

| | | | |
|------------------|----------------------------------|-----------------|-----------------------------------|
| PART NAME | NON-METALLIC ENCLOSURE (STYLE D) | PART No. | NBD-10442 & NBD-10462 & NBD-15442 |
|------------------|----------------------------------|-----------------|-----------------------------------|

| | | |
|--|---|---|
| <p>MATERIAL:</p> <p><u>INDOOR VERSION</u> SOLID BODY & COVER _____ ABS/PC BLENDED PLASTIC UL94-5VB FLAMMABILITY RATING</p> <p>CLEAR COVER _____ POLYCARBONATE PLASTIC UL94V-0 FLAMMABILITY RATING UV STABILIZED</p> <p><u>OUTDOOR VERSION</u> SOLID BODY & COVER _____ PBT/PC BLENDED PLASTIC UL94-5VA FLAMMABILITY RATING UV STABILIZED</p> | <p>FINISH:</p> <p>BODY _____ LIGHT GRAY COVER _____ LIGHT GRAY OR CLEAR</p> <p>COVER INCLUDES GRAY POLYURETHANE GASKET.</p> <p>NOTE: COVER ATTACHES WITH PHILLIPS DRIVE NON-METALLIC SCREWS. (NOT SHOWN)</p> | <p>INDUSTRY STANDARDS:</p> <p><u>INDOOR VERSION</u> UL508 TYPE 1, 2, 4, 4X INDOOR, 12 & 13 NEMA TYPE 1, 2, 4, 4X, 12 & 13 IEC529-IP65</p> <p><u>OUTDOOR VERSION</u> UL508 TYPE 1, 2, 4, 4X, 12 & 13 NEMA TYPE 1, 2, 4, 4X, 12 & 13 IEC529-IP65</p> |
|--|---|---|

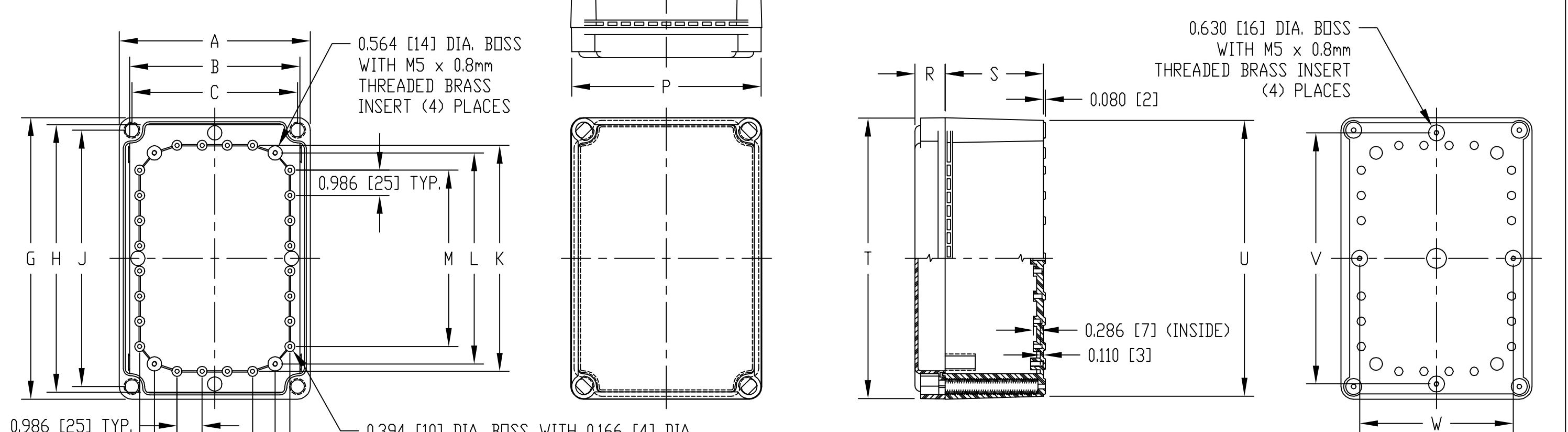

AIR AND MOISTURE VENTS, STAINLESS STEEL LOCKING HASP, PANEL MOUNTING RAILS, GALVANIZED STEEL INNER PANEL AND STAINLESS STEEL WALL MOUNTING BRACKETS ARE NOT INCLUDED, BUT CAN BE PURCHASED SEPARATELY.

DIMENSIONS = INCHES
 [MILLIMETERS]

NOTE: ALL DIMENSIONS HAVE ±0.039 [±1] TOLERANCE UNLESS OTHERWISE SPECIFIED

| INDOOR VERSION | | OUTDOOR VERSION | DIMENSIONS | | | | | | | | | | | | | | | | | | | |
|----------------|-------------|-----------------|----------------|----------------|----------------|----------------|----------------|---------------|-----------------|-----------------|-----------------|----------------|----------------|----------------|----------------|----------------|---------------|---------------|-----------------|-----------------|----------------|----------------|
| PART NO. | | PART NO. | | | | | | | | | | | | | | | | | | | | |
| SOLID COVER | CLEAR COVER | SOLID COVER | A | B | C | D | E | F | G | H | J | K | L | M | N | P | R | S | T | U | V | W |
| NBD-10442 | NBD-10462 | NBD-15442 | 7.485 [190] | 6.663 [169] | 6.496 [165] | 5.890 [150] | 4.736 [120] | 2.958 [75] | 11.024 [280] | 10.474 [266] | 10.039 [255] | 8.850 [225] | 8.263 [210] | 6.902 [175] | 7.280 [185] | 7.420 [188] | 1.181 [30] | 3.850 [98] | 10.984 [279] | 10.805 [274] | 9.838 [250] | 6.027 [153] |

X-ON Electronics

Largest Supplier of Electrical and Electronic Components

Click to view similar products for [Screws & Fasteners](#) category:

Click to view products by [Bud Industries](#) manufacturer:

Other Similar products are found below :

[5721-1440-1/4-SS](#) [593503FX](#) [0098.0094](#) [0098.9206](#) [0098.9219](#) [0098.9262](#) [596-2114-013](#) [59781-6](#) [0098.0026](#) [0098.9210](#) [0098.9212](#) [60227-01](#) [60227-04](#) [60227-08](#) [60687-01](#) [LOCK WASHER Black](#) [618-00001](#) [62153-03](#) [62153-11](#) [M316-KSSTMCZ100](#) [M3440-SS](#) [M3442-SS](#) [M3448-SS](#) [6292-1](#) [6-306105-9](#) [6-306131-4](#) [690432-1](#) [699161-000](#) [7230-3](#) [7244](#) [7248-1](#) [7248-2](#) [73542-02](#) [CAPTIVE SHORT THUMBSCREW](#) [745564-1](#) [F1209](#) [751-00001](#) [7680](#) [809704-1](#) [8700](#) [8860220](#) [9047](#) [9521](#) [992326-6](#) [992763-3](#) [1-18024-0](#) [1-18028-2](#) [A168P1](#) [A495P1](#) [1-24921-1](#) [125416-1](#) [1260](#)