

- ⊕ IP68 rated
- ⊕ IP69K, Tested in accordance with DIN 40050/Part 9 IP6k9k
- ⊕ USB V2.0 performance
- ⊕ Plug and play capability
- ⊕ Shielded system
- ⊕ Overmoulded cables
- ⊕ Screw coupling
- ⊕ PCB versions
- ⊕ Dust and waterproof to EN60529
- ⊕ Data rates up to 480Mbps
- ⊕ Hot pluggable, standard 4 pole interface
- ⊕ High noise immunity
- ⊕ Tamperproof construction
- ⊕ Secure, proven locking system
- ⊕ Direct mounting or via adaptor leads
- ⊕ EN60068-2-52 Test Kb Salt Mist (Cyclic) Marine Severity Level 1

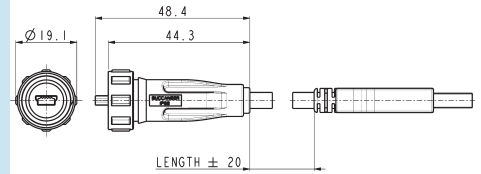

PX0441

- Standard 'A' type to sealed Mini 'B' type
- Fully overmoulded construction
- Available in 2, 3 & 4.5m lengths
- Mates with PX0443, PX0446, PX0447, PX0456, PX0457 & PX0458



PX0442

- Mini 'A' type to sealed mini 'B' type
- Fully overmoulded construction
- Available in 2, 3 & 4.5m lengths
- Mates with PX0443, PX0446, PX0447, PX0456, PX0457 & PX0458

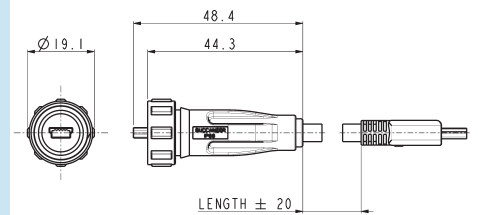

PX0444

- Mini 'B' type to Sealed Mini 'A' type
- Fully overmoulded construction
- Available in 2, 3 & 4.5m lengths
- Mates with PX0456, PX0457 & PX0458

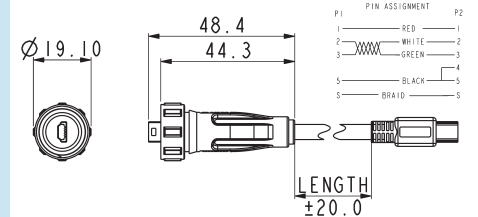

| Part No. | Length | Description |
|-------------|--------|------------------------------------|
| PX0441/2M00 | 2.0m | IP68 mini 'B' to Std 'A' type USB |
| PX0441/3M00 | 3.0m | IP68 mini 'B' to Std 'A' type USB |
| PX0441/4M50 | 4.5m | IP68 mini 'B' to Std 'A' type USB |
| PX0442/2M00 | 2.0m | IP68 mini 'B' to Mini 'A' type USB |
| PX0442/3M00 | 3.0m | IP68 mini 'B' to Mini 'A' type USB |
| PX0442/4M50 | 4.5m | IP68 mini 'B' to Mini 'A' type USB |
| PX0444/2M00 | 2.0m | IP68 mini 'A' to Mini 'B' type USB |
| PX0444/3M00 | 3.0m | IP68 mini 'A' to Mini 'B' type USB |
| PX0444/4M50 | 4.5m | IP68 mini 'A' to Mini 'B' type USB |

Front Panel Mounting Connector



PX0443

- Mini 'B' type
- Leaded with 5 way crimp, for use with PC header
- Mates with PX0441 & PX0442 type cables

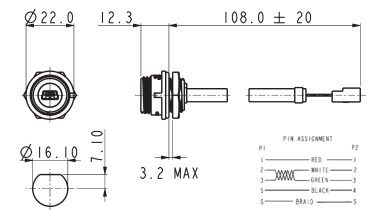

Part no. **Description**

| | |
|--------|---|
| PX0443 | IP68 B type Mini USB, front panel mounted. 5 way crimp connector at rear. |
| PX0459 | As PX0443 with exposed braid for use with PX0464 screening can |

Front Panel Mounting Connector



PX0456

- Mini 'AB' type
- Leaded with 6 way crimp, for use with PC header
- Mates with PX0441, PX0442 & PX0444 type cables

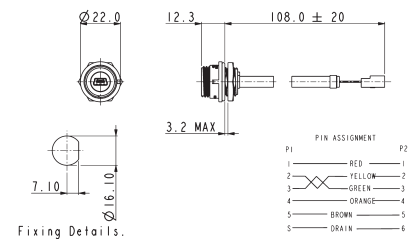

Part no. **Description**

| | |
|--------|--|
| PX0456 | IP68 AB type Mini USB, front panel mounted. 6 way crimp connector at rear. |
|--------|--|

Rear Panel Mounting Connector



PX0446

- Mini 'B' type
- Leaded with 5 way header
- Mates with PX0441 & PX0442 type cables

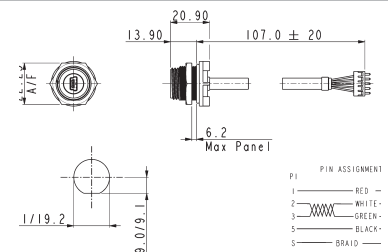

Rear Panel Mounting Connector



PX0447

- Mini 'B' type
- With pins for direct PC mounting
- Mates with PX0441 & PX0442 type cables

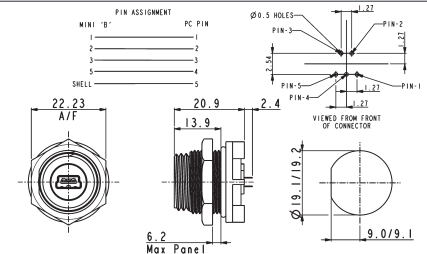

Part no. **Description**

| | |
|--------|---|
| PX0446 | IP68 B type Mini USB, rear panel mounted. 5 way header connector at rear. |
| PX0447 | IP68 B type Mini USB, rear panel mounted. PC terminals at rear. |

Rear Panel Mounting Connector

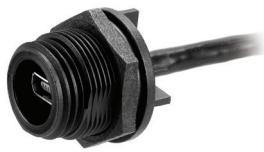

PX0457

- Mini 'AB' type
- Leaded with 6 way header
- Mates with PX0441, PX0442 & PX0444 type cables

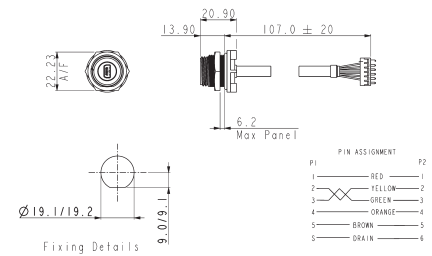

Rear Panel Mounting Connector



PX0458

- Mini 'AB' type
- With pins for direct PC mounting
- Mates with PX0441, PX0442 & PX0444 type cables

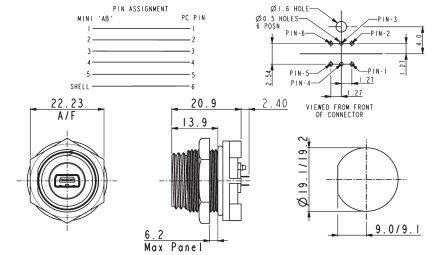

Part no. **Description**

| | |
|--------|--|
| PX0457 | IP68 AB type Mini USB, rear panel mounted. 6 way header connector at rear. |
| PX0458 | IP68 AB type Mini USB, rear panel mounted. PC terminals at rear. |

Screening Can



PX0464

- Maintains cable screening directly to panel
- Shielding can clips around the panel fixing nut
- For use on PX0459

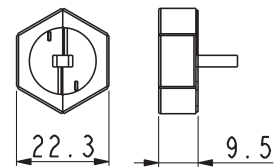

Accessories



- Sealing caps to maintain IP rating when connectors are not in use
- PCB headers for use with PX0443 & PX0456

Part no. **Description**

| | |
|--------|--|
| PX0485 | Sealing cap for use with PX0441, PX0442 & PX0444 |
| PX0480 | Sealing cap for use with PX0443 & PX0456 |
| PX0484 | Sealing cap for use with PX0446, PX0447, PX0457 & PX0458 |
| 14191 | 5 way straight header |
| 14192 | 5 way right angle header |
| 14563 | 6 way straight header |
| 14564 | 6 way right angle header |

Cables & connectors

Mechanical

| | |
|-----------------------|--|
| Sealing | IP68, EN60529:1992+A2:2013 (10m depth for 2 weeks) IP69K, Tested in accordance with DIN 40050/Part 9 IP6k9K |
| Operating temperature | 0°C to +70°C |
| Salt Mist | EN60068-2-52 Test Kb Salt Mist (Cyclic) Marine Severity Level 1 |

Electrical

| | |
|--------------------|-----------------|
| No. of poles | 4 and 5 |
| Current rating | 1A |
| Voltage rating | 30Vac, 42Vdc |
| Contact resistance | 50m Ω max. |
| Performance | USB version 2.0 |

Materials - Overmoulded

| | |
|---------------------|-------------|
| Overmould material | PVC (black) |
| Flammability rating | UL94V-0 |

Materials - Re-wireable and Panel Connectors

| | |
|-------------------------------|--------------------|
| Shell material | Steel |
| Shell plating | Nickel |
| Contact material | Copper Alloy |
| Contact plating | 50 micro inch Gold |
| Connector body & locking ring | Polyester |
| Panel connector | Nylon 6 |
| Flammability rating | UL94V-0 |
| 'O' rings | Nitrile |
| Mating cycles | 5,000 |
| RoHS | Compliant |

Materials - cable

| | |
|--------------|---------------------|
| Cable Jacket | PVC (black) |
| Screen | Tinned copper braid |
| Flammability | UL94V-0 |
| RoHS | Compliant |

| Length: | Dia | Conductors Signal | Conductors Power |
|---------|-------|----------------------|---------------------|
| 2m | 4.8mm | 2 x 28AWG | 2 x 24AWG |
| 3m | 5.0mm | 2 x 28AWG | 2 x 22AWG |
| 5m | 5.2mm | 2 x 25AWG | 2 x 20AWG |

Cable construction - PX0441, PX0442, PX0444

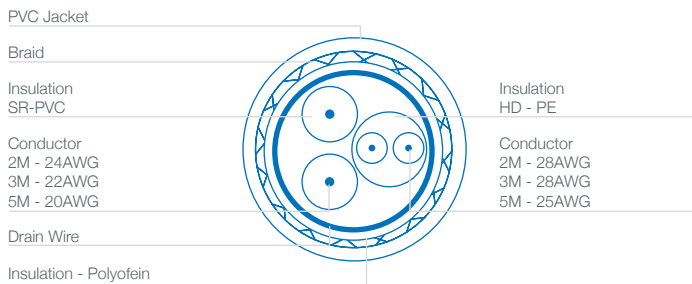

X-ON Electronics

Largest Supplier of Electrical and Electronic Components

Click to view similar products for [Headers & Wire Housings](#) category:

Click to view products by [Bulgin](#) manufacturer:

Other Similar products are found below :

[892-18-020-10-001101](#) [58102-G61-06LF](#) [582553-1](#) [0009485154](#) [009176003701906](#) [0050291907](#) [LY20-4P-DT1-P1E-BR](#) [02.125.8002.8](#)
[609-3404](#) [61062-3](#) [622-0430](#) [622-3653LF](#) [63453-116](#) [636-1030](#) [636-1427](#) [636-3427](#) [636-4007](#) [641938-9](#) [641991-4](#) [644827-2](#) [65817-010LF](#)
[65817-015LF](#) [65863-015LF](#) [66207-023LF](#) [67095-007LF](#) [67601157](#) [68648-049](#) [70.362.1628.0](#) [70-4210](#) [70-4226B](#) [70-4853B](#) [707-5020](#) [707-](#)
[5028](#) [71.350.2428.0](#) [71918-208LF](#) [71961-016LF](#) [733-134](#) [733-162](#) [754199-000](#) [760-3052](#) [787-8014-00](#) [79531-3000](#) [FCN-360C032-B](#) [FCN-](#)
[367T-T012/H](#) [FCN-723D010/2](#) [80.063.4001.1](#) [800-90-001-10-001000](#) [800-90-010-10-002000](#) [801-43-002-10-013000](#) [801-43-006-10-002000](#)