

380 Push Button Snap Action Switches 16(4)A 250Vac

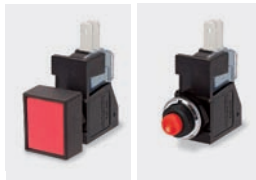

383 2510 K BL



383 2510 RR 383 2510 PR

- ▶ Snap action switches
- ▶ Ratings up to 16A, 250Vac
- ▶ Round and rectangular buttons



16(4)A 250Vac 5E4 T85



16A 125/250Vac 3/4hp T85 50E3

125V 1/2 HP, 250V 3/4 HP, 0.4A 125Vdc, 0.2A 250Vdc



RoHS compliant

Approvals apply to switch mechanism only.
μ contact gap.

■ Blank for switch only

- | | | | | | | |
|----------|--------------|----------------|----------------|----------------|----------------|--|
| E | R Red | B Black | | | | |
| P | R Red | B Black | | | | |
| K | R Red | B Black | BL Blue | G Green | W White | |
| R | R Red | B Black | BL Blue | G Green | W White | |
| M | R Red | B Black | BL Blue | G Green | W White | |

383 2510 K BL

TERMINAL CODE FUNCTION CODE ACTUATOR CODE ACTUATOR COLOR

ORDER FORMAT

▶ TERMINAL	▶ FUNCTION	▶ ACTUATOR	BODY	▶ OPTIONS
<p>383</p> <p>6.3 x 0.8</p> <p>12.0</p>	<p>ON - ON (momentary 1 side)</p>	<p>R Rectangular bezel</p> <p>P Short</p> <p>K with satin chrome bezel</p> <p>M with nylon bezel</p>	<p>Panel Cut-out</p> <p>Panel thickness Both nuts 2.5mm No backnut 4.0mm</p>	<p>Color</p> <p>Call factory for custom colors A full range is available for large orders</p>

Dimensions (mm)

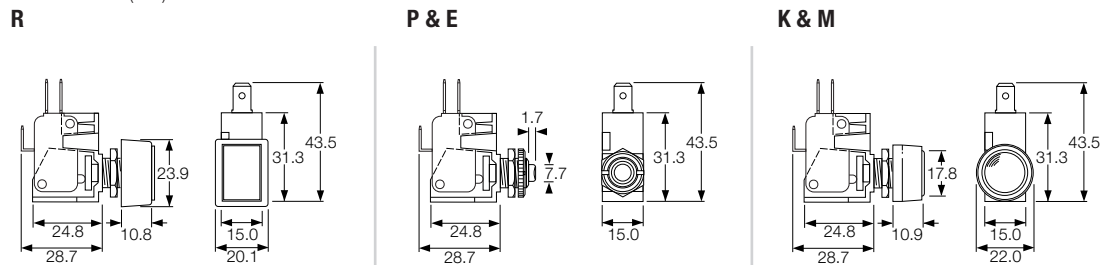

X-ON Electronics

Largest Supplier of Electrical and Electronic Components

Click to view similar products for [Gate Drivers](#) category:

Click to view products by [Bulgin](#) manufacturer:

Other Similar products are found below :

[00053P0231](#) [56956](#) [57.404.7355.5](#) [LT4936](#) [57.904.0755.0](#) [5811-0902](#) [5882900001](#) [00600P0005](#) [00-9050-LRPP](#) [00-9090-RDPP](#)
[5951900000](#) [0131700000](#) [00-2240](#) [LTP70N06](#) [LVP640](#) [5J0-1000LG-SIL](#) [LY2-US-AC240](#) [LY3-UA-DC24](#) [00576P0020](#) [00600P0010](#)
[LZN4-UA-DC12](#) [LZNQ2M-US-DC5](#) [LZNQ2-US-DC12](#) [LZP40N10](#) [00-8196-RDPP](#) [00-8274-RDPP](#) [00-8275-RDNP](#) [00-8609-RDPP](#) [00-](#)
[8722-RDPP](#) [00-8728-WHPP](#) [00-8869-RDPP](#) [00-9051-RDPP](#) [00-9091-LRPP](#) [00-9291-RDPP](#) [0207100000](#) [0207400000](#) [60100564](#) [60249-1-](#)
[CUT-TAPE](#) [0134220000](#) [60713816](#) [M15730061](#) [61161-90](#) [61278-0020](#) [6131-204-23149P](#) [6131-205-17149P](#) [6131-209-15149P](#) [6131-218-](#)
[17149P](#) [6131-220-21149P](#) [6131-260-2358P](#) [6131-265-11149P](#)