

1700 & 1750 Toggle Switches 16A 250Vac Single and Double Pole



- ▶ Nylon toggle switches
- ▶ Ratings up to 20A, 250V ac
- ▶ Single and double pole
- ▶ Wide choice of terminals
- ▶ Choice of circuit options including 3 position
- ▶ Flat & round actuator options

Approvals and specifications



16(4)A 250Vac T85



- UL 20A 250Vac Non Ind (Single pole)
- UL 16A 250Vac Non Ind (Double pole)
- UL CSA (2 pos types) 250Vac 1hp, 125Vac 1/2hp
- UL CSA (3 pos types) 250Vac 1/2hp, 125Vac 1/4hp
- CSA 16A 250Vac Non Ind
- UL 85°C, file E45221, CSA file LR10990
- UL and CSA N/A on momentary types

Selective "A, B, C" and "OFF, A, A+B" circuits at 5 amp also available.
3mm contact gap except where marked μ .
Technical data on pages 4 & 5.

toggle switches

C 1750 H O - - -

TERMINAL FUNCTION ACTUATOR BODY OPTIONS

TERMINAL	FUNCTION		ACTUATOR
C 6.3 x 0.8	Single pole 1700 	Double pole 1750 	H 16.4
H 4.8 x 0.8	1710 μ 	1760 μ 	R 13.8 The switch is on between centre terminals (2 & 5) and the terminals over which the lever is positioned.
K 2.8 x 0.8	1720 μ 	1770 μ 	
T Solder	1721 μ 	ON - OFF - ON (momentary 1 side)	
X PCB 0.8 Sq	1722 μ 	ON - OFF - ON (momentary 2 sides)	



C1700R --



C1700H --



C1760R --



C1750H --

BODY

0
Single pole

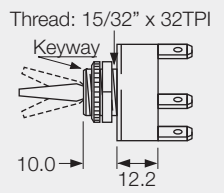

0
Double pole

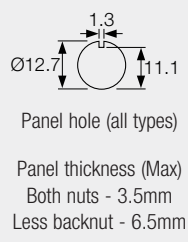
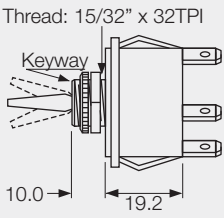

OPTIONS

Neck Seal A0539M0AAA
Material - Nitrile
(H & R Actuators)
Actuator visible



Cover A1080M0AAA
Material - EPDM
(R Actuator only)



Cover A0331M0AAA
Material - PVC
(R Actuator only)



Covers have internal nylon nuts

Fixing nuts (Standard is M506 & T92)

T5 Hex brass
M506 Hex nylon
15.2
3.0 (M506)
2.0 (T5)

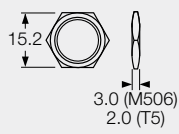

T92 Knurled brass - slotted
16.0
2.6

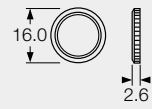

M279 Knurled nylon
16.2
4.1

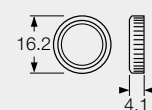

DIMENSIONS (mm)

Single Pole
(C terminals shown)

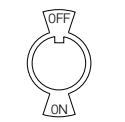
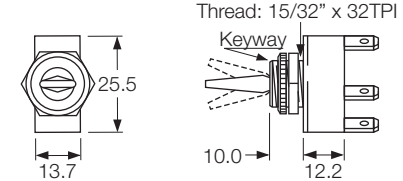

Optional F00232PAAA plate SP or DP

Double Pole
(C terminals shown)

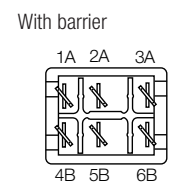
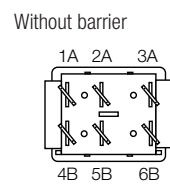
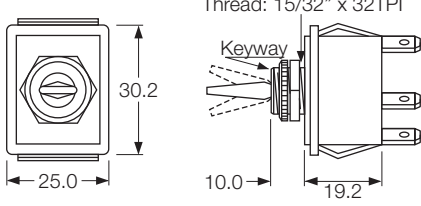

Optional terminal barrier M441.

X-ON Electronics

Largest Supplier of Electrical and Electronic Components

Click to view similar products for [Toggle Switches](#) category:

Click to view products by [Bulgin](#) manufacturer:

Other Similar products are found below :

[8928K478](#) [8951K2998](#) [8951K3310](#) [8956K1283](#) [8956K1285](#) [8956K1286](#) [8956K1287](#) [8961K155](#) [8A1-C-222](#) [020017-13](#) [0090-0001](#) [0121-0015](#) [CS115W](#) [CS120W](#) [CS215I](#) [CS8275](#) [637H/25](#) [7101SPDV30BE](#) [7103SDV30BE](#) [7105D](#) [7108P3YAV2BE](#) [71YY50282](#) [7209SY9AQE](#) [7209SYCBE](#) [7301K38](#) [7301SS24484](#) [7303KZQE](#) [7306K36](#) [7503K21](#) [7565K6](#) [7595K6](#) [7660K12](#) [7691K14](#) [7704K3](#) [8391K108](#) [8811K17](#) [8825K5](#) [8828K13](#) [8835K3](#) [8858K44](#) [8E4011](#) [1202W](#) [A201SCWZB04](#) [A207SYCB04](#) [A208J61ZQ0004](#) [A221T1TCQ](#) [A232M1YCQ](#) [A323S1CWZQ](#) [1201W](#) [1203W](#)