

# 7000 Push Button Switches 16A 250Vac



- ▶ Round and rectangular push button switches
- ▶ Ratings up to 16A, 250V ac
- ▶ Latching and momentary
- ▶ Illuminated & non-illuminated
- ▶ Matching indicators
- ▶ Low profile version
- ▶ Panel cut outs:  
25.0 dia  
27.2 x 22.3



16(4)A 250Vac T125  
8(8)A 250Vac T85



UL CSA 16A Non Ind, 250Vac 1hp, 125Vac 1/2hp  
UL 65°C, file no. E45221, CSA file no. LR10990



RoHS compliant

3mm contact gap.  
Technical data on pages 4 & 5 (switches), 6 (indicators).

<b>NON-LIT</b>		<b>LIT</b>		
<b>B</b> BLACK	<b>B</b> BLACK	<b>A</b> AMBER	<b>2</b> 125V NEON	
<b>R</b> RED	<b>R</b> RED	<b>C</b> CLEAR	<b>3</b> 250V NEON	
<b>W</b> WHITE	<b>W</b> WHITE	<b>G</b> GREEN	<b>7</b> 12V INCANDESCENT	
		<b>R</b> RED		

**C 7053 A F W R 2 -----**

TERMINAL CODE    FUNCTION CODE    ACTUATOR CODE    BODY CODE    BODY COLOR    ACTUATOR COLOR    LAMP VOLTAGE IF REQUIRED    LEGEND & OPTIONS

▶ **ORDER FORMAT**

TERMINAL	FUNCTION				ACTUATOR
<b>C</b>  6.3 x 0.8 9.1	<b>7000</b>		Single pole ON - OFF		<b>A</b> Round actuator shown in F body 
	<b>7001</b>		Single pole ON - OFF (momentary ON)		<b>A</b> Round actuator shown in G body 
	<b>7003</b>		Single pole ON - OFF with light		<b>B</b> Round actuator - medium shown in F body 
	<b>7004</b>		Single pole ON - OFF (momentary ON) with light		<b>C</b> Round actuator - long shown in F body 
	<b>7050</b>		Double pole ON - OFF		<b>C</b> Round actuator - long shown in F body 
	<b>7051</b>		Double pole ON - OFF (momentary ON)		<b>D</b> Round actuator - sub panel mount 
	<b>7053</b>		Double pole ON - OFF with light		<b>S</b> Rectangular actuator Shown in "A" body N/A for 7030 
<b>H</b>  4.8 x 0.8 9.1	<b>7054</b>		Double pole ON - OFF (momentary ON) with light		
	<b>7030</b>		Indicator		



C7000AF ---



C7003AF ---



C7053CF ---



C7053BF ---

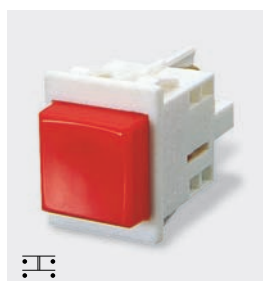

C7050SA ---



C7053AG ---



C7053DF ---



C7030AH ---

push switches

**BODY**

Panel cut-outs

**F H G** Body types fit either cut-out

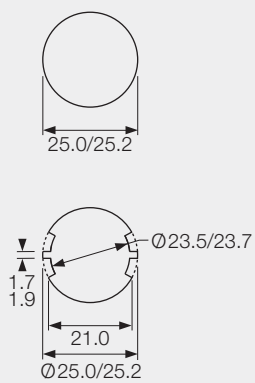

**A**

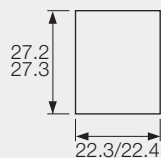

Cut-outs must be punched in the direction of insertion

**OPTIONS**

**Finish**  
 Matt finish is standard on bodies  
 Gloss finish is standard on actuators

**Color**  
 Call factory for custom colors  
 A full range is available for large orders

**Legend printing**  
 A wide range is available or call the factory for custom legends

**Lamp voltage**  
 Call factory for details of other available voltages

**Weatherproof housing (E)**  
 Additional housing which fits round body switches with an oversize housing with a clear silicone cover designed to IP65. Mounting hole dia: 38.0mm

**DIMENSIONS (mm)**

**Panel thickness:**  
**A** 0.8 - 2.5mm  
**F, G, H** 0.8 - 5.0mm

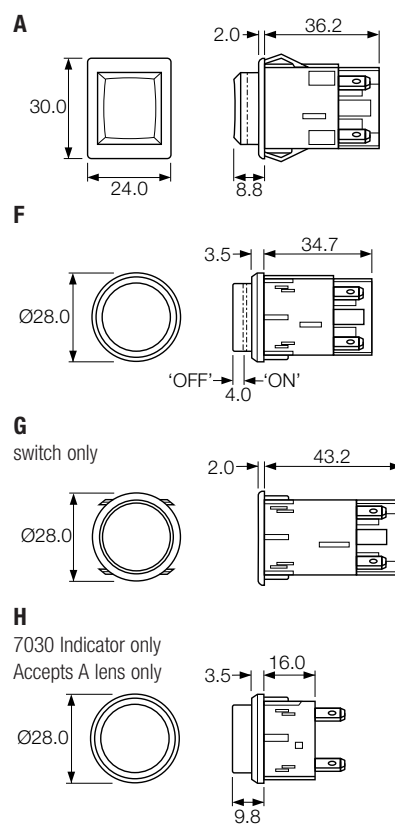

## X-ON Electronics

Largest Supplier of Electrical and Electronic Components

*Click to view similar products for [Pushbutton Switches](#) category:*

*Click to view products by [Bulgin](#) manufacturer:*

Other Similar products are found below :

[8940K2012](#) [LW1L-M1C10V-A](#) [LW1L-M1C70-A](#) [LW2L-A1C20M-GD](#) [LW2L-M1C20M-A](#) [60324L](#) [M22-D-R-GB0/K11](#) [M7E-HRN2](#)  
[67021K512](#) [67081K512X](#) [701PB580](#) [7199K101](#) [810K12910](#) [810KSV30B](#) [MML21EA2ADK](#) [MML21KA3ABK](#) [MML23KA3AC05K-001](#)  
[MML23KW3AA01W](#) [8418K2](#) [8442K3](#) [8450K1](#) [860K11911T01A](#) [861901](#) [861K11911T01A07](#) [861K13810T00A14](#) [861K13911](#)  
[8646AB6X718UL](#) [8646ABUL](#) [9001KXRK](#) [907AYY100](#) [PMHD155A1](#) [9533CD4+U574+U4922](#) [95-414.000](#) [99-450.837](#) [99-453.837](#)  
[PV3H2B0NN-341](#) [1203MRA](#) [A22NZBGANGA](#) [A22NZBNANGA](#) [A22NZMPATRA](#) [A2PMA1X03EC56](#) [A3A-5123-02](#) [A3A-7140](#) [A3A-7310](#) [A3A-7340](#) [A3U-TMW-A2C-5M](#) [A595](#) [12037A2ULCSA](#) [ABD122N-B](#) [1211390004](#)