

Bulgin's slim line **photoelectric sensor** range offers a high degree of mechanical and electrical stability. A cost effective and **flexible sensing solution**. Designed specifically for manufacturing automation and **industrial automation** sensing operations.



Key Features:

- Sealed to IP67
- Stainless Steel 316 shell
- Cabled versions with or without connector
- 2M cable length
- <0.5ms response time
- NPN & PNP output
- Detection distance 1 - 40mm
- Light point diameter 5.0mm at 30mm
- Power supply voltage 12 - 24 VDC
- Ambient humidity 35 - 85%
- Operating temperature -10 to 50°C
- Small body, just 4.5mm thick



- Diffuse Reflective IP67 Sensors
- Choice of M5 Connector Termination
- Stainless Steel 316 Body
- Up to 40mm Sensing Range

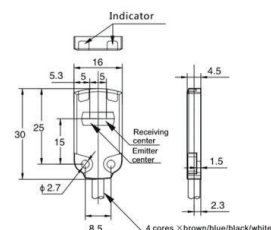

Part no.	Operation Mode	Output Configuration	Sensing Distance	Connection Method
SLLP3002M5	Light on	NPN	2 - 30mm	M5
SLDP3002M5	Dark on	NPN	2 - 30mm	M5
SLLN3002M5	Light on	PNP	2 - 30mm	M5
SLDN3002M5	Dark on	PNP	2 - 30mm	M5
SLLP4002M5	Light on	NPN	2 - 40mm	M5
SLDP4002M5	Dark on	NPN	2 - 40mm	M5
SLLN4002M5	Light on	PNP	2 - 40mm	M5
SLDN4002M5	Dark on	PNP	2 - 40mm	M5
SLLP3002CL	Light on	NPN	2 - 30mm	Cable
SLDP3002CL	Dark on	NPN	2 - 30mm	Cable
SLLN3002CL	Light on	PNP	2 - 30mm	Cable
SLDN3002CL	Dark on	PNP	2 - 30mm	Cable
SLLP4002CL	Light on	NPN	2 - 40mm	Cable
SLDP4002CL	Dark on	NPN	2 - 40mm	Cable
SLLN4002CL	Light on	PNP	2 - 40mm	Cable
SLDN4002CL	Dark on	PNP	2 - 40mm	Cable

○ The way to detect objects correctly

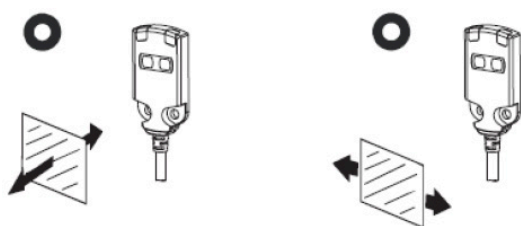

The wrong way to use the sensor

- Use in direct sunlight
- Used in a place of high humidity or dew
- Use in corrosive gas sites
- The use of vibration or shock energy can be directly transmitted to the sensor site.

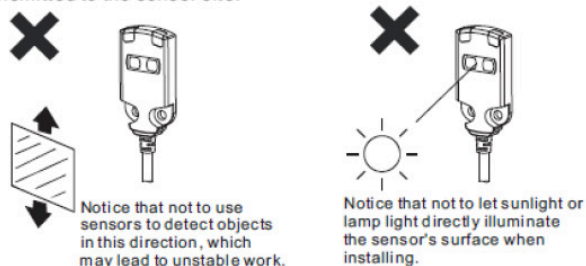

·NPN output

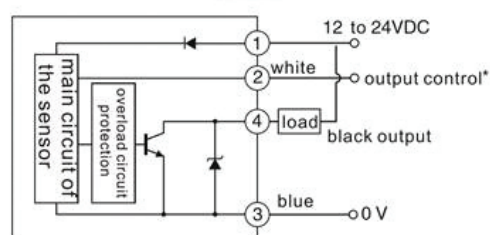

\* DARK-ON mode white ---12 to 24VDC  
 LIGHT-ON mode ---0V

·PNP output

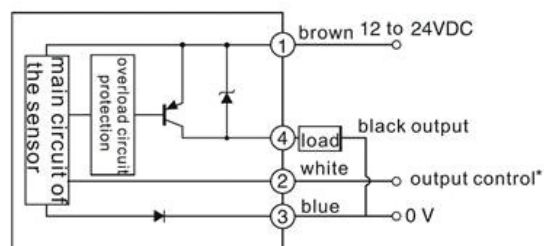

\* DARK-ON mode white ---12 to 24VDC  
 LIGHT-ON mode ---0V

**Electrical:**

<b>Power voltage:</b>	12 V~24VDC ( $\pm 10\%$ )
<b>Current consumption:</b>	11 mA
<b>Output Control (normal):</b>	NPN output type: The NPN collector is open below 24VDC, below 50mA Residual voltage: below 10mA, 10~30mA below 1.5V Below 10mA, when 30~50mA below 2.0V Leakage current: when load resistance 3K $\Omega$ below 0.3mA when load resistance 1K $\Omega$ below 0.5mA when load resistance 0.2K $\Omega$ below 1.5mA
<b>Maximum switching load current:</b>	50 mA

**Mechanical:**

<b>Operating temperature:</b>	-10 to 50°C
<b>Ambient humidity:</b>	35-85%
<b>Sealing:</b>	IP67
<b>Vibration resistance:</b>	10-50Hz double amplitudes, X. Y. Z. each direction 2 hours
<b>Shock resistance:</b>	1000m/s <sup>2</sup> , X. Y. Z. each direction 6 times
<b>Cable Length:</b>	02 = 2M
<b>Termination:</b>	M5 = M5 connector CL = Blunt cut wire

**Operation:**

<b>Indicator:</b>	<ul style="list-style-type: none"> <li>· Out Red;</li> <li>· Stable operation: Green;</li> <li>· Transmitters power supply: Green</li> <li>· Detection: Red &amp; Green</li> </ul>
<b>Range:</b>	SL
<b>Operation Mode:</b>	L + Light On D = Dark On
<b>Output Configuration:</b>	P = NPN N = PNP
<b>Sensing Distance:</b>	30 = upto 30mm 40 = upto 40mm

**Materials:**

Body:	TPU
Coupling Nut:	Nickel Plated Brass
Colour:	Blue
Pin Contacts:	Brass, Gold plating
Socket Contacts:	Phosphor Bronze, Gold plating
O Rings & Gaskets:	Viton
RoHS:	Compliant

**Cable Connectors:****Sensor:**

Stainless Steel 316
-
Blue
-
-
-
Compliant



SL	/	X	/	X	/	XX	/	XX	/	XX
Range		Operation Mode		Output Configuration		Sensing Distance		Cable Length		Termination
SL		L = Light On D = Dark On		P = NPN N = PNP		30 = upto 30mm 40 = upto 40mm		02 = 2M		M5 = M5 connector CL = Blunt cut wire

## X-ON Electronics

Largest Supplier of Electrical and Electronic Components

*Click to view similar products for [Photoelectric Sensors](#) category:*

*Click to view products by [Bulgin](#) manufacturer:*

Other Similar products are found below :

[7442AD2X5FRX](#) [EX-19B-LP](#) [EX-19SB-PN](#) [7443AR0X5FRX](#) [7452AD4D4NNX](#) [F3WD052C5M](#) [7694ADE04DS2X](#) [FX-305](#) [PM-R24-R](#)  
[Q45VR2FPQ](#) [13104RQD07](#) [E3JUXM4MN](#) [E3L2DC4](#) [E3S3LE21](#) [E3SCT11M1J03M](#) [E3SDS20E21](#) [E3VDS70C43S](#) [E3XNM16](#) [BR23P](#)  
[HOA6563-001](#) [OJ-3307-30N8](#) [OS-311A-30](#) [P32013](#) [P34036](#) [P43004](#) [P56001](#) [P60001](#) [PB10CNT15PO](#) [S14132](#) [935286-000](#) [S52101](#)  
[S56258](#) [EX-L261-P](#) [FD-SN500](#) [FE7B-FDRB6-M](#) [SU-79](#) [T36342](#) [T40300](#) [T60001](#) [PD60CNX20BP](#) [FX-302-HY](#) [FZS](#) [PM-T64W](#) [PX-22](#)  
[PZ2-51P](#) [CX-491-P-J](#) [CYNUTX10](#) [UZH802](#) [UZH803](#) [UZFRG1](#)