

A

B

C

D

E

REV.

DESCRIPTION

ECN NO.

NAME

DATE

1

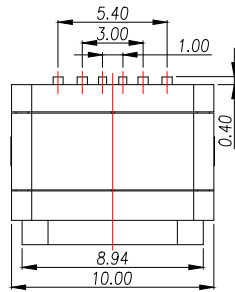
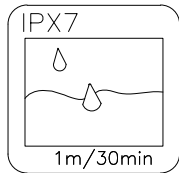

A5	CC1	B5	CC2
A9	VBUS	B9	VBUS
A12	GND	B12	GND
PIN	SIGNAL	PIN	SIGNAL

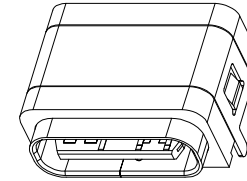
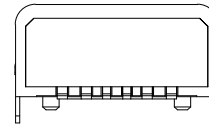

2

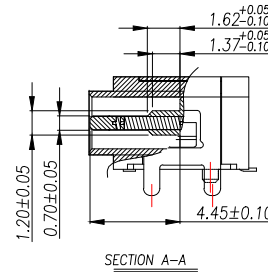
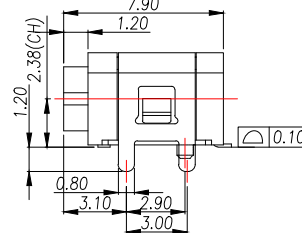
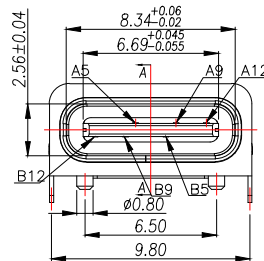
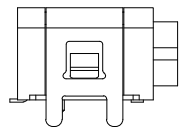

SPECIFICATION:

1.Material:

HOUSING&MOLDING:
HIGH TEMPERATURE RESISTANT PLASTIC,
UL94 V-0
CONTACTS:COPPER ALLOY T=0.15mm
IDDL CLIP:SUS301-1/2H,T=0.15mm
SHELL-1:SUS304, T=0.30mm
SHELL-2:SUS304, T=0.20mm

2.Mechanical:

2.1.Mating force:0.5~2.0kgf.
2.2.UNMATING FORCE:0.8~2.0kgf.
0.6~2.0kgf AFTER DURABILITY TEST;
2.3.Durability:10000 Cycles;

3.Electrical:

3.1.Current Rating:3A Max.;
3.2.Voltage Rating:20V Max.;
3.3.Dielectric Withstanding voltage:100VAc;
3.4.Contact resistance:40m Ohms Max.;
3.5.Insulation Resistance:100M Ohms Min.;

4.Environmental:

4.1.Operating temperature:-40°C~+85°C;
4.2.Wetting Temperature:265±5°C,5±0.5s

3

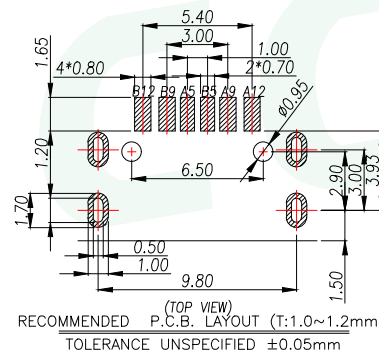
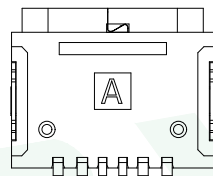

4

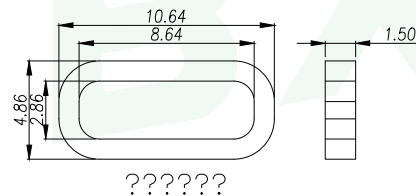

5

GENERAL TOLERANCE

DONGGUAN BAOXUN PRECISION TECHNOLOGY CO., LTD

DIM. TOL.

X
X.X ±0.30
X.XX ±0.25
X.XXX ±0.15
GENERAL ANGLE:
±3°

TITLE: USB C TYPE 6Pin 母座板上型带塑胶柱

DWG. NO.: UC07-0B06F00P11

DRAWN: MAX

PART NO.: UC07-0B06F00P11

CHECKED: ELLA

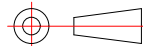

UNIT: mm

SCALE: none

SHEET: 1 of 1

DWG. SIZE: A4

LAYER: bxconn

APPROVED: WILL

BXCONN®



X-ON Electronics

Largest Supplier of Electrical and Electronic Components

Click to view similar products for [USB Connectors](#) category:

Click to view products by [BXCONN](#) manufacturer:

Other Similar products are found below :

[950](#) [A-USB A-LP-SMT-C](#) [A-USB B-TOP-C](#) [MUSBD11135](#) [17-200721](#) [217450-1](#) [KMBVX-TH-5S-B30](#) [KUSBX-AS2N-W](#) [KUSBX-SMT2AP1S-W30](#) [935](#) [957](#) [30-498-6](#) [SK-60A-2](#) [1734082-1](#) [30-470](#) [30-489](#) [30-541](#) [MIKROE-1451](#) [USBFTVSCCG](#) [1-1734084-2](#) [10135326-001LF](#) [4198](#) [USB-A-D-VT](#) [USB-A-S-RA-TSMT](#) [1310-1023-02](#) [690-024-633-031](#) [UB-20PMFP-LC7001](#) [17-200011](#) [UB-20AFMM-LL7A01](#) [1040870124](#) [CAP-WCCMLPB1](#) [2274475-3](#) [UB-20BMFA-SL8001](#) [914-614A2025S10200](#) [ZX40-B-5S-1500-STDA\(30\)](#) [GSB3116344HR](#) [USB3FTV2SAZNF459](#) [U221-041N-1WVS62-F5D](#) [HYCW153-USBD05-500B](#) [HYCW219-USBD05-075B](#) [HYCW148-USBD05-117B](#) [HYCW149-USBD05-740B](#) [HYCW204-USBD05-108B](#) [HYCW214-USBA04-113B](#) [HYCW213-USBA04-113B](#) [UB-20AMFM-SL7A01](#) [KMMX-BSMT35S-1-B30TR](#) [2345986-1](#) [10082141-N340LF](#) [10117836-011LF](#)