

| | | | | | | | | | |
|------|-------------|---|--|---|---------|------|------|---|--|
| A | | B | | C | | D | | E | |
| REV. | DESCRIPTION | | | | ECN NO. | NAME | DATE | | |
| | | | | | | | | | |

PRELIMINARY
DESIGN IS SUBJECT
TO CHANGE WITHOUT
PRIOR NOTICE

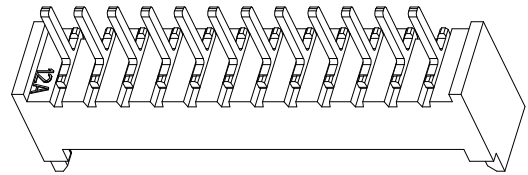

- NOTES:
- Working temp:-25°C~85°C.
 - Voltage rating:125V AC/DC(rms)
 - Contact resistance:55mΩ max.
 - Insulation resistance:100MΩ min.
 - Current rating:1A AV/DC
 - Withstanding Voltage:500V AC/minute
 - Pin Retention Force:5N min.
 - Housing material:LCP UL94-V0,Natural
 - Terminal mater:Brass,
plating Ni 40u" min , plating Tin 100u"min.
 - Solder tab material:Brass,
plating Ni 40u" min , plating Tin 100u"min.

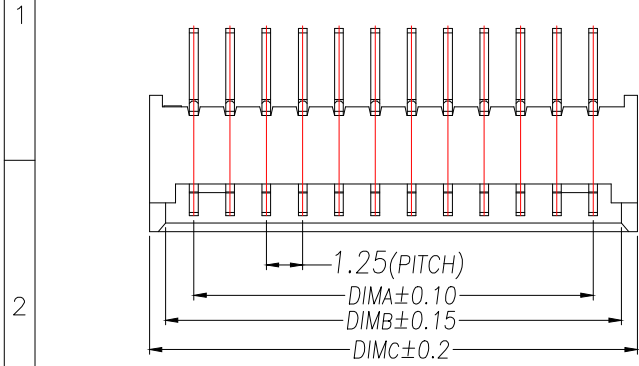
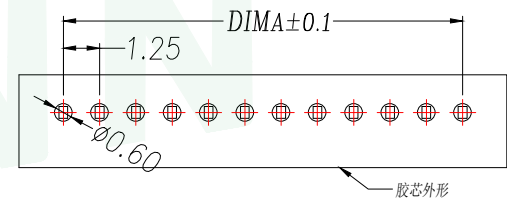
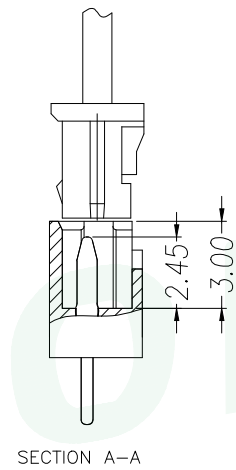
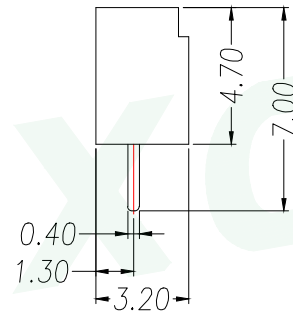
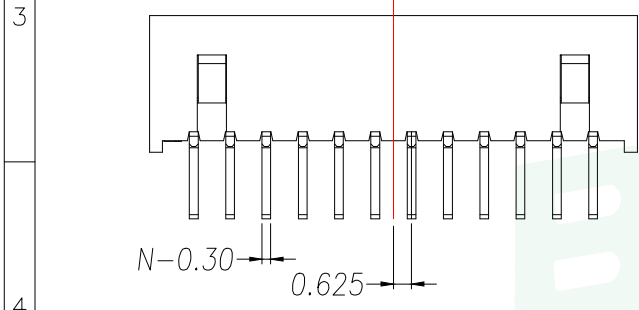
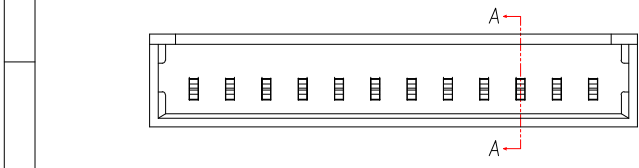

| PIN | No. | Dim A | Dim B | Dim C |
|-----|--------------|-------|-------|-------|
| 2 | WF-1A125A2P | 1.25 | 3.20 | 4.30 |
| 3 | WF-1A125A3P | 2.50 | 4.45 | 5.55 |
| 4 | WF-1A125A4P | 3.75 | 5.70 | 6.80 |
| 5 | WF-1A125A5P | 5.00 | 6.95 | 8.05 |
| 6 | WF-1A125A6P | 6.25 | 8.20 | 9.30 |
| 7 | WF-1A125A7P | 7.50 | 9.45 | 10.55 |
| 8 | WF-1A125A8P | 8.75 | 10.70 | 11.80 |
| 9 | WF-1A125A9P | 10.00 | 11.95 | 13.05 |
| 10 | WF-1A125A10P | 11.25 | 13.20 | 14.30 |
| 11 | WF-1A125A11P | 12.50 | 14.45 | 15.55 |
| 12 | WF-1A125A12P | 13.75 | 15.70 | 16.80 |
| 13 | WF-1A125A13P | 15.00 | 16.95 | 18.05 |
| 14 | WF-1A125A14P | 16.25 | 18.20 | 19.30 |
| 15 | WF-1A125A15P | 17.50 | 19.45 | 20.55 |
| 16 | WF-1A125A16P | 18.75 | 20.70 | 21.80 |

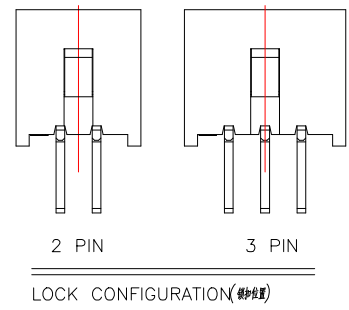

| | | | | | | |
|--------------------|-------|---|-------------|---------------|---------------|----------------|
| GENERAL TOLERANCE | | DONGGUAN BAOXUN PRECISION TECHNOLOGY CO., LTD | | | | |
| DIM. | TOL. | TITLE: WAFER 1.25mm H4.7mm 180°DIP | | | | |
| X | | DWG. NO.: WF-1A125ANP | | DRAWN: MAX | | |
| X.X | ±0.30 | PART NO.: WF-1A125ANP | | CHECKED: ELLA | | |
| X.XX | ±0.25 | UNIT: mm | | SCALE: none | SHEET: 1 of 1 | APPROVED: WILL |
| X.XXX | ±0.15 | DWG. SIZE: A4 | LAYER: bxcn | | | |
| GENERAL ANGLE: ±3° | | | | | | |

X-ON Electronics

Largest Supplier of Electrical and Electronic Components

Click to view similar products for [Headers & Wire Housings](#) category:

Click to view products by [BXCONN](#) manufacturer:

Other Similar products are found below :

[0015917161](#) [0022155065](#) [57102-F02-18ULF](#) [58102-G61-06LF](#) [582553-1](#) [01.001.5753.1](#) [0050291907](#) [02.125.8002.8](#) [609-3404](#) [61062-3](#)
[CSU011177004](#) [622-0430](#) [622-3653LF](#) [63453-116](#) [636-1030](#) [636-1427](#) [636-3427](#) [636-4007](#) [641938-9](#) [65495-038](#) [65692-001LF](#) [65781-018](#)
[65781-047](#) [65817-010LF](#) [65817-015LF](#) [67095-007LF](#) [67601157](#) [68631-112](#) [699319-000](#) [70.362.1628.0](#) [70-4210](#) [70-4226B](#) [70-4853B](#) [707-](#)
[5028](#) [71.350.2428.0](#) [733-134](#) [733-162](#) [760-3052](#) [MHR-64-VUAL](#) [80.063.4001.1](#) [800-90-001-10-001000](#) [801-43-002-10-013000](#)
[801-43-006-10-002000](#) [803-43-024-10-001000](#) [803-93-012-10-001000](#) [8-1437020-4](#) [819-22-004-30-001101](#) [820-22-006-30-001101](#)
[820-22-008-30-001101](#) [821-22-002-10-001101](#)