

A		B		C		D		E	
REV.	DESCRIPTION				ECN NO.	NAME	DATE		

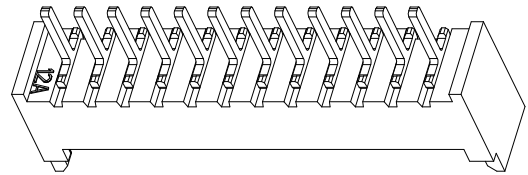

PRELIMINARY
DESIGN IS SUBJECT
TO CHANGE WITHOUT
PRIOR NOTICE

- NOTES:
- Working temp:-25°C~85°C.
 - Voltage rating:125V AC/DC(rms)
 - Contact resistance:55mΩ max.
 - Insulation resistance:100MΩ min.
 - Current rating:1A AV/DC
 - Withstanding Voltage:500V AC/minute
 - Pin Retention Force:5N min.
 - Housing material:LCP UL94-V0,Natural
 - Terminal materl:Brass,
plating Ni 40u" min , plating Tin 100u"min.
 - Solder tab material:Brass,
plating Ni 40u" min , plating Tin 100u"min.

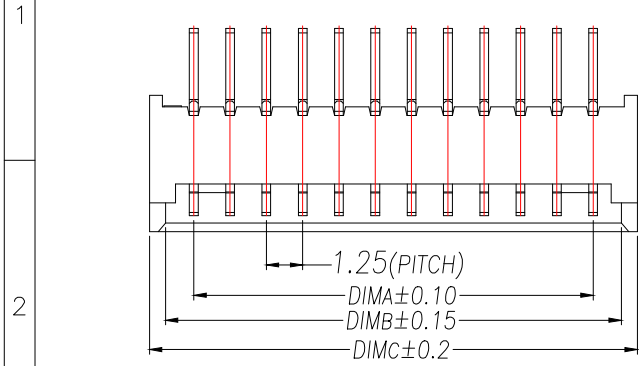
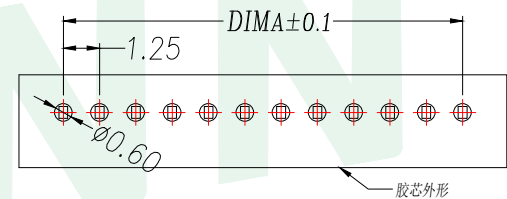
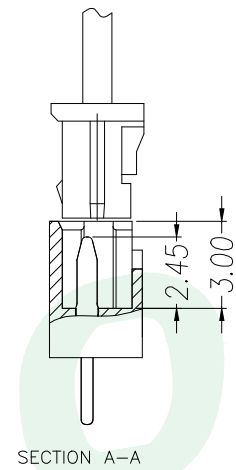
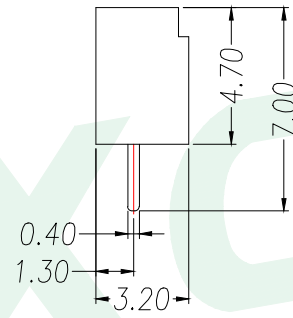
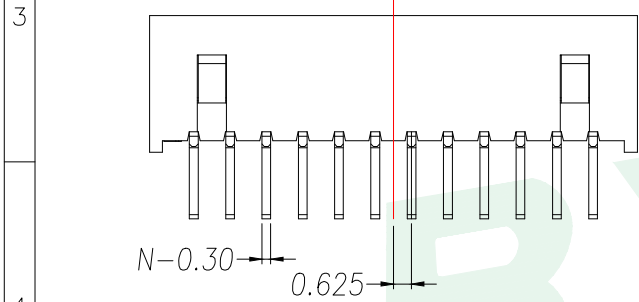
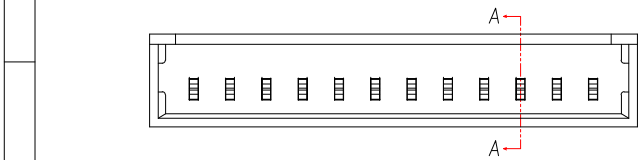

RECOMMENDED PCB LAYOUT TOP VIEW (TOLERANCE:±0.05)

PIN	No.	Dim A	Dim B	Dim C
2	WF-1A125A2P-Y	1.25	3.20	4.30
3	WF-1A125A3P-Y	2.50	4.45	5.55
4	WF-1A125A4P-Y	3.75	5.70	6.80
5	WF-1A125A5P-Y	5.00	6.95	8.05
6	WF-1A125A6P-Y	6.25	8.20	9.30
7	WF-1A125A7P-Y	7.50	9.45	10.55
8	WF-1A125A8P-Y	8.75	10.70	11.80
9	WF-1A125A9P-Y	10.00	11.95	13.05
10	WF-1A125A10P-Y	11.25	13.20	14.30
11	WF-1A125A11P-Y	12.50	14.45	15.55
12	WF-1A125A12P-Y	13.75	15.70	16.80
13	WF-1A125A13P-Y	15.00	16.95	18.05
14	WF-1A125A14P-Y	16.25	18.20	19.30
15	WF-1A125A15P-Y	17.50	19.45	20.55
16	WF-1A125A16P-Y	18.75	20.70	21.80

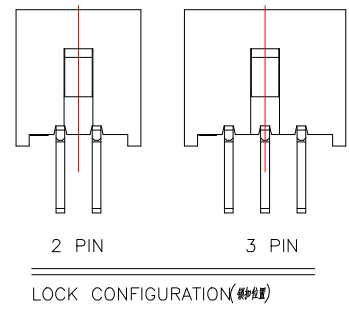

GENERAL TOLERANCE		DONGGUAN BAOXUN PRECISION TECHNOLOGY CO., LTD				
DIM.	TOL.	TITLE: WAFER 1.25mm H4.7mm 180°DIP 黄色				
X		DWG. NO.: WF-1A125ANP-Y		DRAWN: MAX		
X.X	±0.30	PART NO.: WF-1A125ANP-Y		CHECKED: ELLA		
X.XX	±0.25	UNIT: mm		APPROVED: WILL		
X.XXX	±0.15	SCALE: none	SHEET: 1 of 1	DWG. SIZE: A4	LAYER: bxconn	
GENERAL	ANGLE: ±3°					

X-ON Electronics

Largest Supplier of Electrical and Electronic Components

Click to view similar products for [Headers & Wire Housings](#) category:

Click to view products by [BXCONN](#) manufacturer:

Other Similar products are found below :

[0015917161](#) [0022155065](#) [57102-F02-18ULF](#) [58102-G61-06LF](#) [582553-1](#) [01.001.5753.1](#) [0050291907](#) [02.125.8002.8](#) [609-3404](#) [61062-3](#)
[CSU011177004](#) [622-0430](#) [622-3653LF](#) [63453-116](#) [636-1030](#) [636-1427](#) [636-3427](#) [636-4007](#) [641938-9](#) [65495-038](#) [65692-001LF](#) [65781-018](#)
[65781-047](#) [65817-010LF](#) [65817-015LF](#) [67095-007LF](#) [67601157](#) [68631-112](#) [699319-000](#) [70.362.1628.0](#) [70-4210](#) [70-4226B](#) [70-4853B](#) [707-](#)
[5028](#) [71.350.2428.0](#) [733-134](#) [733-162](#) [760-3052](#) [MHR-64-VUAL](#) [80.063.4001.1](#) [800-90-001-10-001000](#) [801-43-002-10-013000](#)
[801-43-006-10-002000](#) [803-43-024-10-001000](#) [803-93-012-10-001000](#) [8-1437020-4](#) [819-22-004-30-001101](#) [820-22-006-30-001101](#)
[820-22-008-30-001101](#) [821-22-002-10-001101](#)