

A		B		C		D		E	
REV.	DESCRIPTION				ECN NO.	NAME	DATE		

PRELIMINARY  
DESIGN IS SUBJECT  
TO CHANGE WITHOUT  
PRIOR NOTICE

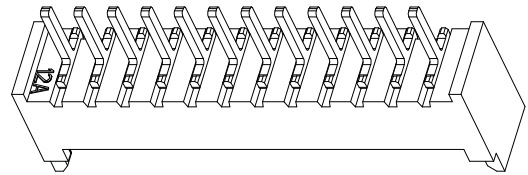

- NOTES:
- Working temp:-25°C~85°C.
  - Voltage rating:125V AC/DC(rms)
  - Contact resistance:55mΩ max.
  - Insulation resistance:100MΩ min.
  - Current rating:1A AV/DC
  - Withstanding Voltage:500V AC/minute
  - Pin Retention Force:5N min.
  - Housing material:LCP UL94-V0,Natural
  - Terminal mater:Brass,  
plating Ni 40u" min , plating Tin 100u"min.
  - Solder tab material:Brass,  
plating Ni 40u" min , plating Tin 100u"min.

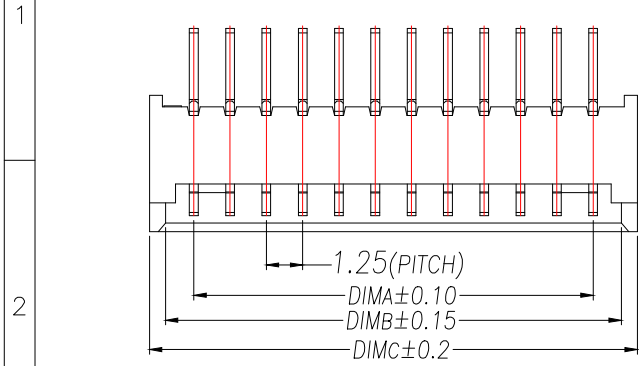
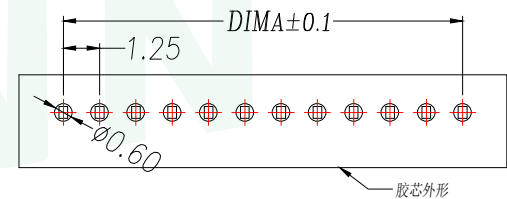
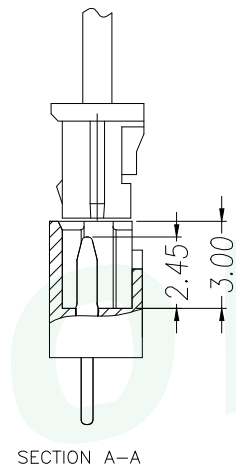
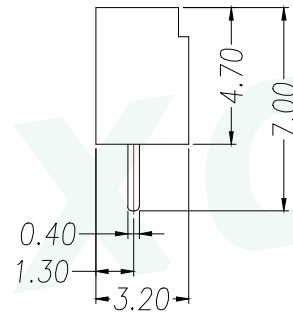
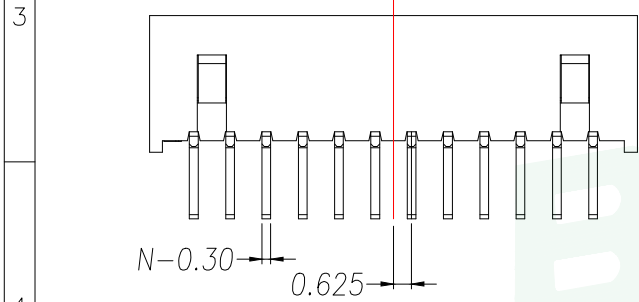
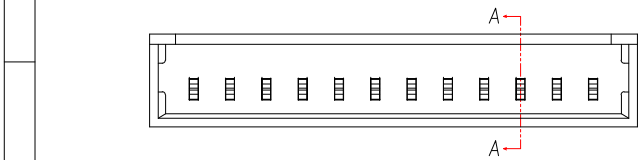

PIN	No.	Dim A	Dim B	Dim C
2	WF-1A125A2P	1.25	3.20	4.30
3	WF-1A125A3P	2.50	4.45	5.55
4	WF-1A125A4P	3.75	5.70	6.80
5	WF-1A125A5P	5.00	6.95	8.05
6	WF-1A125A6P	6.25	8.20	9.30
7	WF-1A125A7P	7.50	9.45	10.55
8	WF-1A125A8P	8.75	10.70	11.80
9	WF-1A125A9P	10.00	11.95	13.05
10	WF-1A125A10P	11.25	13.20	14.30
11	WF-1A125A11P	12.50	14.45	15.55
12	WF-1A125A12P	13.75	15.70	16.80
13	WF-1A125A13P	15.00	16.95	18.05
14	WF-1A125A14P	16.25	18.20	19.30
15	WF-1A125A15P	17.50	19.45	20.55
16	WF-1A125A16P	18.75	20.70	21.80

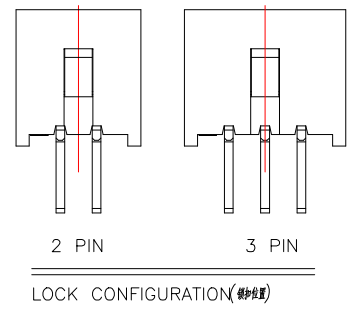

GENERAL TOLERANCE		DONGGUAN BAOXUN PRECISION TECHNOLOGY CO., LTD				
DIM.	TOL.	TITLE: WAFER 1.25mm H4.7mm 180°DIP				
X		DWG. NO.: WF-1A125ANP		DRAWN: MAX		
X.X	±0.30	PART NO.: WF-1A125ANP		CHECKED: ELLA		
X.XX	±0.25	UNIT: mm		APPROVED: WILL		
X.XXX	±0.15	SCALE: none	SHEET: 1 of 1	DWG. SIZE: A4	LAYER: bxconn	
GENERAL ANGLE:	±3°					

## X-ON Electronics

Largest Supplier of Electrical and Electronic Components

*Click to view similar products for [Headers & Wire Housings](#) category:*

*Click to view products by [BXCONN](#) manufacturer:*

Other Similar products are found below :

[0015917161](#) [0022155065](#) [57102-F02-18ULF](#) [58102-G61-06LF](#) [582553-1](#) [01.001.5753.1](#) [0050291907](#) [02.125.8002.8](#) [609-3404](#) [61062-3](#)  
[CSU011177004](#) [622-0430](#) [622-3653LF](#) [63453-116](#) [636-1030](#) [636-1427](#) [636-3427](#) [636-4007](#) [641938-9](#) [65495-038](#) [65692-001LF](#) [65781-018](#)  
[65781-047](#) [65817-010LF](#) [65817-015LF](#) [67095-007LF](#) [67601157](#) [68631-112](#) [699319-000](#) [70.362.1628.0](#) [70-4210](#) [70-4226B](#) [70-4853B](#) [707-](#)  
[5028](#) [71.350.2428.0](#) [733-134](#) [733-162](#) [760-3052](#) [MHR-64-VUAL](#) [80.063.4001.1](#) [800-90-001-10-001000](#) [801-43-002-10-013000](#)  
[801-43-006-10-002000](#) [803-43-024-10-001000](#) [803-93-012-10-001000](#) [8-1437020-4](#) [819-22-004-30-001101](#) [820-22-006-30-001101](#)  
[820-22-008-30-001101](#) [821-22-002-10-001101](#)