

THIS COPY IS PROVIDED ON A RESTRICTED BASIS AND IS NOT TO BE USED IN ANY WAY DETRIMENTAL TO THE INTERESTS OF PANDUIT CORP.

PANDUIT PART #	WIRE RANGE AWG [mm ²]	TAB SIZE INCH [mm]	COLOR	MAX. WIRE INSULATION DIAMETER	DIMENSIONS in. [mm]		
					L± .03 [0,8]	W± .01 [0,3]	H± .01 [0,3]
EDV10-250	#12-10 [4,0-6,0]	.250 X .032 [6,3 X 0,8]	YELLOW	.23 [5,8]	1.03 [26,2]	.30 [7,6]	.13 [3,3]

NOTES:

- USED FOR:
 - A. STRANDED COPPER WIRE ONLY
 - B. 194°F [90°C] MAX. OPERATING TEMP.
 - C. 600 V. MAX. VOLTAGE RATING
- MATERIAL:
 - A. STAMPING: BRASS, TIN PLATED
 - B. HOUSING: VINYL
 - C. SLEEVE: BRASS, TIN PLATED
- INSTALLATION TOOLS:
 - A. UL LISTED AND CSA CERTIFIED: CT-1550, CT-1551, CT-2500, CT-600A
 - B. PANDUIT APPROVED: CT-100A, CT-160, CT-260, CT-460
- WIRE STRIP LENGTH: $9/32'' \begin{smallmatrix} +1/32 \\ -0 \end{smallmatrix} [7,1\text{mm} \begin{smallmatrix} +0,8 \\ -0 \end{smallmatrix}]$
- SEE www.panduit.com FOR PACKAGE QUANTITIES INDICATED BY PART NUMBER SUFFIX
- DIMENSIONS IN BRACKETS ARE METRIC EQUIVALENT

MAX. WIRE INSUL. DIA.
(SEE CHART)

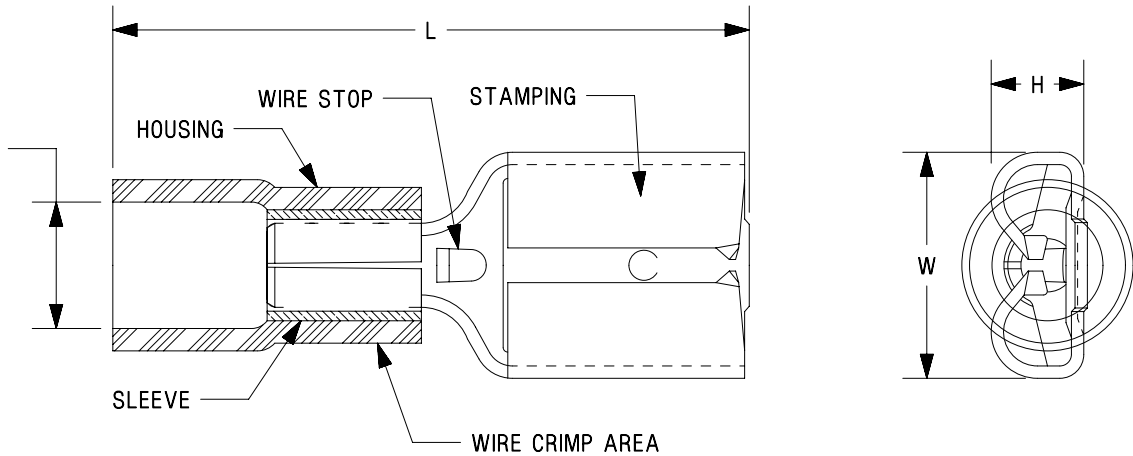

RECOGNIZED CERTIFIED
E78522 LR31212

TITLE STRONGHOLD FEMALE DISCONNECTS (250 SERIES) VINYL INSULATED, METAL SLEEVE #12-10 AWG CUSTOMER DRAWING				
ITEM REVISION NAME		00123SHI/00		
DATASET FILE NAME		00123SHI_DC/00		
UNLESS OTHERWISE SPECIFIED, DIMENSIONAL TOLERANCES ARE: IN [mm] .x ± .1 [2.54] .xxx ± .005 [.127] .xx ± .01 [.25] ANGLES ± 5 °				MATERIAL: SEE NOTES
THIRD ANGLE PROJECTION				DRAWING NUMBER: SH41199
DRAWN BY	DATE	CHK	SCALE	SIZE
JHNU	2/18	TMR	N.T.S.	A

REV	DATE	BY	CHK	APR	DESCRIPTION	ECN
00	2/18	JHNU	TMR	RGB	RELEASED	00123SH

D110100DA/12

X-ON Electronics

Largest Supplier of Electrical and Electronic Components

Click to view similar products for [Terminals](#) category:

Click to view products by [Panduit](#) manufacturer:

Other Similar products are found below :

[HT-13-10](#) [71M-250-32-NB](#) [01-2065-1-0216](#) [00581P0075](#) [M10-10RX](#) [M10BCK](#) [60205-1](#) [604200-1](#) [60598-1-CUT-TAPE](#) [60617-1-C](#) [60873-1](#) [M14-516R/SK](#) [M14-6RSX](#) [M18-10FLX](#) [M18-8FBX](#) [M18-8R/LX](#) [M18BCK](#) [61314-6-C](#) [61-S](#) [61-SN-A](#) [62-NBM-A](#) [63-S](#) [640179-1](#) [640917-2-CUT-TAPE](#) [6501550002](#) [66107-2-C](#) [696683-1](#) [696834-1](#) [696861-1](#) [696931-1](#) [696999-1](#) [M8-516RK](#) [M86700006](#) [MA250DMFMX-A](#) [701-2007](#) [701-2307](#) [701-7761-03](#) [70F-110-32-PB](#) [718-N-A](#) [71M-187-20-NBL](#) [71M-250-32-NBL](#) [72F-187-20-NBL](#) [72M-250-32-NBL](#) [7310](#) [73F-250-32](#) [73F-250-32-NBL](#) [73F-250-32-NL](#) [F14-10C](#) [F-1M](#) [751-250](#)