

THIS COPY IS PROVIDED ON A RESTRICTED BASIS AND IS NOT TO BE USED IN ANY WAY DETRIMENTAL TO THE INTERESTS OF PANDUIT CORP.

PANDUIT PART #	WIRE RANGE AWG [mm <sup>2</sup> ]	TAB SIZE in. [mm]	HOUSING COLOR	MAX WIRE INSUL DIA	DIMENSIONS in. [mm]			WIRE STRIP LENGTH in. [mm] +1/32 [0,8] -0	TOOLS
					L ± .04 [1,1]	W ± .01 [0,3]	M ± .02 [0,6]		
EDV18-187MB	#22-16 [0.5-1.5]	.187 X .032 [4.8 X 0.8]	RED	0.145 [3.7]	0.75 [19.0]	0.19 [4.8]	.39 [10.0]	9/32 [6.8]	KST2000C
EDV14-187MB	#16-14 [1.5-2.5]		BLUE	0.165 [4.2]	0.75 [19.0]	0.19 [4.8]	.39 [10.0]		

NOTES:

- UL LISTED FOR:
  - STRANDED COPPER WIRE ONLY - INTERNAL WIRING
  - 167°F (75°C) MAX TEMP RATING
  - 300V MAX VOLTAGE RATING
- MATERIAL:
  - STAMPING: .016" [0.4] THICK BRASS, TIN PLATED
  - HOUSING: VINYL
- SEE [www.panduit.com](http://www.panduit.com) FOR PACKAGE QUANTITIES
- DIMENSIONS IN BRACKETS ARE METRIC EQUIVALENT

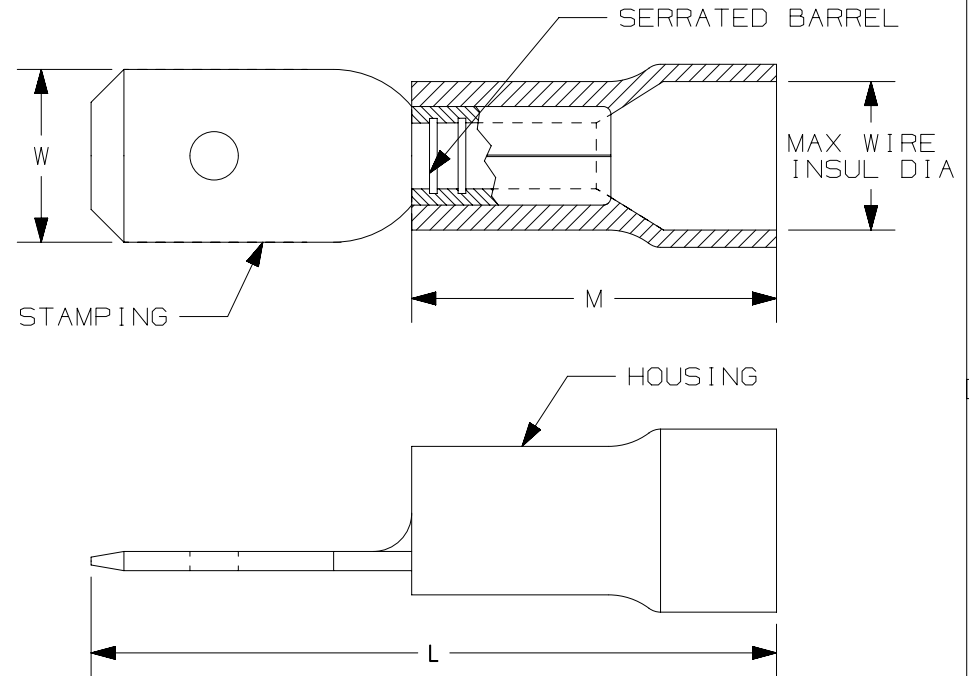

TITLE <b>STRONGHOLD MALE DISCONNECTS (187 SERIES) VINYL INSULATED #22-14 AWG</b>		CUSTOMER DRAWING	
ITEM REVISION NAME 00123SSN/00		<b>PANDUIT</b> <sup>TM</sup>	
DATASET FILE NAME 00123SSN_DC/00			
UNLESS OTHERWISE SPECIFIED, DIMENSIONAL TOLERANCES ARE: IN [mm]		MATERIAL: <b>SEE NOTES</b>	
.x ± .1 [2.54]      .xxx ± .005 [.127] .xx ± .01 [.25]      ANGLES ± 5 °		DRAWING NUMBER: 00123SSN-DC	
THIRD ANGLE PROJECTION			
DRAWN BY JHNU	DATE -	CHK RLS	SCALE N.T.S.
REV		SHEET 1 OF 1	
DESCRIPTION		SIZE A	

00	2/18	JHNU	TMR	RGB	DRAWING RELEASED	00123SS
REV	DATE	BY	CHK	APR	DESCRIPTION	ECN

D10100DA/12

## X-ON Electronics

Largest Supplier of Electrical and Electronic Components

*Click to view similar products for [Terminals](#) category:*

*Click to view products by [Panduit](#) manufacturer:*

Other Similar products are found below :

[HT-13-10](#) [71M-250-32-NB](#) [01-2065-1-0216](#) [00581P0075](#) [M10-10RX](#) [M10BCK](#) [60205-1](#) [604200-1](#) [60598-1-CUT-TAPE](#) [60617-1-C](#) [60873-1](#) [M14-516R/SK](#) [M14-6RSX](#) [M18-10FLX](#) [M18-8FBX](#) [M18-8R/LX](#) [M18BCK](#) [61314-6-C](#) [61-S](#) [61-SN-A](#) [62-NBM-A](#) [63-S](#) [640179-1](#) [640917-2-CUT-TAPE](#) [6501550002](#) [66107-2-C](#) [696683-1](#) [696834-1](#) [696861-1](#) [696931-1](#) [696999-1](#) [M8-516RK](#) [M86700006](#) [MA250DMFMX-A](#) [701-2007](#) [701-2307](#) [701-7761-03](#) [70F-110-32-PB](#) [718-N-A](#) [71M-187-20-NBL](#) [71M-250-32-NBL](#) [72F-187-20-NBL](#) [72M-250-32-NBL](#) [7310](#) [73F-250-32](#) [73F-250-32-NBL](#) [73F-250-32-NL](#) [F14-10C](#) [F-1M](#) [751-250](#)