

THIS IS ISSUED IN STRICT CONFIDENCE THAT IT IS NOT USED AS A BASIS FOR MANUFACTURE OR SALE AND THAT IT IS NOT COPIED, REPRINTED OR DISCLOSED TO A THIRD PARTY EITHER WHOLLY OR IN PART WITHOUT THE PRIOR WRITTEN CONSENT OF CAL TEST ELECTRONICS, INC.

REVISIONS			
REV.	DESCRIPTION	DATE	APPROVED
A	INITIAL RELEASE	11/15/2023	B. HANSEN

- NOTES:
- ALL SPECIFICATIONS SUBJECT TO CHANGE WITHOUT NOTICE.
 - CONNECTOR TO MEET OR EXCEED ALL SPECIFICATIONS PER MIL-PRF-39012
 - MATING DIMENSIONS IN ACCORDANCE WITH MIL-STD-348.
 - FREQUENCY RANGE SPECIFICATIONS ARE FOR REFERENCE AND ARE DEPENDENT ON APPLICATION SPECIFIC CONDITION.
 - MATERIAL:
 - BODY: BRASS, GOLD PLATED
 - CENTER CONTACT: BeCu, GOLD PLATED
 - DIELECTRIC: PTFE
 - ELECTRICAL:
 - IMPEDANCE: 50 Ω
 - FREQUENCY: DC - 18 GHz
 - WORKING VOLTAGE: 335 Vrms
 - INSULATION RESISTANCE: 5,000 MΩ
 - DIELECTRIC WITHSTAND VOLTAGE: 1,000 Vrms
 - MECHANICAL:
 - RECOMMENDED TORQUE: 0.3 Nm TO 0.6 Nm
 - TEMPERATURE RANGE: -55°C TO +165°C
 - RoHS AND REACH COMPLIANT.

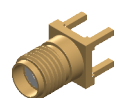
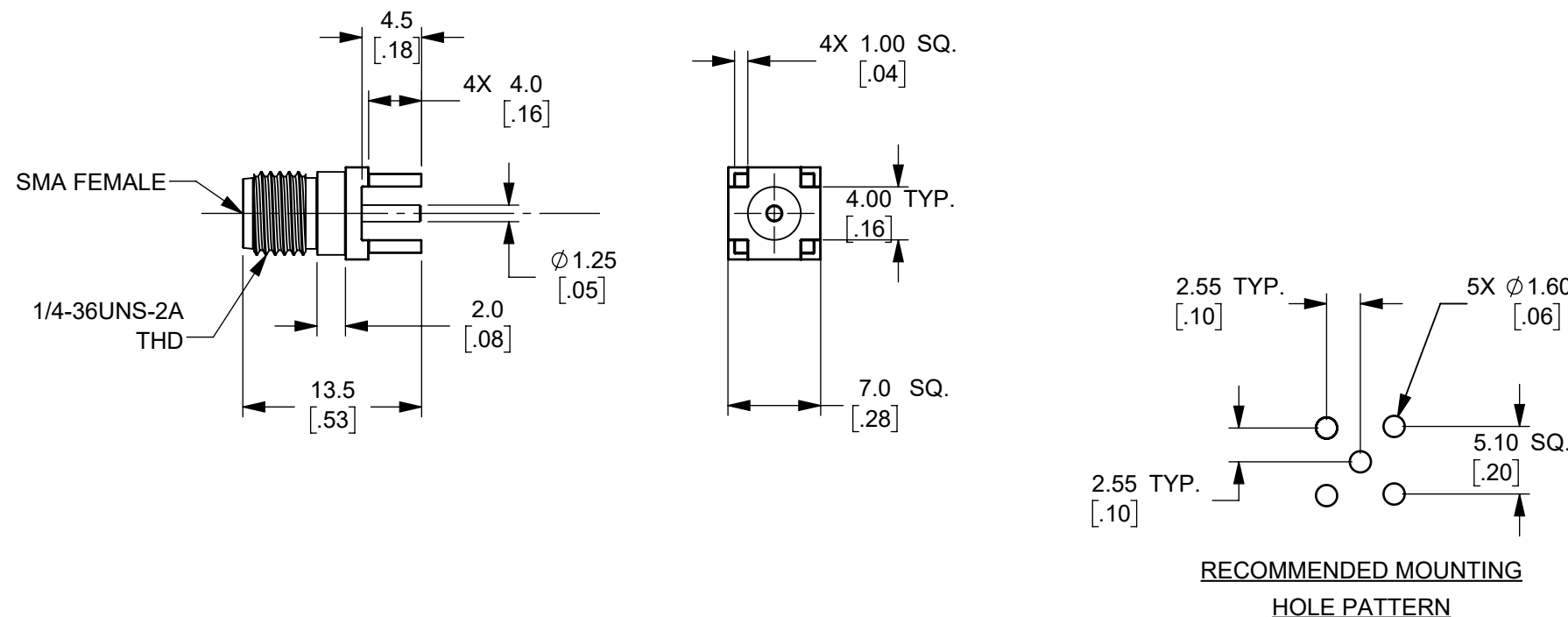

ISOMETRIC VIEW
FULL SCALE

THIRD ANGLE PROJECTION

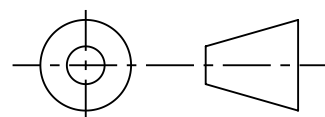

REFERENCE

CT4495	PCB MOUNT	IN-SERIES CONNECTOR	
MODEL NUMBER	CONFIGURATION	NOTES / REFERENCE	
MODEL NUMBER TABLE			
THIRD ANGLE PROJECTION UNLESS OTHERWISE SPECIFIED DIMENSIONS ARE IN MILLIMETERS TOLERANCES ARE: X.X = ±0.5 X.X* = ±0.5* X.XX = ±0.25 X.XXX = ±0.125 DO NOT SCALE DRAWING	PROJECT NO.	METRIC Cal Test 22820 Savi Ranch Prky. Yorba Linda, CA 92887 USA	
	APPROVALS	DATE	TITLE
	DRAWN GSG	9/5/2023	CONNECTOR, SMA FEMALE, PCB MOUNT, THROUGH-HOLE
	CHECKER B. HANSEN	9/5/2023	
MATERIAL SEE NOTES	ENGR. B. HANSEN	9/5/2023	SIZE B CAGE CODE 43F45 DWG. NO. CT4495 REV. A
TREATMENT NONE	DESIGN ACTIVITY	SCALE 2:1	SHEET 1 OF 1
FINISH SEE NOTES			

X-ON Electronics

Largest Supplier of Electrical and Electronic Components

Click to view similar products for [RF Connectors / Coaxial Connectors](#) category:

Click to view products by [Cal Test](#) manufacturer:

Other Similar products are found below :

[89674-0827](#) [6059674-1](#) [630059-000](#) [6501-1071-002](#) [6769](#) [7002-1541-010](#) [7002-1572-002](#) [7004-1512-000](#) [7009-1511-004](#) [7101-1541-010](#)
[7101-1571-002](#) [7105-1521-002](#) [7203-1571-003](#) [7209-1511-011](#) [7210-1511-040](#) [7242-1511-000](#) [7405-1521-005](#) [7405-1521-802](#)
[804S01D04M040](#) [8527](#) [8547](#) [FS11V](#) [877931](#) [8808-1511-001](#) [9049-9513-000](#) [9074-9513-000](#) [PL11C-026](#) [PL40-36](#) [9408-1113-000](#) [980-](#)
[8666-005](#) [11 SMA-50-2-6 / 111 NE](#) [11 SMA-50-3-6 / 111 NE](#) [1-201144-1](#) [120919](#) [R107003010W](#) [R112186000](#) [R113053000W](#) [R113082097](#)
[R113236000](#) [R114083000](#) [R114670000W](#) [R123415000W](#) [R124076320](#) [R124076450](#) [R124175123](#) [R125075000W](#) [R125075001](#)
[R125172000W](#) [R125415030](#) [R141007161](#)