

THIS IS ISSUED IN STRICT CONFIDENCE THAT IT IS NOT USED AS A BASIS FOR MANUFACTURE OR SALE AND THAT IT IS NOT COPIED, REPRINTED OR DISCLOSED TO A THIRD PARTY EITHER WHOLLY OR IN PART WITHOUT THE PRIOR WRITTEN CONSENT OF CAL TEST ELECTRONICS, INC.

REVISIONS			
REV.	DESCRIPTION	DATE	APPROVED
A	INITIAL RELEASE	11/15/2023	B. Hansen

**NOTES:**

- ALL SPECIFICATIONS SUBJECT TO CHANGE WITHOUT NOTICE.
- ADAPTER TO MEET OR EXCEED ALL SPECIFICATIONS PER MIL-PRF-39012.
- MATING DIMENSIONS IN ACCORDANCE WITH MIL-STD-348.
- FREQUENCY RANGE SPECIFICATIONS ARE FOR REFERENCE AND ARE DEPENDENT ON CABLE TYPE AND APPLICATION SPECIFIC CONDITIONS.
- MATERIAL:
  - BODY: BRASS, NICKEL PLATED
  - CENTER CONTACT: BRASS, GOLD PLATED
  - SLEEVE: BRASS, NICKEL PLATED
  - DIELECTRIC: DELRIN
- ELECTRICAL:
  - IMPEDANCE: 50Ω
  - FREQUENCY: DC - 2 GHz
  - WORKING VOLTAGE: 500 Vrms
- CABLE TYPE:
  - THE CT4514 IS INTENDED TO BE USED WITH THE FOLLOWING TYPES OF CABLE:
    - RG-58
- ASSEMBLY INSTRUCTIONS ON SHEET 2 OF 2.
- MECHANICAL:
  - TEMPERATURE RANGE: -20°C TO +80°C
- RoHS AND REACH COMPLIANT

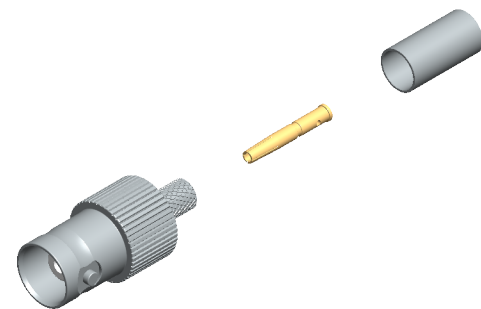
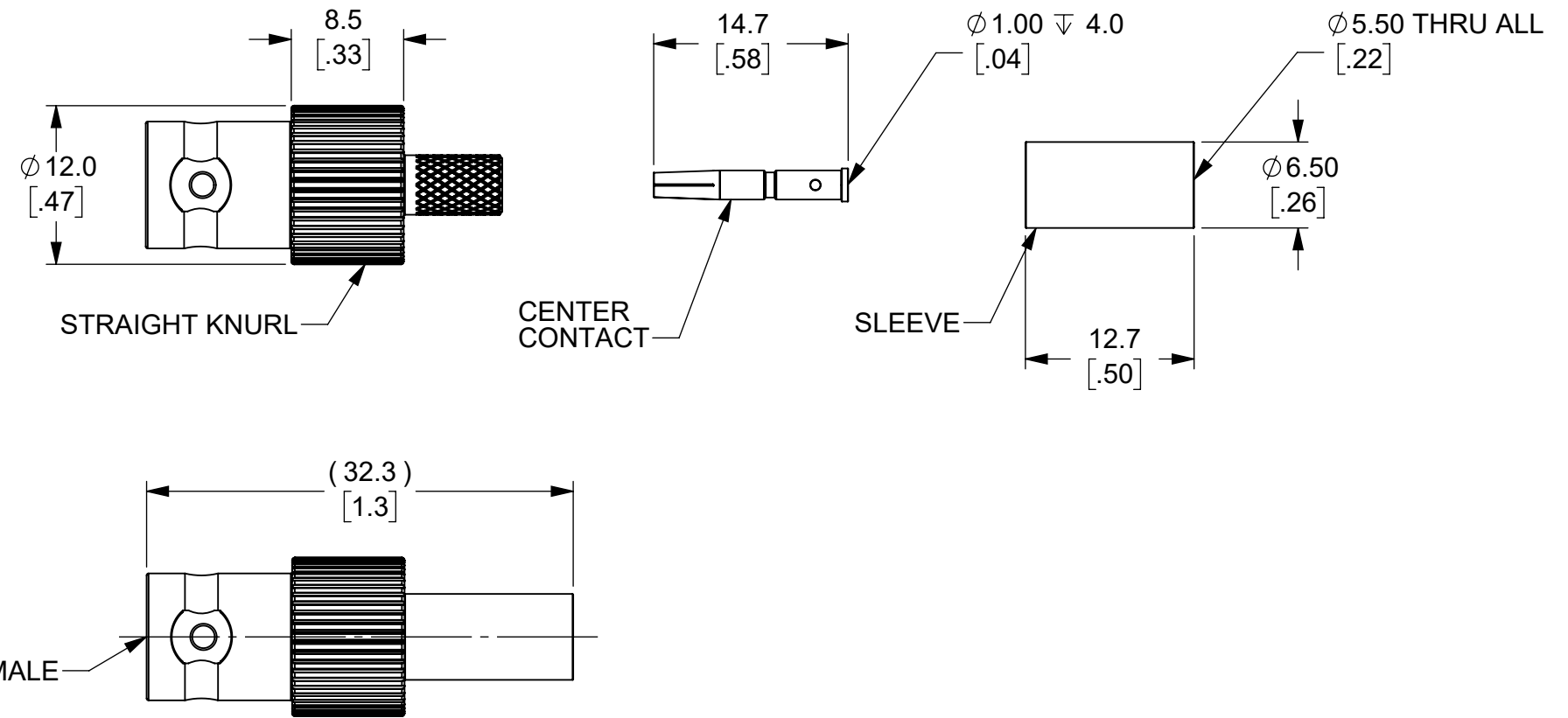

ISOMETRIC VIEW  
FULL SCALE

CT4514	CONNECTOR, CRIMP	IN-SERIES CONNECTOR	
MODEL NUMBER	CONFIGURATION	NOTES / REFERENCE	
MODEL NUMBER TABLE			
THIRD ANGLE PROJECTION 	UNLESS OTHERWISE SPECIFIED DIMENSIONS ARE IN MILLIMETERS TOLERANCES ARE: X.X = ±0.5    X.X* = ±0.5* X.XX = ±0.25 X.XXX = ±0.125 DO NOT SCALE DRAWING		PROJECT NO. TITLE <b>METRIC</b> <b>Cal Test</b> 22820 Savi Ranch Prky. Yorba Linda, CA 92887 USA
	MATERIAL SEE NOTES	APPROVALS DRAWN GSG CHECKER B. HANSEN	DATE 11/7/2023 11/7/2023
TREATMENT NONE	ENGR. B. HANSEN	11/7/2023	SIZE <b>B</b>
FINISH SEE NOTES	DESIGN ACTIVITY	CAGE CODE <b>43F45</b>	DWG. NO. <b>CT4514</b>
		SCALE <b>2:1</b>	REV. <b>A</b>
			SHEET 1 OF 2

THIS IS ISSUED IN STRICT CONFIDENCE THAT IT IS NOT USED AS A BASIS FOR MANUFACTURE OR SALE AND THAT IT IS NOT COPIED, REPRINTED OR DISCLOSED TO A THIRD PARTY EITHER WHOLLY OR IN PART WITHOUT THE PRIOR WRITTEN CONSENT OF CAL TEST ELECTRONICS, INC.

**ASSEMBLY INSTRUCTIONS:**

1. SLIDE CRIMP SLEEVE ONTO CABLE JACKET
2. STRIP COAXIAL CABLE END 
3. INSERT CENTER CONDUCTOR INTO CONTACT HOLE DIAMETER
4. SOLDER CONTACT TO CENTER CONDUCTOR FOR BETTER PERFORMANCE
5. FLARE THE OUTER CONDUCTOR BRAID
6. INSERT CONTACT PIN FIRMLY INTO THE BNC CONNECTOR UNTIL IT SNAPS INTO POSITION
7. ENSURE THE OUTER CONDUCTOR BRAID SEATS PROPERLY AND UNIFORMLY AROUND THE OUTER SURFACE OF THE BNC CRIMP POST
8. SLIDE SLEEVE OVER BRAID AND POST
9. CRIMP SLEEVE TO THE BNC CRIMP POST USING THE APPROPRIATE CRIMPING TOOL

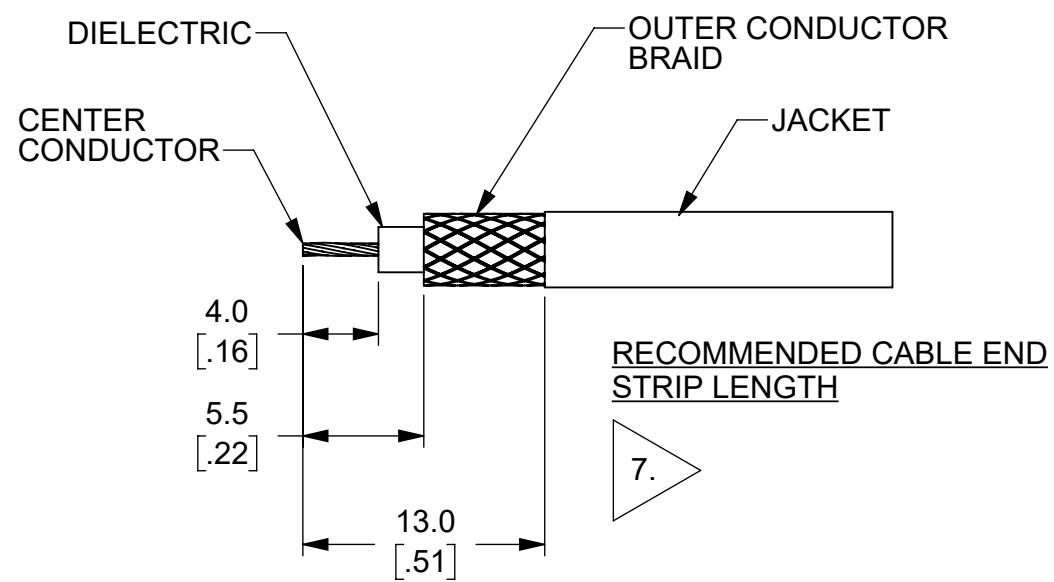
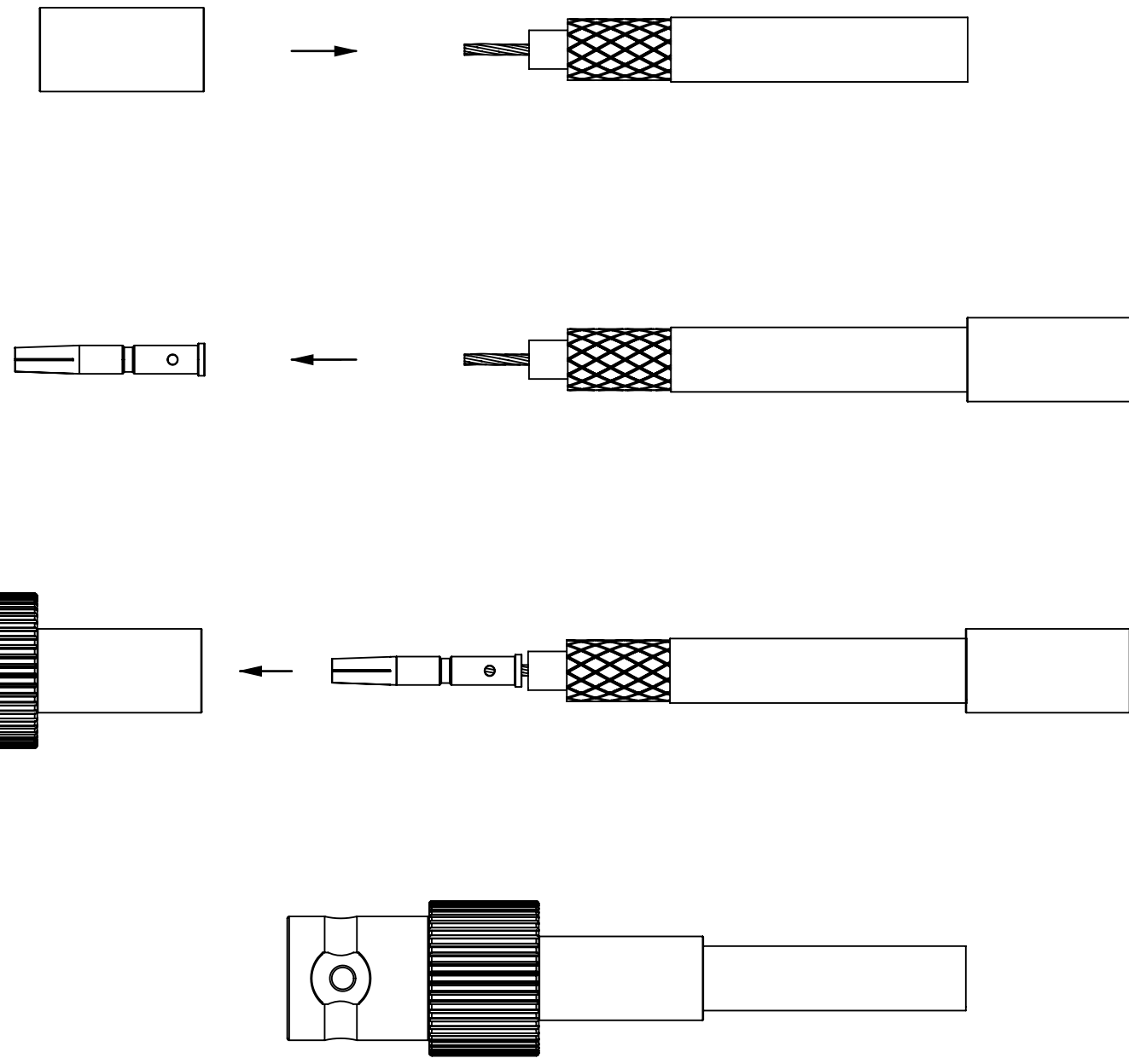

<b>METRIC</b>	APPROVALS	DATE	SIZE	CAGE CODE	DWG. NO.	REV.
	DRAWN GSG	11/7/2023	<b>B</b>	<b>43F45</b>	<b>CT4514</b>	<b>A</b>
	CHECKER B. HANSEN	11/7/2023	SCALE 2:1	SHEET 2 OF 2		

## X-ON Electronics

Largest Supplier of Electrical and Electronic Components

*Click to view similar products for [RF Connectors / Coaxial Connectors](#) category:*

*Click to view products by [Cal Test](#) manufacturer:*

Other Similar products are found below :

[89674-0827](#) [6059674-1](#) [630059-000](#) [6501-1071-002](#) [6769](#) [7002-1541-010](#) [7002-1572-002](#) [7004-1512-000](#) [7009-1511-004](#) [7101-1541-010](#)  
[7101-1571-002](#) [7105-1521-002](#) [7203-1571-003](#) [7209-1511-011](#) [7210-1511-040](#) [7242-1511-000](#) [7405-1521-005](#) [7405-1521-802](#)  
[804S01D04M040](#) [8527](#) [8547](#) [FS11V](#) [877931](#) [8808-1511-001](#) [9049-9513-000](#) [9074-9513-000](#) [PL11C-026](#) [PL40-36](#) [9408-1113-000](#) [980-](#)  
[8666-005](#) [11 SMA-50-2-6 / 111 NE](#) [11 SMA-50-3-6 / 111 NE](#) [1-201144-1](#) [120919](#) [R107003010W](#) [R112186000](#) [R113053000W](#) [R113082097](#)  
[R113236000](#) [R114083000](#) [R114670000W](#) [R123415000W](#) [R124076320](#) [R124076450](#) [R124175123](#) [R125075000W](#) [R125075001](#)  
[R125172000W](#) [R125415030](#) [R141007161](#)