

# 承 認 書

Specification for approval

客戶名稱：  
Customer 立创电子

產品名稱：  
Description: DB-9P 公 传统焊线式 兰胶

客戶料號：  
Customer part no: C138805

燦科盟產品編號：  
CKM P/N: DB0009PM000XH00

承認書編號：  
Approval sheet NO.: SA150431719

承認日期：  
Approval date: 2017-11-17

|                              |                 |                 |                                  |
|------------------------------|-----------------|-----------------|----------------------------------|
| 客戶確認<br>CUSTOMER<br>APPROVED | 核 准<br>APPROVED | 審 核<br>ENGINEER | 經 辦<br>CHECK<br>刘力<br>2017/11/17 |
|                              |                 |                 |                                  |

敬請蓋印承認規格之後，將一份交回給本公司，謝謝!

Please return 1sets of this form to confirm your approval of the product specification thank you!

## 深圳市燦科盟實業有限公司

工廠地址：深圳市光明樓村鲤鱼水工業區鑫博盛科技園 B 棟四樓

聯繫電話：0755-81488157 28154692 13316859588

傳 真：0755-83425987

Http://www.Ckmtw.com.cn

E-mail:2000@ckmtw.com.cn

業務負責人：\_\_\_\_\_

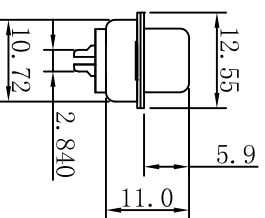
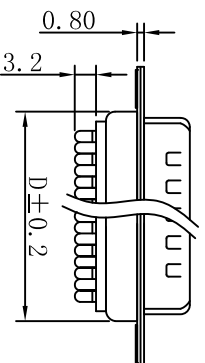
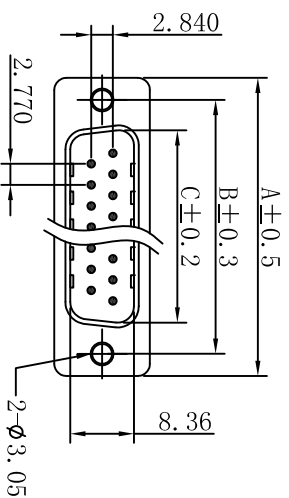

| POLES | PART No. | Dim. A | Dim. B | Dim. C | Dim. D |
|-------|----------|--------|--------|--------|--------|
| 9     | DB-9P    | 30.81  | 24.99  | 16.92  | 19.25  |
| 15    | DB-15P   | 39.14  | 33.32  | 25.25  | 27.51  |
| 25    | DB-25P   | 53.04  | 47.04  | 38.96  | 41.20  |
| 37    | DB-37P   | 69.40  | 63.50  | 55.42  | 57.71  |

**MATERIAL & FINISHES**

INSULATOR - PBT GLASS FILLED UL94V-0  
 CONTACT- BRASS OR PHOSPHOR BRONZE  
 SHELL - STEEL  
 PLATING - CONTACT  
 SELECTIVE GOLD OVER NICKEL PLATED(CONTACT AREA)  
 TIN/LEAD OVER NICKEL PLATED(TAIL AREA)  
 - SHELL  
 TIN OR ZINC OVER COPPER PLATED

**ELECTRICAL CHARACTERISTICS**

CURRENT RATING : 3A  
 CONTACT RESISTANCE : 20mΩ MAX  
 INSULATION RESISTANCE : 1000MΩ AC 500V  
 DIELECTRIC VOLTAGE : 500V /MIN  
 OPERATING TEMPERATURE : -55°C TO+105°C

**TOLERANCE TABLE**

| Dimension | Tolerance |
|-----------|-----------|
| .0        | ±0.30     |
| .00       | ±0.20     |
| .000      | ±0.05     |

APPROVED: DATE:

CHECKED: DATE:

DRAWN: DATE:

LYP 2009-11-28

**Ckmtw** 深圳市灿科盟实业有限公司  
 CHANKLEMENT INDUSTRYCO., LTD

TITLE: DB-XP 公头 焊线 传统式

| P/N           | UNIT  | SCALE | REV. |
|---------------|-------|-------|------|
| /             | mm    | Free  | A    |
| FILE NO.      | SCALE | REV.  | HX00 |
| Ckmtw-DB-0002 | Free  | A     |      |

# 深圳市灿科盟实业有限公司

## DB SERIES

内容：此规格书包含 DB 接插件系列。

Scope: This specification covers the DB spacing Connector series.

| Index:   | Page |
|--|------|
| 1. 产品名称及料号/Product name and part number              | 2    |
| 2. 额定电压电流/Ratings                                    | 2    |
| 3. 特性测试/Performance                                  |      |
| 3-1.电气特性/Electrical performance                      | 2    |
| 3-1-1.接触阻抗/Contact resistance                        | 2    |
| 3-1-2.绝缘阻抗/Insulation resistance                     | 2    |
| 3-1-3.高压测试/Dielectric strength                       | 2    |
| 3-2.机械特性/Mechanical performance                      |      |
| 3-2-1.整组插拔测试/Insertion force and withdrawal force    | 2    |
| 3-2-2.插入力/Insertion force                            | 2    |
| 3-2-3.拔入力/withdrawal force                           | 2    |
| 3-3.环境特性测试/Environmental performance and others      |      |
| 3-3-1.整组插拔测试后接触阻抗/Repeated insertion/withdrawal      | 3    |
| 3-3-2.温升测试/Temperature rise                          | 3    |
| 3-3-3.震动测试/Vibration                                 | 3    |
| 3-3-4.冲击测试/Shock                                     | 3    |
| 3-3-5.耐热测试/Heat resistance                           | 3    |
| 3-3-6.低温测试/Cold resistance                           | 3    |
| 3-3-7.恒温恒湿/Humidity                                  | 3    |
| 3-3-8.温度冲击测试/Temperature cycling                     | 3    |
| 3-3-9.盐水喷雾测试/Salt spray                              | 3    |
| 3-3-10.沾锡性测试/Solderability                           | 4    |
| 3-3-11.焊热性测试/Resistance to soldering heat            | 4    |
| 3-3-12 寿命测试/Life Test                                | 4    |
| 4. 产品规格尺寸及材质/Product shape, dimensions and materials | 4    |

Note::以上测试视公司之测试条件/能力而定。

|          |          |          |       |         |
|----------|----------|----------|-------|---------|
| FILE NO  | ENS014   | APPROVAL | CHECK | DRAWING |
| ECR/N NO | New spec |          |       |         |

## 1. 产品名称及料号/Product name and part number

|              |                              |
|--------------|------------------------------|
| Product Name | Part Number                  |
| Name 名称      | DMS-XP MALE<br>DMS-XP FEMAEL |

## 2. 额定电压电流及使用线径/Ratings and applicable wires

|                              |                 |
|------------------------------|-----------------|
| ITEM                         | STANDARD        |
| Rated Voltage(Max) 额定电压 (最高) | 250V DC/AC(rms) |
| Rated Current(Max) 额定电流 (最高) | 3A              |
| Ambient Temperature 使用温度范围   | -50°C-+105°C    |
|                              |                 |

## 3. 特性测试/Performance

### 3-1. 电气特性/Electrical performance

| ITEM                                   | Test condition  | Requirement                               |
|--|---|---|
| 3-1-1<br>Contact Resistance<br>接触阻抗    | Mate connectors, reassure by dry circuit ,20mV MAX,10mv.(Based upon JIS C5402 5.4)<br>将公母对插, 二头接上微电流电压测试。   | 0.02 欧 (MAX)                              |
| 3-1-2<br>Insulation resistance<br>绝缘阻抗 | Mate connectors, apply 500V DC between adjacent terminal or ground. (Based upon JIS C5402 5.2/MIL-STD-202 method 302 condition B)<br>将公母对插, 二头接上电压测试      | 1000 兆欧 (MIN)                             |
| 3-1-3<br>Dielectric strength<br>高压测试   | Mate connectors, apply 500V AC for 1 minute between adjacent terminal or ground. (Based upon JIS C5402 5.1/MIL-ST-202 Method 301)<br>将公母对插, 相邻的二支端子接上高压测试 | No breakdown and flashover<br>没有损坏/没有电弧产生 |

### 3-2. 机械特性/Mechanical performance

| ITEM  | Test condition   | Requirement   |
|---|--|---------------|
| 3-2-1<br>Insertion force and withdrawal force<br>整组插拔测试 | Insert and withdraw connectors at the speed rate of 25±3mm/minute<br>公母对插插拔 30 次, 机器行走速度 25±3mm/分钟。                            | 1.5 KgN (MIN) |
| 3-2-1<br>Insertion force<br>插入力                         | Insert the crimped terminal into the connectors<br>将公头插入母座内, 测试插入值   | 2.5Kg (MAX)   |
| 3-2-4<br>withdrawal force<br>拔入力                        | Apply axial pull out force at the speed rate of 25±3mm/minute on the terminal assembled<br>In the housing.<br>将公头从母座中拔出, 测试拔出值 | 1.0Kg (MIN)   |
|   |  |               |

### 3-3.环境特性测试/Environmental performance and others

| ITEM   |                                | Test condition  | Requirement                |               |
|--------|--------------------------------|---|----------------------------|---------------|
| 3-3-1  | Repeated insertion/ withdrawal | When mated up to 30 cycles repeatedly by the rate of 10 cycles per minute<br>三十次插拔后，测量接触阻抗  | Contact Resistance<br>接触阻抗 | 40mΩ<br>MAX   |
| 3-3-2. | Temperature Rise 温升            | Carrying rated current load(Based upon UL1977)<br>针对额定电流以作测试  |                            | 30℃<br>MAX    |
| 3-3-3  | Vibration 震动测试                 | Amplitude:1.52mm P.P –调幅<br>Sweep time:10-55-10Hz in 1 minute 频率<br>Duration:2 hours in each X.Y.Z axlals 震动时间<br>(based upon MIL-STD-202 method 201)           | Appearance                 | No Damage     |
|        |                                |   | Contact Resistance         | 40mΩ<br>MAX   |
|        |                                |   | Discontinuity 不连续性         | 1u sec<br>MAX |
| 3-3-4  | Shock 冲击测试                     | 50g 3strokes in each X.Y.Z. axlals.<br>(based upon JIS C0041)<br>50g 力量，XYZ 轴分别三次冲击。  | Appearance                 | No Damage     |
|        |                                |   | Contact Resistance         | 40mΩ<br>MAX   |
|        |                                |   | Discontinuity 不连续性         | 1u sec<br>MAX |
| 3-3-5  | Heat Resistance 耐热测试           | 105±3℃, 96hours<br>(based upon JIS C5402 7.8)<br>时间 96 小时，温度 85±3℃  | Appearance                 | No Damage     |
|        |                                |   | Contact Resistance         | 40mΩ<br>MAX   |
| 3-3-6  | Cold Resistance 低温测试           | -50±3℃, 96hours<br>(based upon JIS C5402 7.9)<br>时间 96 小时，温度 -20±3℃   | Appearance                 | No Damage     |
|        |                                |   | Contact Resistance         | 40mΩ<br>MAX   |
| 3-3-7  | Humidity 恒温恒湿测试                | Temperature:40±2℃, Relative humidity:90~95%(RH)<br>(Based upon MIL-STD-202 Method 103B conditions.B)<br>温度 40±2℃，湿度 90~95%，时间 96 小时。                            | Appearance                 | No Damage     |
|        |                                |   | Contact Resistance         | 40mΩ<br>MAX   |
|        |                                |   | Dielectric strength        | 没有损坏/没有电弧产生   |
| 3-3-8  | Temperature cycling 温度冲击测试     | 5 cycles:<br>1>.-50℃ 30 minutes.<br>2>.+105℃ 30 minutes.<br>3>.+25℃ 30 minutes.<br>4>.+65℃ 30 minutes   | Appearance                 | No Damage     |
|        |                                |   | Contact Resistance         | 40mΩ<br>MAX   |
| 3-3-9  | Salt spray 盐水测试                | 12 hours exposure to a salt spray from the 5±1% solution at 35±2℃. (Based upon JIS C5402/MIL-STD-202method 101D conditions. B)<br>时间 12 小时，盐水体比例 5±1%，温度 35±2℃。 | Appearance                 | No Damage     |
|        |                                |   | Contact Resistance         | 40mΩ<br>MAX   |

|        |   |  |                        |
|--------|---|--|------------------------|
| 3-3-10 | Solderability<br>沾锡性<br>测试                | Soldering time: $3 \pm 0.5$ sec,<br>solder temperature: $230 \pm 5^{\circ}\text{C}$<br>时间: $3 \pm 0.5$ 秒,<br>温度: $230 \pm 5^{\circ}\text{C}$ | 95%以上沾锡面积              |
| 3-3-11 | Resistance to soldering heat<br>焊热性<br>测试 | Soldering time: $5 \pm 1$ sec,<br>solder temperature: $260 \pm 5^{\circ}\text{C}$<br>时间: $5 \pm 1$ 秒,<br>温度: $230 \pm 5^{\circ}\text{C}$     | No Damage<br>外观没有影响    |
| 3-3-12 | Life Test<br>寿命测试                         | 5000 cycles<br>5000 次  | No Damage<br>外观,功能没有影响 |

#### 4. 产品规格尺寸及材质/Product shape, dimensions and materials

(见附件图纸)

## X-ON Electronics

Largest Supplier of Electrical and Electronic Components

*Click to view similar products for [D-Sub Standard Connectors](#) category:*

*Click to view products by [Cankemeng](#) manufacturer:*

Other Similar products are found below :

[DCM37S732N](#) [DAM15P500](#) [DEV09S364GTLF](#) [DEM09P032N](#) [DDM50P732N](#) [DAM15S332N](#) [173109-2218](#) [173109-2466](#) [173109-2436](#)  
[173109-2435](#) [56F706-005-LI](#) [56F711-015](#) [015-0341-000](#) [015-0372-008](#) [015-8544-011](#) [017041-0005](#) [020419-0104](#) [012-0515-000](#) [012-9507-](#)  
[034](#) [012-9507-114](#) [012-9534-001](#) [020745-0008](#) [609-25P](#) [M24308/2-23Z](#) [M243082310F](#) [M243082410F](#) [M243082411F](#) [M24308/4-21](#)  
[CT1A18-11PSA206](#) [CT1N36-5SC](#) [CT2-16S-17PS](#) [CT2-20-15PCAU](#) [CT2-24-12PS](#) [CT2-24-28PSF127A206](#) [CT2-32-9PC](#) [CT6F9767-14-4-](#)  
[14S-5PC](#) [CT6FA10SL-4PS](#) [CT7-18-10SC](#) [CT7-18-10SCAU](#) [CT7-18-12SCAU](#) [CT7-18-1PC](#) [CT7-18-1PCAU](#) [CT7-18-21SCAU](#) [M83513/01-](#)  
[FC](#) [M83723/76W24619 L/C](#) [M85049/48-3-2F](#) [69001-865](#) [6STD09PCM99B70X](#) [6STD09SCM99B30X](#) [6STD09SCT99S40X](#)