

正针板
Positive-needle circuit board

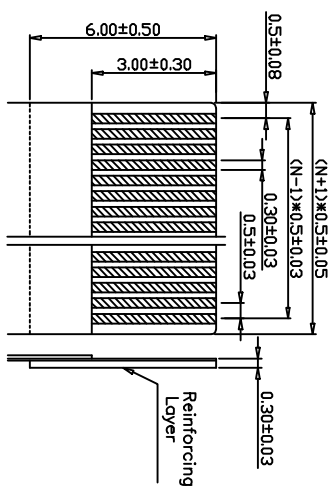
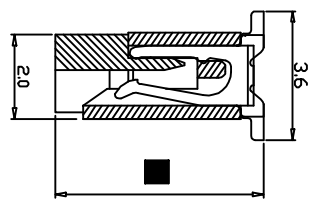
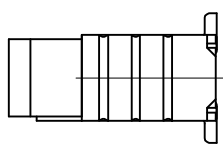

RECOMMENDED FCC/FPC DIM.

Electrical Characteristics:

- Current rating: 0.4A AC/DC
 - Voltage rating: 50V AC/DC
 - Temperature range: -25°C~+85°C
 - Withstand Voltage: 200V AC/Minute
 - Contact Resistance: ≤ 20mΩ
 - Insulation resistance: ≥ 500MΩ
 - Relative Humidity: 93%~40°C
- Material Description:
- Terminal: Phosphor Bronze Tin-Leadplated
 - Fitting Nail: Brass Tin-plated
 - Housing: Thermoplastic(U194V-0)
 - Slider: Thermoplastic(U194V-0)
 - Poles: 4~60P

- 注: 尺寸
- 4PIn~29PIn: 4.70mm
 - 30PIn~39PIn: 4.80mm
 - 40PIn~60PIn: 4.90mm

TOLERANCE TABLE

.0	±0.30
.00	±0.20
.000	±0.05

APPROVED: DATE:

CHECKED: DATE:

DRAWN: DATE:

LYP 2011-01-13

深圳市灿科盟实业有限公司
CANTON GRANKLEMENT INDUSTRY CO., LTD

TITLE: FPC0.5-16P 立贴 带锁 正脚位

PART. NO. C3025534

UNIT	mm	SCALE	free	REV.	B	JMK00
FILE NO.	F-FPC0N16P-D310					

X-ON Electronics

Largest Supplier of Electrical and Electronic Components

Click to view similar products for [FFC & FPC Connectors](#) category:

Click to view products by [Cankemeng](#) manufacturer:

Other Similar products are found below :

[00-6200-227-022-800](#) [006205250500825+](#) [006205280500825+](#) [FPH-1602G](#) [086222026001800](#) [52610-0675](#) [62674-201121DLF](#) [52746-1671-TR250](#) [10051922-1610EHLF](#) [10051922-2810EHLF](#) [686322124422](#) [XF3M-2915-1B-R100](#) [AYF353125A](#) [AYF530665TA](#) [AYF534065TA](#) [20FLH-RSM1-TB](#) [207356-1](#) [SFW12R-5STE9LF](#) [SFW18R-1STAE9LF](#) [SFW4R-5STE9LF](#) [52807-0430](#) [046283021002868+](#) [FFC05011-10SBB114W5M](#) [502250-8027](#) [67000-008LF](#) [200528-0260](#) [FH28K-10S-0.5SH](#) [FH52K-6S-0.5SH](#) [0.5K-DX-30PWB](#) [DS1020-08-10VBT12](#) [THD0515-34CL-GF](#) [X05A10L28G](#) [ECC2841061EU](#) [1.0K-DHQX-16PWB](#) [1.0K-DHQX-30PWB](#) [1775333-6](#) [10054365-202110ELF](#) [10054365-242110ELF](#) [10054365-282110ELF](#) [10064555-392220HLF](#) [59453-041110EBHLF](#) [59453-091110EDHLF](#) [62674-241141ALF](#) [62684-432100ALF](#) [62684-451100AHLF](#) [62684-5721N0ALF](#) [HFW11R-1STE1MTLF](#) [HFW12R-1STE9LF](#) [HFW14R-1STE9MTLF](#) [HFW18S-2STE9LF](#)