



4PM-Series Sub-Miniature Slide Switches for PC Board

Specifications

Contact Rating refer to ordering scheme
 Electrical Life 10,000 make & break cycles @ full load
 Contact Resistance. 10 mΩ max.
 Insulation Resistance 1000 MΩ min. @500 VDC
 Mechanical Life 20,000 cycles
 Operating Temperature . . . -30°C to +85°C
 Solder Heat Resistance. . . MIL-STD-202, Method 210
 Actuator Travel 25°

Materials

Case & Slide Handle. PBT, Glass filled
 Housing. POM
 Terminal Seal Epoxy

4PM-Series Ordering Scheme

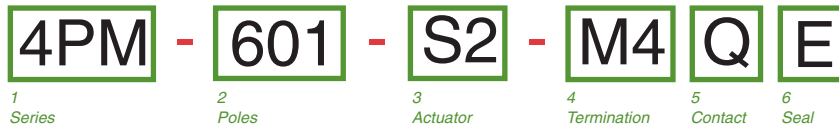

1 SERIES
 4PM Sub-Miniature Slide Switch

2 POLES

		Switching Position:		
		2-1, 5-4	OPEN	2-3, 5-6
601	single pole	ON	NONE	ON
602	double pole	ON	NONE	ON

3 ACTUATOR
 S1 flush slider S2 high slider S3 side slider

4 TERMINATION
 M1 narrow pitch single pole M3 wide pitch single pole
 M2 narrow pitch double pole M4 wide pitch double pole

5 CONTACT

	Material	Terminal Plating	Rating
Q	silver ¹	silver ¹	2A@250VAC
R	gold ²	gold ²	0.1A@30VDC

1 Moveable contact & terminals: copper alloy, silver plated
 2 Moveable contact & terminals: copper alloy with gold plate over nickel plate

6 EPOXY SEAL
 E epoxy seal

4PM-Series Dimensional Specifications: in. [mm]

ACTUATOR

S1 Flush Slider

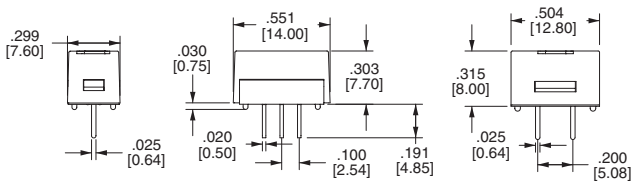

S2 High Slider

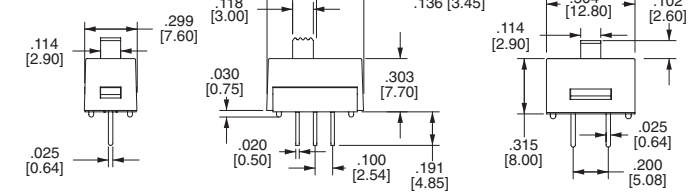

S3 Side Slider

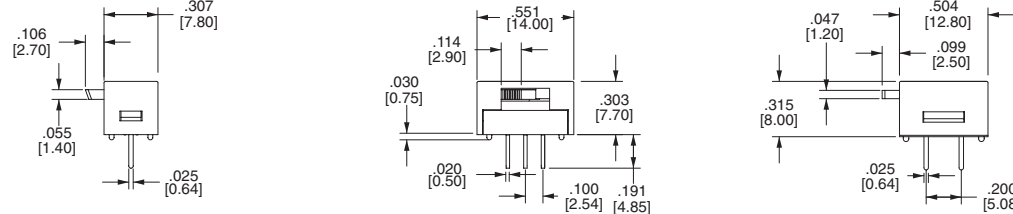

TERMINATION

M1 SINGLE POLE

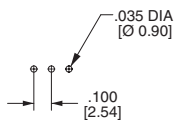

M2 DOUBLE POLE

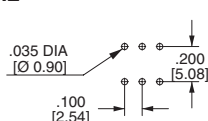

M3 SINGLE POLE

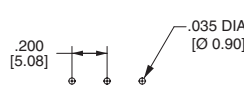

M4 DOUBLE POLE

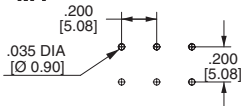

X-ON Electronics

Largest Supplier of Electrical and Electronic Components

Click to view similar products for [carling manufacturer](#):

Other Similar products are found below :

[2FAA01-73-XG](#) [LTA101-TR-B-R/125N](#) [LTI LA60-1L-BL-RC-A/125N](#) [LTILB51-6S-BL-AM-NBL/6V](#) [62111922-0-0-N](#) [62115919-E-0-V](#)
[CT1-X0-04-185-321-C](#) [6GM5L-NWH3](#) [MA1-B-74-410-1-A25-2-M](#) [MD1-B-24-615-1-A36-B-D](#) [MD1-B-34-615-3-A15-B-C](#) [ME1-B-32-410-1-A14-2-E](#) [ME1-B-32-420-1-A14-2-E](#) [ME1-B-32-430-1-A14-2-E](#) [MF2-B-34-620-1-BF4-B-C](#) [MF2-B-92-625-2-CC2-B-C](#) [MF2-B-94-475-1-HC4-2-C](#) [MG1-B-30-440-1-EE2-B-C](#) [MG1-B-32-410-3-JF1-7-C](#) [MG1-B-32-480-3-JF1-7-C](#) [MG1-B-32-490-3-MF1-7-C](#) [MG1-B-32-610-3-FF1-7-C](#) [MG1-B-32-615-3-FF1-7-C](#) [MG1-B-32-625-3-FF1-7-C](#) [MG1-B-32-625-3-JF1-7-C](#) [800931-004](#) [MM1-B-34-450-1-2AA-B-C](#) [GA2-B0-14-650-1D-MG](#) [A11-B0-34-615-131-E](#) [A12-B0-34-615-131-E](#) [A12-B0-34-620-131-E](#) [A33-A0-03-650-22A-E](#) [AA1-B0-10-250-2D1-C](#) [AA1-B0-14-425-2G1-C](#) [AA1-B0-22-615-1B1-C](#) [AA1-B0-34-430-3B1-C](#) [AA1-B0-34-450-3B1-C](#) [AA2-B0-22-630-1B2-C](#) [AA2-B0-34-630-3G1-C](#) [AA3-B0-24-450-1B1-C](#) [AB2-B0-22-475-4D1-C](#) [AB2-B0-34-620-3B1-C](#) [AB3-X0-00-159-3B1-C](#) [AC1-B0-24-450-1F2-C](#) [AC1-B0-34-610-231-D](#) [AC1-B0-34-620-3B1-C](#) [AC1-X0-04-239-5H3-D](#) [AC2-B0-34-610-133-D](#) [AC2-B0-34-620-131-D](#) [RA211-RB-B-E-N](#)