

4S1 & 4SS-Series

Sub-Miniature & **Sealed** Sub-Miniature Slide Switches

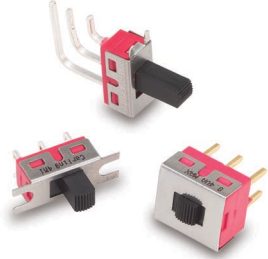

4M1-Series

Miniature Slide Switch

Specifications

Contact Rating refer to ordering scheme
 Electrical Life 30,000 make & break cycles at full load
 Contact Resistance. 10 mΩ max. initial @ 2-4 VDC
 100mA for both silver & gold plated contacts.
 Insulation Resistance 1000 MΩ min.
 Dielectric Strength 1500 Volts RMS @ sea level
 Operating Temperature . . . -30°C to +85°C
 Solder Heat Resistance. . . MIL-STD-202, Method 210
 Actuator Travel 25°

Materials

Case Dially phthalate (DAP) (UL 94V-0)
 Slide Handle. Nylon
 Housing. Stainless Steel
 Terminal Seal Epoxy

4S1-Series Ordering Scheme



1 SERIES 4S1 Sub-Miniature Slide Switch																
2 POLES FSP single pole																
3 CIRCUIT <table style="width: 100%; border-collapse: collapse;"> <tr> <td colspan="4" style="text-align: center;">Switching Position:</td> </tr> <tr> <td style="width: 10%;"></td> <td style="width: 15%;">2-1</td> <td style="width: 20%;">OPEN</td> <td style="width: 15%;">2-3</td> </tr> <tr> <td style="text-align: center;">1</td> <td>ON</td> <td>NONE</td> <td>ON</td> </tr> <tr> <td style="text-align: center;">3</td> <td>ON</td> <td>OFF</td> <td>ON</td> </tr> </table>	Switching Position:					2-1	OPEN	2-3	1	ON	NONE	ON	3	ON	OFF	ON
Switching Position:																
	2-1	OPEN	2-3													
1	ON	NONE	ON													
3	ON	OFF	ON													
4 TERMINATION M2 PCB M6 PC Mount, 90° horizontal																

5 CONTACT														
	<i>Material</i>	<i>Terminal Plating</i>												
G	silver ¹	gold over silver ³												
K	gold ²	tin-lead ⁴												
P	silver ¹	tin-lead ⁴												
Q	silver ¹	silver ¹												
R	gold ²	gold ²												
<table style="width: 100%; border-collapse: collapse;"> <tr> <td style="width: 15%;"></td> <td style="width: 15%;"><i>Rating</i></td> </tr> <tr> <td style="padding: 5px;">3A</td> <td style="padding: 5px;">@ 125VAC or 28VDC; 1.5A @ 250VAC</td> </tr> <tr> <td style="padding: 5px;">0.4VA</td> <td style="padding: 5px;">max. @ 20V max (AC/DC)</td> </tr> <tr> <td style="padding: 5px;">3A</td> <td style="padding: 5px;">@ 125VAC or 28VDC; 1.5A @ 250VAC</td> </tr> <tr> <td style="padding: 5px;">3A</td> <td style="padding: 5px;">@ 125VAC or 28VDC; 1.5A @ 250VAC</td> </tr> <tr> <td style="padding: 5px;">0.4VA</td> <td style="padding: 5px;">max. @ 20V max (AC/DC)</td> </tr> </table>				<i>Rating</i>	3A	@ 125VAC or 28VDC; 1.5A @ 250VAC	0.4VA	max. @ 20V max (AC/DC)	3A	@ 125VAC or 28VDC; 1.5A @ 250VAC	3A	@ 125VAC or 28VDC; 1.5A @ 250VAC	0.4VA	max. @ 20V max (AC/DC)
	<i>Rating</i>													
3A	@ 125VAC or 28VDC; 1.5A @ 250VAC													
0.4VA	max. @ 20V max (AC/DC)													
3A	@ 125VAC or 28VDC; 1.5A @ 250VAC													
3A	@ 125VAC or 28VDC; 1.5A @ 250VAC													
0.4VA	max. @ 20V max (AC/DC)													
NOTE: Tin-lead option available with PC type terminations only. 1 Moveable contact & terminals: copper alloy, silver plate 2 Moveable contact & terminals: copper alloy with gold plate over nickel plate 3 Terminals: silver plate with outer layer in gold plating														
6 EPOXY SEAL E epoxy seal														
7 PACKAGING Switches are bulk packed, unless T/R is specified at the end of the part number. T/R tape reel - 500 pieces per reel														

4S-Series Dimensional Specifications: in. [mm]

4S1-Series

TERMINATION

PC MOUNTING

M2

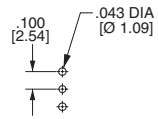
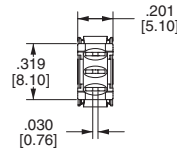
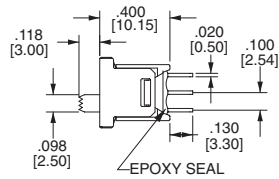
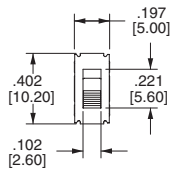

M6

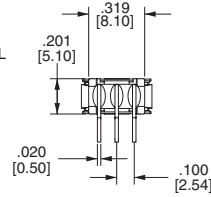
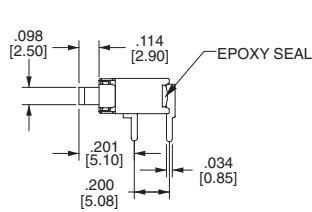
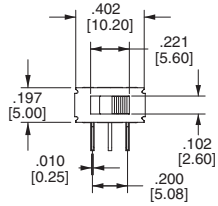

PC MOUNTING

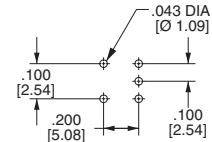

4SS-Series

TERMINATION

PC MOUNTING

M2

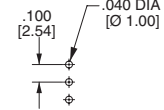
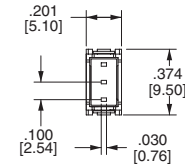
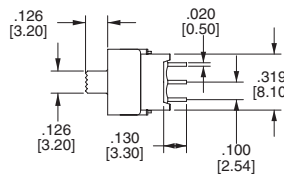
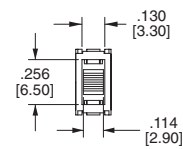

M6

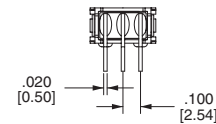
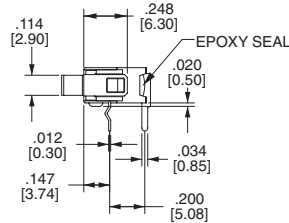
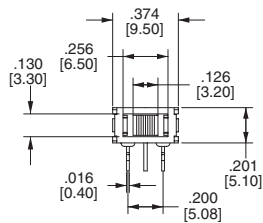

PC MOUNTING

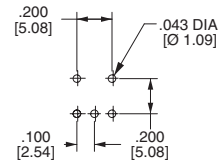

M7

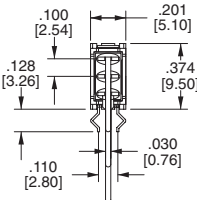
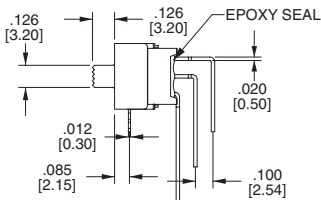
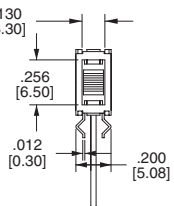

PC MOUNTING

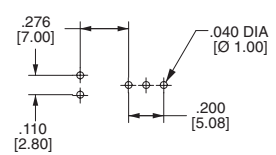

L6

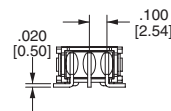
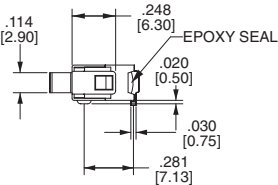
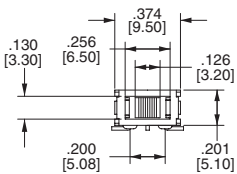

PC MOUNTING

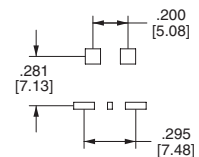

4SS-Series Dimensional Specifications: in. [mm]

TERMINATION

S6

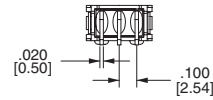
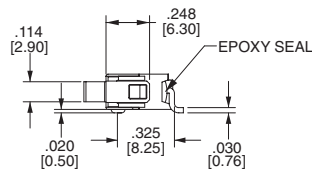
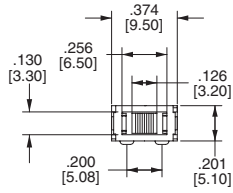

PC MOUNTING

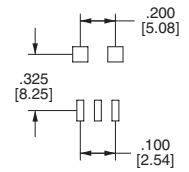

S7

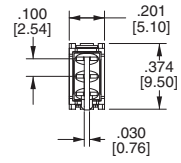
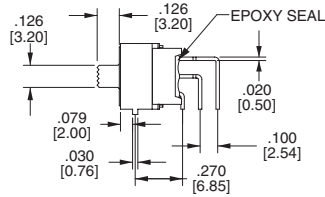
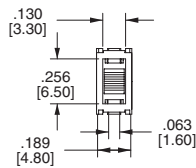

PC MOUNTING

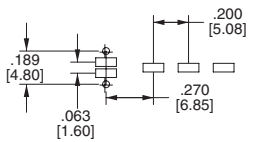

REEL TAPING

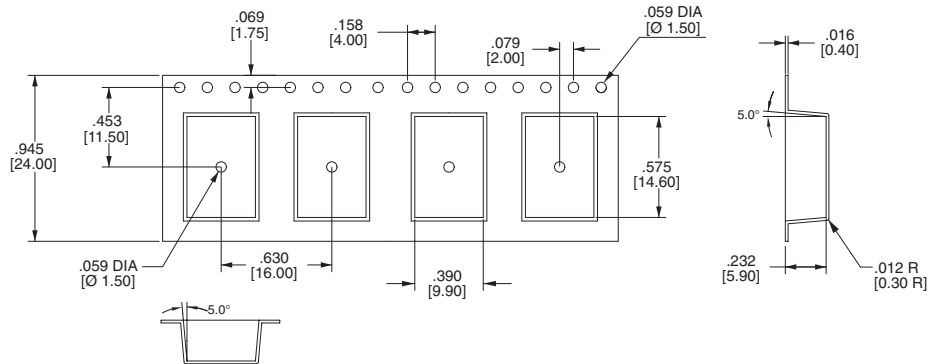

FOR S6,L6 ONLY

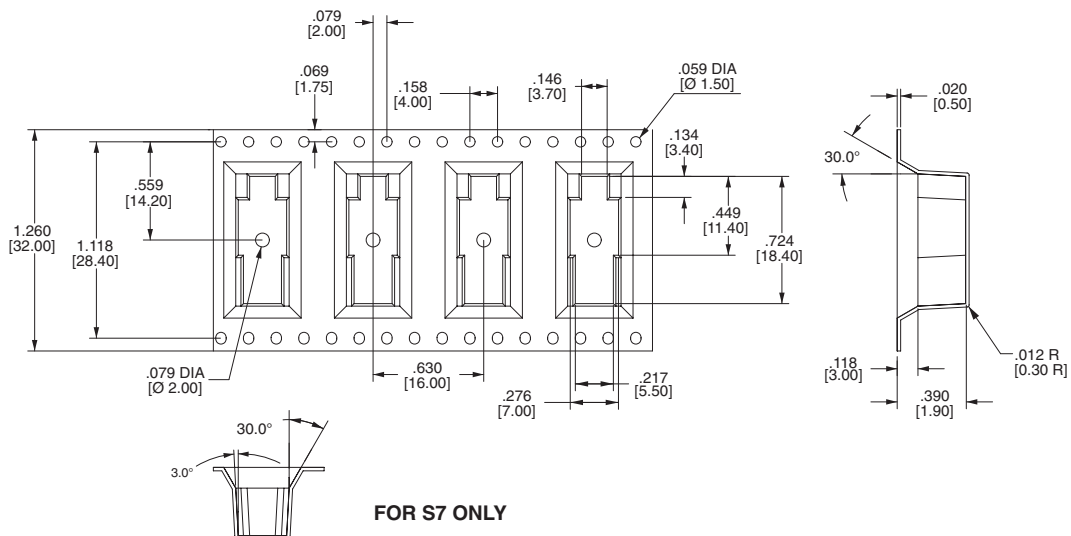

FOR S7 ONLY

4M1-Series Dimensional Specifications: in. [mm]

ACTUATOR

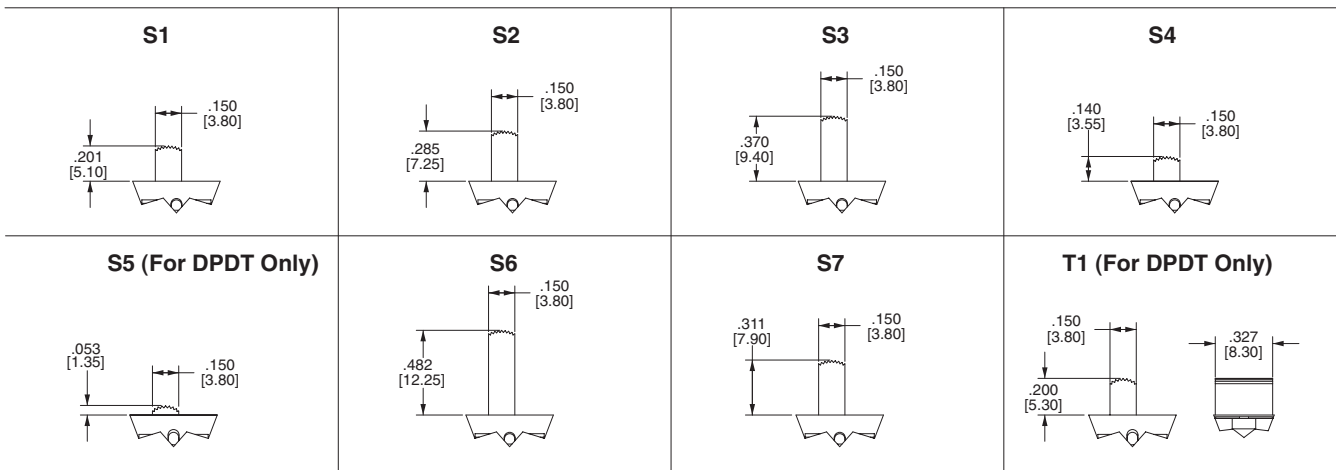

TERMINATION

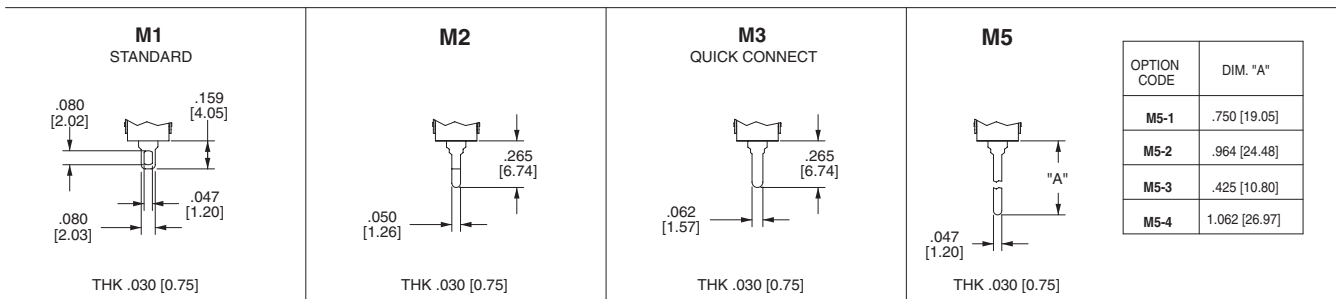

SINGLE POLE

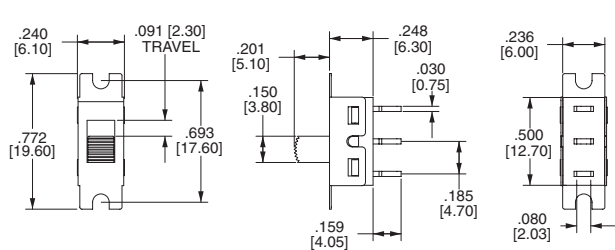

DOUBLE POLE

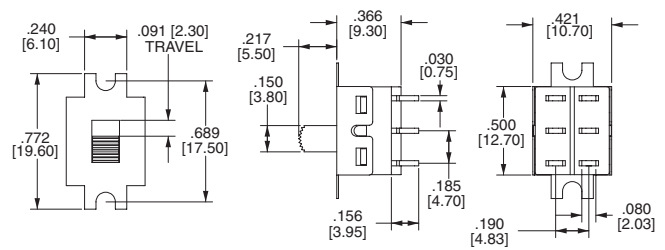

M6

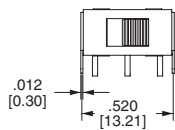

SINGLE POLE

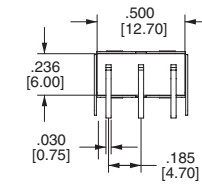
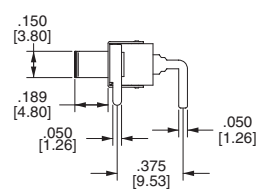

PC MOUNTING

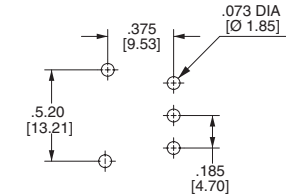

DOUBLE POLE

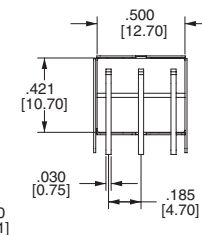
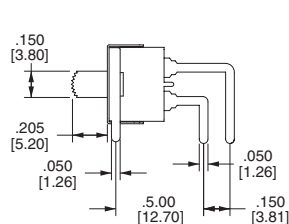

PC MOUNTING

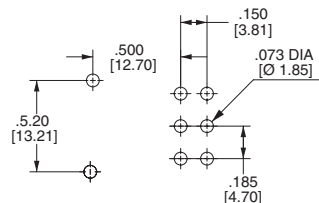

4M1-Series Dimensional Specifications: in. [mm]

TERMINATION

M7

SINGLE POLE

PC MOUNTING

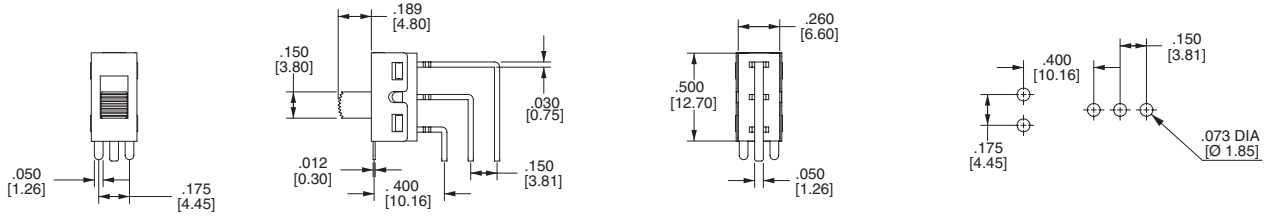

DOUBLE POLE

PC MOUNTING

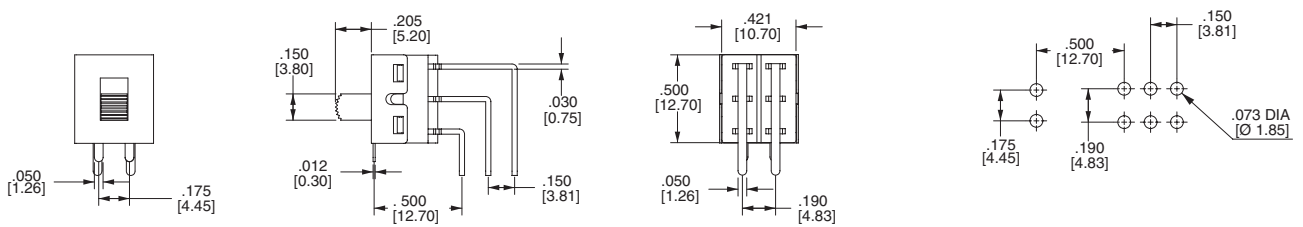

VS2

SINGLE POLE

PC MOUNTING

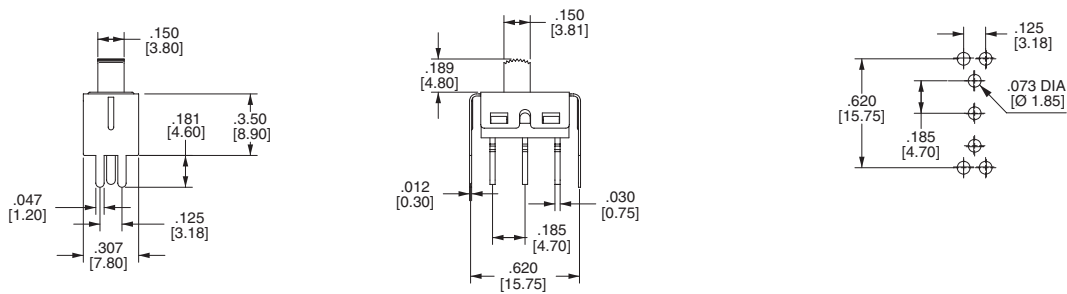

DOUBLE POLE

PC MOUNTING

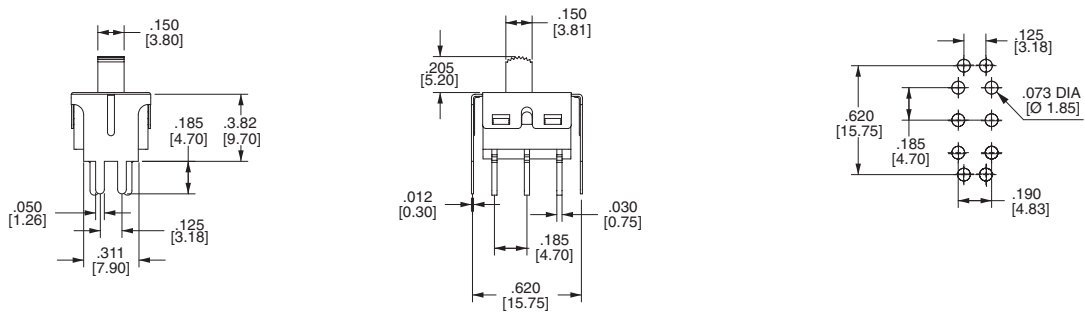

X-ON Electronics

Largest Supplier of Electrical and Electronic Components

Click to view similar products for [Slide Switches](#) category:

Click to view products by [Carling](#) manufacturer:

Other Similar products are found below :

[6-1437581-1](#) [M43R](#) [MHS123K15D](#) [MHSS1104A](#) [MMD](#) [GH49S010001](#) [GH49WW00001](#) [1437576-8](#) [EPS1PC1](#) [1825074-1](#) [1825160-3](#)
[1825167-2](#) [25139NLDB](#) [25436NLDB](#) [25449NAH](#) [25536NA](#) [L101011ML04B](#) [SLB1240R45](#) [SLSA12004](#) [1825078-1](#) [1825080-4](#) [1825081-1](#)
[1825269-1](#) [1825270-2](#) [STS141RA04](#) [T2215BEN506](#) [GF-124-0204](#) [GH46P000001](#) [GH46W000001](#) [GH49P010001](#) [25339NA](#) [25436NLDH](#)
[CST91246FK](#) [TG36P000000](#) [TG36P000050](#) [47227LFE](#) [49331L](#) [MHSS1105A](#) [50208L](#) [HW4S-5LF22N3](#) [L202091MS02Q](#) [4-1437581-7](#)
[X2225CR-437W](#) [48BFSP3M2QT](#) [49329L](#) [1101M1S3ZB8E2](#) [1-1437581-1](#) [EG1218REDACTUATOR](#) [TG39W000000](#) [1825075-1](#)