

Panel Actuators and Indicators

Type PB

Key Selector Switches



- Ø 22mm (Ø0.87") with Standard key
- Ø 30mm (Ø1.18") with Triangle key
- Two and three positions
- cULus and CE
- IEC/EN 60947-5-1, UL 508



Product description

Key selector switches are mechanical switches that can be turned right, center or left to open or to close the electric contacts. Mostly used to switch between two/three circuits. When the key

is pulled-out no any other action can be done. They should be ordered in parts (operator + holder + contact block) and installed in an enclosure.

Ordering key

PB 22S KRS 31 KC

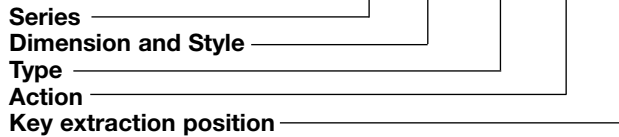

Approvals



Types

KRS = Key selector switch

Dimensions and styles

22S = Ø22mm (Ø0.87") Standard style
 30F = Ø30mm (Ø1.18") Flush style

Actions

21 = Two positions L R
 31 = Three positions L C R

Key extraction position

KL = on the left position
 KC = on the center position
 KR = on the right position

General data

Peripheral of actuator	AL
Actuator	Pa
Mechanical life	≥ 5 x 10 ⁴ cycles
Operating temperature	-25 to +70°C (-13 to +158°F)
Storage temperature	-30 to +80°C (-22 to +176°F)
Degree of protection	IP 65

Dimensions - Push Buttons mm/inches

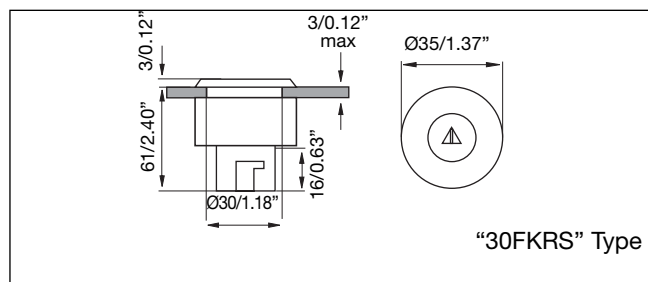
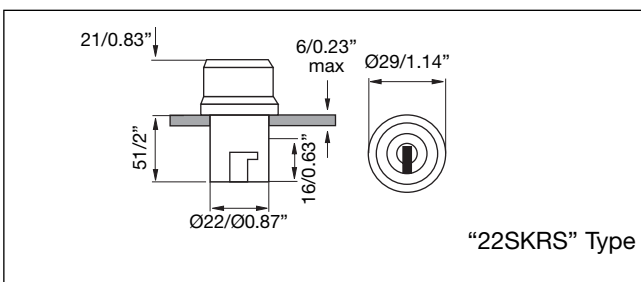

Panel Actuators and Indicators

Type PA2

Contact Block

CARLO GAVAZZI



- High switching power
- Double switch
- Industrial applications
- 10A switching capacity
- Up to 500VAC
- Modular mounting (up to 3 elements)
- Screw terminals
- High reliability
- cULus and CE
- IEC/EN 60947-5-1, IEC/EN 60947-5-5, UL 508

Product description

Switching element equipped with two independent elements. Available in different switching configurations. Pole and throw configurations can be single pole single throw (SPST) or double pole single throw (DPST). Elements can be snapped to each other on the bottom, up to 3.

Ordering key

PA 2 110 / 1

Type _____
 Number of contacts _____
 Contact code _____
 Options (1 = Snap action _____
 2 = Slow action with forced opening (⊖) NC contact)

Approvals



Terminals

Screw terminals

Max. section single-core wire
 Max. section stranded wire
 Copper conductor wire
 Terminal tightening torque

2 x 2.5mm² (0.004sq.inch)
 2 x 1.5mm² (0.002sq.inch)
 14 AWG
 1.2Nm (10.6in.lb.)

Technical data

Contact resistance	≤50mΩ
Travel	5.8 ± 0.2mm (2.28" ± 0.08")
Rated insulation Voltage U _i	660VAC/DC (acc. to IEC 60947-5-1) 600VAC/DC (acc. to UL508)
Rated imp. withstand voltage U _{imp}	2500VAC 50Hz 1min.
Minimum switching power	
Min Current	100mA
Min Voltage	24V
Switch housing	PC
Contact parts	Cu
Contact material	
Standard	Hard silver
Optional	Gold/silver
Optional for aggressive atmospheres	Silver/palladium
Operating temperature	-25 to +70°C (-13 to +158°F)
Storage temperature	-30 to +80°C (-22 to +176°F)

Contact code

Contact configuration	Contact code
2 NO contacts (DPST)	200
2 NC contacts (DPST)	020
1 NC contact (SPST)	010
1 NO contact (SPST)	100
1 NC + 1 NO contacts (DPST)	110

Contact characteristics

Contact Rating AC1	10A @ 250VAC		
Contact Rating	AC15	DC13	
(acc. to IEC 60947-5-1)			
@ 24V	10A	6A	
@ 110V	8A	1A	
@ 220V	6A	0.5A	
@ 380V	4A	-	
@ 500V	2.5A	-	
Thermal Contact Rating	10A (A600)	5A (B600)	
(acc. to UL 508)			
	2.5A (Q600/Q300)		
AC Contact Rating (acc. to UL 508)	A600	B600	
B600 (all snap codes)			
@ 120V	6A	3A	
@ 240V	3A	1.5A	
@ 480V	1.5A	0.75A	
@ 600V	1.2A	0.6A	
DC Contact Rating (acc. to UL 508)	Q600	Q300	
Q600 (all snap codes)			
@ 125V	0.55A	0.55A	
Q600 (100, 200 slow codes)			
@ 250V	0.27A	0.27A	
Q300 (010, 020, 110 slow codes)			
@ 480V	0.10A	-	
@ 600V	0.10A	-	



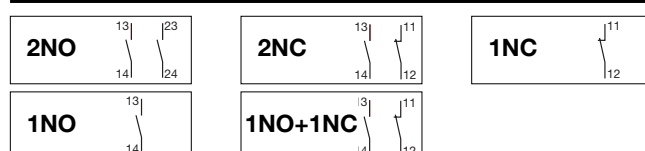

Wiring diagram

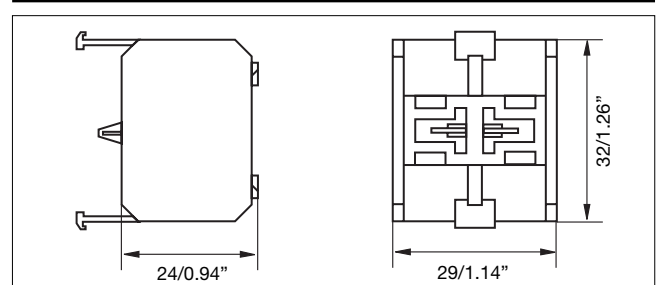

Dimensions mm/inches

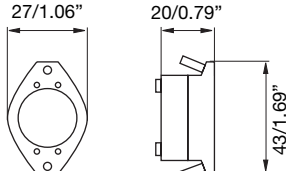

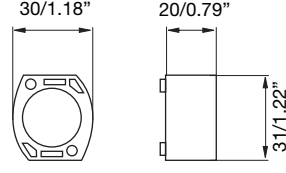
Holders

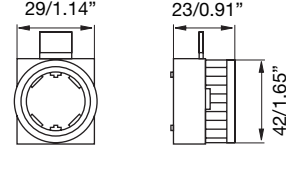
	Holder type "M"	Code PB MB M Material Zn + PBT	
	Holder type "P"	Code PB MB P Material PBT	
	Holder type "N"	Code PB MB N Material PC	

Assembling and Mounting

It come easy to get a complete product. Just to choose the operator, the holder, the lamp element and the contact block (up to 3).

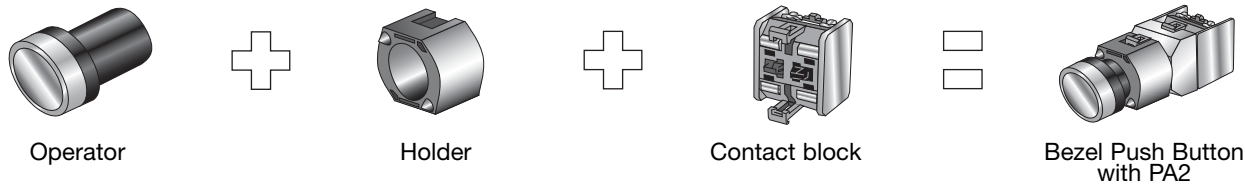

To install it, the only tool needed is a screwdriver. The same used to wiring the contact block can be used to fix the push-button.

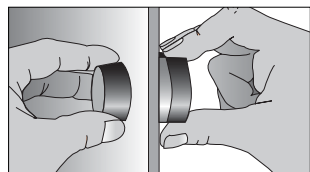

The operator will be inserted into the panel.

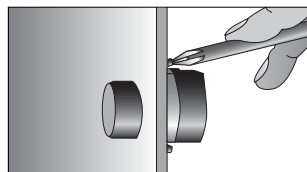

The holder will be secured at the back by two screws or nut.

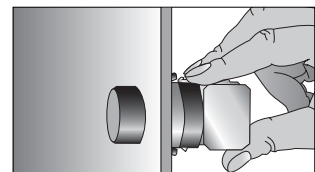

The contact block is snapped on.

Accessories for Panel Actuators

	Terminal shield Installed behind the wiring screws of the contact block to avoid electric shock.	PC		PA 2 SHIELD
	Mounting ring Ø22mm (0.87") Installed on plastic panel to strengthen mounting.	FE		PA MR 22
	Mounting ring Ø25mm (0.98") When the mounting hole is Ø25mm (0.98"), it should be add to the panel.	FE		PA MR 25
	Front bezel set Ø30mm (1.18") For Ø30mm (1.18") panel hole, to have a thinner effect.	AL		PA FBZL 30
	Label frame Hang it on the push button or pilot light, for symbol or text explanation.	PC	10mm/0.39" 18mm/0.71"	PA LBF 11 PA LBF 18
	Yellow protection ring To protect button and to prevent strike or mistaking operation.	ABS Rubber	Ø40mm/Ø1.57" Ø60mm/Ø2.36"	PA YPR 4 PA YPR 6
	Panel hole cap Ø22mm (0.87") For blocking up prepared or useless holes on the panels.	ABS		PA PHC 22

X-ON Electronics

Largest Supplier of Electrical and Electronic Components

Click to view similar products for [LED Panel Mount Indicators](#) category:

Click to view products by [Carlo Gavazzi](#) manufacturer:

Other Similar products are found below :

[607-1312-310F](#) [607-3232-140F](#) [6091M1-24V](#) [6091M5-24V](#) [6091M7-24V](#) [821-0331-503](#) [FL2870C8R](#) [FL2950WL7B](#) [FL589WL8R](#)
[Q6P3BXXB12E](#) [H8630FBBA3](#) [MPC5ADW6.0](#) [DX1091GN](#) [NL177WL3G](#) [NL276C3G](#) [NL2950BWL3G](#) [NL2950CWL2R](#) [NL589WL2R](#)
[NL67C3G](#) [NL67C3R](#) [2191L1-12V](#) [PB22SIOL0RG](#) [PB22SPPM41R](#) [PB22SPPM61R](#) [LE177C5B](#) [LH1048BSWL3702](#) [LH1048BWL3702](#)
[LH382A](#) [LHM62B](#) [SSI-LXH387USBD-150](#) [SSI-LXH9ZIC40587](#) [SSP-LXS110818BA](#) [FL2950BWL7R](#) [FL2950WL7R](#) [FL2951WL8G](#)
[FL2951WL8R](#) [FL589C7R](#) [FL67C7R](#) [FL67WL8G](#) [2191QU7-24V](#) [2191U1-12V](#) [2191U5-12V](#) [2191U5-6V](#) [2191U7-12V](#) [249-4167-3734-504F](#) [Q6P5BXXG02E](#) [3990A7](#) [5110F3-12V](#) [MPC5BCW18.0](#) [556-1237-801F](#)