

Central™ Semiconductor Corp.

145 Adams Ave., Hauppauge, NY 11788 USA
Phone (631) 435-1110 FAX (631) 435-1824

Manufacturers of World Class Discrete Semiconductors
www.centralsemi.com

2N3762
2N3763

PNP SILICON TRANSISTOR

JEDEC TO-39 CASE

DESCRIPTION

The CENTRAL SEMICONDUCTOR 2N3762 and 2N3763 types are Silicon PNP Epitaxial Planar Transistors designed for core driver applications.

MAXIMUM RATINGS (T_A=25°C)

	SYMBOL	2N3762	2N3763	UNITS
Collector-Base Voltage	V _{CBO}	40	60	V
Collector-Emitter Voltage	V _{CEO}	40	50	V
Emitter-Base Voltage	V _{EBO}		5.0	V
Collector Current	I _C		1.5	A
Power Dissipation	P _D		1.0	W
Power Dissipation (T _C =25°C)	P _D		4.0	W
Operating and Storage Junction Temperature	T _J , T _{stg}	-65 to +200		°C
Thermal Resistance	θ _{JA}		175	°C/W
Thermal Resistance	θ _{JC}		44	°C/W

ELECTRICAL CHARACTERISTICS (T_A=25°C unless otherwise noted)

SYMBOL	TEST CONDITIONS	2N3762		2N3763		UNITS
		MIN	MAX	MIN	MAX	
I _{BL}	V _{CE} =½Rated V _{CBO} , V _{EB} =2.0V		200		200	nA
I _{CEV}	V _{CE} =½Rated V _{CBO} , V _{EB} =2.0V		100		100	nA
I _{CEV}	V _{CB} =½Rated V _{CBO} , V _{EB} =2.0V. T _A =100°C		10		10	μA
BV _{CBO}	I _C =10μA	40		60		V
BV _{CEO}	I _C =10mA	40		50		V
BV _{EBO}	I _E =10μA	5.0		5.0		V
V _{CE(SAT)}	I _C =10mA, I _B =1.0mA		0.10		0.10	V
V _{CE(SAT)}	I _C =150mA, I _B =15mA		0.22		0.22	V
V _{CE(SAT)}	I _C =500mA, I _B =50mA		0.50		0.50	V
V _{CE(SAT)}	I _C =1.0A, I _B =100mA		0.90		0.90	V
V _{BE(SAT)}	I _C =10mA, I _B =1.0mA		0.80		0.80	V
V _{BE(SAT)}	I _C =150mA, I _B =15mA		1.00		1.00	V
V _{BE(SAT)}	I _C =500mA, I _B =50mA		1.20		1.20	V
V _{BE(SAT)}	I _C =1.0A, I _B =100mA	0.90	1.40	0.90	1.40	V

(CONTINUED ON REVERSE SIDE)

R1

ELECTRICAL CHARACTERISTICS (Continued)

SYMBOL	TEST CONDITIONS	2N3762		2N3763		UNITS
		MIN	MAX	MIN	MAX	
h_{FE}	$V_{CE}=1.0V, I_C=10mA$	35		35		
h_{FE}	$V_{CE}=1.0V, I_C=150mA$	40		40		
h_{FE}	$V_{CE}=1.0V, I_C=500mA$	35		35		
h_{FE}	$V_{CE}=1.5V, I_C=1.0A$	20	80	30	120	
h_{FE}	$V_{CE}=5.0V, I_C=1.5A$	20		30		
$ h_{fe} $	$V_{CE}=10V, I_C=50mA, f=100MHz$	1.8		1.5		
C_{ob}	$V_{CB}=10V, I_E=0, f=100kHz$		15		15	pF
C_{ib}	$V_{BE}=0.5V, I_C=0, f=100kHz$		80		80	pF
t_d	$V_{CC}=30V, V_{BE(off)}=2.0V, I_C=1.0A, I_{B1}=100mA$		8.0		8.0	ns
t_r	$V_{CC}=30V, V_{BE(off)}=2.0V, I_C=1.0A, I_{B1}=100mA$		3.5		3.5	ns
t_s	$V_{CC}=30V, I_C=1.0A, I_{B1}=-I_{B2}=100mA$		80		80	ns
t_f	$V_{CC}=30V, I_C=1.0A, I_{B1}=-I_{B2}=100mA$		35		35	ns
Q_{τ}	$V_{CC}=30V, I_C=1.0A, I_B=100mA$		30		30	pC

JEDEC TO-39 PACKAGE - MECHANICAL OUTLINE

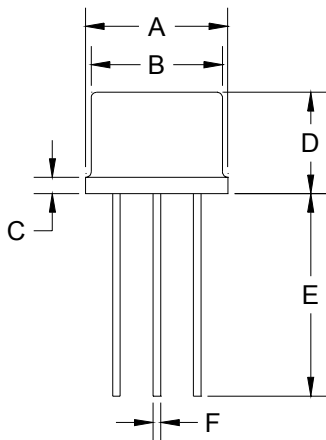

SYMBOL	DIMENSIONS			
	INCHES		MILLIMETERS	
	MIN	MAX	MIN	MAX
A (DIA)	0.335	0.370	8.51	9.40
B (DIA)	0.315	0.335	8.00	8.51
C	-	0.040	-	1.02
D	0.240	0.260	6.10	6.60
E	0.500	-	12.70	-
F (DIA)	0.016	0.021	0.41	0.53
G (DIA)	0.200		5.08	
H	0.100		2.54	
I	0.028	0.034	0.71	0.86
J	0.029	0.045	0.74	1.14

TO-39 (REV: R1)

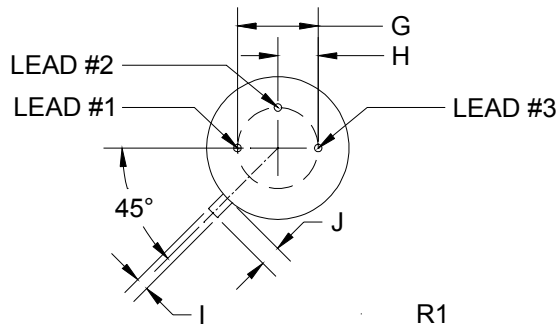

LEAD CODE:

1. Emitter
2. Base
3. Collector

CentralTM
Semiconductor Corp.

145 Adams Ave., Hauppauge, NY 11788 USA
Phone (631) 435-1110 FAX (631) 435-1824

Manufacturers of World Class Discrete Semiconductors

www.centralsemi.com



OUTSTANDING SUPPORT AND SUPERIOR SERVICES

PRODUCT SUPPORT

Central's operations team provides the highest level of support to insure product is delivered on-time.

- Supply management (Customer portals)
- Inventory bonding
- Consolidated shipping options
- Custom bar coding for shipments
- Custom product packing

DESIGNER SUPPORT/SERVICES

Central's applications engineering team is ready to discuss your design challenges. Just ask.

- Free quick ship samples (2nd day air)
- Online technical data and parametric search
- SPICE models
- Custom electrical curves
- Environmental regulation compliance
- Customer specific screening
- Up-screening capabilities
- Special wafer diffusions
- PbSn plating options
- Package details
- Application notes
- Application and design sample kits
- Custom product and package development

REQUESTING PRODUCT PLATING

1. If requesting Tin/Lead plated devices, add the suffix " TIN/LEAD" to the part number when ordering (example: 2N2222A TIN/LEAD).
2. If requesting Lead (Pb) Free plated devices, add the suffix " PBFREE" to the part number when ordering (example: 2N2222A PBFREE).

CONTACT US

Corporate Headquarters & Customer Support Team

Central Semiconductor Corp.
145 Adams Avenue
Hauppauge, NY 11788 USA
Main Tel: (631) 435-1110
Main Fax: (631) 435-1824
Support Team Fax: (631) 435-3388
www.centrasemi.com

Worldwide Field Representatives:
www.centrasemi.com/wwreps

Worldwide Distributors:
www.centrasemi.com/wwdistributors

For the latest version of Central Semiconductor's **LIMITATIONS AND DAMAGES DISCLAIMER**, which is part of Central's Standard Terms and Conditions of sale, visit: www.centrasemi.com/terms

X-ON Electronics

Largest Supplier of Electrical and Electronic Components

Click to view similar products for [Bipolar Transistors - BJT category](#):

Click to view products by [Central Semiconductor manufacturer](#):

Other Similar products are found below :

[619691C](#) [MCH4017-TL-H](#) [BC546/116](#) [BC557/116](#) [BSW67A](#) [NTE158](#) [NTE187A](#) [NTE195A](#) [NTE2302](#) [NTE2330](#) [NTE63](#) [C4460](#)
[2SA1419T-TD-H](#) [2SA1721-O\(TE85L,F\)](#) [2SA2126-E](#) [2SB1204S-TL-E](#) [2SC5488A-TL-H](#) [2SD2150T100R](#) [SP000011176](#) [FMMTA92QTA](#)
[2N2369ADCSM](#) [2N5769](#) [2SC2412KT146S](#) [2SC5490A-TL-H](#) [2SD1816S-TL-E](#) [2SD1816T-TL-E](#) [CMXT2207 TR](#) [CPH6501-TL-E](#)
[MCH4021-TL-E](#) [US6T6TR](#) [NJL0281DG](#) [732314D](#) [CMXT3906 TR](#) [CPH3121-TL-E](#) [CPH6021-TL-H](#) [873787E](#) [IMZ2AT108](#) [UMX21NTR](#)
[MCH6102-TL-E](#) [NJL0302DG](#) [2N3583](#) [2SA1434-TB-E](#) [2SC3143-4-TB-E](#) [2SD1621S-TD-E](#) [NTE103](#) [30A02MH-TL-E](#) [NSV40301MZ4T1G](#)
[NTE101](#) [NTE13](#) [NTE15](#)