

CMMR1F-02 CMMR1F-06  
CMMR1F-04 CMMR1F-08

**SURFACE MOUNT  
FAST RECOVERY SILICON RECTIFIER  
1 AMP, 200 THRU 800 VOLTS**

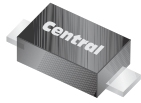

**SOD-123F CASE**

• Device is **Halogen Free** by design



[www.centralemi.com](http://www.centralemi.com)

**DESCRIPTION:**

The CENTRAL SEMICONDUCTOR CMMR1F series are high quality 1.0 amp surface mount silicon rectifiers, well constructed, highly reliable components designed for use in all types of commercial, industrial, entertainment, computer, and automotive applications.

**MARKING CODE: SEE MARKING CODE TABLE ON FOLLOWING PAGE**

**FEATURES:**

- High reverse voltage capability
- Low leakage current
- Low reverse recovery times
- Low package profile (1.08mm MAX)

**MAXIMUM RATINGS:** ( $T_A=25^\circ\text{C}$  unless otherwise noted)

|   | SYMBOL         | CMMR1F |             |     |     | UNITS              |
|---|----------------|--------|-------------|-----|-----|--------------------|
|   |                | -02    | -04         | -06 | -08 |                    |
| Peak Repetitive Reverse Voltage                     | $V_{RRM}$      | 200    | 400         | 600 | 800 | V                  |
| DC Blocking Voltage                                 | $V_R$          | 200    | 400         | 600 | 800 | V                  |
| RMS Reverse Voltage                                 | $V_{R(RMS)}$   | 140    | 280         | 420 | 560 | V                  |
| Average Forward Current ( $T_L=110^\circ\text{C}$ ) | $I_O$          |        | 1.0         |     |     | A                  |
| Peak Forward Surge Current (8.3ms)                  | $I_{FSM}$      |        | 30          |     |     | A                  |
| Operating and Storage Junction Temperature          | $T_J, T_{stg}$ |        | -65 to +150 |     |     | $^\circ\text{C}$   |
| Thermal Resistance                                  | $\theta_{JL}$  |        | 30          |     |     | $^\circ\text{C/W}$ |

**ELECTRICAL CHARACTERISTICS:** ( $T_A=25^\circ\text{C}$  unless otherwise noted)

| SYMBOL   | TEST CONDITIONS   | TYP | MAX | UNITS         |
|----------|---|-----|-----|---------------|
| $I_R$    | $V_R=\text{Rated } V_{RRM}$   |     | 1.0 | $\mu\text{A}$ |
| $I_R$    | $V_R=\text{Rated } V_{RRM}, T_A=125^\circ\text{C}$                      |     | 50  | $\mu\text{A}$ |
| $V_F$    | $I_F=1.0\text{A}$   |     | 1.3 | V             |
| $C_J$    | $V_R=4.0\text{V}, f=1.0\text{MHz}$                                      | 9.0 |     | pF            |
| $t_{rr}$ | $I_F=0.5\text{A}, I_R=1.0\text{A}, I_{rr}=0.25\text{A}$ (CMMR1F-02, 04) |     | 150 | ns            |
| $t_{rr}$ | $I_F=0.5\text{A}, I_R=1.0\text{A}, I_{rr}=0.25\text{A}$ (CMMR1F-06)     |     | 250 | ns            |
| $t_{rr}$ | $I_F=0.5\text{A}, I_R=1.0\text{A}, I_{rr}=0.25\text{A}$ (CMMR1F-08)     |     | 500 | ns            |

CMMR1F-02 CMMR1F-06  
 CMMR1F-04 CMMR1F-08



**SURFACE MOUNT  
 FAST RECOVERY SILICON RECTIFIER  
 1 AMP, 200 THRU 800 VOLTS**

**SOD-123F CASE - MECHANICAL OUTLINE**

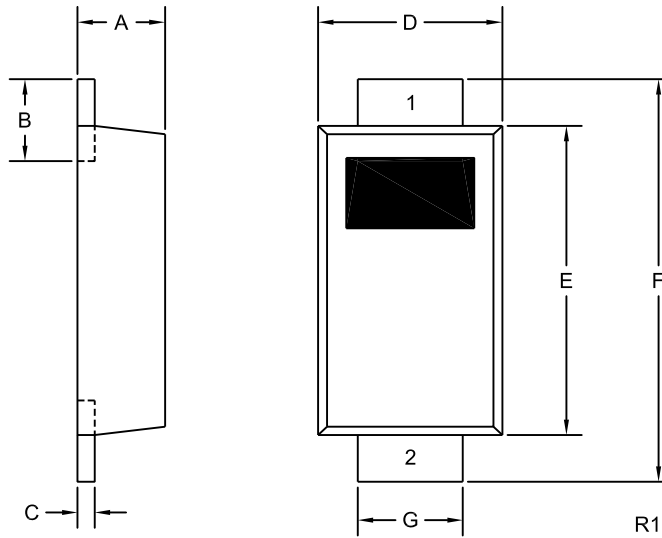

| DEVICE    | MARKING CODE |
|-----------|--------------|
| CMMR1F-02 | CF02F        |
| CMMR1F-04 | CF04F        |
| CMMR1F-06 | CF06F        |
| CMMR1F-08 | CF08F        |

| SYMBOL | INCHES |       | MILLIMETERS |      |
|--------|--------|-------|-------------|------|
|        | MIN    | MAX   | MIN         | MAX  |
| A      | 0.035  | 0.043 | 0.88        | 1.08 |
| B      | 0.020  | 0.031 | 0.50        | 0.80 |
| C      | 0.004  | 0.008 | 0.10        | 0.20 |
| D      | 0.065  | 0.077 | 1.65        | 1.95 |
| E      | 0.104  | 0.116 | 2.65        | 2.95 |
| F      | 0.140  | 0.156 | 3.55        | 3.95 |
| G      | 0.030  | 0.041 | 0.75        | 1.05 |

SOD-123F (REV:R1)

**LEAD CODE:**  
 1) Cathode  
 2) Anode

R3 (19-March 2012)

## X-ON Electronics

Largest Supplier of Electrical and Electronic Components

*Click to view similar products for [Rectifiers](#) category:*

*Click to view products by [Central Semiconductor](#) manufacturer:*

Other Similar products are found below :

[70HFR40](#) [RL252-TP](#) [150KR30A](#) [1N5397](#) [NTE5841](#) [NTE6038](#) [SCF5000](#) [1N4002G](#) [1N4005-TR](#) [JANS1N6640US](#) [481235F](#)  
[RRE02VS6SGTR](#) [067907F](#) [MS306](#) [70HF40](#) [T110HF60](#) [T85HFL60S02](#) [US2JFL-TP](#) [A1N5404G-G](#) [CRS04\(T5L,TEMQ\)](#) [ACGRA4007-HF](#)  
[ACGRB207-HF](#) [CLH03\(TE16L,Q\)](#) [ACGRC307-HF](#) [ACEFC304-HF](#) [NTE6356](#) [NTE6359](#) [NTE6002](#) [NTE6023](#) [NTE6039](#) [NTE6077](#)  
[85HFR60](#) [40HFR60](#) [1N1186RA](#) [70HF120](#) [85HFR80](#) [D126A45C](#) [SCF7500](#) [D251N08B](#) [SCHJ22.5K](#) [SM100](#) [SCPA2](#) [SCH10000](#) [SDHD5K](#)  
[VS-12FL100S10](#) [ACGRA4001-HF](#) [D1821SH45T PR](#) [D1251S45T](#) [NTE5990](#) [NTE6358](#)