

# 9001 Series

## DIN41612 C Type Female

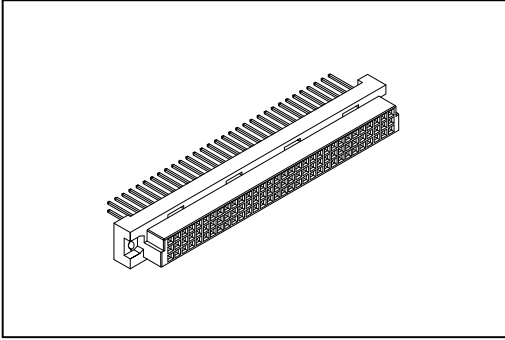

### Material:

Housing: Thermoplastic Polyester Glass Filled UL94V-0.  
 Contacts: Copper Alloy.

### Electrical Characteristics:

Current Rating: 2 A.  
 Dielectric Withstanding Voltage: AC 1000V.  
 Insulator Resistance: 1000MΩ min.  
 Contact Resistance: 20mΩ max.  
 Operating Temperature: -55°C ~ +125°C.

### Features:

\* Mates with Male 3Row  
 9001-1196, 1164 C Type.  
 9001-1396, 1364 R Type.

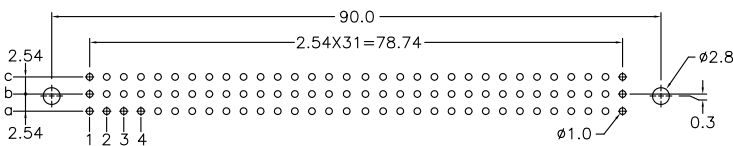
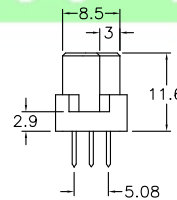
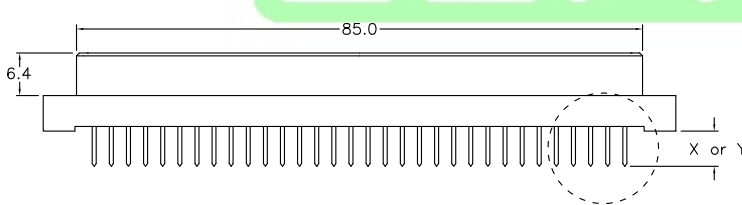
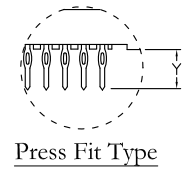
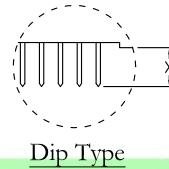
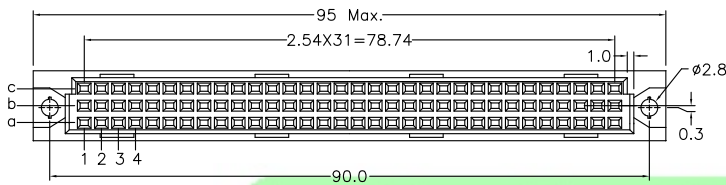

P.C. Board Layout

Length	1	2	W1	W2
X	4.0	2.5	13	17
Y	4.6	6.3	13	17
Pitch	Position	Rows with Contacts	Contact Arrange	
2.54mm	96	a b c		
	64	a - c		
	32	a - -		
5.08mm	48	a b c		
	32	a - c		
	16	a - -		

## Ordering information

9001- 1 2 96 1 C 00 P L1 A  
 Series 1: 2.54mm 2: Female Position 1: Dip Length 2: Dip Length  
 W1: Dip Length W2: Dip Length  
 C: Selective Gold Plated  
 00: G/F  
 P: Blank: Dip P: Press Fit  
 L1: Blank: W/O Lock L1: With Lock  
 A: Tray Package  
 See Page CA03

# 9001 Series

## DIN41612 Mating Introduce



2 Row insulator  
 B (Standard mounting)  
 Mounting axis  
 of the connector

3 Row insulator  
 C (Standard mounting)  
 Mounting axis  
 of the connector

Board lock available  
 L1=P.C.B. Thickness 1.6 ~2.0 mm  
 L2=P.C.B. Thickness 2.8 ~3.2 mm

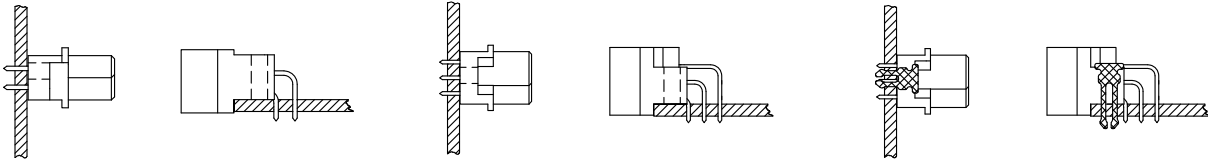

Q (Reverse mounting)  
 Mounting axis  
 of the connector

R (Reverse mounting)  
 Mounting axis  
 of the connector

Board lock available  
 L1=P.C.B. Thickness 1.6 ~2.0 mm  
 L2=P.C.B. Thickness 2.8 ~3.2 mm

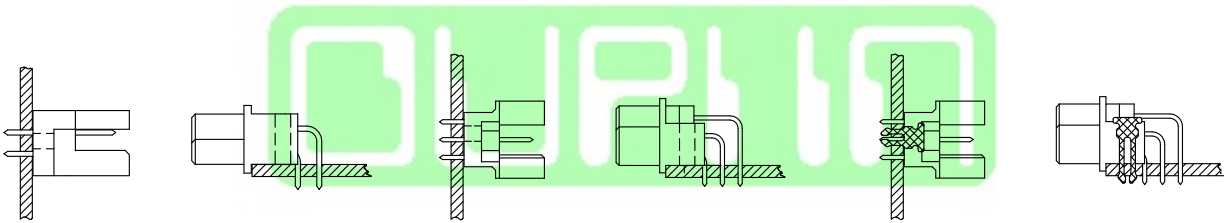

I.D.C. Type Ribbon Cable

Press Fit Type  
 2 Row insulator

3 Row insulator

2 Row insulator

3 Row insulator

