

# External Drive Piezo Transducer

## SPT28 series

### DIMENSIONS

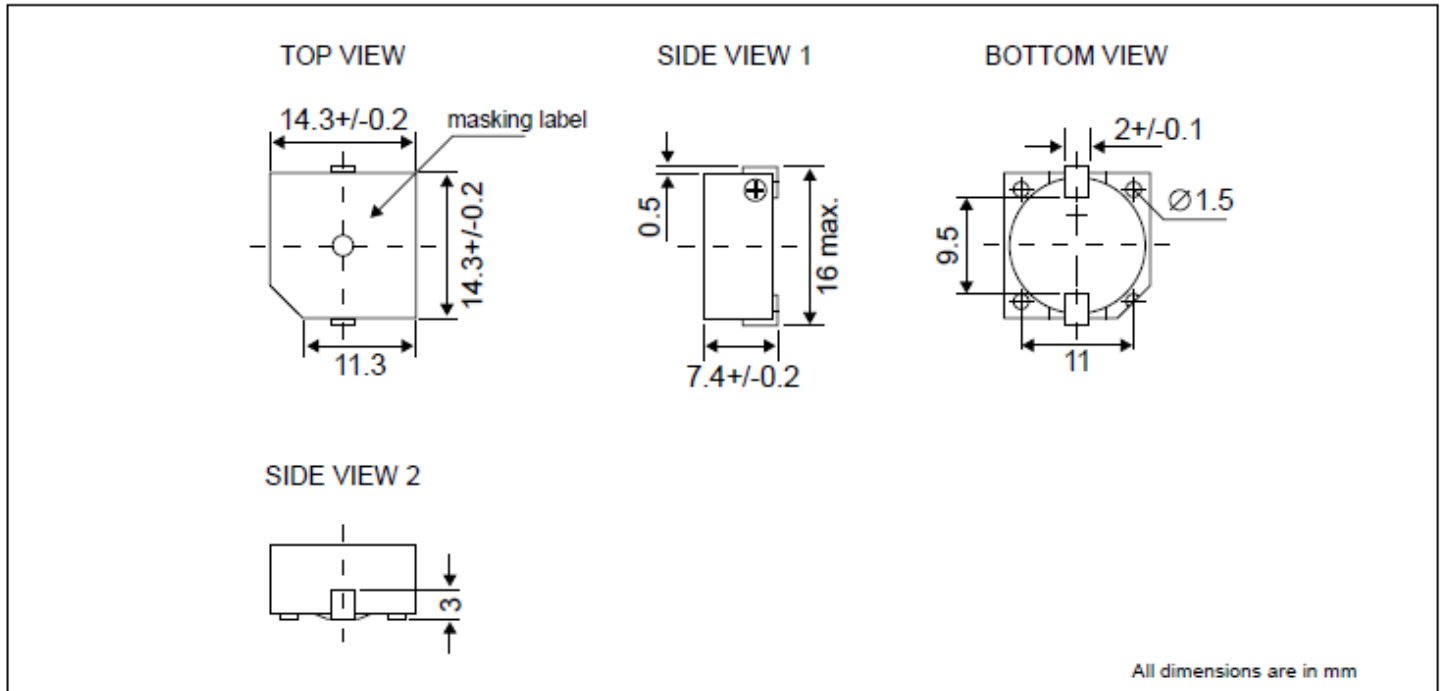

Ref. no. : CS001-1

Special Description : PT28-156840PM fulfil RoHS regulation, (Lead Free version)

### ELECTRICAL SPECIFICATIONS

Model No.	PT28-156840PMR
Sound Pressure Level	90 dBA min. [ 12 Vp-p Square Wave, 10cm, 4000Hz]
Capacitance	15000 pF +/- 30% at 100Hz
Max. Input Voltage	20 Vp-p
Operating Temperature □ [°C]	-30 ~ +85
Housing Material	PPS (Pb free version)
Terminal	SMD
Colour	Black
Weight □ [gm]	1.9