

2~3P

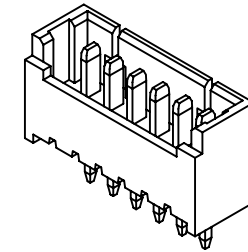

SPECIFICATIONS:

Current Rating: 1A AC,DC
 Voltage Rating: 125V AC,DC
 Temperature Range: -40°C ~ +105°C
 Contact Resistance: 20mΩ Max.
 Insulation Resistance: 100MΩ Min.
 Withstanding Voltage: 500V AC/minute
 Pin Material: Phosphor Bronze/Tin over Nickel
 Material: Nylon 66,UL94V-0(Beige)

Ordering Information & Dimensions

Circuits	Dimensions(mm)		Circuits	Dimensions(mm)	
	A	B		A	B
2P	1.25	4.30	12P	13.75	16.80
3P	2.50	5.55	13P	15.00	18.05
4P	3.75	6.80	14P	16.25	19.30
5P	5.00	8.05	15P	17.50	20.55
6P	6.25	9.30	16P	18.75	21.80
7P	7.50	10.55	17P	20.00	23.05
8P	8.75	11.80	18P	21.25	24.30
9P	10.00	13.05	19P	22.50	25.55
10P	11.25	14.30	20P	23.75	26.80
11P	12.50	15.55			

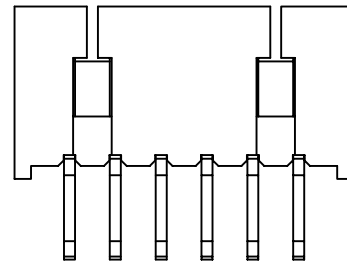
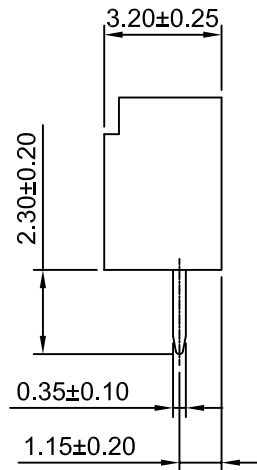
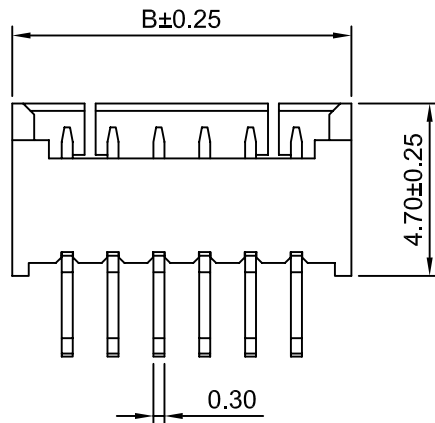

4~20P



CHANGJIANG CONNECTORS CO.,LTD.

Unit mm	Scale 5:1	Sheet 1 of 1
Draw BY: LIZQ	Approved : GONGYB	

Title :
1.25mm PITCH
180° WAFER

REV	DESCRIPTION	DATE
A1	Modify drawings	2016.03.20
A0	NEW RELELEASE	2013.01.21

General Tolerance	
x.xx±0.25	ANGLE±
x.xxx±0.20	
x.xxxx±0.15	

DRAW NO : **A1251WV-XP** REV **A1**

X-ON Electronics

Largest Supplier of Electrical and Electronic Components

Click to view similar products for [Headers & Wire Housings](#) category:

Click to view products by [Changjiang](#) manufacturer:

Other Similar products are found below :

[57102-F02-18ULF](#) [58102-G61-06LF](#) [582553-1](#) [0009485154](#) [009176003701906](#) [0050291907](#) [00-9021-0611-00-339](#) [02.125.8002.8](#) [609-3404](#)
[61062-3](#) [622-0430](#) [622-3653LF](#) [63453-116](#) [636-1030](#) [636-1427](#) [636-3427](#) [636-4007](#) [641938-9](#) [65495-038](#) [65692-001LF](#) [65781-018](#) [65781-](#)
[047](#) [65817-015LF](#) [66207-023LF](#) [67016-026LF](#) [67095-007LF](#) [68631-112](#) [68645-018](#) [68648-049](#) [699319-000](#) [M90C108951C](#) [70.362.1628.0](#)
[70-4210](#) [70-4226B](#) [70-4853B](#) [707-5020](#) [707-5028](#) [71.350.2428.0](#) [71961-016LF](#) [733-134](#) [754199-000](#) [760-3052](#) [787-8014-00](#) [FCN-367T-](#)
[T012/H](#) [80.063.4001.1](#) [800-90-001-10-001000](#) [801-43-002-10-013000](#) [801-43-006-10-002000](#) [803-41-018-10-001000](#) [803-43-014-20-001000](#)