

## Specifications

Current rating:1A AC,DC  
Voltage rating:150V AC,DC  
Temperature range:-40°C~+105°C  
Contact resistance:30mΩMax.  
Insulation resistance:500MΩMin.  
Withstanding voltage:500V AC/minute  
\*Compliant with RoHS and REACH\*  
\*Meet the HF/Halogen Free,need to customize\*  
\*Contact CJT for details\*

## Standards



## Assembly layout

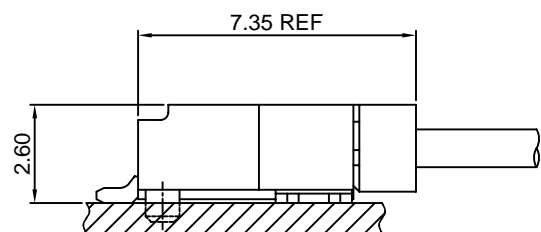
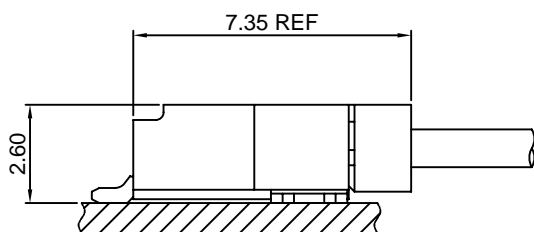

# A1255-T

1.25mm pitch Crimp Terminal

**Reference Informations:**

\*Used in CJT A1255H-XP series Housing

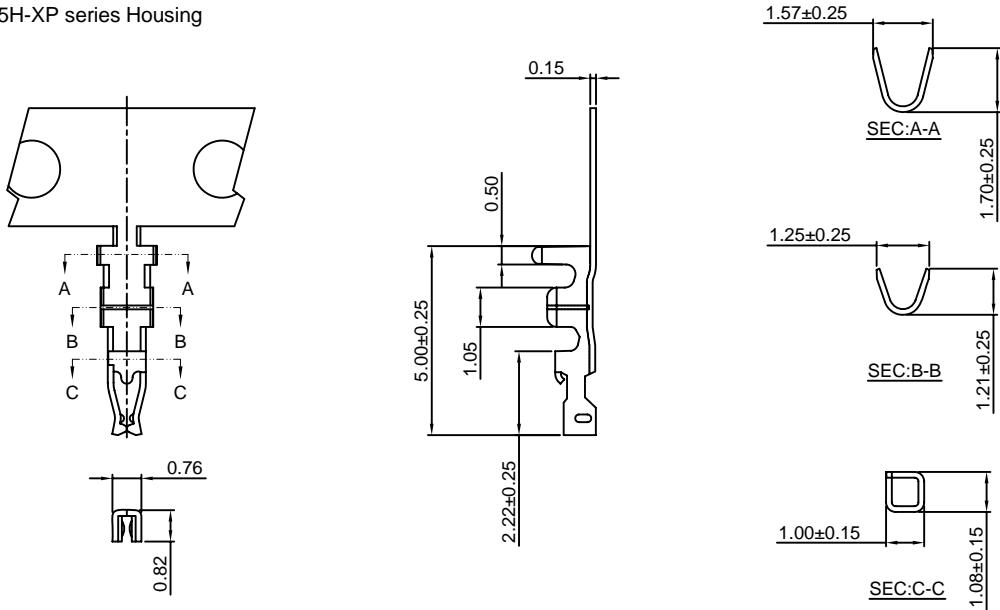

Ordering information & Specifications:

Unit:mm

Part NO.	Wire Range	Insulation O.D.	Material	Finish	Qty/reel
A1255-TP	AWG#26-#32	1.00mm(max)	Phosphor Bronze	Tin over Nickel	10,000 PCS
A1255-GP	AWG#26-#32	1.00mm(max)	Phosphor Bronze	Gold over Nickel	10,000 PCS

Optional Gold plating available but MOQ requested

# A1255MA-T

1.25mm pitch Crimp Terminal

**Reference Informations:**

\*Used in CJT A1255HMA-XP series Housing

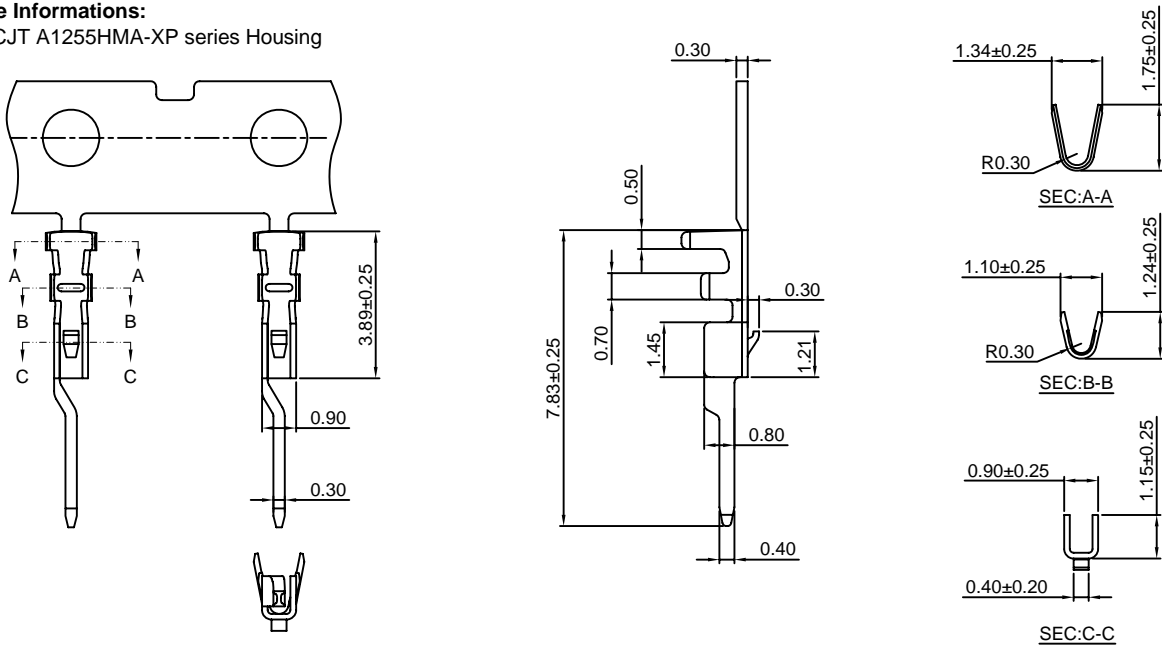

Ordering information & Specifications:

Unit:mm

Part NO.	Wire Range	Insulation O.D.	Material	Finish	Qty/reel
A1255MA-TP	AWG#28-#32	0.90mm(max)	Phosphor Bronze	Tin over Nickel	15,000 PCS
A1255MA-GP	AWG#28-#32	0.90mm(max)	Phosphor Bronze	Gold over Nickel	15,000 PCS

Optional Gold plating available but MOQ requested

### A1255H-XP

1.25mm pitch Housing

**Reference Informations:**

- \*Material:Nylon 66,UL94V-0
- \*Suitble CJT A1255-T series Terminal
- \*Mates with CJT A1255WR-S,WR-S-F-XP series Wafer
- \*Color:Gray

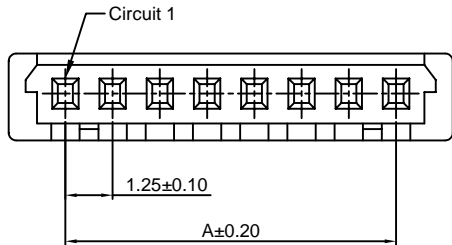
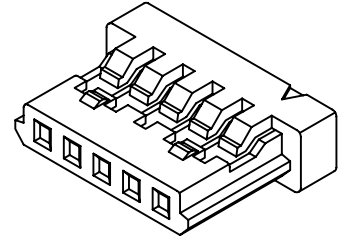

**Ordering Information:**

A1255H-XP - \*\*\*  
1 2

- 1.Part No.
- 2.Material:  
(Blank):Nylon 66,UL94V-0  
GWT:Nylon 66,UL94V-0,GWT 750 °C

**Ordering Information & Dimensions:**

PART NO.	Dimensions	
	A	B
2P	1.25	4.35
3P	2.50	5.60
4P	3.75	6.85
5P	5.00	8.10
6P	6.25	9.35
7P	7.50	10.60
8P	8.75	11.85
9P	10.00	13.10
10P	11.25	14.35
11P	12.50	15.60
12P	13.75	16.85
13P	15.00	18.10
14P	16.25	19.35
15P	17.50	20.60
20P	23.75	26.85
25P	30.00	33.10
30P	36.25	39.35

Unit: mm

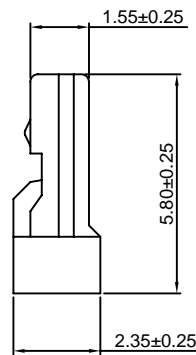
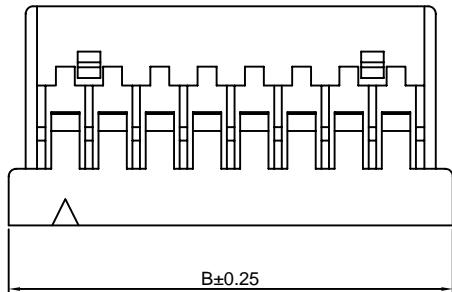

### A1255HA-XP

1.25mm pitch Housing

**Reference Informations:**

- \*Material:Nylon 66,UL94V-0
- \*Suitble CJT A1256-T series Terminal
- \*Mates with CJT A1255HMA-XP series Housing or A1255WVA-S,WRA-S-XP series Wafer
- \*Color:White

**Ordering Information:**

A1255HA-XP - \*\*\*  
1 2

- 1.Part No.
- 2.Material:  
(Blank):Nylon 66,UL94V-0  
GWT:Nylon 66,UL94V-0,GWT 750 °C

**Ordering Information & Dimensions:**

PART NO.	Dimensions	
	A	B
2P	1.25	4.35
3P	2.50	5.60
4P	3.75	6.85
5P	5.00	8.10
6P	6.25	9.35
7P	7.50	10.60
8P	8.75	11.85
9P	10.00	13.10
10P	11.25	14.35
11P	12.50	15.60
12P	13.75	16.85
13P	15.00	18.10
14P	16.25	19.35
15P	17.50	20.60
20P	23.75	26.85
25P	30.00	33.10
30P	36.25	39.35

Unit: mm

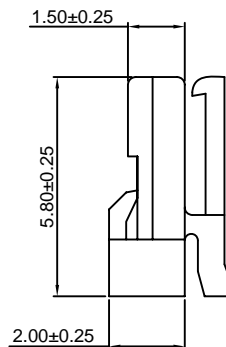
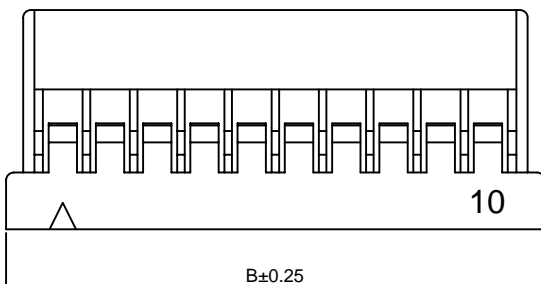
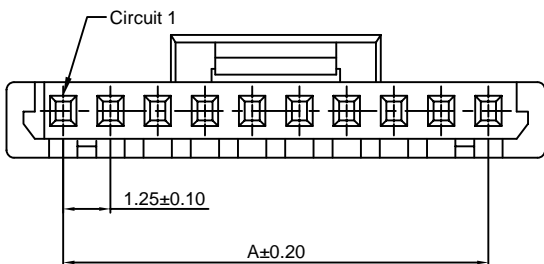

### A1255HMA-XP

1.25mm pitch Housing

**Reference Informations:**

- \*Material:Nylon 66,UL94V-0
- \*Suitble CJT A1255MA-T series Terminal
- \*Mates with CJT A1255HA-XP series Housing
- \*Color:White

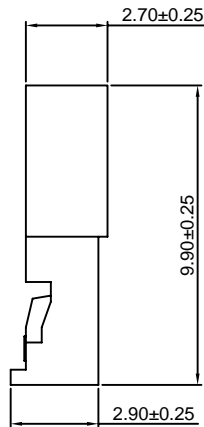
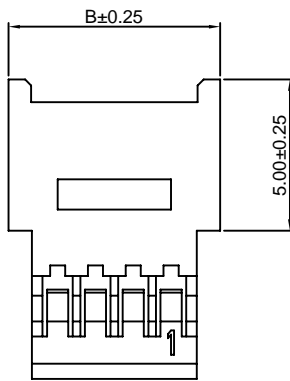
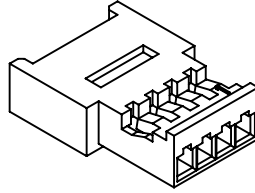
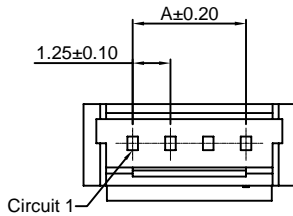

**Ordering Information:**

A1255HMA-XP - \*\*\*  
1 2

1.Part No.

2.Material:

(Blank):Nylon 66,UL94V-0

GWT:Nylon 66,UL94V-0,GWT 750°C

**Ordering Information & Dimensions:**

PART NO.	Dimensions	
	A	B
2P	1.25	4.50
3P	2.50	5.75
4P	3.75	7.00
5P	5.00	8.25
6P	6.25	9.50
7P	7.50	10.75
8P	8.75	12.00
9P	10.00	13.25
10P	11.25	14.50
11P	12.50	15.75
12P	13.75	17.00
13P	15.00	18.25
14P	16.25	19.50
15P	17.50	20.75
20P	23.75	22.00
25P	30.00	33.25

Unit: mm

### A1255WR-S-XP

1.25mm pitch 90° Wafer Without Boss -SMT TYPE

**Reference Informations:**

- \*Material:Pin:Brass/Tin over Nickel
- Solder Tabs:Brass/Tin over Nickel
- Insulator:Nylon 9T,UL94V-0
- \*Mates with CJT A1255H-XP series Housing
- \*Color:Ivory

**Ordering Information:**

A1255WR-S-XP - \*\*\* - \*\*  
1 2 3

1.Part No.

2.Material:

(Blank):Nylon 9T,UL94V-0

GWT:Nylon 9T,UL94V-0,GWT 750°C

3.Finish:

(Blank):Tin over Nickel

G:Gold over Nickel

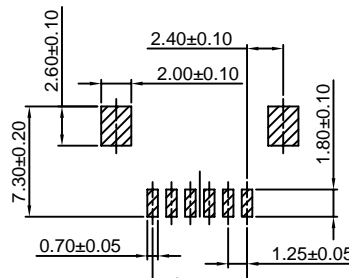
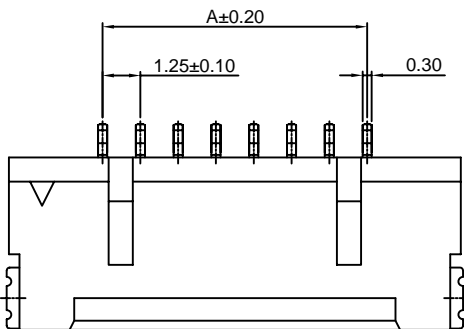
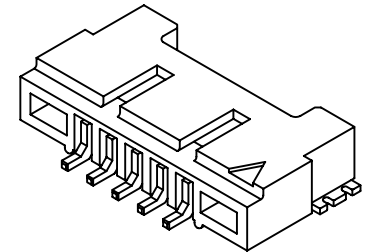

P.C.B. LAYOUT

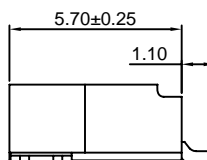
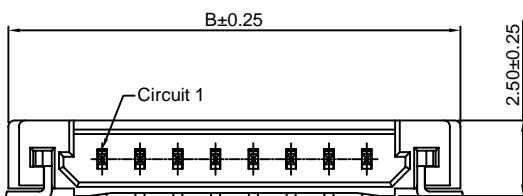

**Ordering Information & Dimensions:**

PART NO.	Dimensions	
	A	B
2P	1.25	7.45
3P	2.50	8.70
4P	3.75	9.95
5P	5.00	11.20
6P	6.25	12.45
7P	7.50	13.70
8P	8.75	14.95
9P	10.00	16.20
10P	11.25	17.45
11P	12.50	18.70
12P	13.75	19.95
13P	15.00	21.20
14P	16.25	22.45
15P	17.50	23.70
20P	23.75	29.95
25P	30.00	36.20
30P	36.25	42.45

Unit: mm

### A1255WR-S-F-XP

1.25mm pitch 90° Wafer With Boss-SMT TYPE

**Reference Informations:**

- \*Material:Pin:Brass/Tin over Nickel  
Solder Tabs:Brass/Tin over Nickel  
Insulator:Nylon 9T,UL94V-0
- \*Mates with CJT A1255H-XP series Housing
- \*Color:Ivory

**Ordering Information:**

- A1255WR-S-F-XP - \*\*\* - \*\*  
 1                      2                      3
- 1.Part No.
  - 2.Material:  
(Blank):Nylon 9T,UL94V-0  
GWT:Nylon 9T,UL94V-0,GWT 750°C
  - 3.Finish:  
(Blank):Tin over Nickel  
G:Gold over Nickel

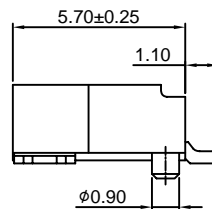
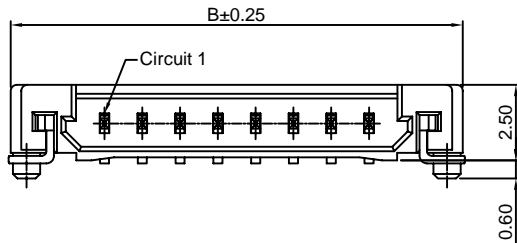
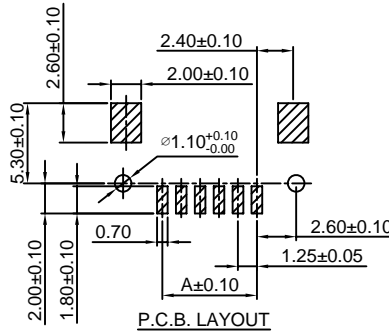
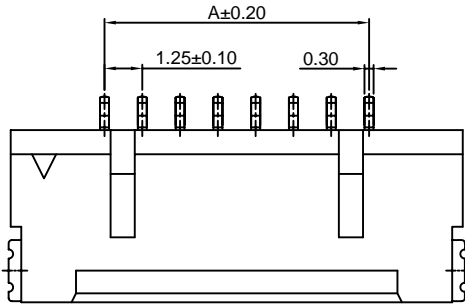
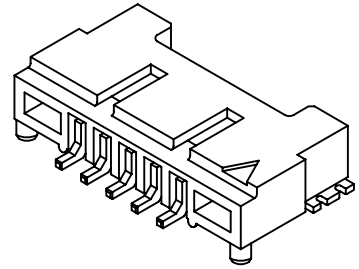

**Ordering Information & Dimensions:**

PART NO.	Dimensions	
	A	B
2P	1.25	7.45
3P	2.50	8.70
4P	3.75	9.95
5P	5.00	11.20
6P	6.25	12.45
7P	7.50	13.70
8P	8.75	14.95
9P	10.00	16.20
10P	11.25	17.45
11P	12.50	18.70
12P	13.75	19.95
13P	15.00	21.20
14P	16.25	22.45
15P	17.50	23.70
20P	23.75	29.95
25P	30.00	36.20
30P	36.25	42.45

Unit: mm

### A1255WVA-S-XP

1.25mm pitch 180° Wafer Without Boss -SMT TYPE

**Reference Informations:**

- \*Material:Pin:Brass/Tin over Nickel  
Solder Tabs:Brass/Tin over Nickel  
Insulator:Nylon 6T,UL94V-0
- \*Mates with CJT A1255HA-XP series Housing
- \*Color:Beige

**Ordering Information:**

- A1255WVA-S-XP - \*\*\* - \*\*  
 1                      2                      3
- 1.Part No.
  - 2.Material:  
(Blank):Nylon 6T,UL94V-0  
GWT:Nylon 6T,UL94V-0,GWT 750°C
  - 3.Finish:  
(Blank):Tin over Nickel  
G:Gold over Nickel

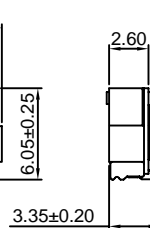
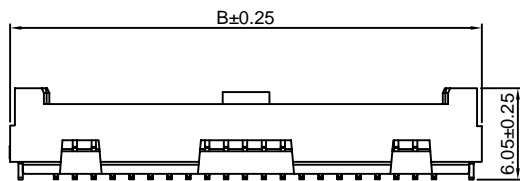
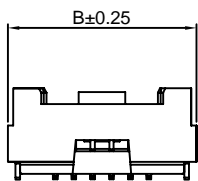
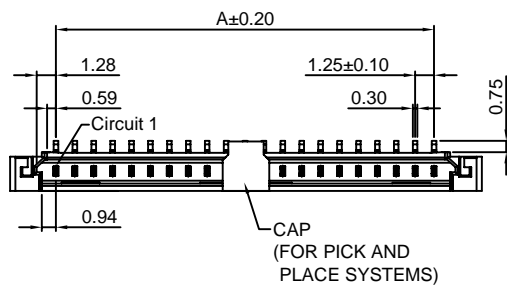
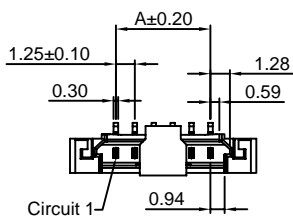
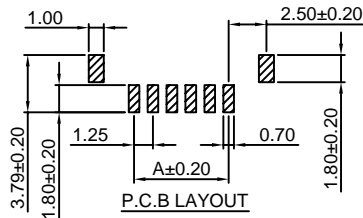
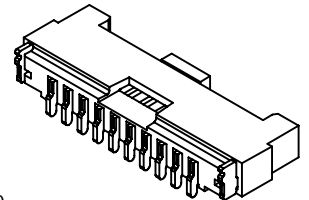

2P~15P,20P

25P,30P

**Ordering Information & Dimensions:**

PART NO.	Dimensions	
	A	B
2P	1.25	7.45
3P	2.50	8.70
4P	3.75	9.95
5P	5.00	11.20
6P	6.25	12.45
7P	7.50	13.70
8P	8.75	14.95
9P	10.00	16.20
10P	11.25	17.45
11P	12.50	18.70
12P	13.75	19.95
13P	15.00	21.20
14P	16.25	22.45
15P	17.50	23.70
20P	23.75	29.95
25P	30.00	36.20
30P	36.25	42.45

Unit: mm

### A1255WRA-S-XP

1.25mm pitch 90° Wafer Without Boss -SMT TYPE

#### Reference Informations:

- \*Material: Pin: Brass/Tin over Nickel  
Solder Tabs: Brass/Tin over Nickel  
Insulator: Nylon 6T, UL94V-0
- \*Mates with CJT A1255HA-XP series Housing
- \*Color: Beige

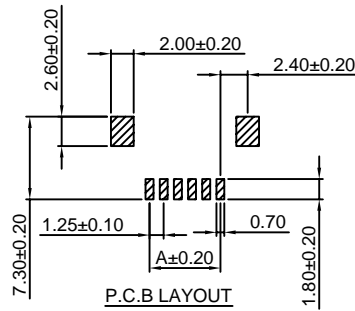

#### Ordering Information:

A1255WRA-S-XP - \*\*\* - \*\*  
1 2 3

1. Part No.
2. Material:  
(Blank): Nylon 6T, UL94V-0  
GWT: Nylon 6T, UL94V-0, GWT 750°C
3. Finish:  
(Blank): Tin over Nickel  
G: Gold over Nickel

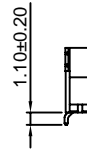
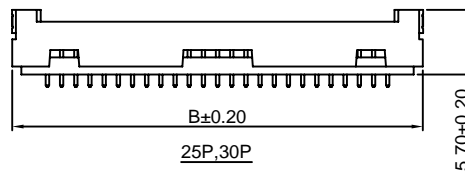
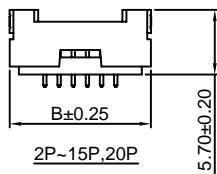
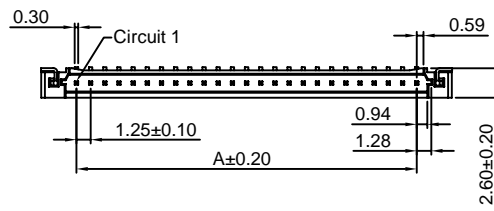
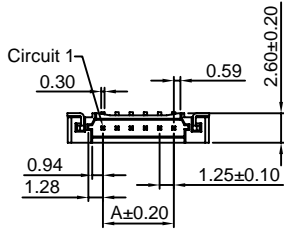
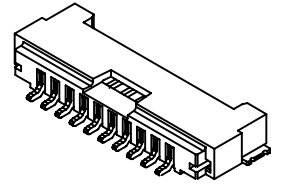

#### Ordering Information & Dimensions:

PART NO.	Dimensions	
	A	B
2P	1.25	7.45
3P	2.50	8.70
4P	3.75	9.95
5P	5.00	11.20
6P	6.25	12.45
7P	7.50	13.70
8P	8.75	14.95
9P	10.00	16.20
10P	11.25	17.45
11P	12.50	18.70
12P	13.75	19.95
13P	15.00	21.20
14P	16.25	22.45
15P	17.50	23.70
20P	23.75	29.95
25P	30.00	36.20
30P	36.25	42.45

Unit: mm

## X-ON Electronics

Largest Supplier of Electrical and Electronic Components

*Click to view similar products for [Headers & Wire Housings](#) category:*

*Click to view products by [Changjiang](#) manufacturer:*

Other Similar products are found below :

[57102-F02-18ULF](#) [58102-G61-06LF](#) [582553-1](#) [009176003701906](#) [0050291907](#) [02.125.8002.8](#) [609-3404](#) [61062-3](#) [622-0430](#) [622-3653LF](#)  
[63453-116](#) [636-1030](#) [636-1427](#) [636-3427](#) [636-4007](#) [641938-9](#) [65495-038](#) [65692-001LF](#) [65781-018](#) [65781-047](#) [65817-010LF](#) [65817-015LF](#)  
[66207-023LF](#) [67016-026LF](#) [67095-007LF](#) [68631-112](#) [68645-018](#) [68648-049](#) [699319-000](#) [M90C108951C](#) [70.362.1628.0](#) [70-4210](#) [70-4226B](#)  
[70-4853B](#) [707-5020](#) [707-5028](#) [71.350.2428.0](#) [71961-016LF](#) [733-134](#) [754199-000](#) [760-3052](#) [787-8014-00](#) [FCN-367T-T012/H](#)  
[80.063.4001.1](#) [800-90-001-10-001000](#) [801-43-002-10-013000](#) [801-43-006-10-002000](#) [803-41-018-10-001000](#) [803-43-014-20-001000](#)  
[803-43-024-10-001000](#)