

### Specifications

- Current rating: 1A AC, DC
- Voltage rating: 100V AC, DC
- Temperature range: -40°C ~ +105°C
- Contact resistance: 20mΩ Max.
- Insulation resistance: 500MΩ Min.
- Withstanding voltage: 500V AC/minute
- \*Compliant with RoHS and REACH\*
- \*Meet the HF/Halogen Free, need to customize\*
- \*Contact CJT for details\*

### Standards



### Assembly layout

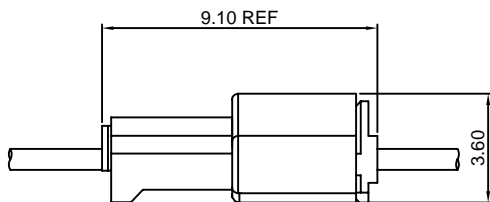

wire to wire

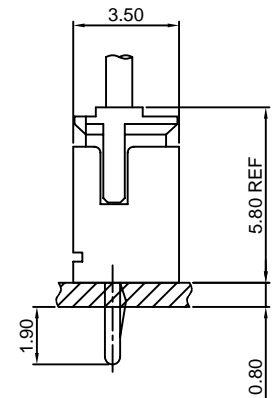
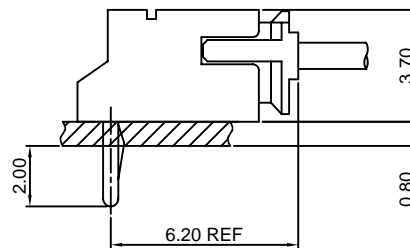

DIP TYPE

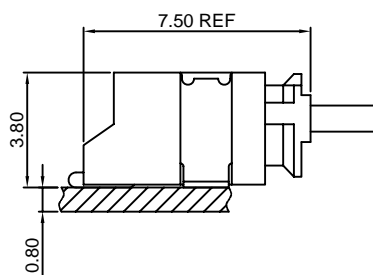
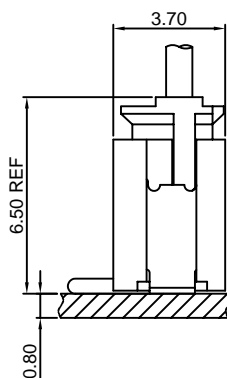

SMT TYPE

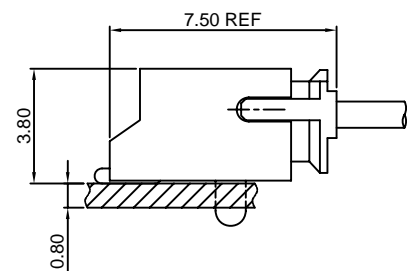

# A1501-T

1.50mm pitch Crimp Terminal

**Reference Informations:**

\*Used in CJT A1501H-XP series Housing

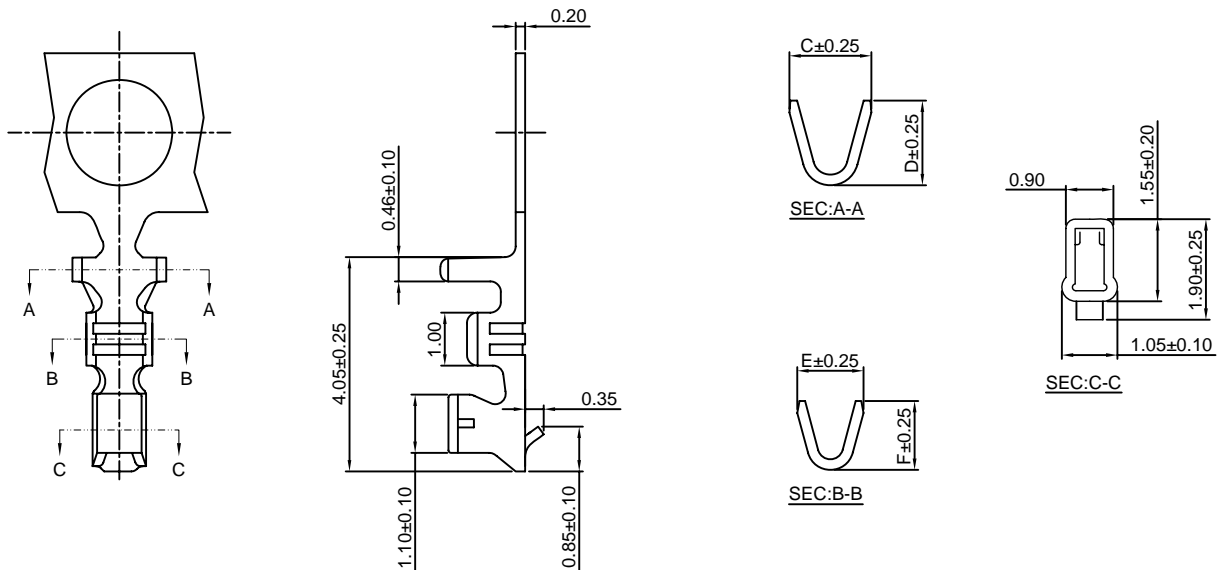
**Ordering information & Specifications:**

Unit:mm

| Part NO.   | Wire Range | Insulation O.D. | Material        | Finish           | C    | D    | E    | F    | Qty/reel   |
|------------|------------|-----------------|-----------------|------------------|------|------|------|------|------------|
| A1501-TP   | AWG#26-#32 | 1.10mm(max)     | Phosphor Bronze | Tin over Nickel  | 1.55 | 1.60 | 1.25 | 1.30 | 10,000 PCS |
| A1501-GP   | AWG#26-#32 | 1.10mm(max)     | Phosphor Bronze | Gold over Nickel | 1.55 | 1.60 | 1.25 | 1.30 | 10,000 PCS |
| A1501-TP-H | AWG#24-#30 | 1.50mm(max)     | Phosphor Bronze | Tin over Nickel  | 1.80 | 1.85 | 1.25 | 1.30 | 15,000 PCS |
| A1501-GP-H | AWG#24-#30 | 1.50mm(max)     | Phosphor Bronze | Gold over Nickel | 1.80 | 1.85 | 1.25 | 1.30 | 15,000 PCS |

Optional Gold plating available but MOQ requested

# A1501-T-A

1.50mm pitch Crimp Terminal

**Reference Informations:**

\*Used in CJT A1501HA-XP series Housing

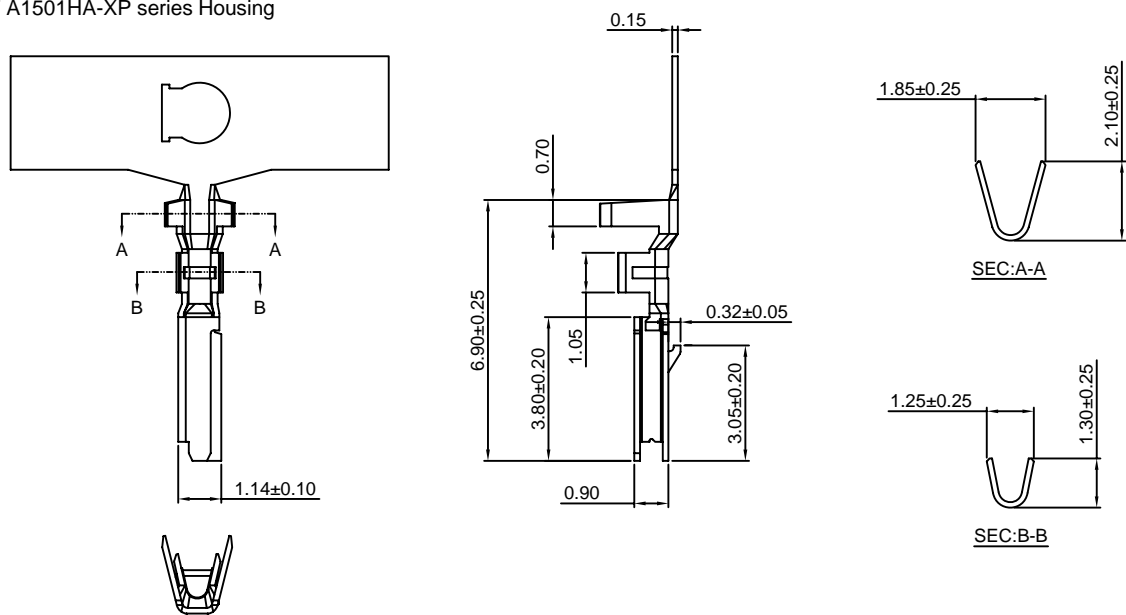
**Ordering information & Specifications:**

Unit:mm

| Part NO.   | Wire Range | Insulation O.D. | Material        | Finish           | Qty/reel   |
|------------|------------|-----------------|-----------------|------------------|------------|
| A1501-TP-A | AWG#24-#28 | 1.28mm(max)     | Phosphor Bronze | Tin over Nickel  | 10,000 PCS |
| A1501-GP-A | AWG#24-#28 | 1.28mm(max)     | Phosphor Bronze | Gold over Nickel | 10,000 PCS |

Optional Gold plating available but MOQ requested

# A1501-T-B

1.50mm pitch Crimp Terminal

**Reference Informations:**

\*Used in CJT A1501HB-XP series Housing

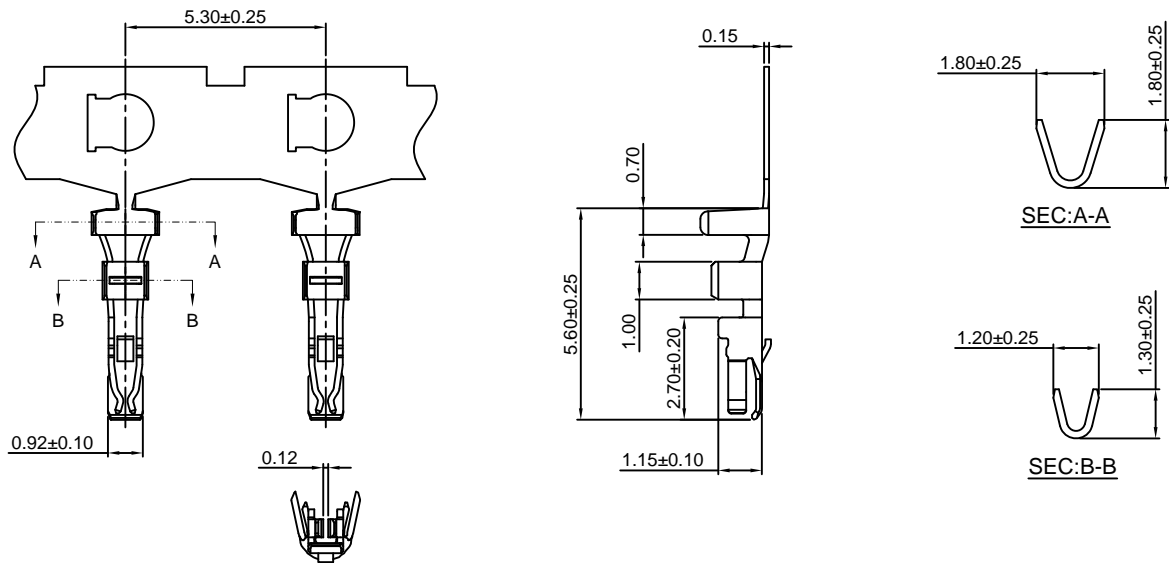

Ordering information &amp; Specifications:

Unit:mm

| Part NO.   | Wire Range | Insulation O.D. | Material        | Finish           | Qty/reel   |
|------------|------------|-----------------|-----------------|------------------|------------|
| A1501-GP-B | AWG#28-#32 | 1.10mm(max)     | Phosphor Bronze | Gold over Nickel | 10,000 PCS |

# A1501M-T

1.50mm pitch Crimp Terminal

**Reference Informations:**

\*Used in CJT A1501HM-XP series Housing

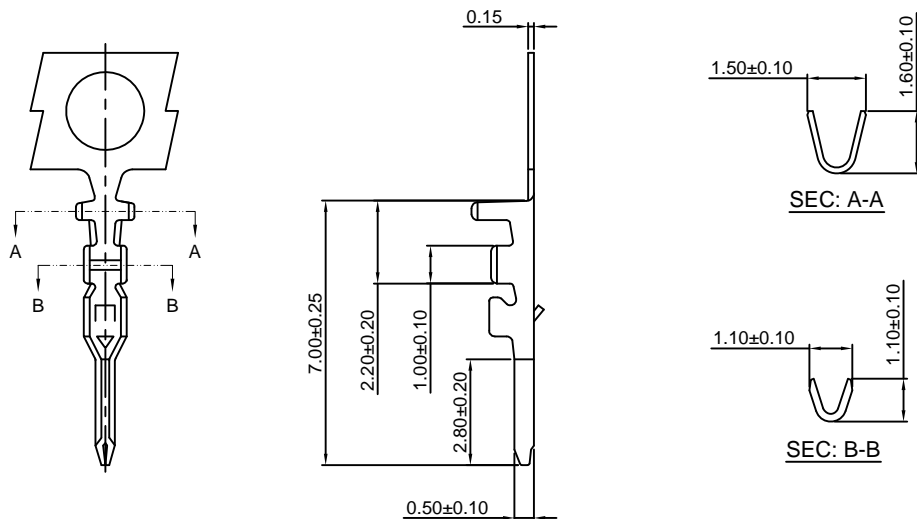

Ordering information &amp; Specifications:

Unit:mm

| Part NO.  | Wire Range | Insulation O.D. | Material        | Finish           | Qty/reel   |
|-----------|------------|-----------------|-----------------|------------------|------------|
| A1501M-TP | AWG#28-#32 | 0.90mm(max)     | Phosphor Bronze | Tin over Nickel  | 15,000 PCS |
| A1501M-GP | AWG#28-#32 | 0.90mm(max)     | Phosphor Bronze | Gold over Nickel | 15,000 PCS |

Optional Gold plating available but MOQ requested

### A1501H-XP

1.50mm pitch Housing

**Reference Informations:**

- \*Material:Nylon 66,UL94V-0
- \*Suitable CJT A1501-T(H) series Terminal
- \*Mates with CJT A1501HM-XP series Housing and A1501WV,WR,WV-S,WR-S-XP series Wafer
- \*Color:White

**Ordering Information:**

A1501H-XP - \*\*\* - \*\*\*  
1 2 3

- 1.Part No.
- 2.Material:  
(Blank):Nylon 66,UL94V-0  
GWT:Nylon 66,UL94V-0 GWT 750 °C
- 3.Color:  
(Blank):White  
BK:Black           GY:Gray  
RD:Red           LE:Light blue  
BL:Blue           LY:Lemon yellow  
GN:Green        DO:Dark orange

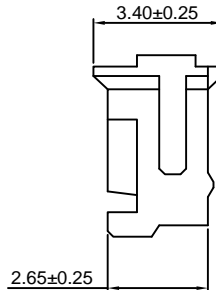
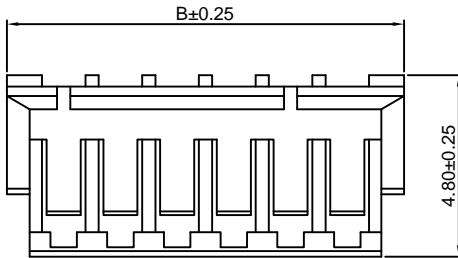
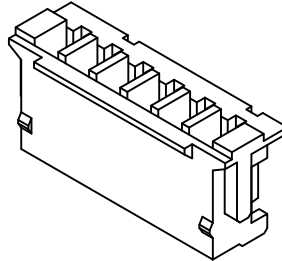
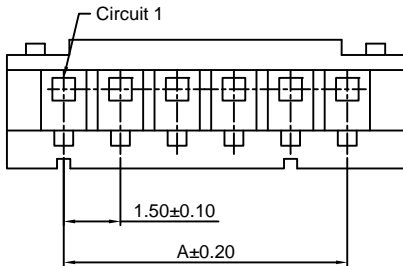

**Ordering Information & Dimensions:**

| PART NO. | Dimensions |       |
|----------|------------|-------|
|          | A          | B     |
| 2P       | 1.50       | 4.50  |
| 3P       | 3.00       | 6.00  |
| 4P       | 4.50       | 7.50  |
| 5P       | 6.00       | 9.00  |
| 6P       | 7.50       | 10.50 |
| 7P       | 9.00       | 12.00 |
| 8P       | 10.50      | 13.50 |
| 9P       | 12.00      | 15.00 |
| 10P      | 13.50      | 16.50 |
| 11P      | 15.00      | 18.00 |
| 12P      | 16.50      | 19.50 |
| 13P      | 18.00      | 21.00 |
| 15P      | 21.00      | 24.00 |

Unit: mm

### A1501HA-XP

1.50mm pitch Housing

**Reference Informations:**

- \*Material:PBT,UL94V-0
- \*Suitable CJT A1501-T-A series Terminal
- \*Mates with CJT A1501WVA-S,WRA-S-XP series Wafer
- \*Color:Beige

**Ordering Information:**

A1501HA-XP - \*\*\*  
1 2

- 1.Part No.
- 2.Material:  
(Blank):PBT,UL94V-0  
GWT:PBT,UL94V-0 GWT 750 °C

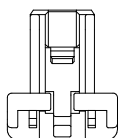
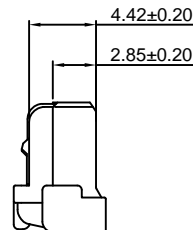
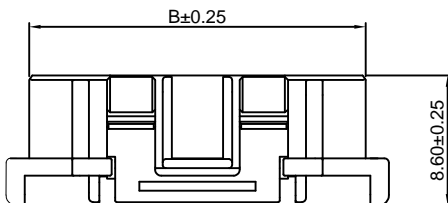
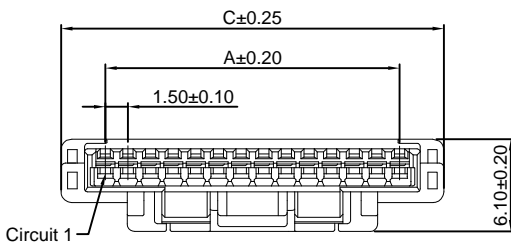
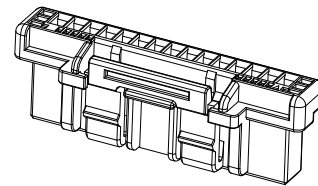

2P,3P

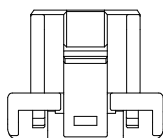

4P,5P

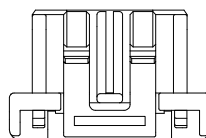

6P~15P

**Ordering Information & Dimensions:**

| PART NO. | Dimensions |       |       |
|----------|------------|-------|-------|
|          | A          | B     | C     |
| 2P       | 1.50       | 4.25  | 7.30  |
| 3P       | 3.00       | 5.75  | 8.80  |
| 4P       | 4.50       | 7.25  | 10.30 |
| 5P       | 6.00       | 8.75  | 11.80 |
| 6P       | 7.50       | 10.25 | 13.30 |
| 7P       | 9.00       | 11.75 | 14.80 |
| 8P       | 10.50      | 13.25 | 16.30 |
| 9P       | 12.00      | 14.75 | 17.80 |
| 10P      | 13.50      | 16.25 | 19.30 |
| 11P      | 15.00      | 17.75 | 20.80 |
| 12P      | 16.50      | 19.25 | 22.30 |
| 13P      | 18.00      | 20.75 | 23.80 |
| 14P      | 19.50      | 22.25 | 25.30 |
| 15P      | 21.00      | 23.75 | 26.80 |

Unit: mm

### A1501HB-XP

1.50mm pitch Housing

**Reference Informations:**

- \*Material:Nylon 66,UL94V-0
- \*Suitable CJT A1501-T-B series Terminal
- \*Mates with CJT A1501WRB-S-XP series Wafer
- \*Color:Black

**Ordering Information:**

- A1501HB-XP - \*\*\*  
 1 2  
 1.Part No.  
 2.Material:  
 (Blank):Nylon 66,UL94V-0  
 GWT:Nylon 66,UL94V-0 GWT 750 °C

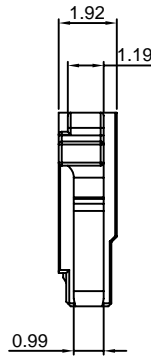
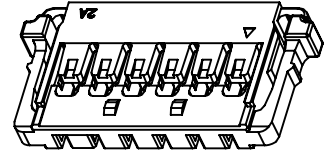
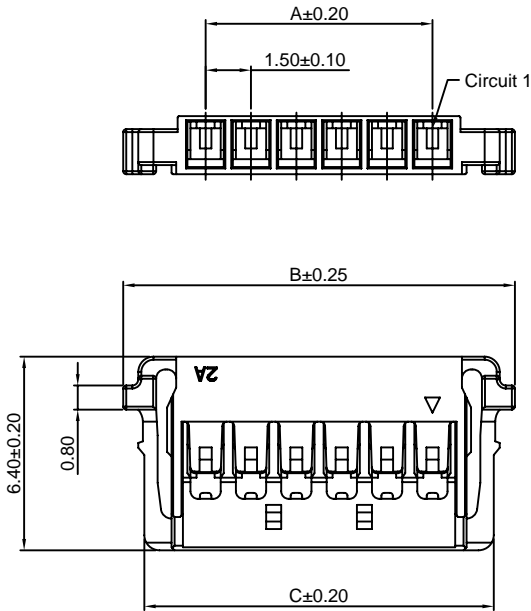

**Ordering Information & Dimensions:**

| PART NO. | Dimensions |       |       |
|----------|------------|-------|-------|
|          | A          | B     | C     |
| 2P       | 1.50       | 6.95  | 5.55  |
| 3P       | 3.00       | 8.45  | 7.05  |
| 4P       | 4.50       | 9.95  | 8.55  |
| 5P       | 6.00       | 11.45 | 10.05 |
| 6P       | 7.50       | 12.95 | 11.55 |
| 7P       | 9.00       | 14.45 | 13.05 |
| 8P       | 10.50      | 15.95 | 14.55 |
| 9P       | 12.00      | 17.45 | 16.05 |
| 10P      | 13.50      | 18.95 | 17.55 |
| 11P      | 15.00      | 20.45 | 19.05 |
| 12P      | 16.50      | 21.95 | 20.55 |

Unit: mm

### A1501HM-XP

1.50mm pitch Housing

**Reference Informations:**

- \*Material:Nylon 66,UL94V-0
- \*Suitable CJT A1501M-T series Terminal
- \*Mates with CJT A1501H-XP series Housing
- \*Color:White

**Ordering Information:**

- A1501HM-XP - \*\*\*  
 1 2  
 1.Part No.  
 2.Material:  
 (Blank):Nylon 66,UL94V-0  
 GWT:Nylon 66,UL94V-0 GWT 750 °C

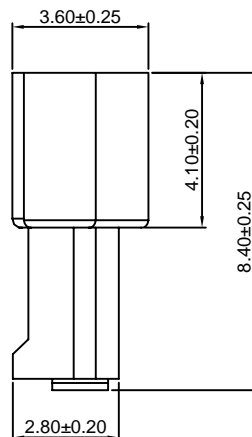
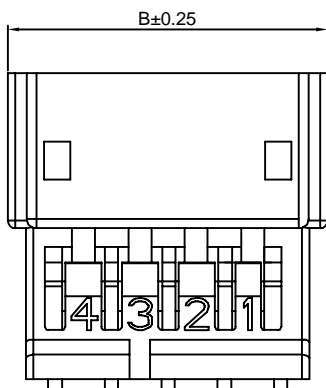
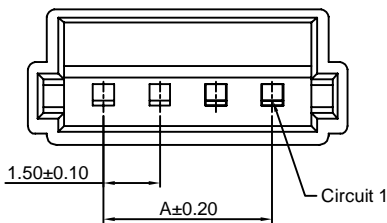

**Ordering Information & Dimensions:**

| PART NO. | Dimensions |       |
|----------|------------|-------|
|          | A          | B     |
| 2P       | 1.50       | 5.55  |
| 3P       | 3.00       | 7.05  |
| 4P       | 4.50       | 8.55  |
| 5P       | 6.00       | 10.05 |
| 6P       | 7.50       | 11.55 |
| 7P       | 9.00       | 13.05 |
| 8P       | 10.50      | 14.55 |
| 9P       | 12.00      | 16.05 |
| 10P      | 13.50      | 17.55 |
| 11P      | 15.00      | 19.05 |
| 12P      | 16.50      | 20.55 |
| 13P      | 18.00      | 22.05 |

Unit: mm

### A1501WV-XP

1.50mm pitch 180° Wafer

#### Reference Informations:

- \*Material: Pin: Brass/Tin over Nickel  
Insulator: Nylon 66, UL94V-0
- \*Mates with CJT A1501H-XP series Housing
- \*Color: Ivory

#### Ordering Information:

A1501WV-XP - \*\*\* - \*\* - \*\*  
1 2 3 4

1. Part No.
2. Material:  
(Blank): Nylon 66, UL94V-0  
GWT: Nylon 66, UL94V-0, GWT 750 °C
3. Color:  
(blank): Ivory  
BK: Black  
RD: Red  
BL: Blue  
GN: Green  
YL: Yellow
4. Finish:  
(Blank): Tin over Nickel  
G: Gold over Nickel

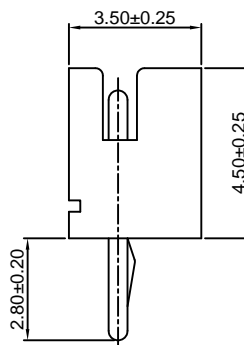
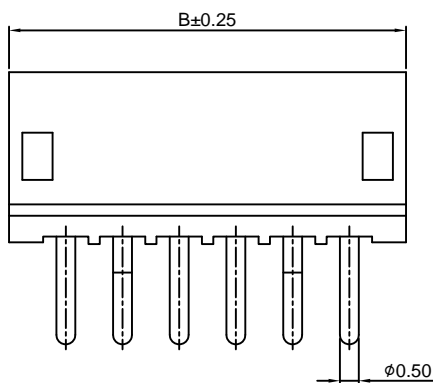
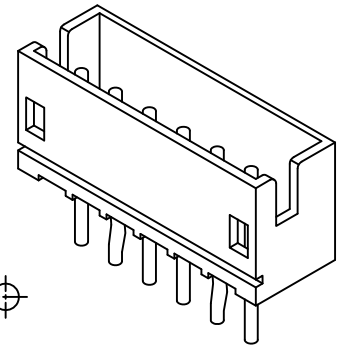
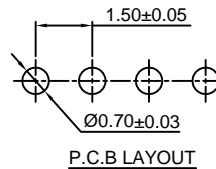
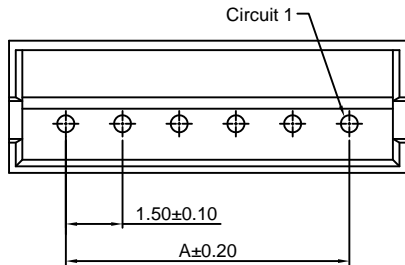

#### Ordering Information & Dimensions:

| PART NO. | Dimensions |       |
|----------|------------|-------|
|          | A          | B     |
| 2P       | 1.50       | 4.50  |
| 3P       | 3.00       | 6.00  |
| 4P       | 4.50       | 7.50  |
| 5P       | 6.00       | 9.00  |
| 6P       | 7.50       | 10.50 |
| 7P       | 9.00       | 12.00 |
| 8P       | 10.50      | 13.50 |
| 9P       | 12.00      | 15.00 |
| 10P      | 13.50      | 16.50 |
| 11P      | 15.00      | 18.00 |
| 12P      | 16.50      | 19.50 |
| 13P      | 18.00      | 21.00 |
| 15P      | 21.00      | 24.00 |

Unit: mm

### A1501WR-XP

1.50mm pitch 90° Wafer

#### Reference Informations:

- \*Material: Pin: Brass/Tin over Nickel  
Insulator: Nylon 66, UL94V-0
- \*Mates with CJT A1501H-XP series Housing
- \*Color: Ivory

#### Ordering Information:

A1501WR-XP - \*\*\* - \*\* - \*\*  
1 2 3 4

1. Part No.
2. Material:  
(Blank): Nylon 66, UL94V-0  
GWT: Nylon 66, UL94V-0, GWT 750 °C
3. Color:  
(blank): Ivory  
BK: Black  
RD: Red  
BL: Blue  
GN: Green  
YL: Yellow
4. Finish:  
(Blank): Tin over Nickel  
G: Gold over Nickel

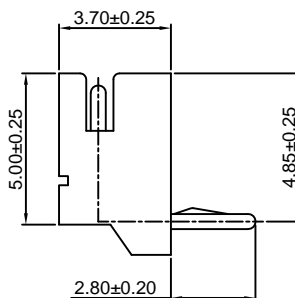
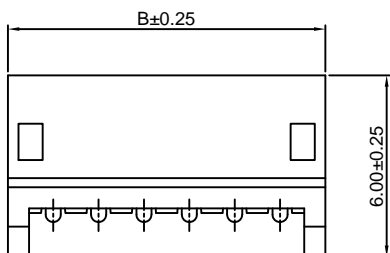
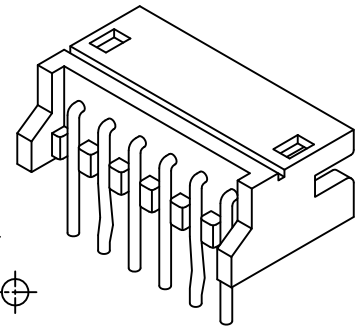
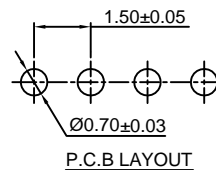
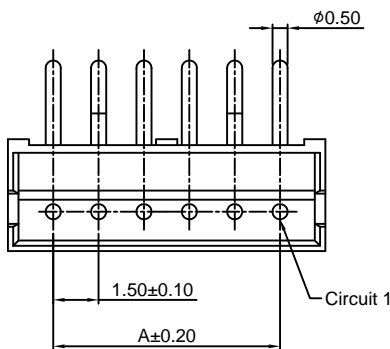

#### Ordering Information & Dimensions:

| PART NO. | Dimensions |       |
|----------|------------|-------|
|          | A          | B     |
| 2P       | 1.50       | 4.50  |
| 3P       | 3.00       | 6.00  |
| 4P       | 4.50       | 7.50  |
| 5P       | 6.00       | 9.00  |
| 6P       | 7.50       | 10.50 |
| 7P       | 9.00       | 12.00 |
| 8P       | 10.50      | 13.50 |
| 9P       | 12.00      | 15.00 |
| 10P      | 13.50      | 16.50 |
| 11P      | 15.00      | 18.00 |
| 12P      | 16.50      | 19.50 |
| 13P      | 18.00      | 21.00 |
| 15P      | 21.00      | 24.00 |

Unit: mm

## A1501WV-S-XP

1.50mm pitch 180° Wafer-SMT TYPE

### Reference Informations:

- \*Material: Pin: Brass/Tin over Nickel  
Solder Tabs: Brass/Gold over Nickel  
Insulator: Nylon 6T, UL94V-0  
Cap: Nylon 6T, UL94V-0
- \*Mates with CJT A1501H-XP series Housing
- \*Color: Ivory

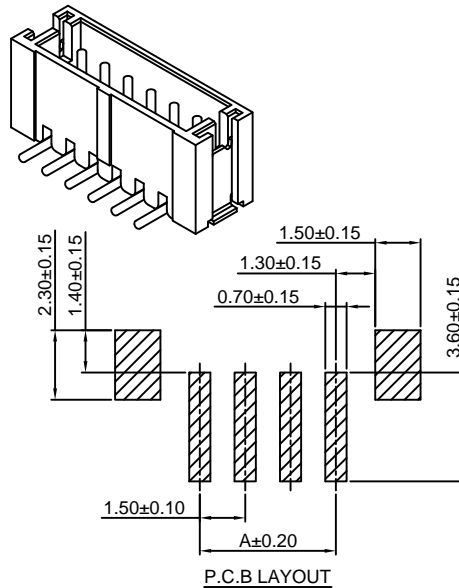
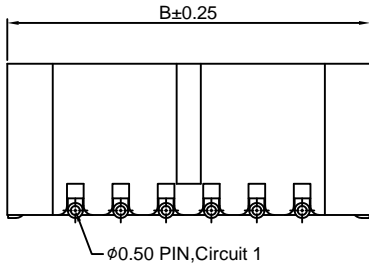
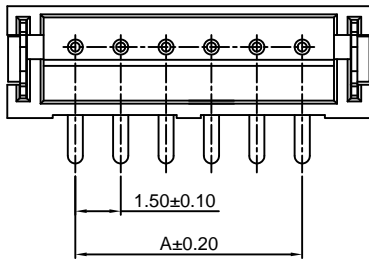

### Ordering Information:

A1501WV-S-XP - <sup>\*\*\*</sup> - <sup>\*\*</sup> - <sup>\*\*</sup>  
1 2 3 4

1. Part No.
2. Material:  
(Blank): Nylon 6T, UL94V-0  
GWT: Nylon 6T, UL94V-0, GWT 750 °C
3. Color:  
(Blank): Ivory  
BK: Black                   DH: Dark gray  
RD: Red                    LE: Light blue  
BL: Blue                   LY: Lemon yellow  
GN: Green                DO: Dark orange
4. Finish:  
(Blank): Tin over Nickel  
G: Gold over Nickel

### Ordering Information & Dimensions:

| PART NO. | Dimensions |       |
|----------|------------|-------|
|          | A          | B     |
| 2P       | 1.50       | 6.00  |
| 3P       | 3.00       | 7.50  |
| 4P       | 4.50       | 9.00  |
| 5P       | 6.00       | 10.50 |
| 6P       | 7.50       | 12.00 |
| 7P       | 9.00       | 13.50 |
| 8P       | 10.50      | 15.00 |
| 9P       | 12.00      | 16.50 |
| 10P      | 13.50      | 18.00 |
| 11P      | 15.00      | 19.50 |
| 12P      | 16.50      | 21.00 |
| 13P      | 18.00      | 22.50 |

Unit: mm

## A1501WR-S-XP

1.50mm pitch 90° Wafer-SMT TYPE

### Reference Informations:

- \*Material: Pin: Brass/Tin over Nickel  
Solder Tabs: Brass/Gold over Nickel  
Insulator: Nylon 6T, UL94V-0
- \*Mates with CJT A1501H-XP series Housing
- \*Color: Ivory

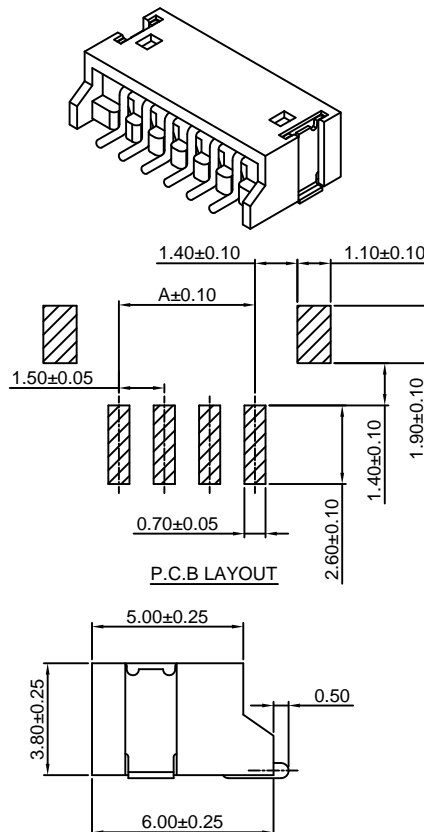
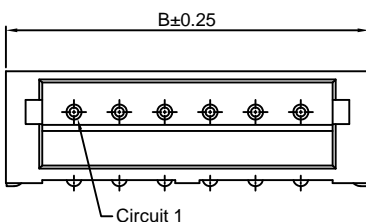
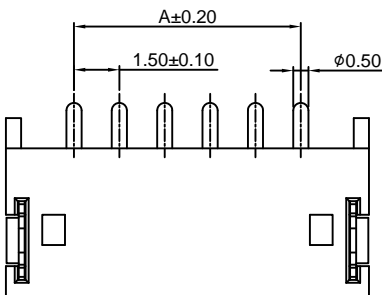

### Ordering Information:

A1501WR-S-XP - <sup>\*\*\*</sup> - <sup>\*\*</sup> - <sup>\*\*</sup>  
1 2 3 4

1. Part No.
2. Material:  
(Blank): Nylon 6T, UL94V-0  
GWT: Nylon 6T, UL94V-0 GWT 750 °C
3. Color:  
(Blank): Ivory  
BK: Black                   DH: Dark gray  
RD: Red                    LE: Light blue  
BL: Blue                   LY: Lemon yellow  
GN: Green                DO: Dark orange
4. Finish:  
(Blank): Tin over Nickel  
G: Gold over Nickel

### Ordering Information & Dimensions:

| PART NO. | Dimensions |       |
|----------|------------|-------|
|          | A          | B     |
| 2P       | 1.50       | 6.00  |
| 3P       | 3.00       | 7.50  |
| 4P       | 4.50       | 9.00  |
| 5P       | 6.00       | 10.50 |
| 6P       | 7.50       | 12.00 |
| 7P       | 9.00       | 13.50 |
| 8P       | 10.50      | 15.00 |
| 9P       | 12.00      | 16.50 |
| 10P      | 13.50      | 18.00 |
| 11P      | 15.00      | 19.50 |
| 12P      | 16.50      | 21.00 |
| 13P      | 18.00      | 22.50 |

Unit: mm

### A1501WR-S-XP-A

1.50mm pitch 90° Wafer DIP SMT TYPE

#### Reference Informations:

- \*Material: Pin: Brass/Tin over Nickel  
Solder Tabs: Brass/Gold over Nickel  
Insulator: Nylon 6T, UL94V-0
- \*Mates with CJT A1501H-XP series Housing
- \*Color: Ivory

Ordering Information:  
A1501WR-S-XP-A - \*\*\* - \*\*  
1 2 3

1. Part No.
2. Material:  
(Blank): Nylon 6T, UL94V-0  
GWT: Nylon 6T, UL94V-0 GWT 750 °C
3. Finish:  
(Blank): Tin over Nickel  
G: Gold over Nickel

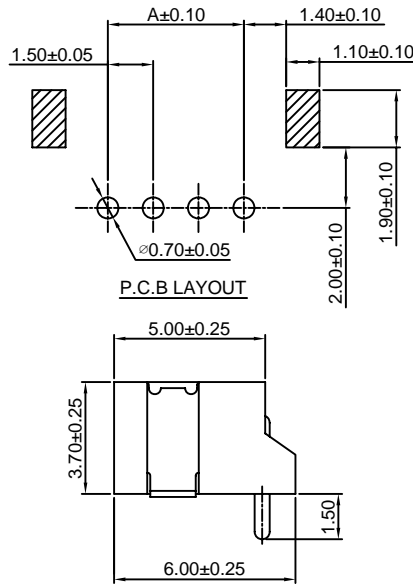
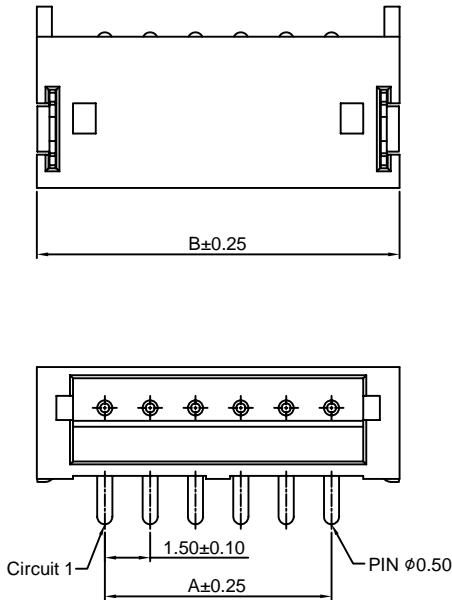
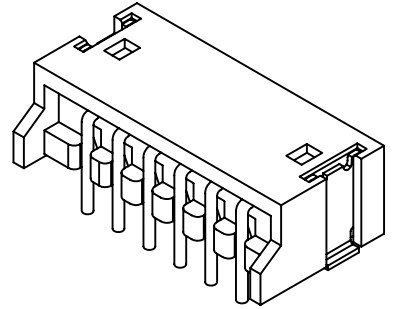

#### Ordering Information & Dimensions:

| PART NO. | Dimensions |       |
|----------|------------|-------|
|          | A          | B     |
| 2P       | 1.50       | 6.00  |
| 3P       | 3.00       | 7.50  |
| 4P       | 4.50       | 9.00  |
| 5P       | 6.00       | 10.50 |
| 6P       | 7.50       | 12.00 |
| 7P       | 9.00       | 13.50 |
| 8P       | 10.50      | 15.00 |
| 9P       | 12.00      | 16.50 |
| 10P      | 13.50      | 18.00 |
| 11P      | 15.00      | 19.50 |
| 12P      | 16.50      | 21.00 |
| 13P      | 18.00      | 22.50 |

Unit: mm

### A1501WVA-S-XP

1.50mm pitch 180° Wafer-SMT TYPE

#### Reference Informations:

- \*Material: Pin: Phosphor Bronze/Tin over Nickel  
Solder Tabs: Brass/Tin over Nickel  
Insulator: LCP, UL94V-0
- \*Mates with CJT A1501HA-XP series Housing
- \*Color: Ivory

Ordering Information:  
A1501WVA-S-XP - \*\*\* - \*\*  
1 2 3

1. Part No.
2. Material:  
(blank): LCP, UL94V-0  
GWT: LCP, UL94V-0 GWT 750 °C
3. Finish:  
(Blank): Tin over Nickel  
G: Gold over Nickel

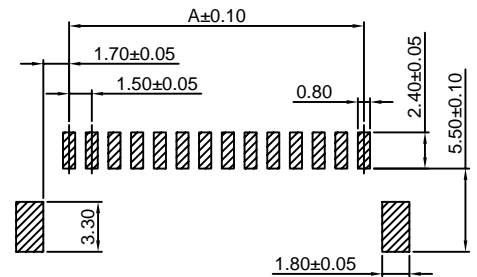

P.C.B LAYOUT

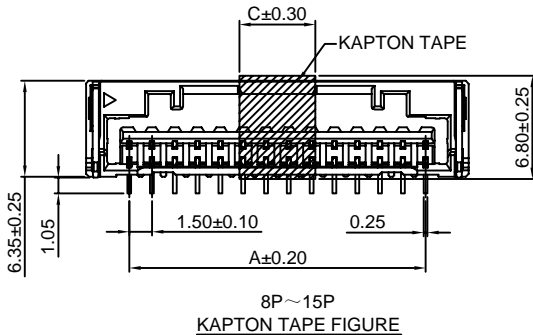

8P~15P KAPTON TAPE FIGURE

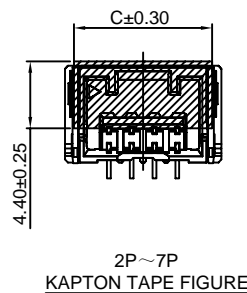

2P~7P KAPTON TAPE FIGURE

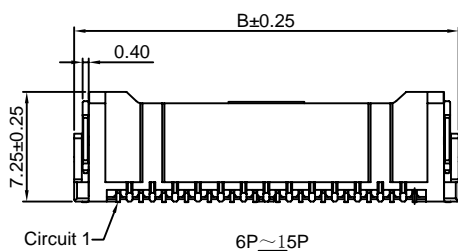

6P~15P

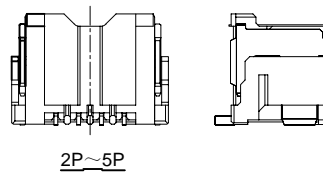

2P~5P

#### Ordering Information & Dimensions:

| PART NO. | Dimensions |       |       |
|----------|------------|-------|-------|
|          | A          | B     | C     |
| 2P       | 1.50       | 7.30  | 6.10  |
| 3P       | 3.00       | 8.80  | 7.60  |
| 4P       | 4.50       | 10.30 | 9.10  |
| 5P       | 6.00       | 11.80 | 10.60 |
| 6P       | 7.50       | 13.30 | 12.10 |
| 7P       | 9.00       | 14.80 | 13.60 |
| 8P       | 10.50      | 16.30 | 5.00  |
| 9P       | 12.00      | 17.80 | 5.00  |
| 10P      | 13.50      | 19.30 | 5.00  |
| 11P      | 15.00      | 20.80 | 5.00  |
| 12P      | 16.50      | 22.30 | 5.00  |
| 13P      | 18.00      | 23.80 | 5.00  |
| 14P      | 19.50      | 25.30 | 5.00  |
| 15P      | 21.00      | 26.80 | 5.00  |

Unit: mm



### A1501WRA-S-XP

1.50mm pitch 90° Wafer-SMT TYPE

#### Reference Informations:

- \*Material: Pin: Phosphor Bronze/Tin over Nickel  
Solder Tabs: Brass/Tin over Nickel  
Insulator: LCP, UL94V-0
- \*Mates with CJT A1501HA-XP series Housing
- \*Color: Ivory

#### Ordering Information:

A1501WRA-S-XP - \*\*\* - \*\*  
1 2 3

1. Part No.
2. Material:  
(Blank): LCP, UL94V-0  
GWT: LCP, UL94V-0 GWT 750°C
3. Finish:  
(Blank): Tin over Nickel  
G: Gold over Nickel

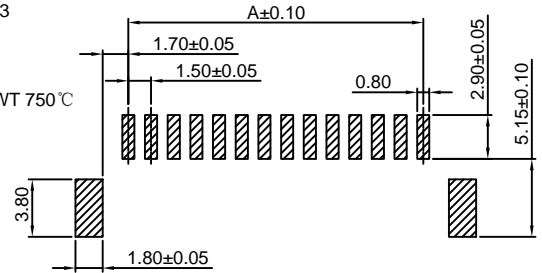
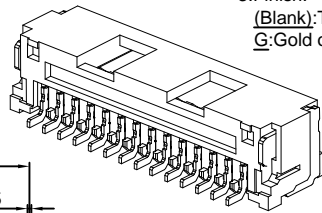

P.C.B LAYOUT

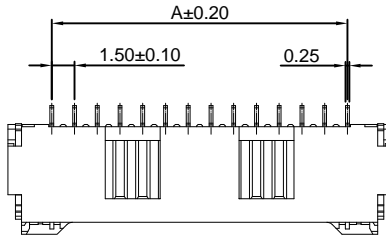

6P~15P

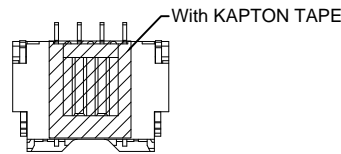

2P~5P

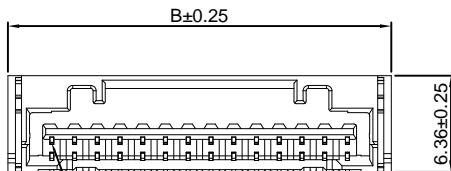

Circuit 1



#### Ordering Information & Dimensions:

| PART NO. | Dimensions |       |
|----------|------------|-------|
|          | A          | B     |
| 2P       | 1.50       | 7.30  |
| 3P       | 3.00       | 8.80  |
| 4P       | 4.50       | 10.30 |
| 5P       | 6.00       | 11.80 |
| 6P       | 7.50       | 13.30 |
| 7P       | 9.00       | 14.80 |
| 8P       | 10.50      | 16.30 |
| 9P       | 12.00      | 17.80 |
| 10P      | 13.50      | 19.30 |
| 11P      | 15.00      | 20.80 |
| 12P      | 16.50      | 22.30 |
| 13P      | 18.00      | 23.80 |
| 14P      | 19.50      | 25.30 |
| 15P      | 21.00      | 26.80 |

Unit: mm

### A1501WRB-S-XP

1.50mm pitch 90° Wafer-SMT TYPE

#### Reference Informations:

- \*Material: Pin: Brass/Gold over Nickel  
Insulator: Nylon 9T, UL94V-0
- \*Mates with CJT A1501HB-XP series Housing
- \*Color: Black

#### Ordering Information:

A1501WRB-S-XP - \*\*\*  
1 2

1. Part No.
2. Material:  
(Blank): Nylon 9T, UL94V-0  
GWT: Nylon 9T, UL94V-0, GWT 750°C

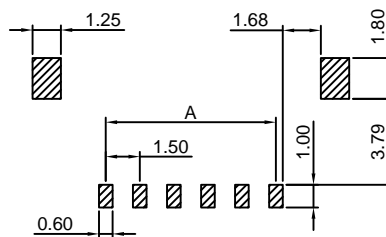
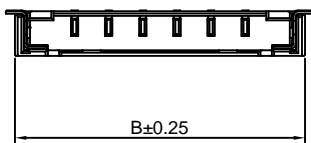

P.C.B LAYOUT

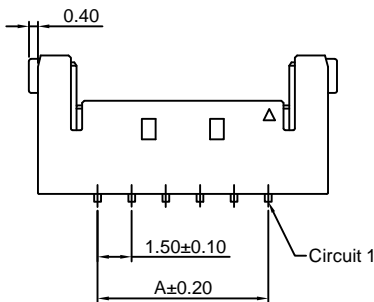

Circuit 1

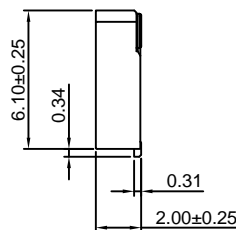

#### Ordering Information & Dimensions:

| PART NO. | Dimensions |       |
|----------|------------|-------|
|          | A          | B     |
| 2P       | 1.50       | 6.75  |
| 3P       | 3.00       | 8.25  |
| 4P       | 4.50       | 9.75  |
| 5P       | 6.00       | 11.25 |
| 6P       | 7.50       | 12.75 |
| 7P       | 9.00       | 14.25 |
| 8P       | 10.50      | 15.75 |
| 9P       | 12.00      | 17.25 |
| 10P      | 13.50      | 18.75 |
| 11P      | 15.00      | 20.25 |
| 12P      | 16.50      | 21.75 |

Unit: mm

### A1501WVD-S-XP

1.50mm pitch 180° Wafer-SMT TYPE

**Reference Informations:**

\*Material:Pin:Phosphor Bronze/Tin over Nickel  
Insulator:LCP,UL94V-0

\*Color:Beige

**Ordering Information:**

A1501WVD-S-XP - \*\*\* - \*\*  
1 2 3

- 1.Part No.
- 2.Material:  
(Blank):LCP,UL94V-0  
GWT:LCP,UL94V-0 GWT 750 °C
- 3.Finish:  
(Blank):Tin over Nickel  
G:Gold over Nickel

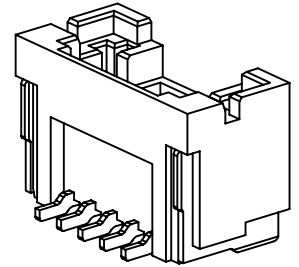
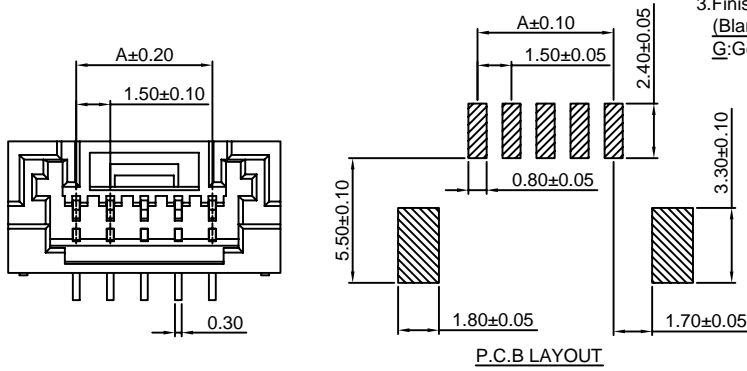

**Ordering Information & Dimensions:**

| PART NO. | Dimensions |       |
|----------|------------|-------|
|          | A          | B     |
| 2P       | 1.50       | 7.50  |
| 3P       | 3.00       | 9.00  |
| 4P       | 4.50       | 10.50 |
| 5P       | 6.00       | 12.00 |
| 6P       | 7.50       | 13.50 |
| 7P       | 9.00       | 15.00 |
| 8P       | 10.50      | 16.50 |
| 9P       | 12.00      | 18.00 |
| 10P      | 13.50      | 19.50 |
| 11P      | 15.00      | 21.00 |
| 12P      | 16.50      | 22.50 |
| 13P      | 18.00      | 24.00 |
| 14P      | 19.50      | 25.50 |
| 15P      | 21.00      | 27.00 |
| 16P      | 22.50      | 28.50 |

Unit: mm

### A1501WRD-S-XP

1.50mm pitch 90° Wafer-SMT TYPE

**Reference Informations:**

\*Material:Pin:Phosphor Bronze/Tin over Nickel  
Insulator:LCP,UL94V-0

\*Color:Beige

**Ordering Information:**

A1501WRD-S-XP - \*\*\* - \*\*  
1 2 3

- 1.Part No.
- 2.Material:  
(Blank):LCP,UL94V-0  
GWT:LCP,UL94V-0 GWT 750 °C
- 3.Finish:  
(Blank):Tin over Nickel  
G:Gold over Nickel

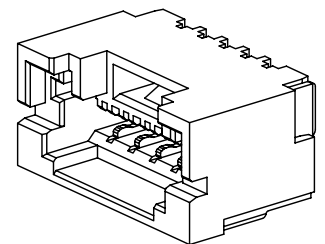
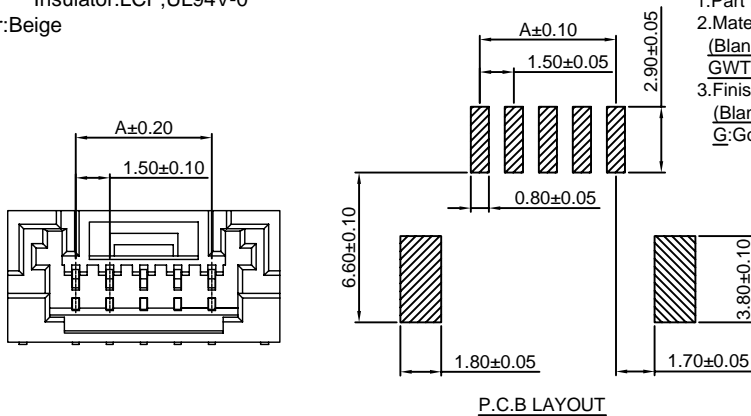

**Ordering Information & Dimensions:**

| PART NO. | Dimensions |       |
|----------|------------|-------|
|          | A          | B     |
| 2P       | 1.50       | 7.50  |
| 3P       | 3.00       | 9.00  |
| 4P       | 4.50       | 10.50 |
| 5P       | 6.00       | 12.00 |
| 6P       | 7.50       | 13.50 |
| 7P       | 9.00       | 15.00 |
| 8P       | 10.50      | 16.50 |
| 9P       | 12.00      | 18.00 |
| 10P      | 13.50      | 19.50 |
| 11P      | 15.00      | 21.00 |
| 12P      | 16.50      | 22.50 |
| 13P      | 18.00      | 24.00 |
| 14P      | 19.50      | 25.50 |
| 15P      | 21.00      | 27.00 |
| 16P      | 22.50      | 28.50 |

Unit: mm

## X-ON Electronics

Largest Supplier of Electrical and Electronic Components

*Click to view similar products for [Headers & Wire Housings](#) category:*

*Click to view products by [Changjiang](#) manufacturer:*

Other Similar products are found below :

[57102-F02-18ULF](#) [58102-G61-06LF](#) [0009485154](#) [009176003701906](#) [0050291907](#) [02.125.8002.8](#) [609-3404](#) [61062-3](#) [622-0430](#) [622-3653LF](#)  
[63453-116](#) [636-1030](#) [636-1427](#) [636-3427](#) [636-4007](#) [641938-9](#) [644827-2](#) [65495-038](#) [65692-001LF](#) [65781-018](#) [65781-047](#) [65817-010LF](#)  
[65817-015LF](#) [66207-023LF](#) [67016-026LF](#) [67095-007LF](#) [68631-112](#) [68645-018](#) [68648-049](#) [699319-000](#) [70.362.1628.0](#) [70-4210](#) [70-4226B](#)  
[70-4853B](#) [707-5020](#) [707-5028](#) [71.350.2428.0](#) [71961-016LF](#) [733-134](#) [754199-000](#) [760-3052](#) [787-8014-00](#) [FCN-367T-T012/H](#) [80.063.4001.1](#)  
[800-90-001-10-001000](#) [800-90-010-10-002000](#) [801-43-002-10-013000](#) [801-43-006-10-002000](#) [803-41-018-10-001000](#) [803-43-014-20-](#)  
[001000](#)