

P.C.B LAYOUT

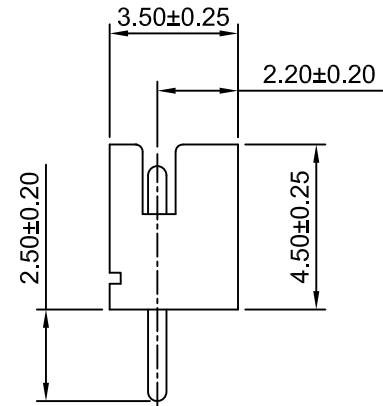
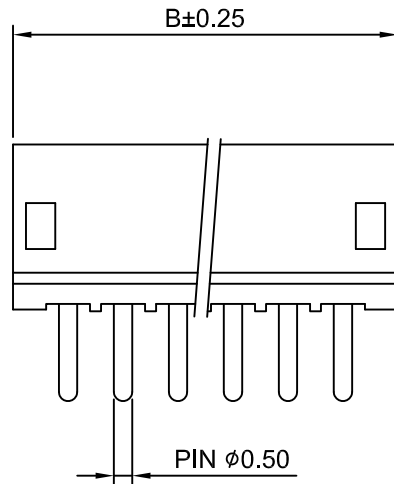
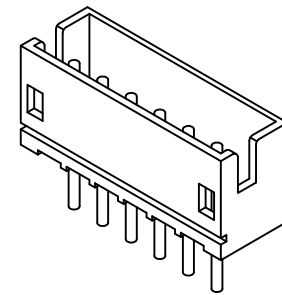

SPECIFICATIONS:

Current Rating: 2A AC,DC (AWG24)
 Voltage Rating: 100V AC,DC
 Temperature Range: -40°C ~ +105°C
 Contact Resistance: 20mΩ Max.
 Insulation Resistance: 500MΩ Min.
 Withstanding Voltage: 500V AC/minute
 Pin Material: Brass/Tin over Nickel
 Material: Nylon 66,UL94V-0(White)

Ordering Information & Dimensions

Circuits	Dimensions(mm)		Circuits	Dimensions(mm)	
	A	B		A	B
2P	1.50	4.50	8P	10.50	13.50
3P	3.00	6.00	9P	12.00	15.00
4P	4.50	7.50	10P	13.50	16.50
5P	6.00	9.00	11P	15.00	18.00
6P	7.50	10.50	12P	16.50	19.50
7P	9.00	12.00	13P	18.00	21.00

CJTconn CHANGJIANG CONNECTORS CO.,LTD.

Unit mm	Scale 5:1	Sheet 1 of 1	Title : 1.50mm Pitch 180° Wafer
Draw By: Dlankul Wan	Approved : Jack Yin		
General Tolerance			
A2	CHANGE THE CURRENT RATING	2019.02.26	DRAW NO : A1501WV-XP-WH REV A2
A1	CHANGE THE DRAWING	2019.01.10	
A0	NEW RELEASE	2005.05.10	
REV	DESCRIPTION	DATE	

PROJECT

A2	CHANGE THE CURRENT RATING	2019.02.26	PROJECT
A1	CHANGE THE DRAWING	2019.01.10	
A0	NEW RELEASE	2005.05.10	
REV	DESCRIPTION	DATE	

X-ON Electronics

Largest Supplier of Electrical and Electronic Components

Click to view similar products for [Headers & Wire Housings](#) category:

Click to view products by [Changjiang](#) manufacturer:

Other Similar products are found below :

[57102-F02-18ULF](#) [58102-G61-06LF](#) [582553-1](#) [009176003701906](#) [01.001.5753.1](#) [0050291907](#) [02.125.8002.8](#) [609-3404](#) [61062-3](#)
[CSU011177004](#) [622-0430](#) [622-3653LF](#) [63453-116](#) [636-1030](#) [636-1427](#) [636-3427](#) [636-4007](#) [641938-9](#) [65495-038](#) [65692-001LF](#) [65781-018](#)
[65781-047](#) [65817-010LF](#) [65817-015LF](#) [66207-023LF](#) [67095-007LF](#) [67601157](#) [68631-112](#) [68645-018](#) [699319-000](#) [M90C108951C](#)
[70.362.1628.0](#) [70-4210](#) [70-4226B](#) [70-4853B](#) [707-5028](#) [71.350.2428.0](#) [71961-016LF](#) [733-134](#) [733-162](#) [754199-000](#) [760-3052](#) [80.063.4001.1](#)
[800-90-001-10-001000](#) [800-90-010-10-002000](#) [801-43-002-10-013000](#) [801-43-006-10-002000](#) [803-41-018-10-001000](#) [803-43-024-10-](#)
[001000](#) [803-93-012-10-001000](#)