

## Specifications

- Current rating:3A AC,DC
- Voltage rating:350V AC,DC
- Temperature range:-40°C~+105°C
- Contact resistance:20mΩMax.
- Insulation resistance:1000MΩMin.
- Withstanding voltage:500V AC/minute
- \*Compliant with RoHS and REACH\*
- \*Meet the HF/Halogen Free,need to customize\*
- \*Contact CJT for details\*

## Standards

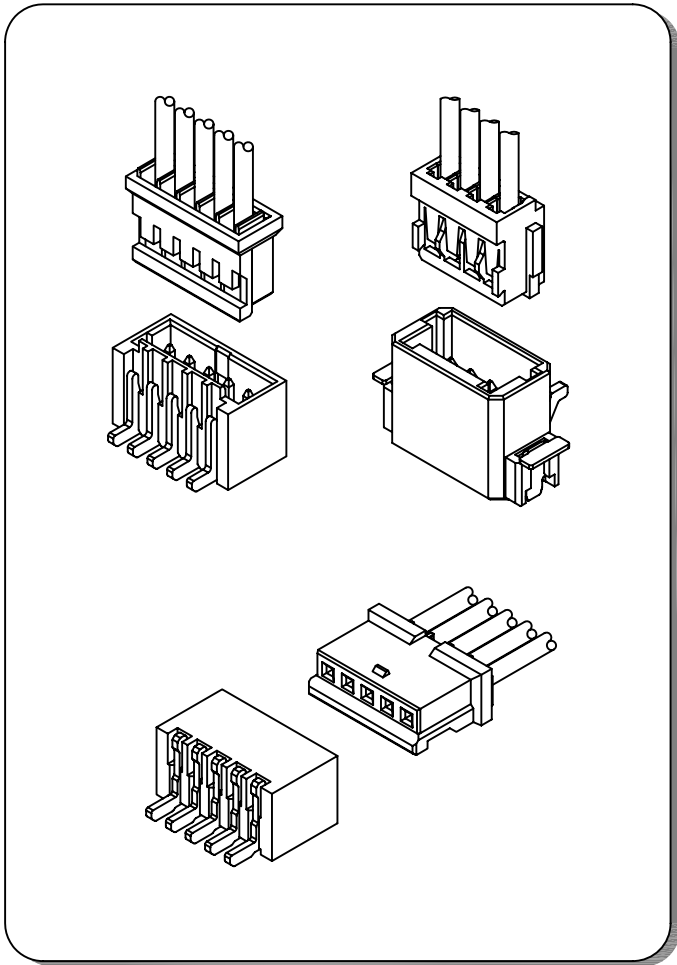

## Assembly layout

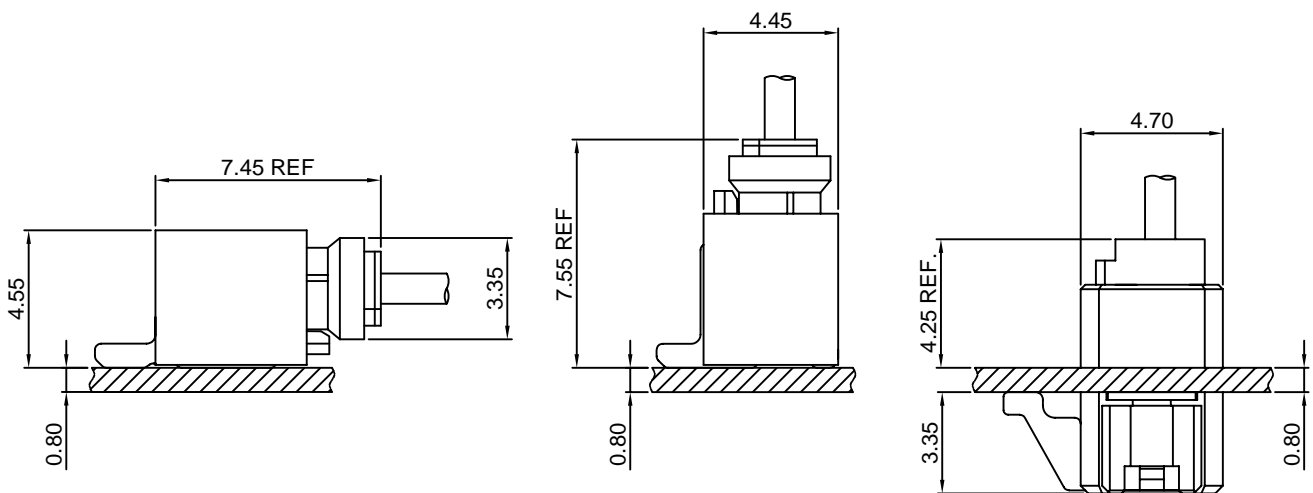

## A1502-T

1.50mm pitch Crimp Terminal

### Reference Informations:

\*Used in CJT A1502 series Housing

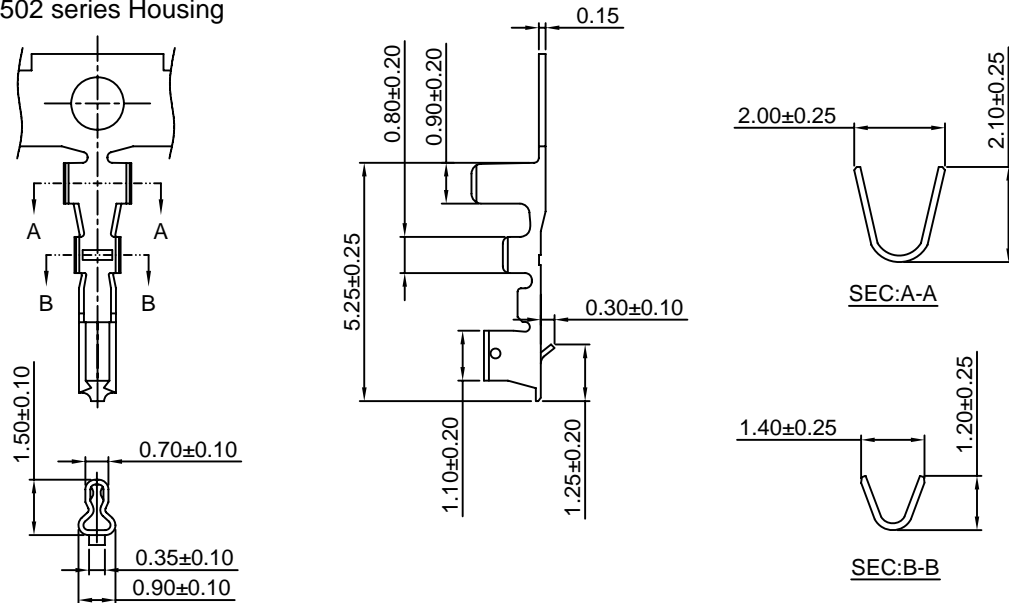

Ordering information & Specifications:

Unit:mm

| Part NO. | Wire Range | Insulation O.D. | Material        | Finish           | Qty/reel   |
|----------|------------|-----------------|-----------------|------------------|------------|
| A1502-TP | AWG#24-#28 | 1.10mm(max)     | Phosphor Bronze | Tin over Nickel  | 10,000 PCS |
| A1502-GP | AWG#24-#28 | 1.10mm(max)     | Phosphor Bronze | Gold over Nickel | 10,000 PCS |

Optional Gold plating available but MOQ requested

## A1502-T-A

1.50mm pitch Crimp Terminal

### Reference Informations:

\*Used in CJT A1502HA series Housing

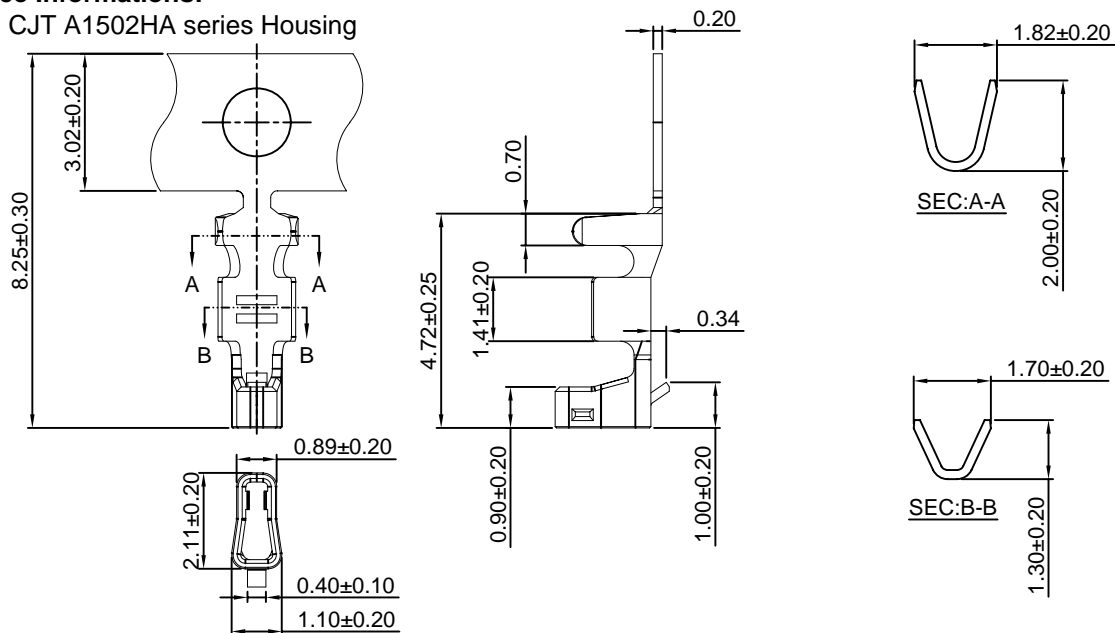

Ordering information & Specifications:

Unit:mm

| Part NO.   | Wire Range | Insulation O.D. | Material        | Finish           | Qty/reel   |
|------------|------------|-----------------|-----------------|------------------|------------|
| A1502-TP-A | AWG#24-#28 | 1.10mm(max)     | Phosphor Bronze | Tin over Nickel  | 10,000 PCS |
| A1502-GP-A | AWG#24-#28 | 1.10mm(max)     | Phosphor Bronze | Gold over Nickel | 10,000 PCS |

Optional Gold plating available but MOQ requested

## A1502H

1.50mm pitch Housing

### Reference Informations:

- \*Material: Nylon 66, UL94V-0
- \*Suitable CJT A1502 series Terminal
- \*Mates with CJT A1502 series Wafer
- \*Color: White

### Ordering Information:

- A1502H-XP - \*\*  
 $\frac{1}{2}$
1. Part No.
  2. Color:  
 (blank) - White  
 BK - Black

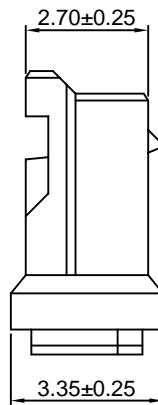
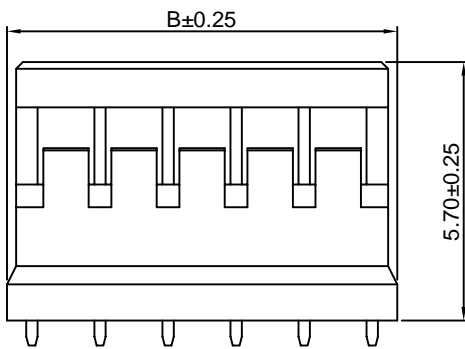
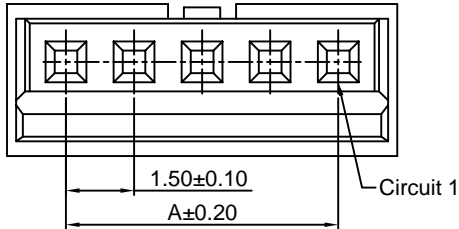
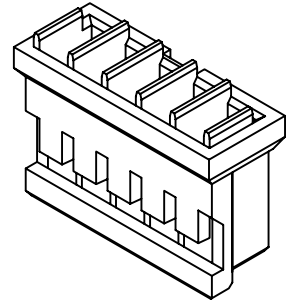

### Ordering Information & Dimensions:

| PART NO.   | Dimensions |       |
|------------|------------|-------|
|            | A          | B     |
| A1502H-2P  | 1.50       | 4.10  |
| A1502H-3P  | 3.00       | 5.60  |
| A1502H-4P  | 4.50       | 7.10  |
| A1502H-5P  | 6.00       | 8.60  |
| A1502H-6P  | 7.50       | 10.10 |
| A1502H-7P  | 9.00       | 11.60 |
| A1502H-8P  | 10.50      | 13.10 |
| A1502H-9P  | 12.00      | 14.60 |
| A1502H-10P | 13.50      | 16.10 |
| A1502H-11P | 15.00      | 17.60 |
| A1502H-12P | 16.50      | 19.10 |
| A1502H-13P | 18.00      | 20.60 |
| A1502H-14P | 19.50      | 22.10 |
| A1502H-15P | 21.00      | 23.60 |

Unit: mm

## A1502HA

1.50mm pitch Housing

### Reference Informations:

- \*Material: Nylon 66, UL94V-0
- \*Suitable CJT A1502HA series Terminal
- \*Mates with CJT A1502WVA-IT-S series Wafer
- \*Color: White

### Ordering Information:

- A1502HA-XP - \*\*  
 $\frac{1}{2}$
1. Part No.
  2. Color:  
 (blank) - White  
 BL - Blue

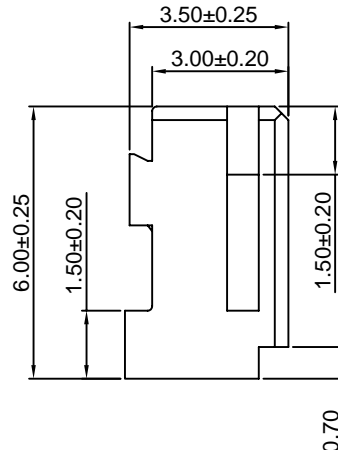
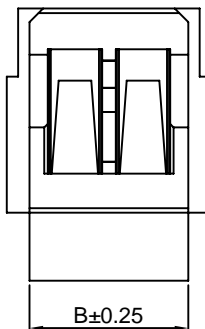
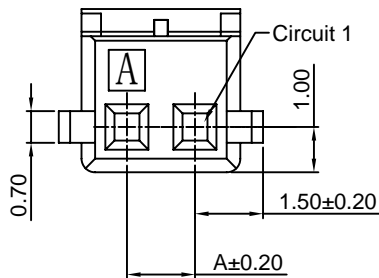
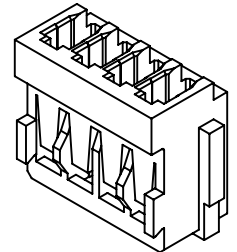

### Ordering Information & Dimensions:

| PART NO.    | Dimensions |       |
|-------------|------------|-------|
|             | A          | B     |
| A1502HA-2P  | 1.50       | 3.50  |
| A1502HA-3P  | 3.00       | 5.00  |
| A1502HA-4P  | 4.50       | 6.50  |
| A1502HA-5P  | 6.00       | 8.00  |
| A1502HA-6P  | 7.50       | 9.50  |
| A1502HA-7P  | 9.00       | 11.00 |
| A1502HA-8P  | 10.50      | 12.50 |
| A1502HA-9P  | 12.00      | 14.00 |
| A1502HA-10P | 13.50      | 15.50 |
| A1502HA-11P | 15.00      | 17.00 |
| A1502HA-12P | 16.50      | 18.50 |
| A1502HA-13P | 18.00      | 20.00 |
| A1502HA-14P | 19.50      | 21.50 |
| A1502HA-15P | 21.00      | 23.00 |
| A1502HA-16P | 22.50      | 24.50 |
| A1502HA-17P | 24.00      | 26.00 |
| A1502HA-18P | 25.50      | 27.50 |
| A1502HA-19P | 27.00      | 29.00 |
| A1502HA-20P | 28.50      | 30.50 |

Unit: mm

## A1502WV

—1.50mm pitch 180° Wafer—

### Reference Informations:

- \*Material:Pin:Brass/Tin over Nicke  
Insulator:Nylon 66,UL94V-0
- \*Mates with CJT A1502 series Housing
- \*Color:White

### Ordering Information:

- A1502WV-XP - \*\*  
1 2
- 1.Part No.
  - 2.Color:  
(blank) - White  
BK - Black

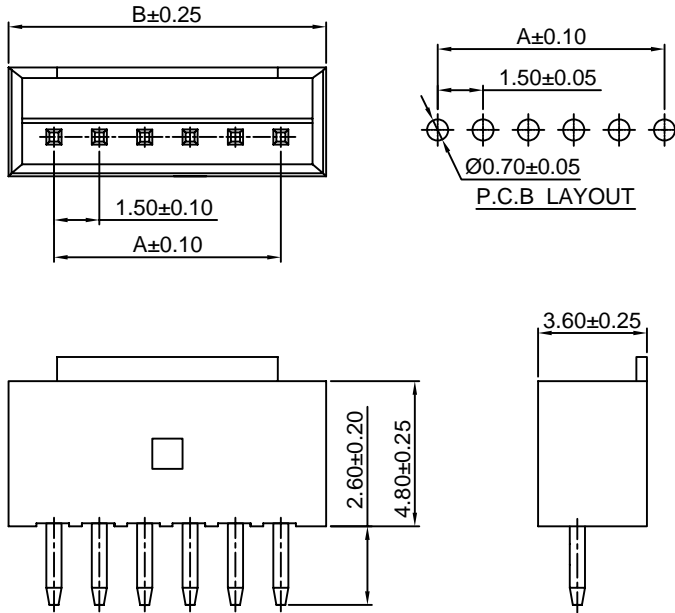

### Ordering Information & Dimensions:

| PART NO.    | Dimensions |       |
|-------------|------------|-------|
|             | A          | B     |
| A1502WV-2P  | 1.50       | 4.50  |
| A1502WV-3P  | 3.00       | 6.00  |
| A1502WV-4P  | 4.50       | 7.50  |
| A1502WV-5P  | 6.00       | 9.00  |
| A1502WV-6P  | 7.50       | 10.50 |
| A1502WV-7P  | 9.00       | 12.00 |
| A1502WV-8P  | 10.50      | 13.50 |
| A1502WV-9P  | 12.00      | 15.00 |
| A1502WV-10P | 13.50      | 16.50 |
| A1502WV-11P | 15.00      | 18.00 |
| A1502WV-12P | 16.50      | 19.50 |
| A1502WV-13P | 18.00      | 21.00 |
| A1502WV-14P | 19.50      | 22.50 |
| A1502WV-15P | 21.00      | 24.00 |

Unit: mm

## A1502WR

—1.50mm pitch 90° Wafer—

### Reference Informations:

- \*Material:Pin:Brass/Tin over Nickel  
Insulator:Nylon 66,UL94V-0
- \*Mates with CJT A1502 series Housing
- \*Color:White

### Ordering Information:

- A1502WR-XP - \*\*  
1 2
- 1.Part No.
  - 2.Color:  
(blank) - White  
BK - Black

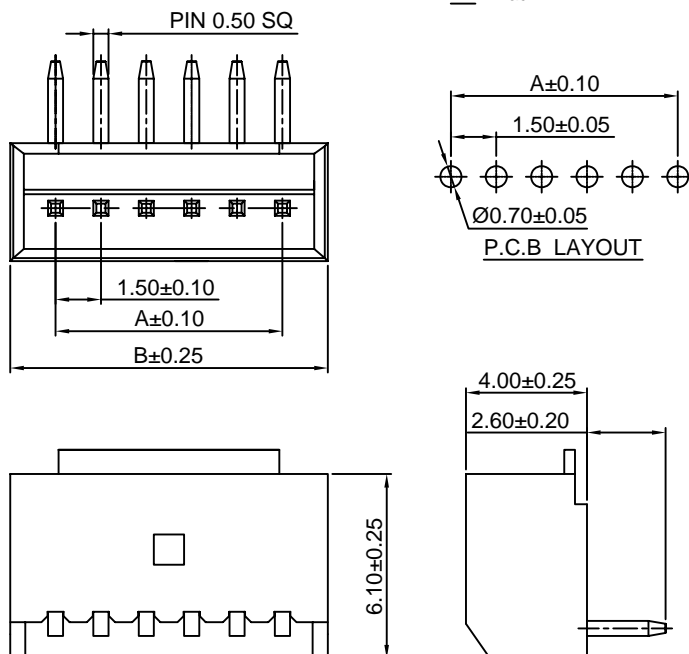

### Ordering Information & Dimensions:

| PART NO.    | Dimensions |       |
|-------------|------------|-------|
|             | A          | B     |
| A1502WR-2P  | 1.50       | 4.50  |
| A1502WR-3P  | 3.00       | 6.00  |
| A1502WR-4P  | 4.50       | 7.50  |
| A1502WR-5P  | 6.00       | 9.00  |
| A1502WR-6P  | 7.50       | 10.50 |
| A1502WR-7P  | 9.00       | 12.00 |
| A1502WR-8P  | 10.50      | 13.50 |
| A1502WR-9P  | 12.00      | 15.00 |
| A1502WR-10P | 13.50      | 16.50 |
| A1502WR-11P | 15.00      | 18.00 |
| A1502WR-12P | 16.50      | 19.50 |
| A1502WR-13P | 18.00      | 21.00 |
| A1502WR-14P | 19.50      | 22.50 |
| A1502WR-15P | 21.00      | 24.00 |

Unit: mm

### A1502WV-S

1.50mm pitch 180° Wafer-SMT TYPE

#### Reference Informations:

- \*Material: Pin: Brass/Tin over Nickel  
Insulator: Nylon 6T, UL94V-0
- \*Mates with CJT A1502 series Housing
- \*Color: Ivory

Ordering Information:  
A1502WV-S-XP - \*\*  
1  
2

- 1. Part No.
- 2. Color:  
(blank) - Ivory  
BK - Black

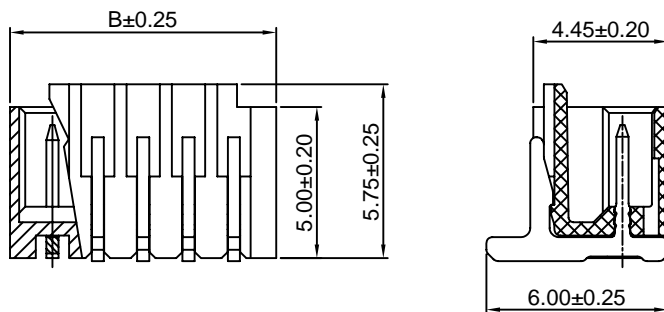
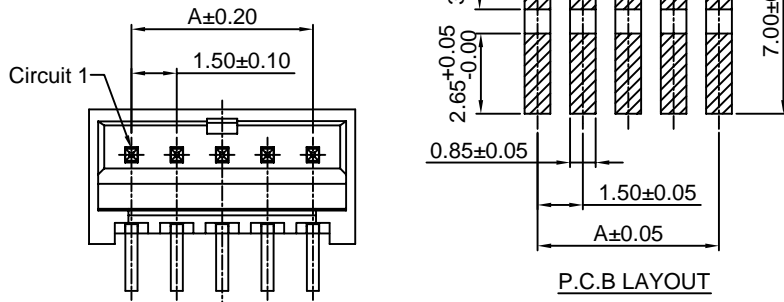
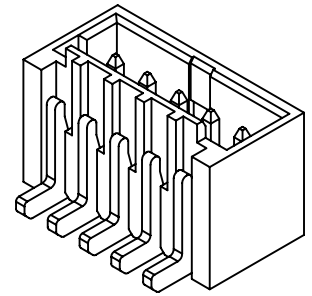

#### Ordering Information & Dimensions:

| PART NO.      | Dimensions |       |
|---------------|------------|-------|
|               | A          | B     |
| A1502WV-S-2P  | 1.50       | 4.30  |
| A1502WV-S-3P  | 3.00       | 5.80  |
| A1502WV-S-4P  | 4.50       | 7.30  |
| A1502WV-S-5P  | 6.00       | 8.80  |
| A1502WV-S-6P  | 7.50       | 10.30 |
| A1502WV-S-7P  | 9.00       | 11.80 |
| A1502WV-S-8P  | 10.50      | 13.30 |
| A1502WV-S-9P  | 12.00      | 14.80 |
| A1502WV-S-10P | 13.50      | 16.30 |
| A1502WV-S-11P | 15.00      | 17.80 |
| A1502WV-S-12P | 16.50      | 19.30 |
| A1502WV-S-13P | 18.00      | 20.80 |
| A1502WV-S-14P | 19.50      | 22.30 |
| A1502WV-S-15P | 21.00      | 23.80 |

Unit: mm

### A1502WR-S

1.50mm pitch 90° Wafer-SMT TYPE

#### Reference Informations:

- \*Material: Pin: Brass/Tin over Nickel  
Insulator: Nylon 6T, UL94V-0
- \*Mates with CJT A1502 series Housing
- \*Color: Ivory

Ordering Information:  
A1502WR-S-XP - \*\*  
1  
2

- 1. Part No.
- 2. Color:  
(blank) - Ivory  
BK - Black

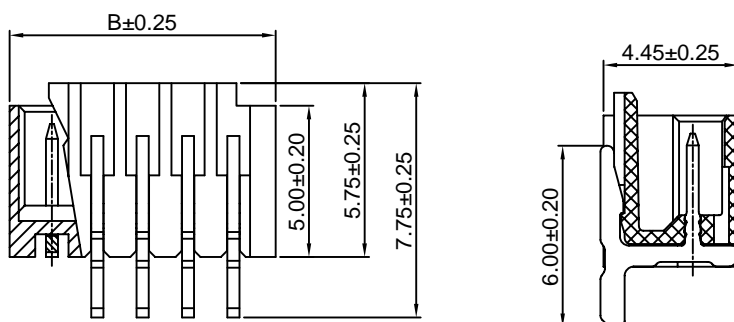
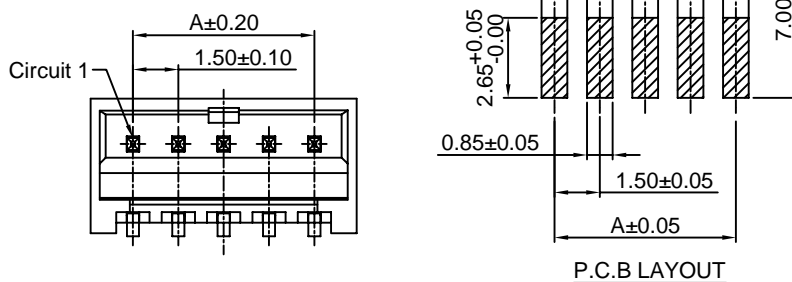
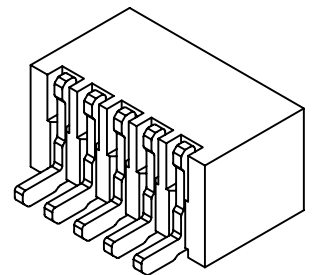

#### Ordering Information & Dimensions:

| PART NO.      | Dimensions |       |
|---------------|------------|-------|
|               | A          | B     |
| A1502WR-S-2P  | 1.50       | 4.30  |
| A1502WR-S-3P  | 3.00       | 5.80  |
| A1502WR-S-4P  | 4.50       | 7.30  |
| A1502WR-S-5P  | 6.00       | 8.80  |
| A1502WR-S-6P  | 7.50       | 10.30 |
| A1502WR-S-7P  | 9.00       | 11.80 |
| A1502WR-S-8P  | 10.50      | 13.30 |
| A1502WR-S-9P  | 12.00      | 14.80 |
| A1502WR-S-10P | 13.50      | 16.30 |
| A1502WR-S-11P | 15.00      | 17.80 |
| A1502WR-S-12P | 16.50      | 19.30 |
| A1502WR-S-13P | 18.00      | 20.80 |
| A1502WR-S-14P | 19.50      | 22.30 |
| A1502WR-S-15P | 21.00      | 23.80 |

Unit: mm

## A1502WVA-IT-S

1.50mm pitch thru board inverted SMT 180° Wafer

### Reference Informations:

- \*Material: Pin: Brass/Tin over Nickel  
Solder Tabs: Brass/Tin over Nickel  
Insulator: LCP, UL94V-0
- \*Mates with CJT A1502HA series Housing
- \*Color: Ivory

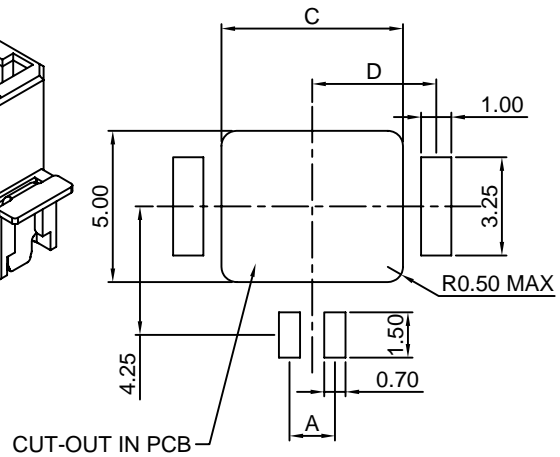
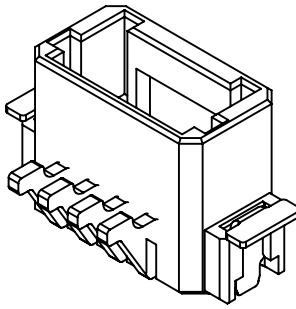
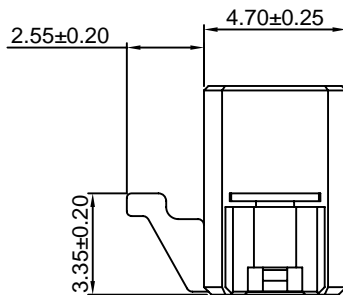
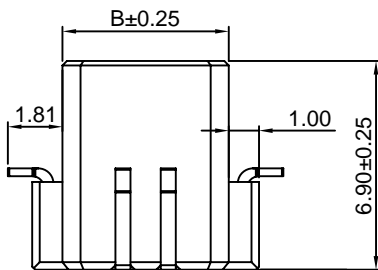
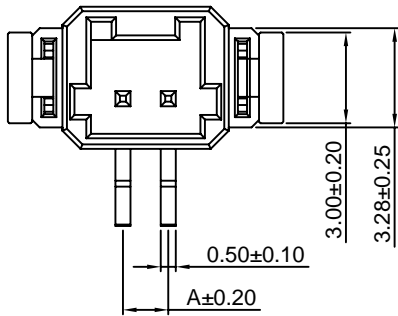

### Ordering Information & Dimensions:

| PART NO.         | Dimensions |       |       |      |
|------------------|------------|-------|-------|------|
|                  | A          | B     | C     | D    |
| A1502WVA-IT-S-2P | 1.50       | 5.50  | 6.00  | 4.10 |
| A1502WVA-IT-S-3P | 3.00       | 7.00  | 7.50  | 4.85 |
| A1502WVA-IT-S-4P | 4.50       | 8.50  | 9.00  | 5.60 |
| A1502WVA-IT-S-5P | 6.00       | 10.00 | 10.50 | 6.35 |
| A1502WVA-IT-S-6P | 7.50       | 11.50 | 12.00 | 7.10 |

Unit: mm

## X-ON Electronics

Largest Supplier of Electrical and Electronic Components

*Click to view similar products for [Headers & Wire Housings](#) category:*

*Click to view products by [Changjiang](#) manufacturer:*

Other Similar products are found below :

[57102-F02-18ULF](#) [58102-G61-06LF](#) [0009485154](#) [009176003701906](#) [0050291907](#) [00-9021-0611-00-339](#) [02.125.8002.8](#) [609-3404](#) [61062-3](#)  
[622-0430](#) [622-3653LF](#) [63453-116](#) [636-1030](#) [636-1427](#) [636-3427](#) [636-4007](#) [641938-9](#) [644827-2](#) [65495-038](#) [65692-001LF](#) [65781-018](#)  
[65781-047](#) [65817-010LF](#) [65817-015LF](#) [66207-023LF](#) [67016-026LF](#) [67095-007LF](#) [68631-112](#) [68645-018](#) [68648-049](#) [699319-000](#)  
[70.362.1628.0](#) [70-4210](#) [70-4226B](#) [70-4853B](#) [707-5020](#) [707-5028](#) [71.350.2428.0](#) [71961-016LF](#) [733-134](#) [754199-000](#) [760-3052](#) [787-8014-00](#)  
[FCN-367T-T012/H](#) [80.063.4001.1](#) [800-90-001-10-001000](#) [800-90-010-10-002000](#) [801-43-002-10-013000](#) [801-43-006-10-002000](#)  
[803-41-018-10-001000](#)