

### Specifications

- Current rating: 3A AC, DC
- Voltage rating: 250V AC, DC
- Temperature range: -40°C ~ +105°C
- Contact resistance: 10mΩ Max.
- Insulation resistance: 1000MΩ Min.
- Withstanding voltage: 800V AC/minute
- \*Compliant with RoHS and REACH\*
- \*Meet the HF/Halogen Free, need to customize\*
- \*Contact CJT for details\*

### Standards

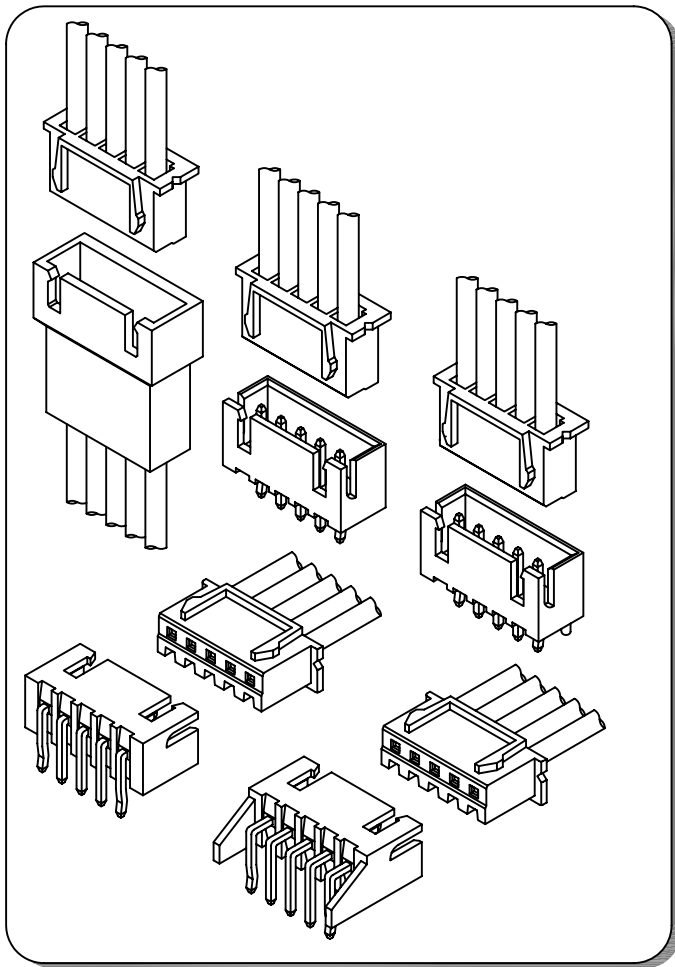

### Assembly layout

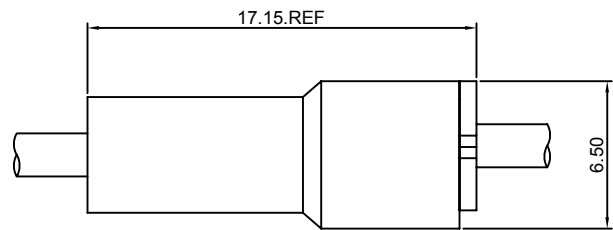

wire to wire

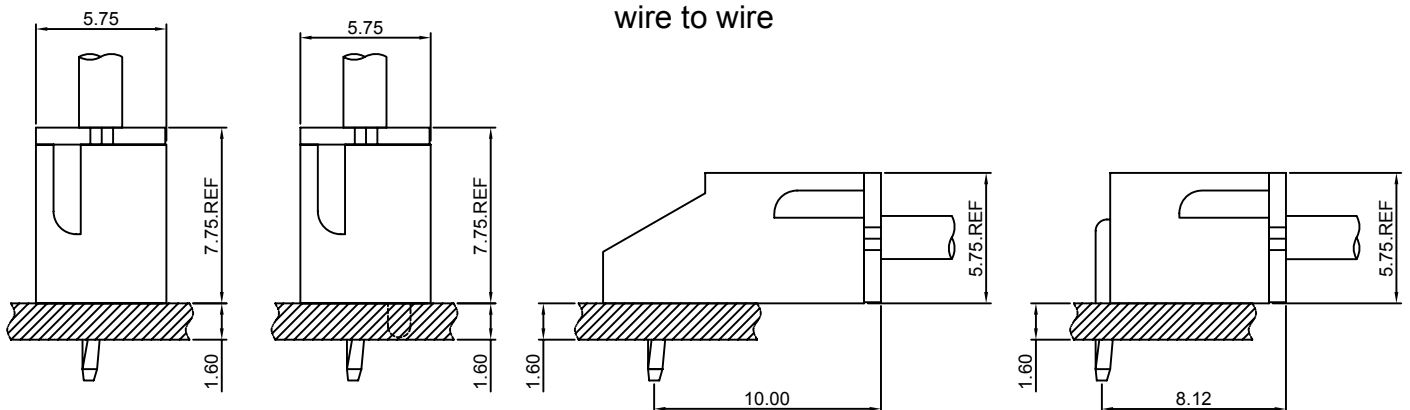

wire to board

### A2501-T

2.50mm pitch Crimp Terminal

**Reference Informations:**

\*Used in CJT A2501H,HB-XP,A2512H-XP series Housing

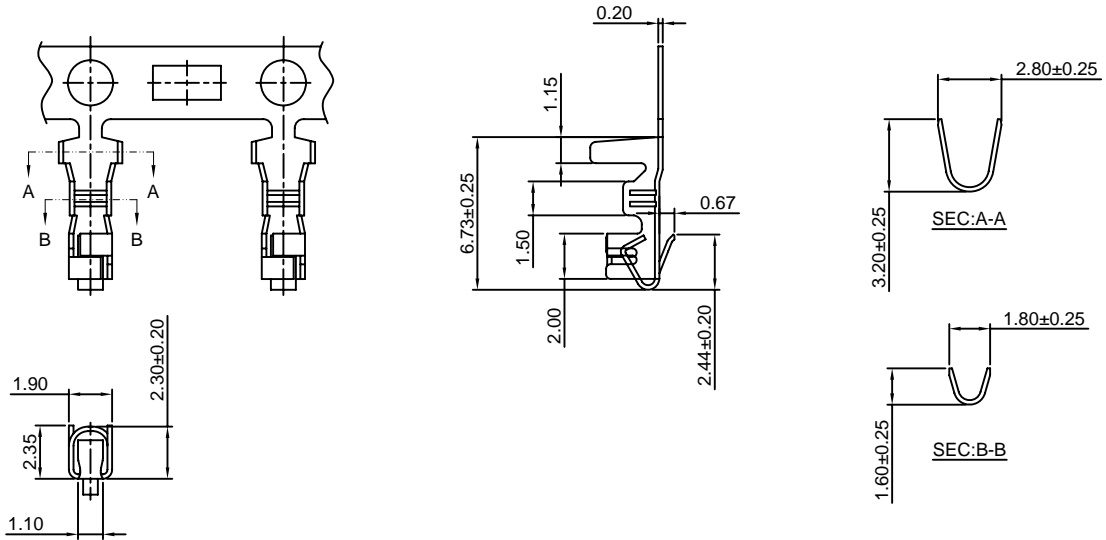

Ordering information & Specifications:

Unit:mm

| Part NO. | Wire Range | Insulation O.D. | Material        | Finish           | Qty/reel  |
|----------|------------|-----------------|-----------------|------------------|-----------|
| A2501-TP | AWG#22-#28 | 1.90mm(max)     | Phosphor Bronze | Tin over Nickel  | 8,000 PCS |
| A2501-GP | AWG#22-#28 | 1.90mm(max)     | Phosphor Bronze | Gold over Nickel | 8,000 PCS |

Optional Gold plating available but MOQ requested

### A2501-T-A

2.50mm pitch Crimp Terminal

**Reference Informations:**

\*Used in CJT A2501H,HB-XP,A2512H,HA,HB-XP series Housing

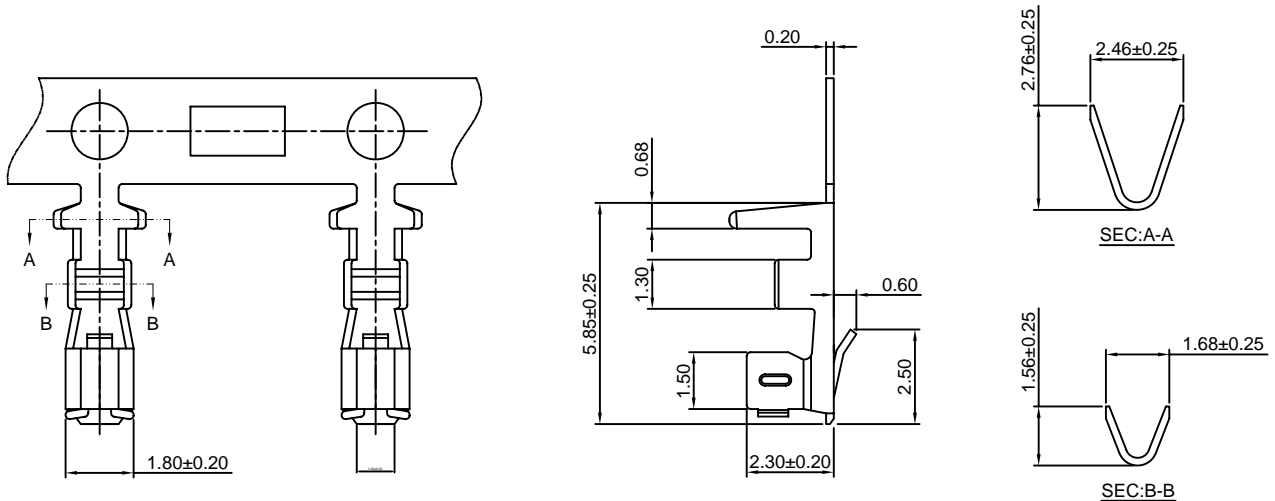

Ordering information & Specifications:

Unit:mm

| Part NO.   | Wire Range | Insulation O.D. | Material        | Finish           | Qty/reel   |
|------------|------------|-----------------|-----------------|------------------|------------|
| A2501-TP-A | AWG#22-#28 | 1.90mm(max)     | Phosphor Bronze | Tin over Nickel  | 15,000 PCS |
| A2501-GP-A | AWG#22-#28 | 1.90mm(max)     | Phosphor Bronze | Gold over Nickel | 15,000 PCS |

Optional Gold plating available but MOQ requested

### A2501M-T

2.50mm pitch Crimp Terminal

**Reference Informations:**

\*Used in CJT A2501HMB,HMC-XP,A2507HM-2P,A2509HM-XP,C2504HM,HMA-XP series Housing

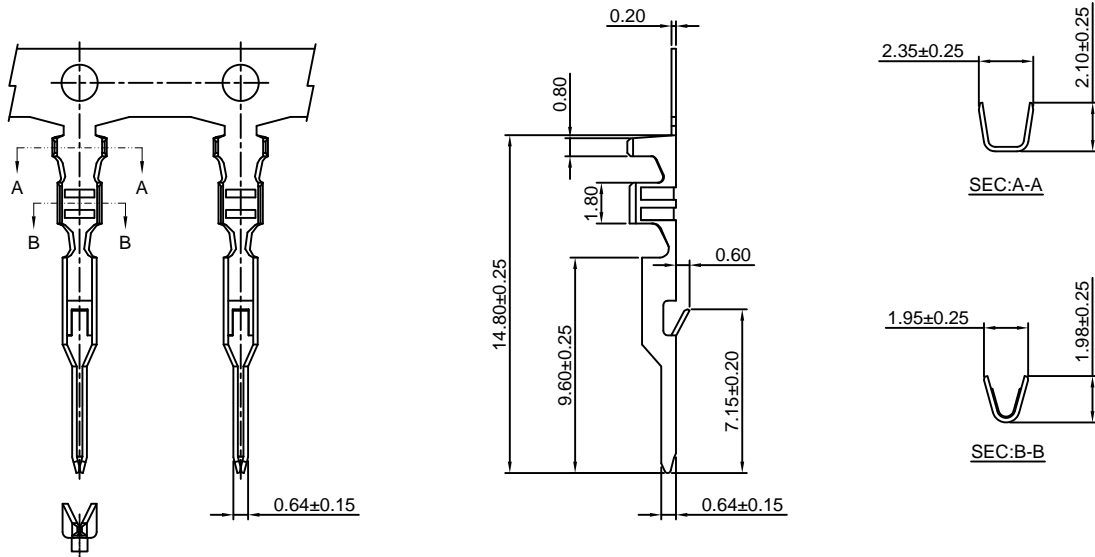

Ordering information & Specifications:

Unit:mm

| Part NO.  | Wire Range | Insulation O.D. | Material        | Finish           | Qty/reel   |
|-----------|------------|-----------------|-----------------|------------------|------------|
| A2501M-TB | AWG#22-#28 | 1.00mm(max)     | Brass           | Tin over Nickel  | 10,000 PCS |
| A2501M-TP | AWG#22-#28 | 1.00mm(max)     | Phosphor Bronze | Tin over Nickel  | 10,000 PCS |
| A2501M-GB | AWG#22-#28 | 1.00mm(max)     | Brass           | Gold over Nickel | 10,000 PCS |
| A2501M-GP | AWG#22-#28 | 1.00mm(max)     | Phosphor Bronze | Gold over Nickel | 10,000 PCS |

Optional Gold plating available but MOQ requested

### A2501H-XP

2.50mm pitch Housing

**Reference Informations:**

\*Material:Nylon 66,UL94V-0

\*Suitable CJT A2501-T(-A) series Terminal

\*Mates with CJT A2501HMB-XP series Housing or A2501WV(-F),WR,WV-S,WR-S-XP, A2501WRB,WVR,A2501WVC(-F)-XP,WVT-XP, A2512WVA,WRA,WVA-F,WVRA,WVT-XP series Wafer

\*Color: White

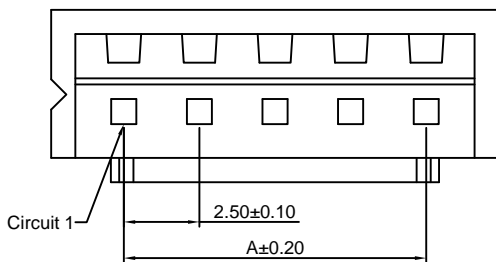
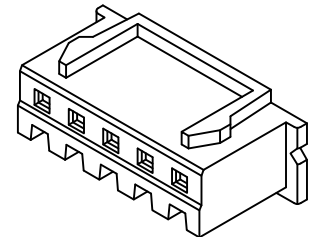

**Ordering Information:**

A2501H-XP - \*\*\* - \*\*  
1 2 3

1.Part No

2.Material:

(Blank):Nylon 66,UL94V-0

GWT:Nylon 66,UL94V-0,GWT 750 °C

3.Color:

(blank):White

BL:Blue

RD:Red

GN:Green

BR:Brown

VY:Vivid yellow

BK:Black

YL:Yellow

OR:Orange

LY:Lemon yellow

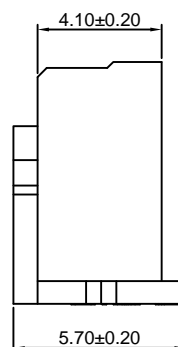
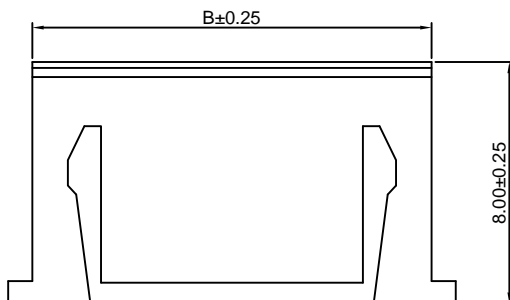

**Ordering Information & Dimensions:**

| PART NO. | Dimensions |       |
|----------|------------|-------|
|          | A          | B     |
| 2P       | 2.50       | 5.70  |
| 3P       | 5.00       | 8.20  |
| 4P       | 7.50       | 10.70 |
| 5P       | 10.00      | 13.20 |
| 6P       | 12.50      | 15.70 |
| 7P       | 15.00      | 18.20 |
| 8P       | 17.50      | 20.70 |
| 9P       | 20.00      | 23.20 |
| 10P      | 22.50      | 25.70 |
| 11P      | 25.00      | 28.20 |
| 12P      | 27.50      | 30.70 |
| 13P      | 30.00      | 33.20 |
| 14P      | 32.50      | 35.70 |
| 15P      | 35.00      | 38.20 |
| 16P      | 37.50      | 40.70 |
| 17P      | 40.00      | 43.20 |
| 18P      | 42.50      | 45.70 |
| 19P      | 45.00      | 48.20 |
| 20P      | 47.50      | 50.70 |

Unit: mm

### A2501HB-XP

2.50mm pitch Housing

**Reference Informations:**

- \*Material:Nylon 66,UL94V-0
- \*Suitable CJT A2501-T(-A) series Terminal
- \*Mates with CJT A2501HMB-XP series Housing or A2501WV(-F),WR, WV-S,WR-S-XP,A2501WRB,WVR,A2501WVC(-F)-XPWVT-XP, series Wafer or A2512SA-XP series Retainer
- \*Color: White

**Ordering Information:**

A2501HB-XP - \*\*\* - \*\*  
1 2 3

- 1.Part No.
- 2.Material:  
(Blank):Nylon 66,UL94V-0  
GWT:Nylon 66,UL94V-0,GWT 750 °C
- 3.Color:  
(Blank):White  
BL:Blue  
BK:Black  
RD:Red  
YL:Yellow  
GN:Green

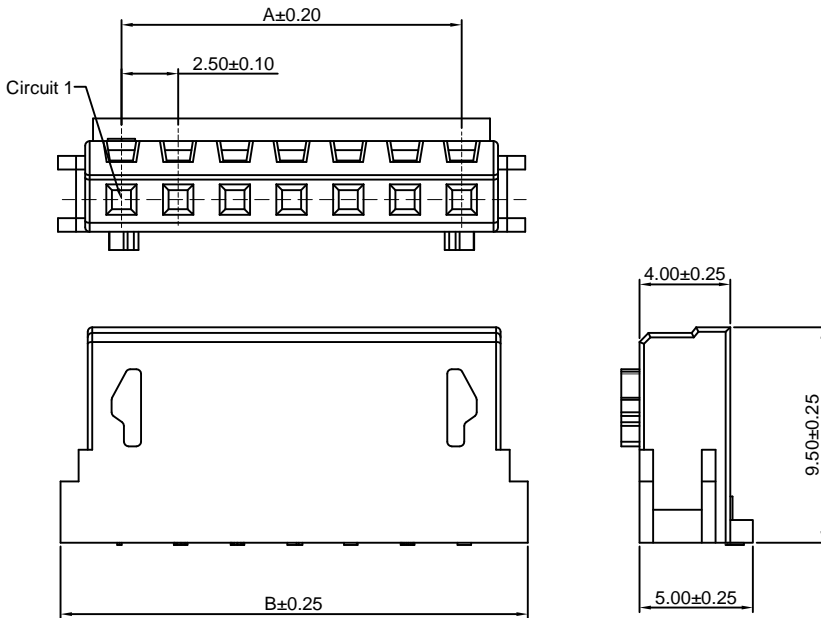

**Ordering Information & Dimensions:**

| PART NO. | Dimensions |       |
|----------|------------|-------|
|          | A          | B     |
| 2P       | 2.50       | 8.10  |
| 3P       | 5.00       | 10.60 |
| 4P       | 7.50       | 13.10 |
| 5P       | 10.00      | 15.60 |
| 6P       | 12.50      | 18.10 |
| 7P       | 15.00      | 20.60 |
| 8P       | 17.50      | 23.10 |
| 9P       | 20.00      | 25.60 |
| 10P      | 22.50      | 28.10 |
| 11P      | 25.00      | 30.60 |
| 12P      | 27.50      | 33.10 |
| 13P      | 30.00      | 35.60 |
| 14P      | 32.50      | 38.10 |
| 15P      | 35.00      | 40.60 |

Unit: mm

### A2501HMB-XP

2.50mm pitch Housing

**Reference Informations:**

- \*Material:Nylon 66,UL94V-0
- \*Suitable CJT A2501M-T series Terminal
- \*Mates with CJT A2501H,HB-XP series Housing
- \*Color:White

**Ordering Information:**

A2501HMB-XP - \*\* - \*\*\*  
1 2 3

- 1.Part No.
- 2.Material:  
(Blank):Nylon 66,UL94V-0  
GWT:Nylon 66,UL94V-0,GWT 750 °C
- 3.Color:  
(Blank):White  
BL:Blue  
BK:Black  
RD:Red  
YL:Yellow  
GN:Green

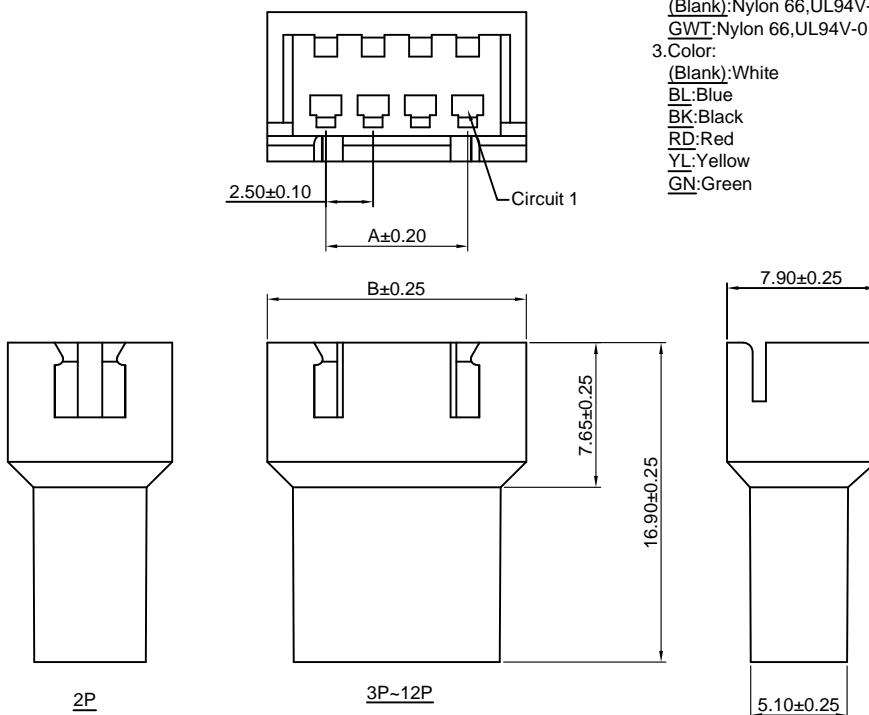

**Ordering Information & Dimensions:**

| PART NO. | Dimensions |       |
|----------|------------|-------|
|          | A          | B     |
| 2P       | 2.50       | 8.70  |
| 3P       | 5.00       | 11.20 |
| 4P       | 7.50       | 13.70 |
| 5P       | 10.00      | 16.20 |
| 6P       | 12.50      | 18.70 |
| 7P       | 15.00      | 21.20 |
| 8P       | 17.50      | 23.70 |
| 9P       | 20.00      | 26.20 |
| 10P      | 22.50      | 28.70 |
| 11P      | 25.00      | 31.20 |
| 12P      | 27.50      | 33.70 |
| 13P      | 30.00      | 36.20 |
| 14P      | 32.50      | 38.70 |
| 15P      | 35.00      | 41.20 |
| 16P      | 37.50      | 43.70 |
| 17P      | 40.00      | 46.20 |
| 18P      | 42.50      | 48.70 |
| 19P      | 45.00      | 51.20 |
| 20P      | 47.50      | 53.70 |

Unit: mm

### A2501HMC-XP

2.50mm pitch Housing

**Reference Informations:**

- \*Material:Nylon 66,UL94V-0
- \*Suitable CJT A2501M-T series Terminal
- \*Mates with CJT A2512HA-XP series Housing
- \*Color:White

**Ordering Information:**

A2501HMC-XP - \*\*\*  
1 2

- 1.Part No.
- 2.Material:

(Blank):Nylon 66,UL94V-0  
GWT:Nylon 66,UL94V-0,GWT 750 °C

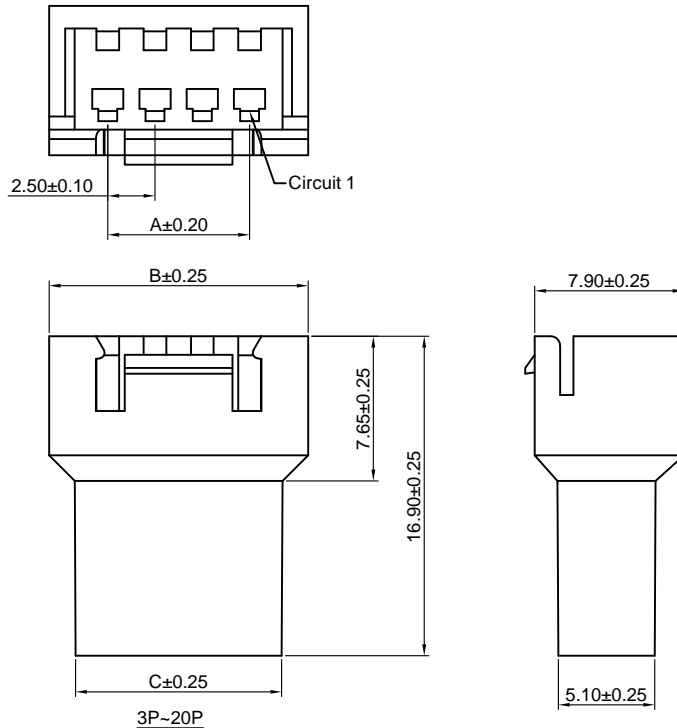

**Ordering Information & Dimensions:**

| PART NO. | Dimensions |       |       |
|----------|------------|-------|-------|
|          | A          | B     | C     |
| 2P       | 2.50       | 8.70  | 5.90  |
| 3P       | 5.00       | 11.20 | 8.40  |
| 4P       | 7.50       | 13.70 | 10.90 |
| 5P       | 10.00      | 16.20 | 13.40 |
| 6P       | 12.50      | 18.70 | 15.90 |
| 7P       | 15.00      | 21.20 | 18.40 |
| 8P       | 17.50      | 23.70 | 20.90 |
| 9P       | 20.00      | 26.20 | 23.40 |
| 10P      | 22.50      | 28.70 | 25.90 |
| 11P      | 25.00      | 31.20 | 28.40 |
| 12P      | 27.50      | 33.70 | 30.90 |
| 13P      | 30.00      | 36.20 | 33.40 |
| 14P      | 32.50      | 38.70 | 35.90 |
| 15P      | 35.00      | 41.20 | 38.40 |
| 16P      | 37.50      | 43.70 | 40.90 |
| 17P      | 40.00      | 46.20 | 43.40 |
| 18P      | 42.50      | 48.70 | 45.90 |
| 19P      | 45.00      | 51.20 | 48.40 |
| 20P      | 47.50      | 53.70 | 50.90 |

Unit: mm

### A2501WV(-F)-XP

2.50mm pitch 180° Wafer

**Reference Informations:**

- \*Material:Pin:Brass/Tin over Nickel  
Insulator:Nylon 66,UL94V-0
- \*Mates with CJT A2501H,HB-XP series Housing
- \*Color:White

**Ordering Information:**

A2501WV(-F)-XP - \* - \*\*\* - \*\* - \*\*  
1 2 3 4 5

- 1.Part No
- 2.Style:  
(blank) :Type 1  
2 :Type 2
- 3.Material:  
(Blank):Nylon 66,UL94V-0  
GWT:Nylon 66,UL94V-0,GWT 750 °C
- 4.Color:  
(blank):White  
BL:Blue  
RD:Red  
GN:Green  
BR:Brown  
VY:Vivid yellow  
BK:Black  
YL:Yellow  
OR:Orange  
LY:Lemon yellow
- 5.Finish:  
(blank):Tin over Nickel  
G:Gold over Nickel

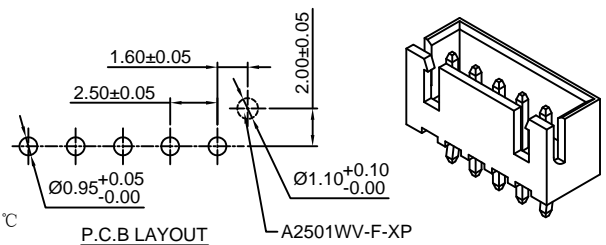

**Ordering Information & Dimensions:**

| PART NO. | Dimensions |       |
|----------|------------|-------|
|          | A          | B     |
| 2P       | 2.50       | 7.50  |
| 3P       | 5.00       | 10.00 |
| 4P       | 7.50       | 12.50 |
| 5P       | 10.00      | 15.00 |
| 6P       | 12.50      | 17.50 |
| 7P       | 15.00      | 20.00 |
| 8P       | 17.50      | 22.50 |
| 9P       | 20.00      | 25.00 |
| 10P      | 22.50      | 27.50 |
| 11P      | 25.00      | 30.00 |
| 12P      | 27.50      | 32.50 |
| 13P      | 30.00      | 35.00 |
| 14P      | 32.50      | 37.50 |
| 15P      | 35.00      | 40.00 |
| 16P      | 37.50      | 42.50 |
| 17P      | 40.00      | 45.00 |
| 18P      | 42.50      | 47.50 |
| 19P      | 45.00      | 50.00 |
| 20P      | 47.50      | 52.50 |

Unit: mm

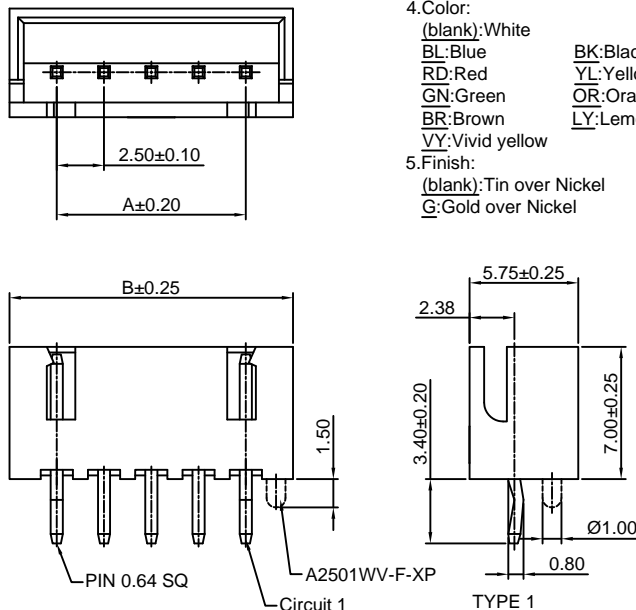

### A2501WVC(-F)-XP

2.5mm pitch 180° Wafer

#### Reference Informations:

- \*Material: Pin: Brass/Tin over Nickel  
Insulator: Nylon 66, UL94V-0
- \*Mates with CJT A2501H, HB-XP series Housing
- \*Color: White

#### Ordering Information:

A2501WVC(-F)-XP - \*\*\* - \*\* - \*\*  
1 2 3 4

1. Part No
2. Material:  
(Blank): Nylon 66, UL94V-0  
GWT: Nylon 66, UL94V-0, GWT 750 °C
3. Color:  
(blank): White  
BL: Blue  
BK: Black  
RD: Red  
YL: Yellow  
GN: Green  
LY: Lemon yellow
4. Finish:  
(blank): Tin over Nickel  
G: Gold over Nickel

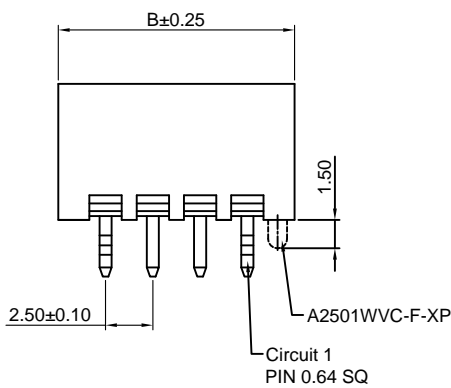
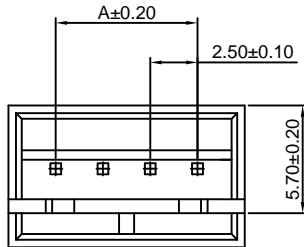
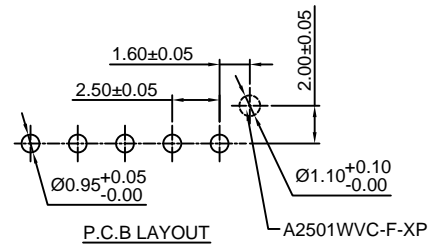

#### Ordering Information & Dimensions:

| PART NO. | Dimensions |       |
|----------|------------|-------|
|          | A          | B     |
| 2P       | 2.50       | 7.50  |
| 3P       | 5.00       | 10.00 |
| 4P       | 7.50       | 12.50 |
| 5P       | 10.00      | 15.00 |
| 6P       | 12.50      | 17.50 |
| 7P       | 15.00      | 20.00 |
| 8P       | 17.50      | 22.50 |
| 9P       | 20.00      | 25.00 |
| 10P      | 22.50      | 27.50 |
| 11P      | 25.00      | 30.00 |
| 12P      | 27.50      | 32.50 |
| 13P      | 30.00      | 35.00 |
| 14P      | 32.50      | 37.50 |
| 15P      | 35.00      | 40.00 |
| 16P      | 37.50      | 42.50 |
| 17P      | 40.00      | 45.00 |
| 18P      | 42.50      | 47.50 |
| 19P      | 45.00      | 50.00 |
| 20P      | 47.50      | 52.50 |

Unit: mm

### A2501WV-F-XP-H

2.5mm pitch 180° Wafer - With Boss

#### Reference Informations:

- \*Material: Pin: Brass/Tin over Nickel  
Insulator: Nylon 66, UL94V-0
- \*Mates with CJT A2501H, HB-XP series Housing
- \*Color: White

#### Ordering Information:

A2501WV-F-XP-H - \*\*\* - \*\* - \*\*  
1 2 3 4

1. Part No
2. Material:  
(Blank): Nylon 66, UL94V-0  
GWT: Nylon 66, UL94V-0, GWT 750 °C
3. Color:  
(blank): White  
BL: Blue  
BK: Black  
RD: Red  
YL: Yellow  
GN: Green
4. Finish:  
(blank): Tin over Nickel  
G: Gold over Nickel

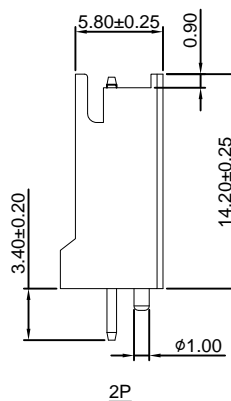
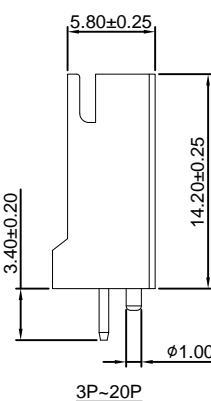
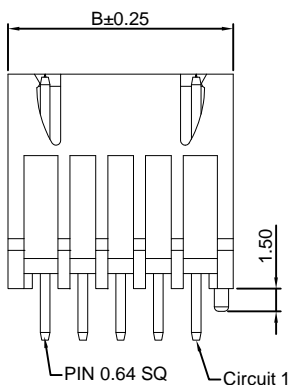
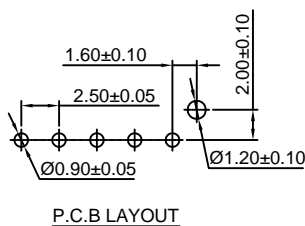
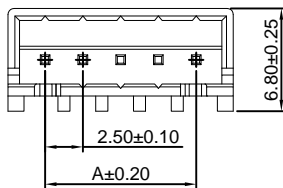
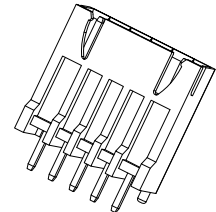

#### Ordering Information & Dimensions:

| PART NO. | Dimensions |       |
|----------|------------|-------|
|          | A          | B     |
| 2P       | 2.50       | 7.50  |
| 3P       | 5.00       | 10.00 |
| 4P       | 7.50       | 12.50 |
| 5P       | 10.00      | 15.00 |
| 6P       | 12.50      | 17.50 |
| 7P       | 15.00      | 20.00 |
| 8P       | 17.50      | 22.50 |
| 9P       | 20.00      | 25.00 |
| 10P      | 22.50      | 27.50 |
| 11P      | 25.00      | 30.00 |
| 12P      | 27.50      | 32.50 |
| 13P      | 30.00      | 35.00 |
| 14P      | 32.50      | 37.50 |
| 15P      | 35.00      | 40.00 |
| 16P      | 37.50      | 42.50 |
| 17P      | 40.00      | 45.00 |
| 18P      | 42.50      | 47.50 |
| 19P      | 45.00      | 50.00 |
| 20P      | 47.50      | 52.50 |

Unit: mm

### A2501WR-XP

— 2.50mm pitch 90° Wafer

#### Reference Informations:

- \*Material: Pin: Brass/Tin over Nickel  
Insulator: Nylon 66, UL94V-0
- \*Mates with CJT A2501H, HB-XP series Housing
- \*Color: White

#### Ordering Information:

A2501WR-XP - \*\* - \*\*\* - \*\* - \*\*  
1 2 3 4 5

1. Part No
2. Style:  
(blank) : Type 1  
2 : Type 2
3. Material:  
(Blank): Nylon 66, UL94V-0  
GWT: Nylon 66, UL94V-0, GWT 750 °C
4. Color:  
(blank): White  
BL: Blue BK: Black  
RD: Red YL: Yellow  
GN: Green OR: Orange  
BR: Brown LY: Lemon yellow  
VY: Vivid yellow
5. Finish:  
(blank): Tin over Nickel  
G: Gold over Nickel

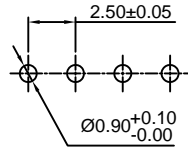

P.C.B LAYOUT

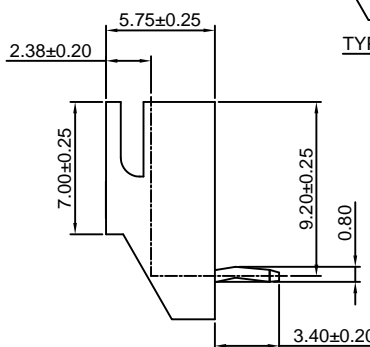
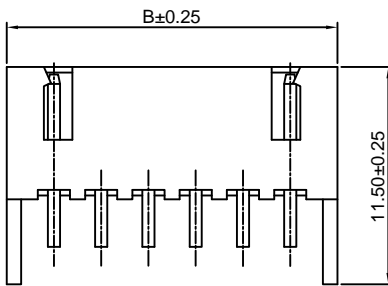
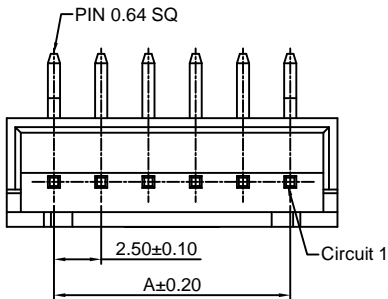
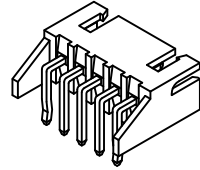

TYPE 1

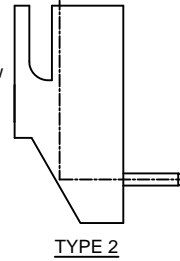

TYPE 2

#### Ordering Information & Dimensions:

| PART NO. | Dimensions |       |
|----------|------------|-------|
|          | A          | B     |
| 2P       | 2.50       | 7.50  |
| 3P       | 5.00       | 10.00 |
| 4P       | 7.50       | 12.50 |
| 5P       | 10.00      | 15.00 |
| 6P       | 12.50      | 17.50 |
| 7P       | 15.00      | 20.00 |
| 8P       | 17.50      | 22.50 |
| 9P       | 20.00      | 25.00 |
| 10P      | 22.50      | 27.50 |
| 11P      | 25.00      | 30.00 |
| 12P      | 27.50      | 32.50 |
| 13P      | 30.00      | 35.00 |
| 14P      | 32.50      | 37.50 |
| 15P      | 35.00      | 40.00 |
| 16P      | 37.50      | 42.50 |
| 17P      | 40.00      | 45.00 |
| 18P      | 42.50      | 47.50 |
| 19P      | 45.00      | 50.00 |
| 20P      | 47.50      | 52.50 |

Unit: mm

### A2501WRB-XP

— 2.50mm pitch 90° Wafer

#### Reference Informations:

- \*Material: Pin: Brass/Tin over Nickel  
Insulator: Nylon 66, UL94V-0
- \*Mates with CJT A2501H, HB-XP series Housing
- \*Color: White

#### Ordering Information:

A2501WRB-XP - \*\* - \*\*\* - \*\* - \*\*  
1 2 3 4 5

1. Part No
2. Style:  
(blank) : Type 1  
2 : Type 2
3. Material:  
(Blank): Nylon 66, UL94V-0  
GWT: Nylon 66, UL94V-0, GWT 750 °C
4. Color:  
(blank): White  
BL: Blue BK: Black  
RD: Red YL: Yellow  
GN: Green OR: Orange  
BR: Brown LY: Lemon yellow  
VY: Vivid yellow
5. Finish:  
(blank): Tin over Nickel  
G: Gold over Nickel

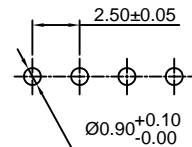

P.C.B LAYOUT

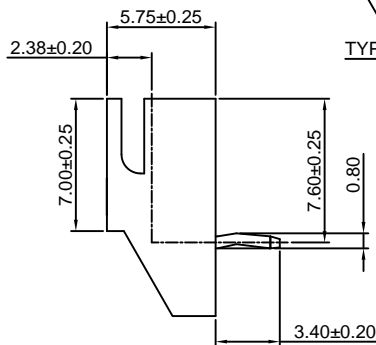
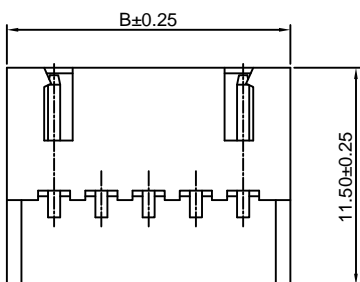
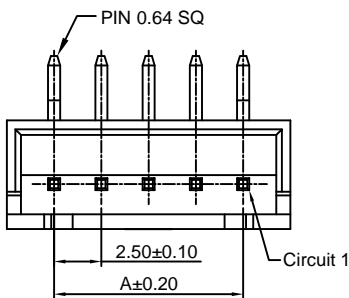

TYPE 1

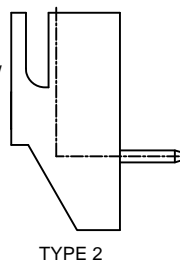

TYPE 2

#### Ordering Information & Dimensions:

| PART NO. | Dimensions |       |
|----------|------------|-------|
|          | A          | B     |
| 2P       | 2.50       | 7.50  |
| 3P       | 5.00       | 10.00 |
| 4P       | 7.50       | 12.50 |
| 5P       | 10.00      | 15.00 |
| 6P       | 12.50      | 17.50 |
| 7P       | 15.00      | 20.00 |
| 8P       | 17.50      | 22.50 |
| 9P       | 20.00      | 25.00 |
| 10P      | 22.50      | 27.50 |
| 11P      | 25.00      | 30.00 |
| 12P      | 27.50      | 32.50 |
| 13P      | 30.00      | 35.00 |
| 14P      | 32.50      | 37.50 |
| 15P      | 35.00      | 40.00 |
| 16P      | 37.50      | 42.50 |
| 17P      | 40.00      | 45.00 |
| 18P      | 42.50      | 47.50 |
| 19P      | 45.00      | 50.00 |
| 20P      | 47.50      | 52.50 |

Unit: mm



### A2501WVR-XP

2.50mm pitch 90° Wafer

**Reference Informations:**

- \*Material:Pin:Brass/Tin over Nickel  
Insulator:Nylon 66,UL94V-0
- \*Mates with CJT A2501H,HB-XP series Housing
- \*Color:White

**Ordering Information:**

A2501WVR-XP - <sup>\*\*</sup> - <sup>\*\*\*</sup> - <sup>\*\*</sup> - <sup>\*\*</sup>

1      2      3      4      5

- 1.Part No
- 2.Style:  
(blank) :Type 1  
2 :Type 2
- 3.Material:  
(Blank):Nylon 66,UL94V-0  
GWT:Nylon 66,UL94V-0,GWT 750 °C
- 4.Color:  
(blank):White  
BL:Blue  
BK:Black  
RD:Red  
YL:Yellow  
GN:Green
- 5.Finish:  
(blank):Tin over Nickel  
G:Gold over Nickel

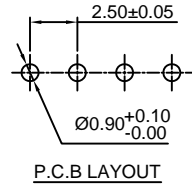
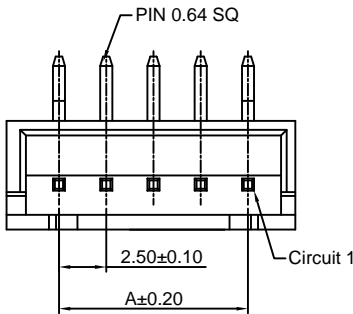
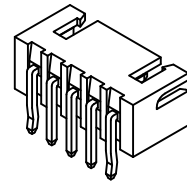

**Ordering Information & Dimensions:**

| PART NO. | Dimensions |       |
|----------|------------|-------|
|          | A          | B     |
| 2P       | 2.50       | 7.50  |
| 3P       | 5.00       | 10.00 |
| 4P       | 7.50       | 12.50 |
| 5P       | 10.00      | 15.00 |
| 6P       | 12.50      | 17.50 |
| 7P       | 15.00      | 20.00 |
| 8P       | 17.50      | 22.50 |
| 9P       | 20.00      | 25.00 |
| 10P      | 22.50      | 27.50 |
| 11P      | 25.00      | 30.00 |
| 12P      | 27.50      | 32.50 |
| 13P      | 30.00      | 35.00 |
| 14P      | 32.50      | 37.50 |
| 15P      | 35.00      | 40.00 |
| 16P      | 37.50      | 42.50 |
| 17P      | 40.00      | 45.00 |
| 18P      | 42.50      | 47.50 |
| 19P      | 45.00      | 50.00 |
| 20P      | 47.50      | 52.50 |

Unit: mm

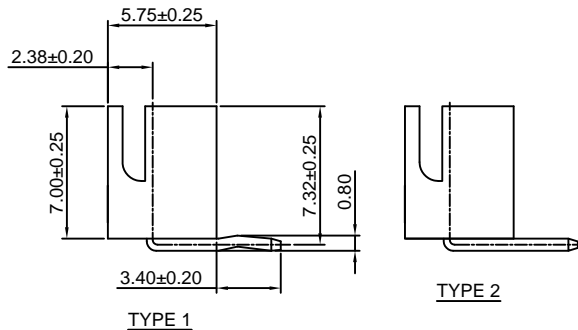
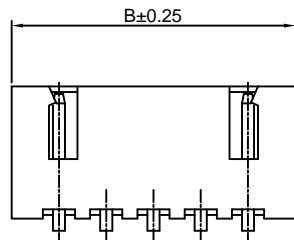

### A2501WV-S-XP

2.50mm pitch 180° Wafer - SMT TYPE

**Reference Informations:**

- \*Material:Pin:Brass/Tin over Nickel  
Solder Tabs:Phosphor Bronze/Tin over Nickel  
Insulator:LCP,UL94V-0
- \*Mates with CJT A2501H,HB-XP series Housing
- \*Color:Ivory

**Ordering Information:**

A2501WV-S-XP - <sup>\*\*\*</sup> - <sup>\*\*</sup> - <sup>\*\*</sup>

1      2      3      4

- 1.Part No.
- 2.Material:  
(Blank):LCP,UL94V-0  
GWT:LCP,UL94V-0,GWT 750 °C
- 3.Color:  
(blank):Ivory  
BL:Blue  
RD:Red  
GN:Green
- 4.Finish:  
(blank):Tin over Nickel  
G:Gold over Nickel

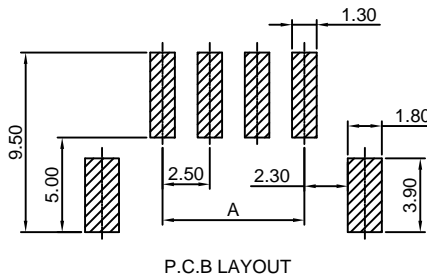
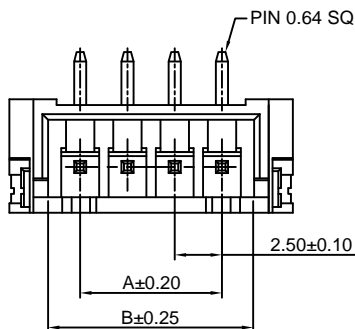

**Ordering Information & Dimensions:**

| PART NO. | Dimensions |       |       |
|----------|------------|-------|-------|
|          | A          | B     |       |
| 2P       | 2.50       | 5.90  | 10.00 |
| 3P       | 5.00       | 8.40  | 12.50 |
| 4P       | 7.50       | 10.90 | 15.00 |
| 5P       | 10.00      | 13.40 | 17.50 |
| 6P       | 12.50      | 15.90 | 20.00 |
| 7P       | 15.00      | 18.40 | 22.50 |
| 8P       | 17.50      | 20.90 | 25.00 |
| 9P       | 20.00      | 23.40 | 27.50 |
| 10P      | 22.50      | 25.90 | 30.00 |
| 11P      | 25.00      | 28.40 | 32.50 |
| 12P      | 27.50      | 30.90 | 35.00 |
| 13P      | 30.00      | 33.40 | 37.50 |
| 14P      | 32.50      | 35.90 | 40.00 |
| 15P      | 35.00      | 38.40 | 42.50 |
| 16P      | 37.50      | 40.90 | 45.00 |

Unit: mm

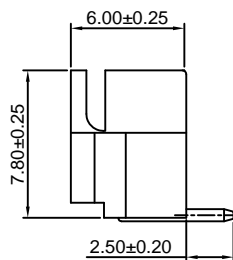
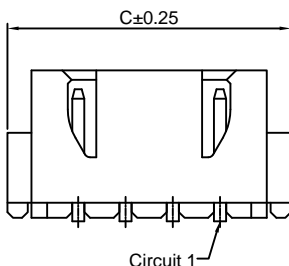



### A2501WR-S-XP

2.50mm pitch 90° Wafer - SMT TYPE

**Reference Informations:**

- \*Material:Pin:Brass/Tin over Nickel  
Insulator:Nylon 6T,UL94V-0
- \*Mates with CJT A2501H,HB-XP series Housing
- \*Color:Ivory

- Ordering Information:  
A2501WR-S-XP - \*\*\* - \*\* - \*\*  
1 2 3 4
- 1.Part No.
  - 2.Material:  
(Blank):Nylon 6T,UL94V-0  
GWT:Nylon 6T,UL94V-0,GWT 750°C
  - 3.Color:  
(blank):Ivory  
BL:Blue RD:Red  
GN:Green LY:Lemon yellow
  - 4.Finish:  
(blank):Tin over Nickel  
G:Gold over Nickel

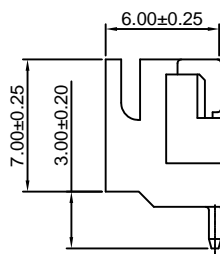
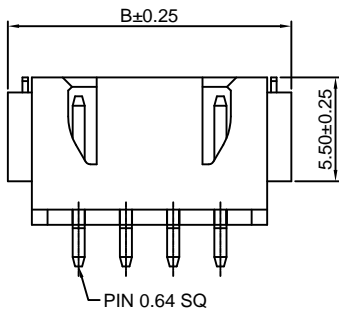
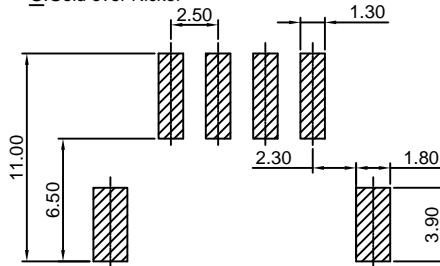
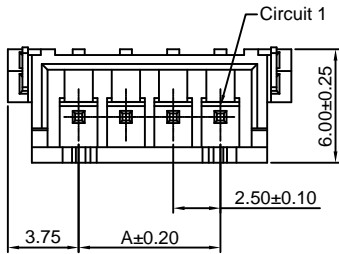
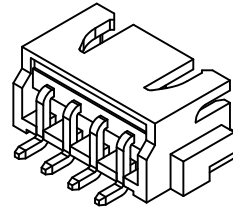

**Ordering Information & Dimensions:**

| PART NO. | Dimensions |       |
|----------|------------|-------|
|          | A          | B     |
| 2P       | 2.50       | 10.00 |
| 3P       | 5.00       | 12.50 |
| 4P       | 7.50       | 15.00 |
| 5P       | 10.00      | 17.50 |
| 6P       | 12.50      | 20.00 |
| 7P       | 15.00      | 22.50 |
| 8P       | 17.50      | 25.00 |
| 9P       | 20.00      | 27.50 |
| 10P      | 22.50      | 30.00 |
| 11P      | 25.00      | 32.50 |
| 12P      | 27.50      | 35.00 |
| 13P      | 30.00      | 37.50 |
| 14P      | 32.50      | 40.00 |
| 15P      | 35.00      | 42.50 |
| 16P      | 37.50      | 45.00 |
| 17P      | 40.00      | 47.50 |
| 18P      | 42.50      | 50.00 |
| 19P      | 45.00      | 52.50 |
| 20P      | 47.50      | 55.00 |

Unit: mm

### A2501WRA-S-F-2P

2.50mm pitch 90° Wafer - SMT TYPE

**Reference Informations:**

- \*Material:Pin:Copper Alloy/Tin over Nickel  
Insulator:Nylon 9T,UL94V-0
- \*Color:Ivory

- Ordering Information:  
A2501WRA-S-F-2P - \*\*\* - \*\*  
1 2 3
- 1.Part No.
  - 2.Material:  
(Blank):Nylon 9T,UL94V-0  
GWT:Nylon 9T,UL94V-0,GWT 750°C
  - 3.Finish:  
(blank):Tin over Nickel  
G:Gold over Nickel

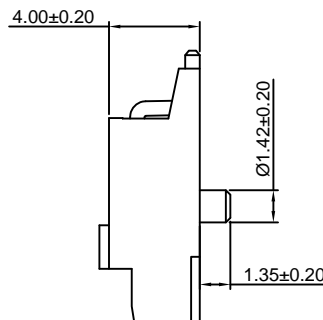
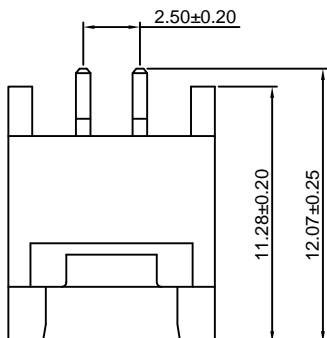
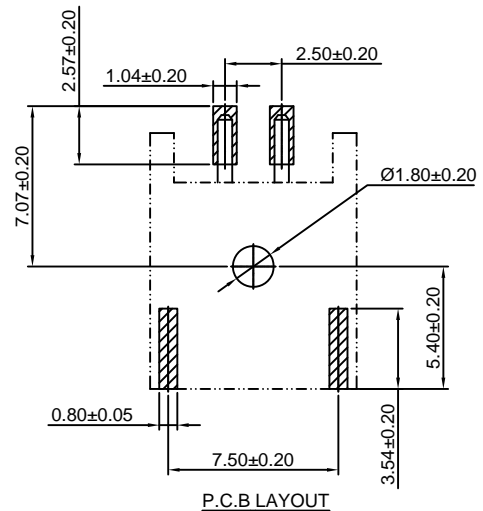
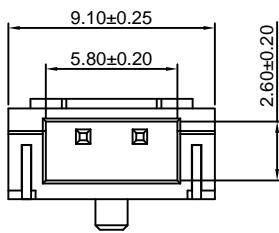

Unit: mm

### A2501WVT-XP

2.5mm pitch 180° Wafer ON RADIAL-TAPE

#### Reference Informations:

- \*Material: Pin: Brass/Tin over Nickel  
Insulator: Nylon66, UL94V-0
- \*Mates with CJT A2501H, HB-XP series Housing
- \*Color: White

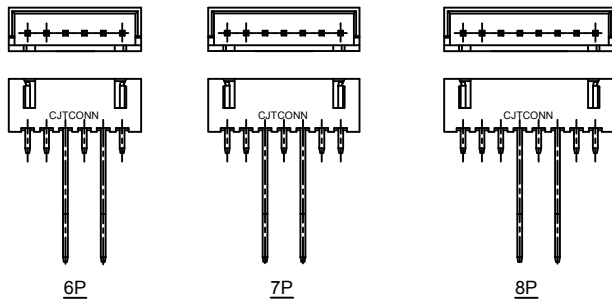
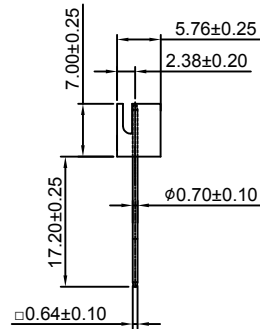
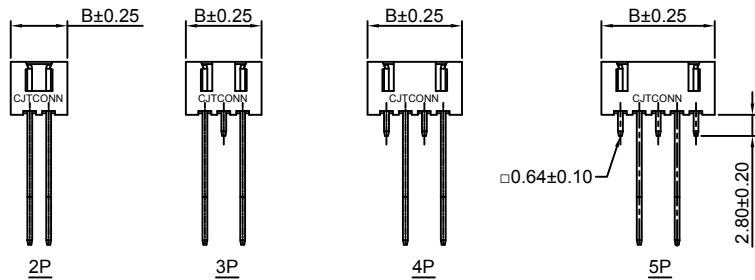
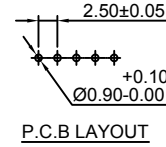
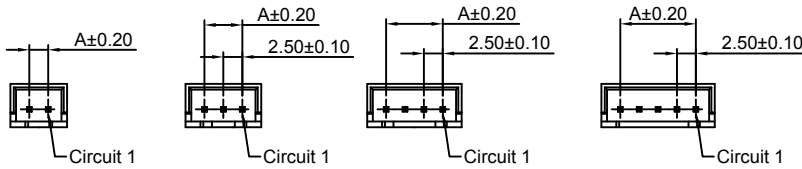
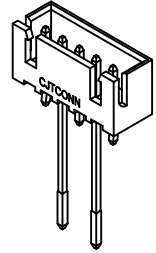

#### Ordering Information:

A2501WVT-XP - \*\*\* - \*\* - \*\*  
1 2 3 4

- Part No
- Material:  
(Blank): Nylon 66, UL94V-0  
GWT: Nylon 66, UL94V-0, GWT 750 °C
- Color:  
(blank): White  
BL: Blue BK: Black  
RD: Red YL: Yellow  
GN: Green
- Finish:  
(blank): Tin over Nickel  
G: Gold over Nickel

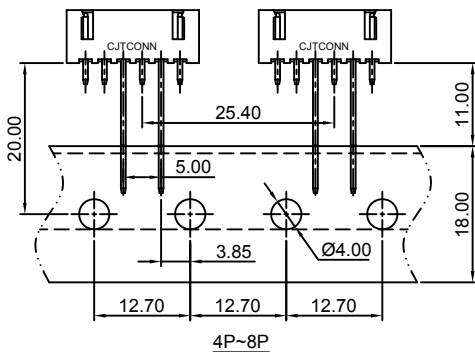
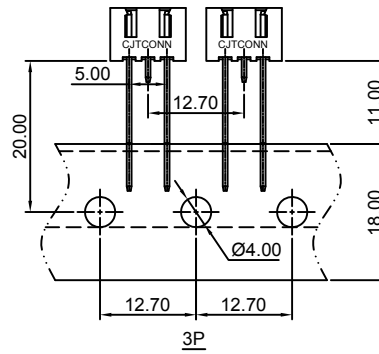
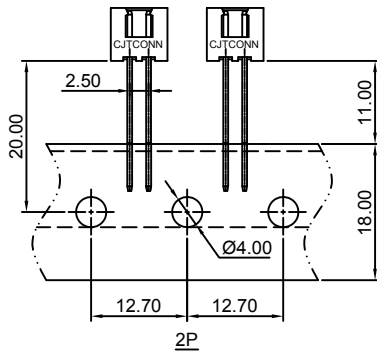

#### Ordering Information & Dimensions:

| PART NO. | Dimensions |       |
|----------|------------|-------|
|          | A          | B     |
| 2P       | 2.50       | 7.50  |
| 3P       | 5.00       | 10.00 |
| 4P       | 7.50       | 12.50 |
| 5P       | 10.00      | 15.00 |
| 6P       | 12.50      | 17.50 |
| 7P       | 15.00      | 20.00 |
| 8P       | 17.50      | 22.50 |

Unit: mm

### A2501HWV-XP

2.50mm pitch 180° Wafer

#### Reference Informations:

- \*Material:Pin:Phosphor Bronze/Tin over Nickel  
Insulator:Nylon 66,UL94V-0
- \*Mates with CJT A2501HMB-XP series Housing or A2501WV,WR, WV-S,WR-S,WV-F-XP,A2501WRB,WVR,WVT-XP series Wafer
- \*Color:White

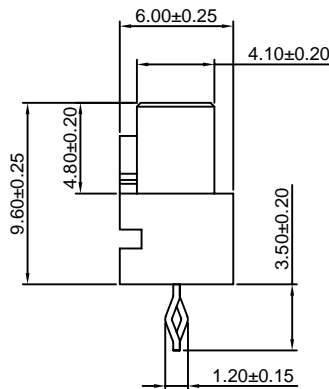
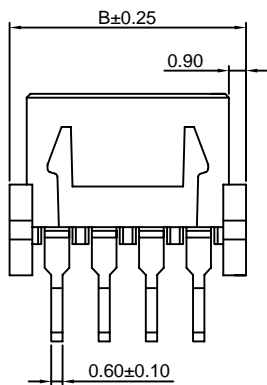
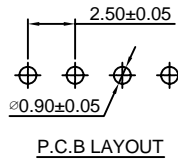
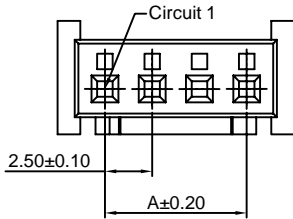

#### Ordering Information:

A2501HWV-XP - \*\*\* - \*\*  
1 2 3

- 1.Part No.
- 2.Material:  
(Blank):Nylon 66,UL94V-0  
GWT:Nylon 66,UL94V-0,GWT 750 °C
- 3.Finish:  
(blank):Tin over Nickel  
G:Gold over Nickel

#### Ordering Information & Dimensions:

| PART NO. | Dimensions |       |
|----------|------------|-------|
|          | A          | B     |
| 2P       | 2.50       | 7.50  |
| 3P       | 5.00       | 10.00 |
| 4P       | 7.50       | 12.50 |
| 5P       | 10.00      | 15.00 |
| 6P       | 12.50      | 17.50 |
| 7P       | 15.00      | 20.00 |
| 8P       | 17.50      | 22.50 |
| 9P       | 20.00      | 25.00 |
| 10P      | 22.50      | 27.50 |
| 11P      | 25.00      | 30.00 |
| 12P      | 27.50      | 32.50 |
| 13P      | 30.00      | 35.00 |
| 14P      | 32.50      | 37.50 |
| 15P      | 35.00      | 40.00 |
| 16P      | 37.50      | 42.50 |
| 17P      | 40.00      | 45.00 |
| 18P      | 42.50      | 47.50 |
| 19P      | 45.00      | 50.00 |
| 20P      | 47.50      | 52.50 |

Unit: mm

### A2501HWR-XP

2.50mm pitch 90° Wafer

#### Reference Informations:

- \*Material:Pin:Phosphor Bronze/Tin over Nickel  
Insulator:Nylon 66,UL94V-0
- \*Mates with CJT A2501HMB-XP series Housing or A2501WV,WR, WV-S,WR-S,WV-F-XP,A2501WRB,WVR,WVT-XP series Wafer
- \*Color:White

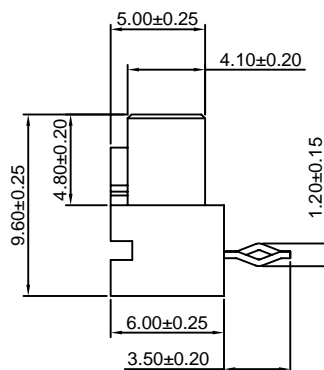
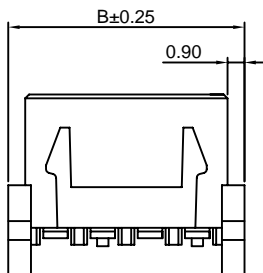
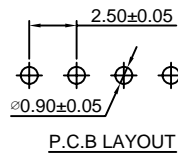
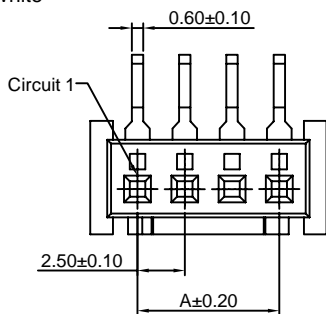

#### Ordering Information:

A2501HWR-XP - \*\*\* - \*\*  
1 2 3

- 1.Part No.
- 2.Material:  
(Blank):Nylon 66,UL94V-0  
GWT:Nylon 66,UL94V-0,GWT 750 °C
- 3.Finish:  
(blank):Tin over Nickel  
G:Gold over Nickel

#### Ordering Information & Dimensions:

| PART NO. | Dimensions |       |
|----------|------------|-------|
|          | A          | B     |
| 2P       | 2.50       | 7.50  |
| 3P       | 5.00       | 10.00 |
| 4P       | 7.50       | 12.50 |
| 5P       | 10.00      | 15.00 |
| 6P       | 12.50      | 17.50 |
| 7P       | 15.00      | 20.00 |
| 8P       | 17.50      | 22.50 |
| 9P       | 20.00      | 25.00 |
| 10P      | 22.50      | 27.50 |
| 11P      | 25.00      | 30.00 |
| 12P      | 27.50      | 32.50 |
| 13P      | 30.00      | 35.00 |
| 14P      | 32.50      | 37.50 |
| 15P      | 35.00      | 40.00 |
| 16P      | 37.50      | 42.50 |
| 17P      | 40.00      | 45.00 |
| 18P      | 42.50      | 47.50 |
| 19P      | 45.00      | 50.00 |
| 20P      | 47.50      | 52.50 |

Unit: mm

## X-ON Electronics

Largest Supplier of Electrical and Electronic Components

*Click to view similar products for [Headers & Wire Housings](#) category:*

*Click to view products by [Changjiang](#) manufacturer:*

Other Similar products are found below :

[57102-F02-18ULF](#) [58102-G61-06LF](#) [0009485154](#) [009176003701906](#) [0050291907](#) [00-9021-0611-00-339](#) [02.125.8002.8](#) [609-3404](#) [61062-3](#)  
[622-0430](#) [622-3653LF](#) [63453-116](#) [636-1030](#) [636-1427](#) [636-3427](#) [636-4007](#) [641938-9](#) [644827-2](#) [65495-038](#) [65692-001LF](#) [65781-018](#)  
[65781-047](#) [65817-010LF](#) [65817-015LF](#) [66207-023LF](#) [67016-026LF](#) [67095-007LF](#) [68631-112](#) [68645-018](#) [68648-049](#) [699319-000](#)  
[70.362.1628.0](#) [70-4210](#) [70-4226B](#) [70-4853B](#) [707-5020](#) [707-5028](#) [71.350.2428.0](#) [71961-016LF](#) [733-134](#) [754199-000](#) [760-3052](#) [787-8014-00](#)  
[FCN-367T-T012/H](#) [80.063.4001.1](#) [800-90-001-10-001000](#) [800-90-010-10-002000](#) [801-43-002-10-013000](#) [801-43-006-10-002000](#)  
[803-41-018-10-001000](#)