

Specifications

Current rating:3A AC,DC
Voltage rating:250V AC,DC
Temperature range:-40°C~+105°C
Contact resistance:10mΩMax.
Insulation resistance:1000MΩMin.
Withstanding voltage:800V AC/minute
Compliant with RoHS and REACH
Meet the HF/Halogen Free,need to customize
Contact CJT for details

Standards



Assembly layout

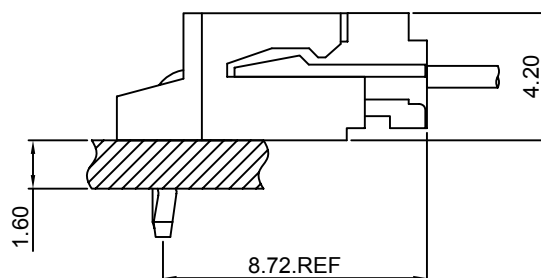
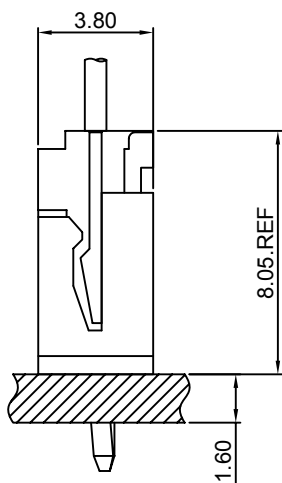

A2502-T

2.50mm pitch Crimp Terminal

Reference Informations:

*Used in CJT A2502 series Housing

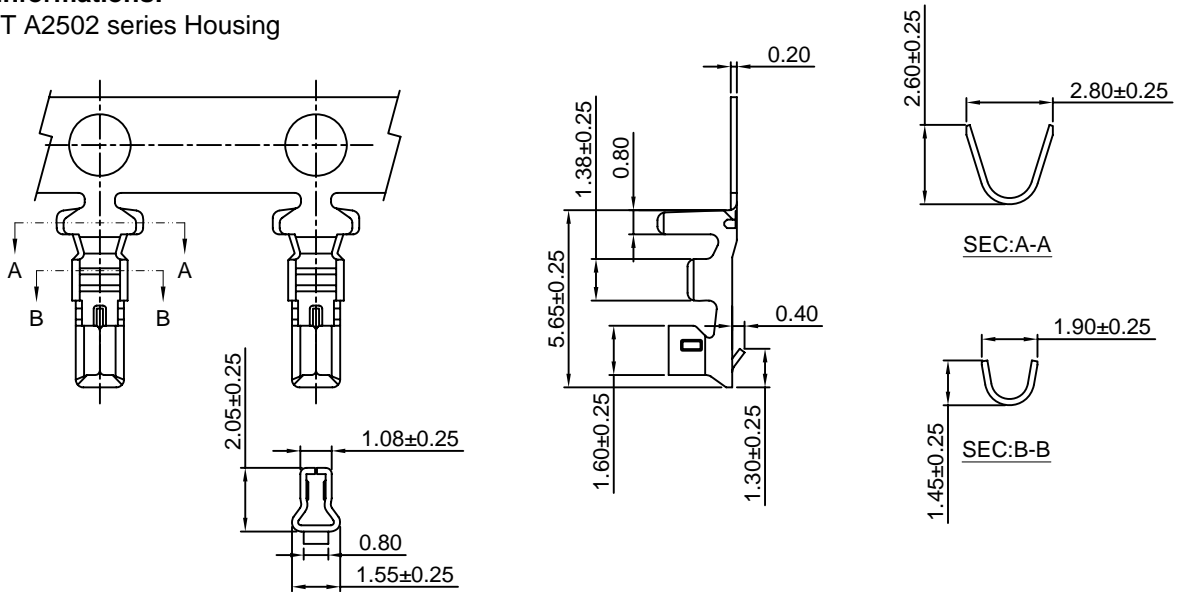

Ordering information & Specifications

Unit:mm

| Part NO | Wire Range | Insulation O.D. | Material | Finish | Qty/reel |
|----------|------------|-----------------|-----------------|------------------|------------|
| A2502-TP | AWG#22-#30 | 1.90mm(max) | Phosphor Bronze | Tin over Nickel | 10,000 PCS |
| A2502-GP | AWG#22-#30 | 1.90mm(max) | Phosphor Bronze | Gold over Nickel | 10,000 PCS |

Optional Gold plating available but MOQ requested

A2502H

2.50mm pitch Housing

Reference Informations:

*Material:Nylon 66,UL94V-0

*Suitable CJT A2502 series Terminal

*Mates with CJT A2502 series Wafer

*Color:White

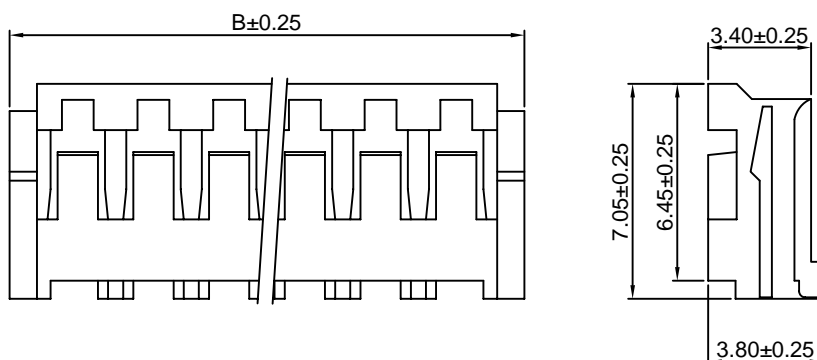
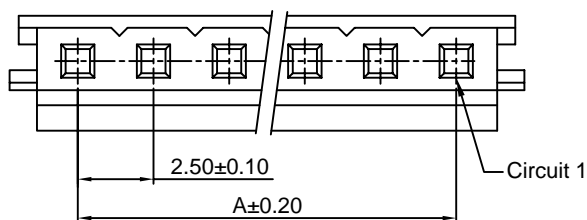
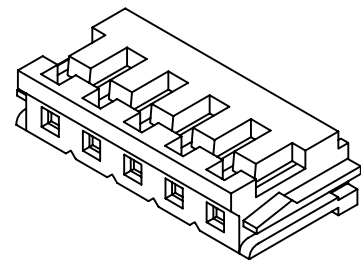

Ordering Information & Dimensions

| PART NO. | Dimensions | |
|------------|------------|-------|
| | A | B |
| A2502H-2P | 2.50 | 7.00 |
| A2502H-3P | 5.00 | 9.50 |
| A2502H-4P | 7.50 | 12.00 |
| A2502H-5P | 10.00 | 14.50 |
| A2502H-6P | 12.50 | 17.00 |
| A2502H-7P | 15.00 | 19.50 |
| A2502H-8P | 17.50 | 22.00 |
| A2502H-9P | 20.00 | 24.50 |
| A2502H-10P | 22.50 | 27.00 |
| A2502H-11P | 25.00 | 29.50 |
| A2502H-12P | 27.50 | 32.00 |
| A2502H-13P | 30.00 | 34.50 |
| A2502H-14P | 32.50 | 37.00 |
| A2502H-15P | 35.00 | 39.50 |

Unit: mm

A2502WV

2.50mm pitch 180° Wafer

Reference Informations:

- *Material:Pin:Brass/Tin over Nickel
Insulator:Nylon 66,UL94V-0
- *Mates with CJT A2502 series Housing
- *Color:White

Ordering Information:

- A2502WV-XP - **
1 2
- 1.Part No.
 - 2.Style
(blank)-Type 1
2-Type 2

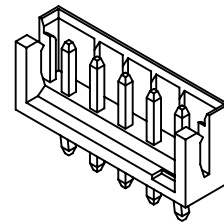
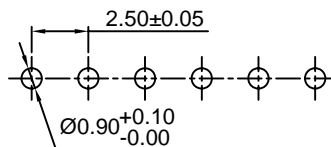
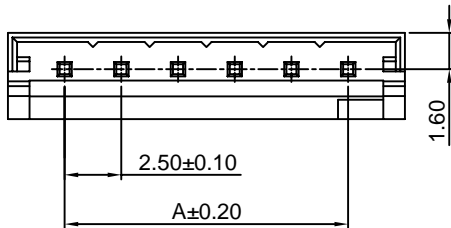

Ordering Information & Dimensions

| PART NO. | Dimensions | |
|-------------|------------|-------|
| | A | B |
| A2502WV-2P | 2.50 | 7.50 |
| A2502WV-3P | 5.00 | 10.00 |
| A2502WV-4P | 7.50 | 12.50 |
| A2502WV-5P | 10.00 | 15.00 |
| A2502WV-6P | 12.50 | 17.50 |
| A2502WV-7P | 15.00 | 20.00 |
| A2502WV-8P | 17.50 | 22.50 |
| A2502WV-9P | 20.00 | 25.00 |
| A2502WV-10P | 22.50 | 27.50 |
| A2502WV-11P | 25.00 | 30.00 |
| A2502WV-12P | 27.50 | 32.50 |
| A2502WV-13P | 30.00 | 35.00 |
| A2502WV-14P | 32.50 | 37.50 |
| A2502WV-15P | 35.00 | 40.00 |

Unit: mm

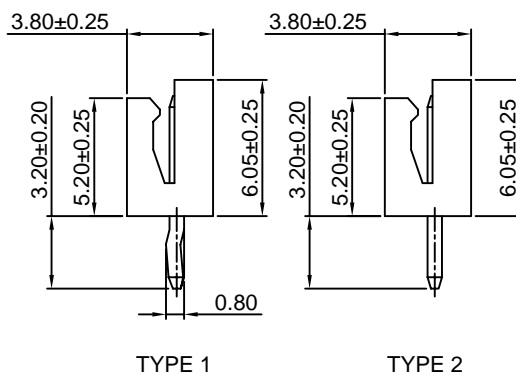
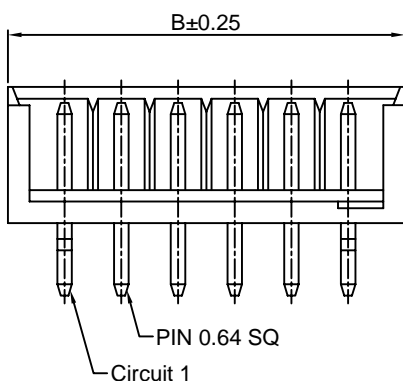

A2502WR

2.50mm pitch 90° Wafer

Reference Informations:

- *Material:Pin:Brass/Tin over Nickel
Insulator:Nylon 66,UL94V-0
- *Mates with CJT A2502 series Housing
- *Color:White

Ordering Information:

- A2502WR-XP - **
1 2
- 1.Part No.
 - 2.Style
(blank)-Type 1
2-Type 2

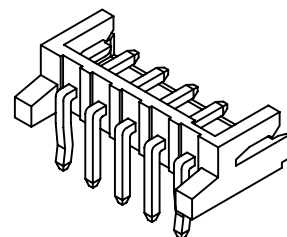
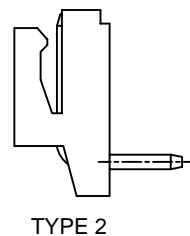
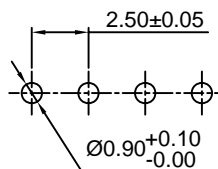
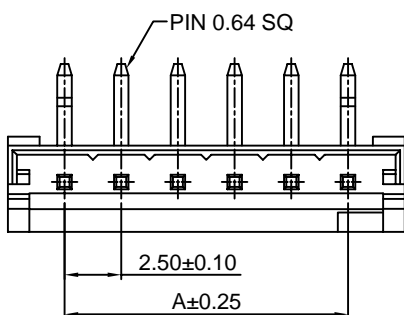

Ordering Information & Dimensions

| PART NO. | Dimensions | |
|-------------|------------|-------|
| | A | B |
| A2502WR-2P | 2.50 | 7.50 |
| A2502WR-3P | 5.00 | 10.00 |
| A2502WR-4P | 7.50 | 12.50 |
| A2502WR-5P | 10.00 | 15.00 |
| A2502WR-6P | 12.50 | 17.50 |
| A2502WR-7P | 15.00 | 20.00 |
| A2502WR-8P | 17.50 | 22.50 |
| A2502WR-9P | 20.00 | 25.00 |
| A2502WR-10P | 22.50 | 27.50 |
| A2502WR-11P | 25.00 | 30.00 |
| A2502WR-12P | 27.50 | 32.50 |
| A2502WR-13P | 30.00 | 35.00 |
| A2502WR-14P | 32.50 | 37.50 |
| A2502WR-15P | 35.00 | 40.00 |

Unit: mm

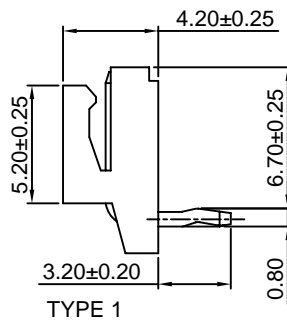
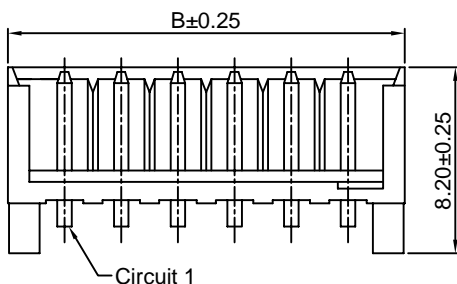

X-ON Electronics

Largest Supplier of Electrical and Electronic Components

Click to view similar products for [Headers & Wire Housings](#) category:

Click to view products by [Changjiang](#) manufacturer:

Other Similar products are found below :

[57102-F02-18ULF](#) [58102-G61-06LF](#) [582553-1](#) [009176003701906](#) [0050291907](#) [02.125.8002.8](#) [609-3404](#) [61062-3](#) [622-0430](#) [622-3653LF](#)
[63453-116](#) [636-1030](#) [636-1427](#) [636-3427](#) [636-4007](#) [641938-9](#) [65495-038](#) [65692-001LF](#) [65781-018](#) [65781-047](#) [65817-010LF](#) [65817-015LF](#)
[66207-023LF](#) [67016-026LF](#) [67095-007LF](#) [68631-112](#) [68645-018](#) [68648-049](#) [699319-000](#) [M90C108951C](#) [70.362.1628.0](#) [70-4210](#) [70-4226B](#)
[70-4853B](#) [707-5020](#) [707-5028](#) [71.350.2428.0](#) [71961-016LF](#) [733-134](#) [754199-000](#) [760-3052](#) [787-8014-00](#) [FCN-367T-T012/H](#)
[80.063.4001.1](#) [800-90-001-10-001000](#) [801-43-002-10-013000](#) [801-43-006-10-002000](#) [803-41-018-10-001000](#) [803-43-014-20-001000](#)
[803-43-024-10-001000](#)