

Specifications

Current rating:3A AC,DC
Voltage rating:250V AC,DC
Temperature range:-40°C~+105°C
Contact resistance:20mΩMax.
Insulation resistance:1000MΩMin.
Withstanding voltage:1000V AC/minute
Compliant with RoHS and REACH
Meet the HF/Halogen Free,need to customize
Contact CJT for details

Standards



Assembly layout

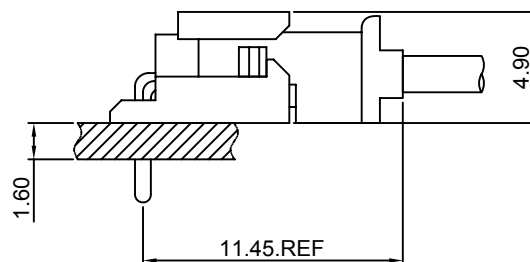
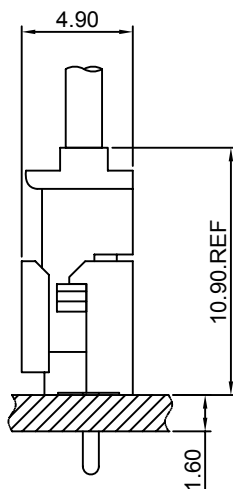

A2505-T

2.50mm pitch Crimp Terminal

Reference Informations:

*Used in CJT A2505 series Housing

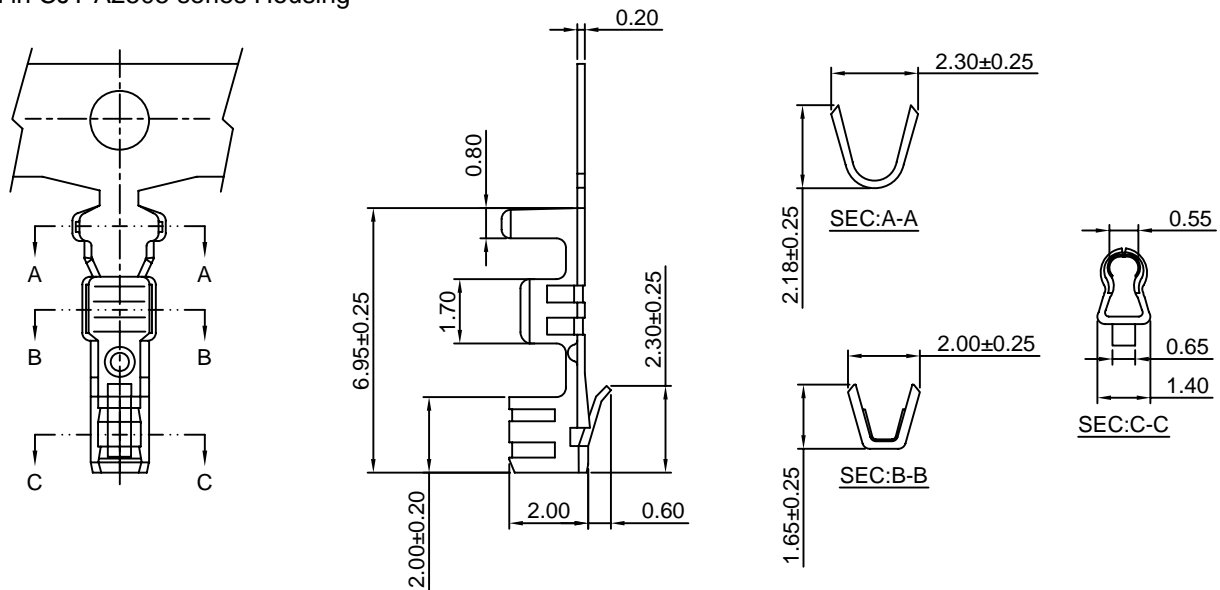

Ordering information & Specifications:

Unit:mm

| Part NO | Wire Range | Insulation O.D. | Material | Finish | Qty/reel |
|----------|------------|-----------------|-----------------|------------------|------------|
| A2505-TP | AWG#22-#28 | 1.90mm(max) | Phosphor Bronze | Tin over Nickel | 10,000 PCS |
| A2505-GP | AWG#22-#28 | 1.90mm(max) | Phosphor Bronze | Gold over Nickel | 10,000 PCS |

Optional Gold plating available but MOQ requested

A2505H

2.50mm pitch Housing

Reference Informations:

*Material:Nylon 66,UL94V-0

*Suitable CJT A2505 series Terminal

*Mates with CJT A2505 series Wafer

*Color:Beige

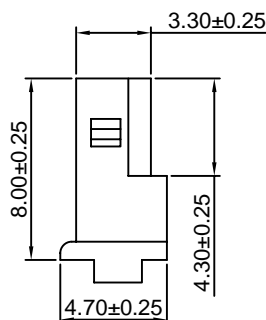
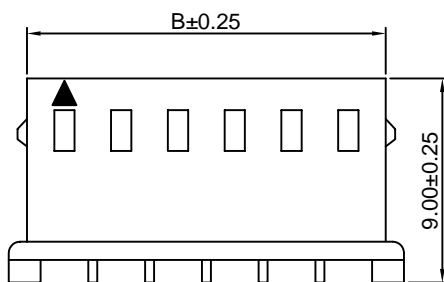
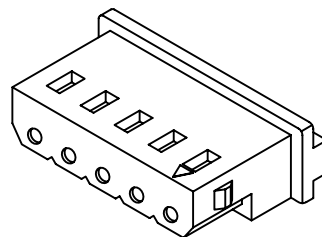
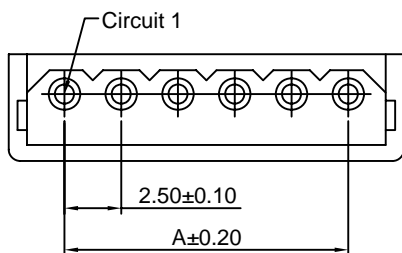

Ordering Information & Dimensions

| PART NO. | Dimensions | |
|------------|------------|-------|
| | A | B |
| A2505H-2P | 2.50 | 5.80 |
| A2505H-3P | 5.00 | 8.30 |
| A2505H-4P | 7.50 | 10.80 |
| A2505H-5P | 10.00 | 13.30 |
| A2505H-6P | 12.50 | 15.80 |
| A2505H-7P | 15.00 | 18.30 |
| A2505H-8P | 17.50 | 20.80 |
| A2505H-9P | 20.00 | 23.30 |
| A2505H-10P | 22.50 | 25.80 |
| A2505H-11P | 25.00 | 28.30 |
| A2505H-12P | 27.50 | 30.80 |
| A2505H-13P | 30.00 | 33.30 |
| A2505H-14P | 32.50 | 35.80 |
| A2505H-15P | 35.00 | 38.30 |
| A2505H-16P | 37.00 | 40.80 |
| A2505H-17P | 39.50 | 43.30 |
| A2505H-18P | 42.00 | 45.80 |
| A2505H-19P | 44.50 | 48.30 |
| A2505H-20P | 47.00 | 50.80 |

Unit: mm

A2505WV

2.50mm pitch 180° Wafer

Reference Informations:

- *Material:Pin:Brass/Tin over Nickel
Insulator:Nylon 66,UL94V-0
- *Mates with CJT A2505 series Housing
- *Color:Beige

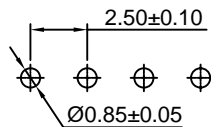
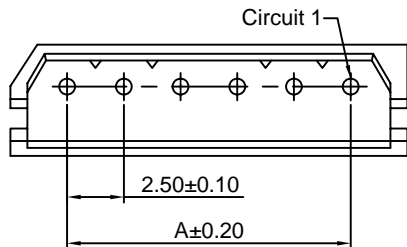

P.C.B LAYOUT

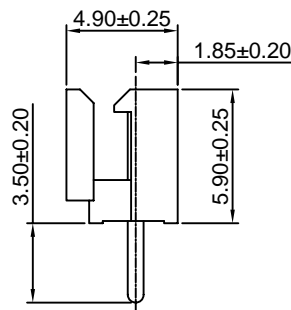
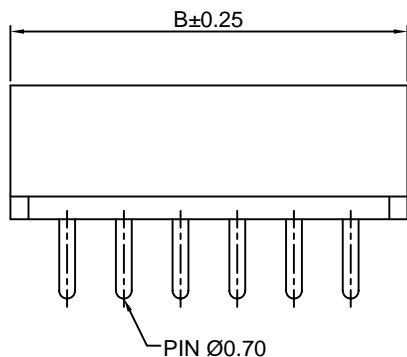

Ordering Information & Dimensions

| PART NO. | Dimensions | |
|-------------|------------|-------|
| | A | B |
| A2505WV-2P | 2.50 | 7.50 |
| A2505WV-3P | 5.00 | 10.00 |
| A2505WV-4P | 7.50 | 12.50 |
| A2505WV-5P | 10.00 | 15.00 |
| A2505WV-6P | 12.50 | 17.50 |
| A2505WV-7P | 15.00 | 20.00 |
| A2505WV-8P | 17.50 | 22.50 |
| A2505WV-9P | 20.00 | 25.00 |
| A2505WV-10P | 22.50 | 27.50 |
| A2505WV-11P | 25.00 | 30.00 |
| A2505WV-12P | 27.50 | 32.50 |
| A2505WV-13P | 30.00 | 35.00 |
| A2505WV-14P | 32.50 | 37.50 |
| A2505WV-15P | 35.00 | 40.00 |
| A2505WV-16P | 37.50 | 42.50 |
| A2505WV-17P | 40.00 | 45.00 |
| A2505WV-18P | 42.50 | 47.50 |
| A2505WV-19P | 45.00 | 50.00 |
| A2505WV-20P | 47.50 | 52.50 |

Unit: mm

A2505WR

2.50mm pitch 90° Wafer

Reference Informations:

- *Material:Pin:Brass/Tin over Nickel
Insulator:Nylon 66,UL94V-0
- *Mates with CJT A2505 series Housing
- *Color:Beige

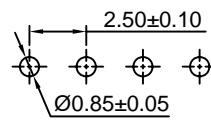
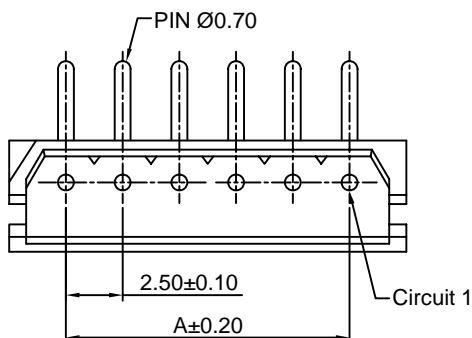

P.C.B LAYOUT

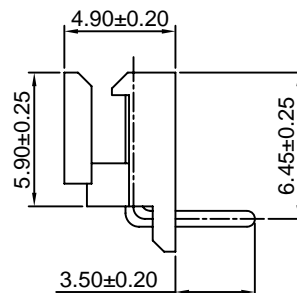
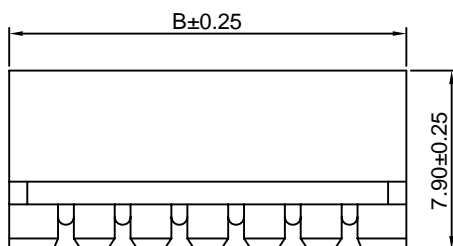

Ordering Information & Dimensions

| PART NO. | Dimensions | |
|-------------|------------|-------|
| | A | B |
| A2505WR-2P | 2.50 | 7.50 |
| A2505WR-3P | 5.00 | 10.00 |
| A2505WR-4P | 7.50 | 12.50 |
| A2505WR-5P | 10.00 | 15.00 |
| A2505WR-6P | 12.50 | 17.50 |
| A2505WR-7P | 15.00 | 20.00 |
| A2505WR-8P | 17.50 | 22.50 |
| A2505WR-9P | 20.00 | 25.00 |
| A2505WR-10P | 22.50 | 27.50 |
| A2505WR-11P | 25.00 | 30.00 |
| A2505WR-12P | 27.50 | 32.50 |
| A2505WR-13P | 30.00 | 35.00 |
| A2505WR-14P | 32.50 | 37.50 |
| A2505WR-15P | 35.00 | 40.00 |
| A2505WR-16P | 37.50 | 42.50 |
| A2505WR-17P | 40.00 | 45.00 |
| A2505WR-18P | 42.50 | 47.50 |
| A2505WR-19P | 45.00 | 50.00 |
| A2505WR-20P | 47.50 | 52.50 |

Unit: mm

X-ON Electronics

Largest Supplier of Electrical and Electronic Components

Click to view similar products for [Headers & Wire Housings](#) category:

Click to view products by [Changjiang](#) manufacturer:

Other Similar products are found below :

[57102-F02-18ULF](#) [58102-G61-06LF](#) [0009485154](#) [009176003701906](#) [0050291907](#) [00-9021-0611-00-339](#) [02.125.8002.8](#) [609-3404](#) [61062-3](#)
[622-0430](#) [622-3653LF](#) [63453-116](#) [636-1030](#) [636-1427](#) [636-3427](#) [636-4007](#) [641938-9](#) [644827-2](#) [65495-038](#) [65692-001LF](#) [65781-018](#)
[65781-047](#) [65817-010LF](#) [65817-015LF](#) [66207-023LF](#) [67016-026LF](#) [67095-007LF](#) [68631-112](#) [68645-018](#) [68648-049](#) [699319-000](#)
[70.362.1628.0](#) [70-4210](#) [70-4226B](#) [70-4853B](#) [707-5020](#) [707-5028](#) [71.350.2428.0](#) [71961-016LF](#) [733-134](#) [754199-000](#) [760-3052](#) [787-8014-00](#)
[FCN-367T-T012/H](#) [80.063.4001.1](#) [800-90-001-10-001000](#) [800-90-010-10-002000](#) [801-43-002-10-013000](#) [801-43-006-10-002000](#)
[803-41-018-10-001000](#)