



SOT-23-3LK Plastic-Encapsulate Thyristors

CT401L 4Q TRIACs

MAIN CHARACTERISTICS

$I_{T(RMS)}$		1A
V_{DRM}/V_{RRM}	CT401L-600T/S	600V
	CT401L-800T/S	800V
V_{TM}		1.55V

FEATURES

- NPNPN 5-layer Structure TRIACs
- Mesa Glass Passivated Technology
- Multi Layers Metal Electrodes
- High Junction Temperature
- Good Commutation Performance

APPLICATIONS

- Heater Control
- Motor Speed Controller
- Mixer

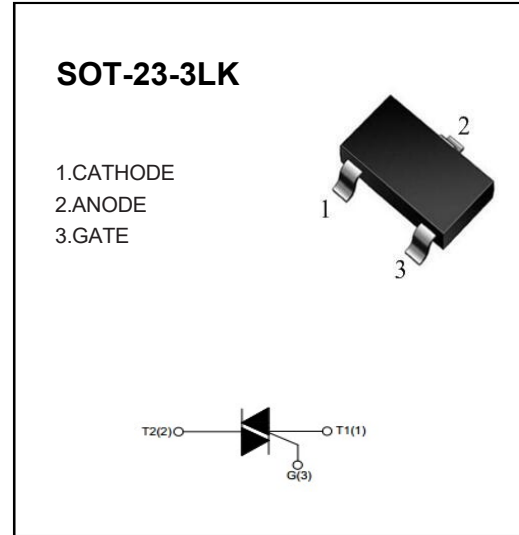

ABSOLUTE RATINGS ($T_a=25^{\circ}C$ unless otherwise noted)

Symbol	Parameter	Test condition	Value	Unit	
V_{DRM}/V_{RRM}	Repetitive peak off-state voltage	$T_j=25^{\circ}C$	CT401L-600T/S	600	V
			CT401L-800T/S	800	V
$I_{T(RMS)}$	RMS on-state current	SOT-23-3LK($T_C \leq 60^{\circ}C$), Fig. 1,2	1	A	
I_{TSM}	Non repetitive surge peak on-state current	Full sine wave , $T_j(\text{init})=25^{\circ}C$, $t_p=20\text{ms}$; Fig. 3,5	10	A	
I^2t	I^2t value	$t_p=10\text{ms}$	1.28	A^2s	
di_T/dt	Critical rate of rise of on-state current	$I_G=2 \cdot I_{GT}$, $t_r \leq 10\text{ns}$, $F=120\text{Hz}$, $T_j=125^{\circ}C$	I - II - III	50	$A/\mu s$
			IV	10	
I_{GM}	Peak gate current	$t_p=20\mu s$, $T_j=125^{\circ}C$	2	A	
$P_{G(AV)}$	Average gate power	$T_j=125^{\circ}C$	0.5	W	
T_{STG}	Storage temperature		-40~+150	$^{\circ}C$	
T_j	Operating junction temperature		-40~+125		

ELECTRICAL CHARACTERISTICS (T_a=25°C unless otherwise specified)

Symbol	Parameter	Test condition	Value		Unit	
			T	S		
I _{GT}	Gate trigger current	V _D =12V, I _T =0.1A,	I - II - III	≤3	≤8	mA
			IV	≤5	≤10	
V _{GT}	Gate trigger voltage	T _j =25°C, Fig. 6	I - II - III - IV	≤1.3		V
V _{GD}	Non-triggering gate voltage	V _D =V _{DRM} , T _j =125°C		≥0.2		V
I _H	Holding current	V _D =12V, I _{GT} =0.1A, T _j =25°C, Fig. 6	I - II - III - IV	≤5	≤5	mA
I _L	Latching current		I - III - IV	≤6	≤10	mA
			II	≤10	≤15	mA
dV _D /dt	Critical rate of rise of off-state	V _D =67%V _{DRM} , Gate Open T _j =125°C		≥20	≥50	V/μs
V _{TM}	On-state Voltage	I _{TM} =1.5A, t _p =380μs, Fig. 4		≤1.55		V
I _{DRM} / I _{RRM}	Repetitive peak off-state current	V _D =V _{DRM} /V _{RRM} , T _j =25°C		≤5	≤5	μA
		V _D =V _{DRM} /V _{RRM} , T _j =125°C		≤0.1	≤0.1	mA

THERMAL RESISTANCES

Symbol	Parameter	Value	Unit
R _{th} (j-c)	Junction to case (AC)	SOT-23-3LK	32 °C/W
R _{th} (j-a)	Junction to ambient	SOT-23-3LK	400 °C/W

PART NUMBER

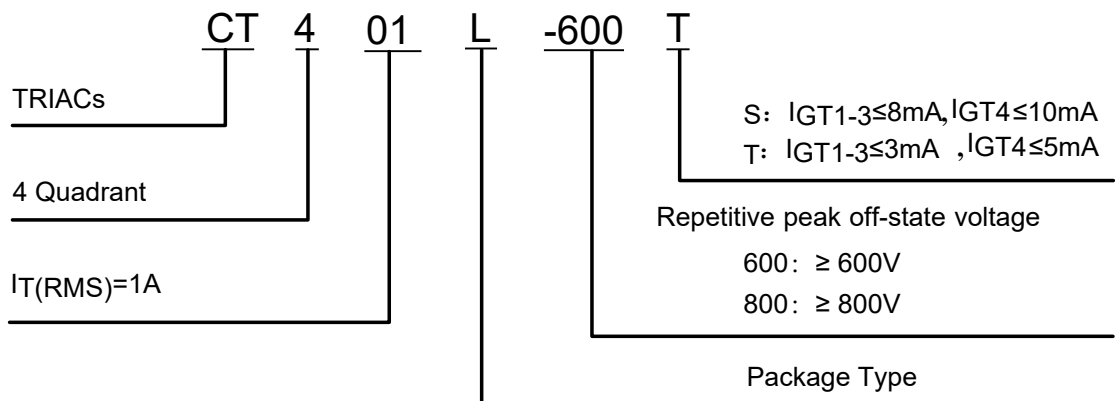

CHARACTERISTICS CURVES

FIG.1: Maximum power dissipation versus RMS on-state current (full cycle)

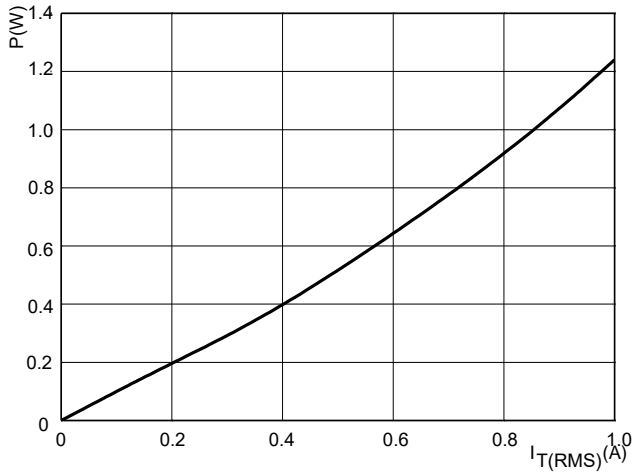

FIG.2: RMS on-state current versus case temperature (full cycle)

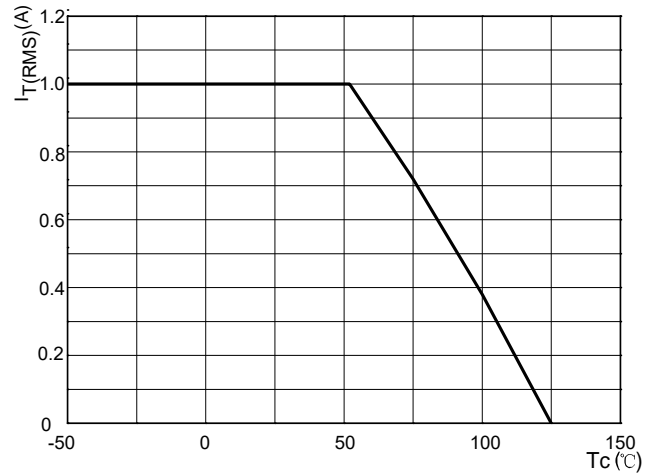

FIG.3: Surge peak on-state current versus number of cycles

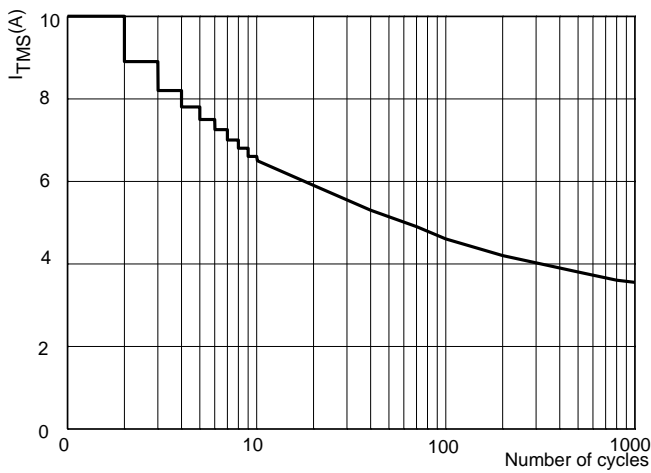

FIG.4: On-state characteristics (maximum values)

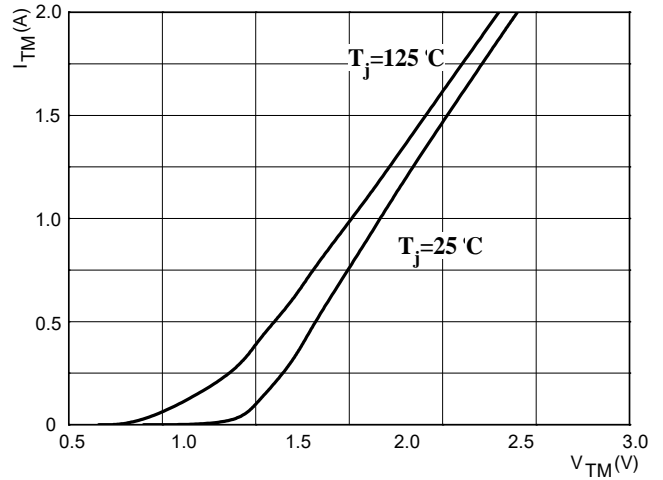

FIG.5: Non-repetitive surge peak on-state current for a sinusoidal pulse with width $t_p < 10\text{ms}$

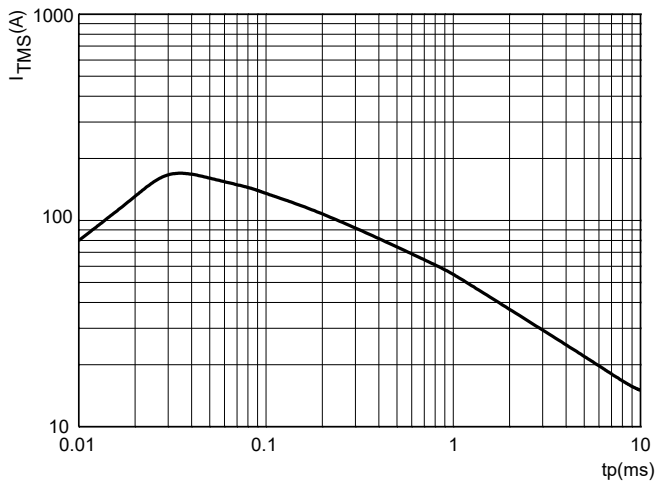
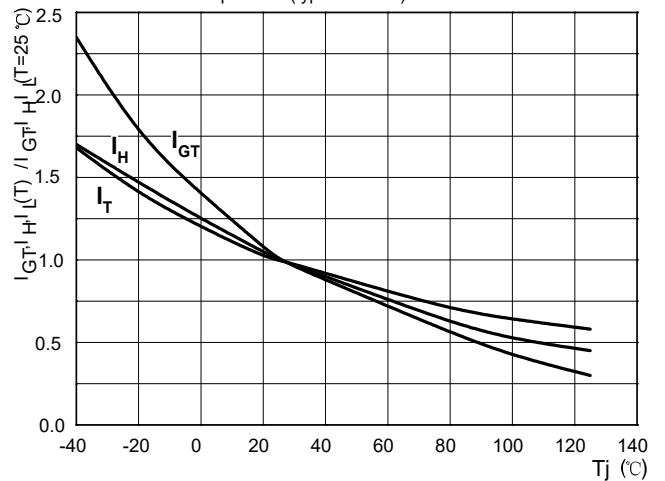
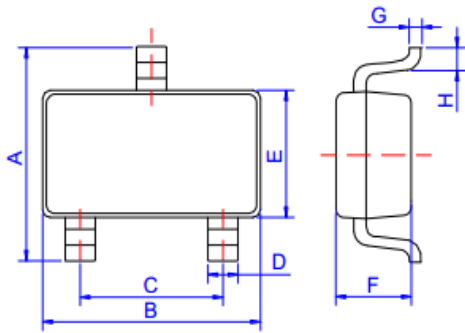

FIG.6: Relative variations of gate trigger current, holding current and latching current versus junction temperature (typical values)



SOT-23-3LK PACKAGE OUTLINE DIMENSIONS



Ref.	Dimensions					
	Millimeters			Inches		
	Min.	Typ.	Max.	Min.	Typ.	Max.
A	2.65		2.95	0.104		0.116
B		2.92			0.115	
C		1.90			0.075	
D	0.34		0.36	0.013		0.014
E		1.60			0.063	
F		1.17			0.046	
G		0.15			0.006	
H	0.25		0.55	0.010		0.022

X-ON Electronics

Largest Supplier of Electrical and Electronic Components

Click to view similar products for [Triacs](#) category:

Click to view products by [Changjiang](#) manufacturer:

Other Similar products are found below :

[T2035H-6G](#) [BT137-600-0Q](#) [Z0409MF0AA2](#) [Z0109NA 2AL2](#) [ACST1635T-8FP](#) [BCR20RM-30LA#B00](#) [CMA60MT1600NHR](#) [NTE5611](#)
[NTE5612](#) [NTE5613](#) [NTE5621](#) [NTE5623](#) [NTE5629](#) [NTE5638-08](#) [NTE5688](#) [NTE5689](#) [NTE5690](#) [T1235T-8I](#) [BTA312-600CT.127](#) [T1210T-](#)
[8G-TR](#) [Z0109NN0,135](#) [T2535T-8I](#) [T2535T-8T](#) [TN4050-12WL](#) [MAC4DLM-1G](#) [BT137-600E,127](#) [BT137X-600D](#) [BT148W-600R,115](#)
[BT258-500R,127](#) [BTA08-800BW3G](#) [BTA140-800,127](#) [BTA30-600CW3G](#) [BTA30-600CW3G](#) [BTB08-800BW3G](#) [BTB16-600CW3G](#)
[BTB16-600CW3G](#) [Z0410MF0AA2](#) [Z0109MN,135](#) [T825T-6I](#) [T1635T-6I](#) [T1220T-6I](#) [NTE5638](#) [TYN612MRG](#) [TYN1225RG](#) [TPDV840RG](#)
[ACST1235-8FP](#) [ACS302-6T3-TR](#) [BT134-600D,127](#) [BT134-600G,127](#) [BT136X-600E,127](#)