

BMMI Series



BMMI Series is designed for low profile type with low RDC and ultra large current. Its molded magnetic shielded type is suitable for high-density mounting and ultra low buzz noise. Soldering conditions can be easily confirmed when mounting onto the board. This series also provides customers with embossed carrier type packaging for automatic mounting machine.

Features

- RoHS, Halogen Free and REACH Compliance
- Low resistance and high current rating
- Magnetic core made by high performance magnetic powder

Applications

- Laptop and desktop applications
- High current power supplies
- PMIC
- DC/DC converters

Product Identification

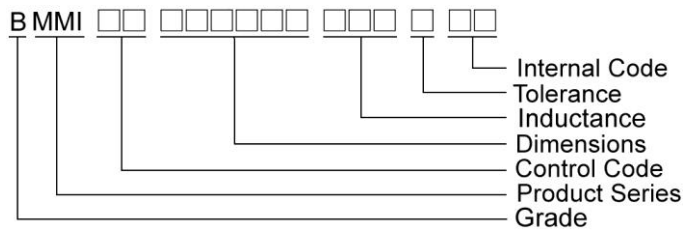

Shape and Dimensions

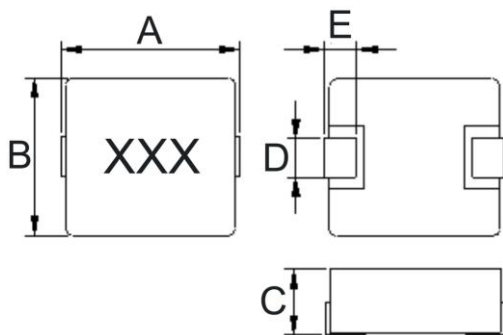

Dimensions in mm

| TYPE | A | B | C | D | E |
|--------------|-----------|-----------|--------|---------|----------|
| BMMI00040412 | 4.45±0.25 | 4.06±0.25 | 1.2Max | 2.0±0.3 | 0.76±0.3 |
| BMMI00050515 | 5.49±0.25 | 5.18±0.22 | 1.5Max | 2.0±0.3 | 1.0±0.3 |
| BMMI00060612 | 6.95±0.35 | 6.6±0.2 | 1.2Max | 3.0±0.3 | 1.6±0.3 |
| BMMI00060630 | 6.95±0.35 | 6.6±0.2 | 3.0Max | 3.0±0.3 | 1.6±0.3 |
| BMMI00131350 | 13.2±0.5 | 12.9Max | 5.0Max | 3.5±0.5 | 2.3±0.3 |
| BMMI00131365 | 13.2±0.5 | 12.9Max | 6.5Max | 3.5±0.5 | 2.3±0.3 |

Recommended Pattern

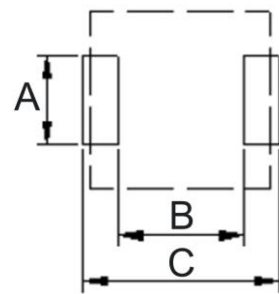

Dimensions in mm

| TYPE | A | B | C |
|--------------|-----|-----|------|
| BMMI00040412 | 2.5 | 2.2 | 5.2 |
| BMMI00050515 | 2.5 | 2.2 | 5.99 |
| BMMI00060612 | 3.5 | 3.7 | 8.4 |
| BMMI00060630 | 3.5 | 3.7 | 8.4 |
| BMMI00131350 | 5.0 | 8.0 | 14.5 |
| BMMI00131365 | 5.5 | 8.0 | 14.5 |

Molding Power Inductors – BMMI Series

Electrical Characteristics

| Part Number | Inductance (uH) | Tolerance (±%) | Test Frequency (kHz) | RDC(mΩ) Max(Typ.) | Isat(A) Max(Typ.) | Irms(A) Max(Typ.) | Marking |
|--------------------|-----------------|----------------|----------------------|-------------------|-------------------|-------------------|---------|
| BMMI000404124R7MX1 | 4.7 | 20 | 100 | 145(124) | 2.8(3.2) | 2.1(2.4) | 4R7 |

Note: When ordering, please specify tolerance code. Tolerance: M=±20%

- Operating temperature range - 55°C ~ 125°C(Including self - temperature rise)
- Isat for Inductance drop 30% from its value without current
- I rms for a 40°C temperature rise from 25°C ambient with current
- Measure Equipment :
 L : WK 3260B or WK 6500P, 100kHz 0.25V
 RDC : CHEN HWA 502 or CHEN HWA 46502B
 I rms : CHROMA 1810

Test Instruments : WK3260B Impedance / Material Analyzer

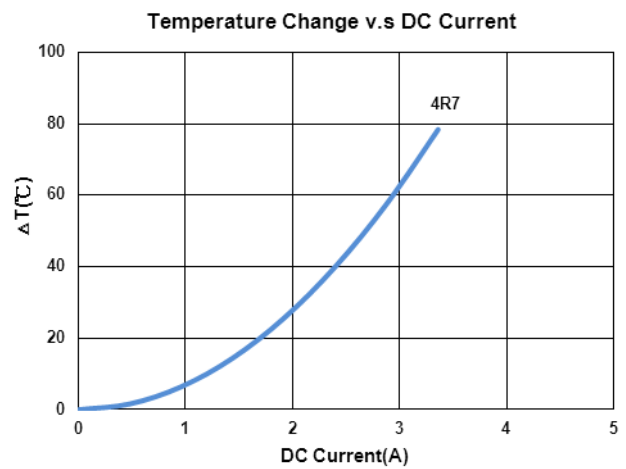
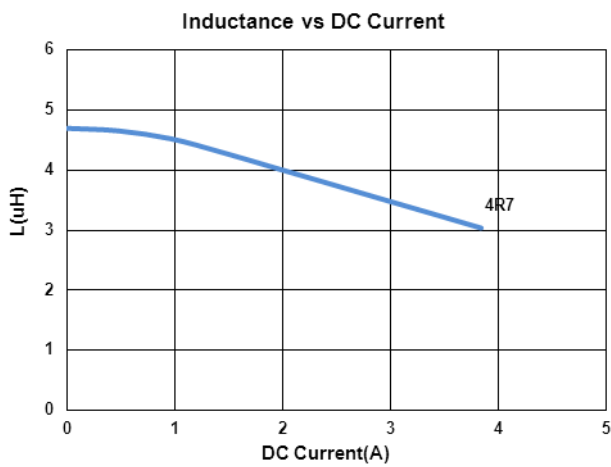

Molding Power Inductors – BMMI Series

Electrical Characteristics

| Part Number | Inductance (uH) | Tolerance (±%) | Test Frequency (kHz) | RDC(mΩ) Max(Typ.) | Isat(A) Max(Typ.) | Irms(A) Max(Typ.) | Marking |
|--------------------|-----------------|----------------|----------------------|-------------------|-------------------|-------------------|---------|
| BMMI000505151R0MX2 | 1.0 | 20 | 100 | 23(19) | 8.1(9.5) | 5.8(6.5) | 1R0 |

Note: When ordering, please specify tolerance code. Tolerance: M=±20%

- Operating temperature range - 55°C ~ 125°C(Including self - temperature rise)
- Isat for Inductance drop 30% from its value without current
- I rms for a 40°C temperature rise from 25°C ambient with current
- Measure Equipment :
 L : WK 3260B or WK 6500P, 100kHz 0.25V
 RDC : CHEN HWA 502 or CHEN HWA 46502B
 I rms : CHROMA 1810

Test Instruments : WK3260B Impedance / Material Analyzer

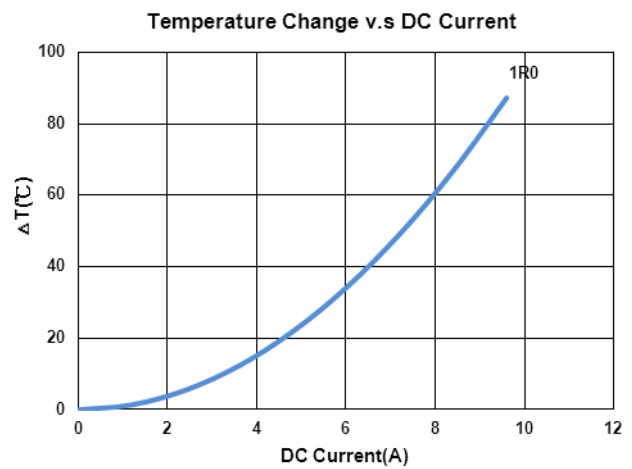
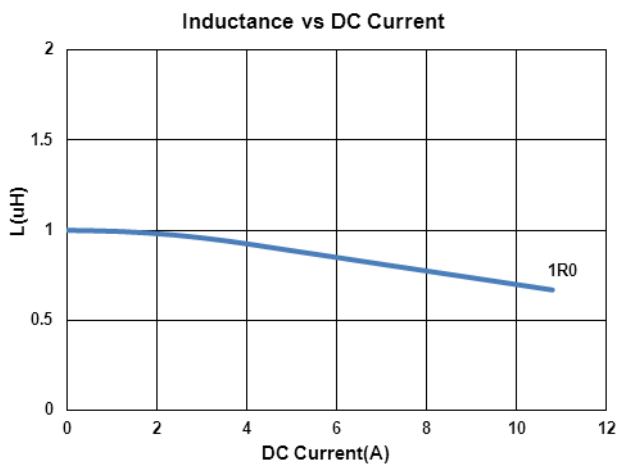

Molding Power Inductors – BMMI Series

Electrical Characteristics

| Part Number | Inductance (uH) | Tolerance (±%) | Test Frequency (kHz) | RDC(mΩ) Max(Typ.) | Isat (A)Typ. | Irms (A)Typ. | Marking |
|--------------------|-----------------|----------------|----------------------|-------------------|--------------|--------------|---------|
| BMMI000606121R0MX1 | 1.0 | 20 | 100 | 29(25) | 7.5 | 6.0 | 1R0 |

Note: When ordering, please specify tolerance code. Tolerance: M=±20%

- Operating temperature range - 55°C ~ 125°C(Including self - temperature rise)
- Isat for Inductance drop 30% from its value without current
- Irms for a 40°C temperature rise from 25°C ambient with current
- Measure Equipment :
 L : WK 3260B or WK 6500P, 100kHz 0.25V
 RDC : CHEN HWA 502 or CHEN HWA 46502B
 Irms : CHROMA 1810

Test Instruments : WK3260B Impedance / Material Analyzer

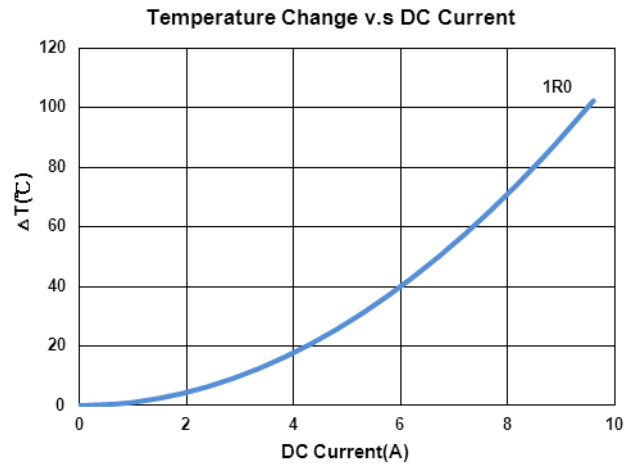
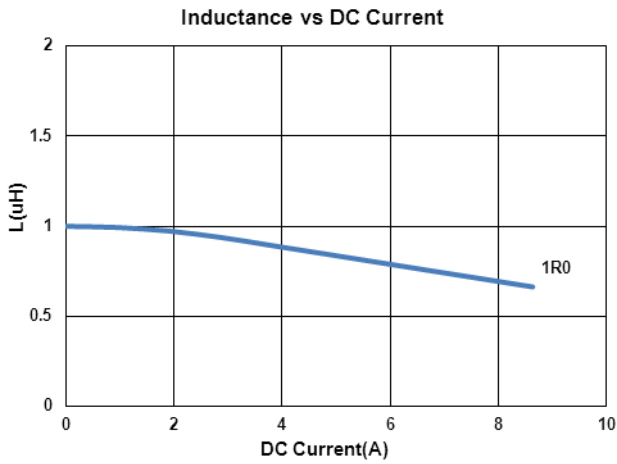

Molding Power Inductors – BMMI Series

Electrical Characteristics

| Part Number | Inductance (uH) | Tolerance (±%) | Test Frequency (kHz) | RDC(mΩ) Max(Typ.) | Isat(A) Max(Typ.) | Irms(A) Max(Typ.) | Marking |
|--------------------|-----------------|----------------|----------------------|-------------------|-------------------|-------------------|---------|
| BMMI00060630R30MX1 | 0.22 | 20 | 100 | 2.4(2.0) | 27(31) | 25.5(28) | R22 |
| BMMI00060630R47MX1 | 0.47 | 20 | 100 | 3.3(2.9) | 20(23) | 20(23) | R47 |
| BMMI000606301R0MX1 | 1.0 | 20 | 100 | 6.4(5.6) | 14(16) | 14.4(16) | 1R0 |
| BMMI000606301R5MX1 | 1.5 | 20 | 100 | 8.9(7.7) | 12.7(14.8) | 11(12) | 1R5 |
| BMMI000606302R2MX1 | 2.2 | 20 | 100 | 12.8(11) | 12(14) | 9(10) | 2R2 |
| BMMI000606303R3MX1 | 3.3 | 20 | 100 | 21(18.5) | 10(11) | 7(8) | 3R3 |
| BMMI000606304R7MX1 | 4.7 | 20 | 100 | 26(23.6) | 7(8) | 6(6.7) | 4R7 |

Note: When ordering, please specify tolerance code. Tolerance: M=±20%

- Operating temperature range - 55°C ~ 125°C(Including self - temperature rise)
- Isat for Inductance drop 30% from its value without current
- I rms for a 40°C temperature rise from 25°C ambient with current
- Measure Equipment :
 L : WK 3260B or WK 6500P, 100kHz 0.25V
 RDC : CHEN HWA 502 or CHEN HWA 46502B
 I rms : CHROMA 1810

Test Instruments : WK3260B Impedance / Material Analyzer

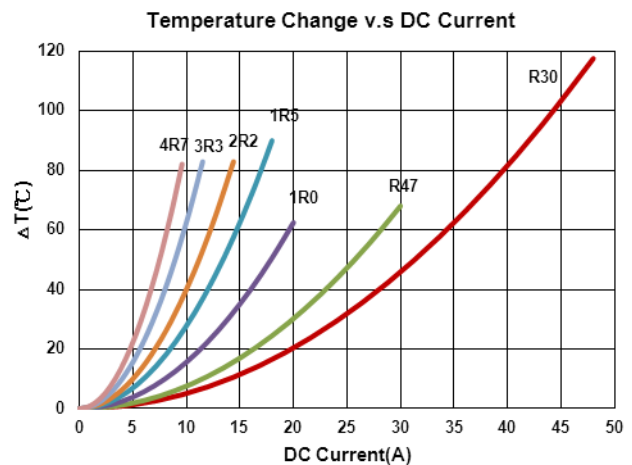
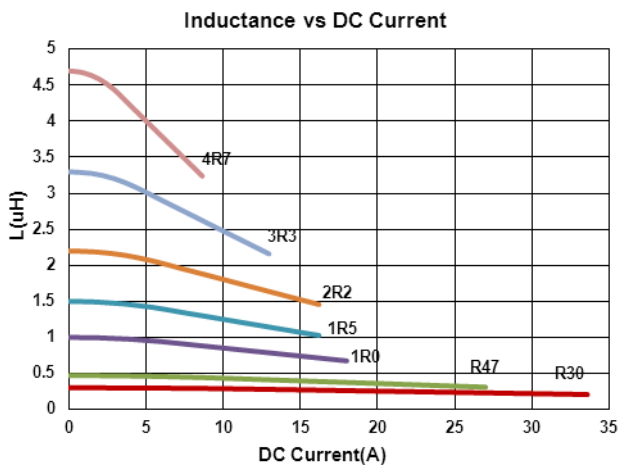

Molding Power Inductors – BMMI Series

Electrical Characteristics

| Part Number | Inductance (uH) | Tolerance (±%) | Test Frequency (kHz) | RDC(mΩ) Max(Typ.) | Isat (A)Typ. | Irms (A)Typ. | Marking |
|--------------------|-----------------|----------------|----------------------|-------------------|--------------|--------------|---------|
| BMMI001313503R3MX1 | 3.3 | 20 | 100 | 9.2(7.7) | 32 | 15 | 3R3 |

Note: When ordering, please specify tolerance code. Tolerance: M=±20%

- Operating temperature range - 55°C ~ 125°C(Including self - temperature rise)
- Isat for Inductance drop 20% from its value without current
- Irms for a 40°C temperature rise from 25°C ambient with current
- Measure Equipment :
 L : WK 3260B or WK 6500P, 100kHz 0.25V
 RDC : CHEN HWA 502 or CHEN HWA 46502B
 Irms : CHROMA 1810

Test Instruments : WK3260B Impedance / Material Analyzer

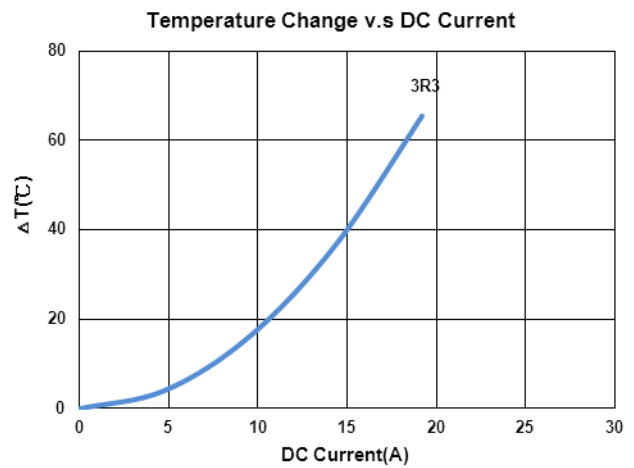
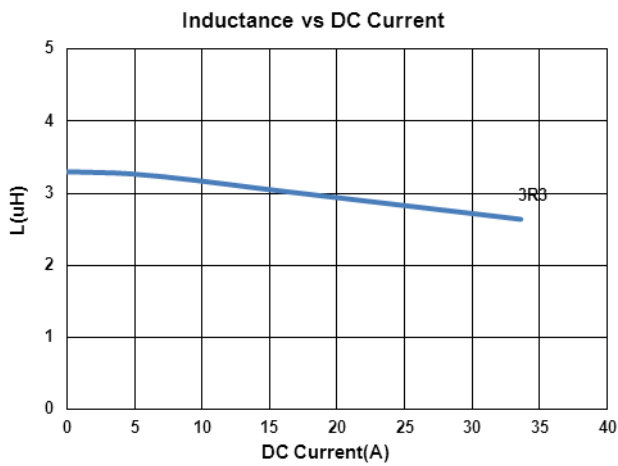

Molding Power Inductors – BMMI Series

Electrical Characteristics

| Part Number | Inductance (uH) | Tolerance (±%) | Test Frequency (kHz) | RDC(mΩ) Max(Typ.) | Isat(A) Max(Typ.) | Irms(A) Max(Typ.) | Marking |
|--------------------|-----------------|----------------|----------------------|-------------------|-------------------|-------------------|---------|
| BMMI001313653R3MX1 | 3.3 | 20 | 100 | 4.4(3.75) | 40(42) | 20(22) | 3R3 |

Note: When ordering, please specify tolerance code. Tolerance: M=±20%

- Operating temperature range - 55°C ~ 125°C(Including self - temperature rise)
- Isat for Inductance drop 30% from its value without current
- I rms for a 40°C temperature rise from 25°C ambient with current
- Measure Equipment :
 L : WK 3260B or WK 6500P, 100kHz 0.25V
 RDC : CHEN HWA 502 or CHEN HWA 46502B
 I rms : CHROMA 1810

Test Instruments : WK3260B Impedance / Material Analyzer

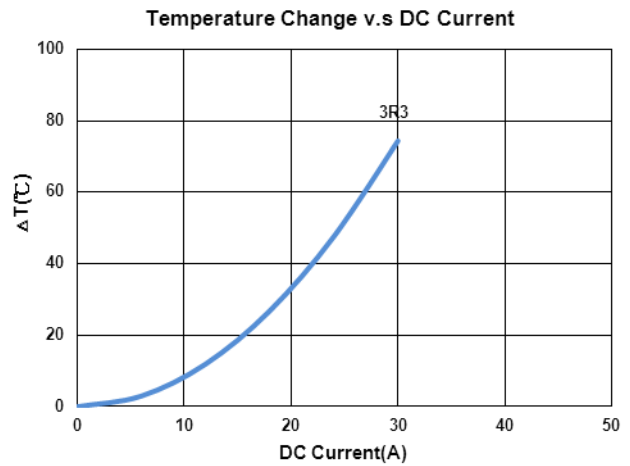
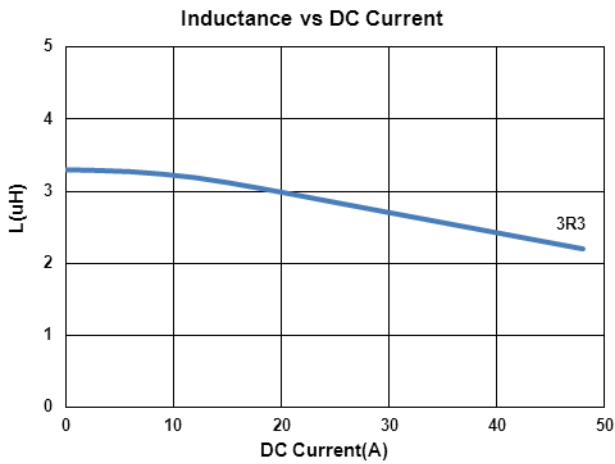

Packaging Specifications

Tape Dimensions

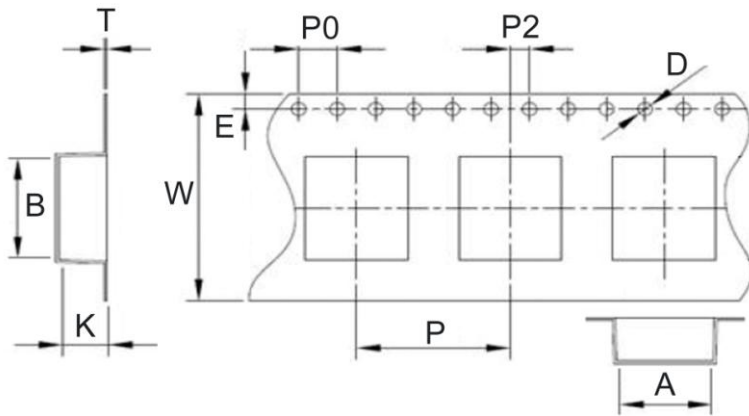

Reel Dimensions

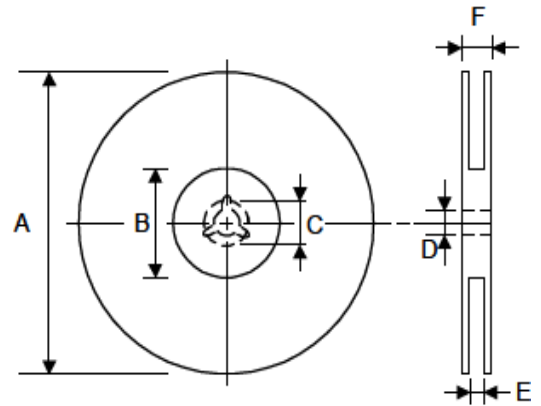

Dimensions in mm

| TYPE | Tape Dimensions | | | | | | | | | | Reel Dimensions | | | | | | Quantity PCS / REEL |
|--------------|-----------------|------|------|------|-----|------|----|----|----|----|-----------------|-----|------|----|------|------|------------------------|
| | A | B | K | T | D | E | W | P | P0 | P2 | A | B | C | D | E | F | |
| BMMI00040412 | 4.5 | 4.9 | 1.7 | 0.35 | 1.5 | 1.75 | 12 | 8 | 4 | 2 | 330 | 100 | 21.5 | 13 | 12.4 | 17.4 | 2000 |
| BMMI00050515 | 5.4 | 5.8 | 1.95 | 0.3 | 1.5 | 1.75 | 12 | 8 | 4 | 2 | 330 | 100 | 21.5 | 13 | 12.4 | 17.4 | 1000 |
| BMMI00060612 | 6.8 | 7.5 | 1.5 | 0.3 | 1.5 | 1.75 | 16 | 12 | 4 | 2 | 330 | 100 | 21.5 | 13 | 16.4 | 21.4 | 2000 |
| BMMI00060630 | 6.9 | 7.6 | 3.4 | 0.35 | 1.5 | 1.75 | 16 | 12 | 4 | 2 | 330 | 100 | 21.5 | 13 | 16.4 | 21.4 | 1000 |
| BMMI00131350 | 13.4 | 14.0 | 5.0 | 0.4 | 1.5 | 1.75 | 24 | 16 | 4 | 2 | 330 | 100 | 21.5 | 13 | 24.2 | 29.2 | 250 |
| BMMI00131365 | 13.4 | 14.1 | 6.8 | 0.4 | 1.5 | 1.75 | 24 | 16 | 4 | 2 | 330 | 100 | 21.5 | 13 | 24.2 | 29.2 | 250 |

X-ON Electronics

Largest Supplier of Electrical and Electronic Components

Click to view similar products for [Fixed Inductors](#) category:

Click to view products by [Chilisin](#) manufacturer:

Other Similar products are found below :

[CR32NP-151KC](#) [CR32NP-180KC](#) [CR32NP-181KC](#) [CR32NP-1R5MC](#) [CR32NP-390KC](#) [CR32NP-3R9MC](#) [CR32NP-680KC](#) [CR32NP-820KC](#) [CR32NP-8R2MC](#) [CR43NP-390KC](#) [CR43NP-560KC](#) [CR43NP-680KC](#) [CR54NP-181KC](#) [CR54NP-470LC](#) [CR54NP-820KC](#) [CR54NP-8R5MC](#) [70F224AI](#) [MGDQ4-00004-P](#) [MHL1ECTTP18NJ](#) [MHQ1005P10NJ](#) [MHQ1005P1N0S](#) [MHQ1005P2N4S](#) [MHQ1005P3N6S](#) [MHQ1005P5N1S](#) [MHQ1005P8N2J](#) [PE-51506NL](#) [PE-53601NL](#) [PE-53602NL](#) [PE-53630NL](#) [PE-53824SNLT](#) [PE-92100NL](#) [PG0434.801NLT](#) [PG0936.113NLT](#) [9220-20](#) [9310-16](#) [PM06-2N7](#) [PM06-39NJ](#) [A01TK](#) [1206CS-471XJ](#) [HC2LP-R47-R](#) [HC2-R47-R](#) [HC3-2R2-R](#) [HCF1305-3R3-R](#) [1206CS-151XG](#) [RCH664NP-140L](#) [RCH664NP-4R7M](#) [RCH8011NP-221L](#) [RCP1317NP-332L](#) [RCP1317NP-391L](#) [RCR1010NP-470M](#)