

- SPECIFICATIONS**
- 1、Current Rating: 1A AC, DC
 - 2、Voltage Rating: 125V AC, DC
 - 3、Temperatuer Range: -25℃~ +85℃
 - 4、Contact Resistance: 20mΩ Max
 - 5、Insulation Resistance: 500mΩ Min
 - 6、Withstanding Voltang: 500V AC/minute
 - 7、Material: Wafer LCP UL94-V0
Pin Brass Tin-plated

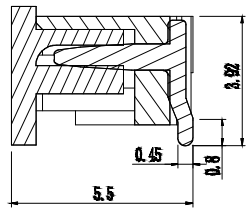

截面 A-A

| Circuit | Part NO. | Dimensions mm | | |
|---------|------------------|---------------|-------|-------|
| | | A | B | C |
| 2 | XD-1.25-2PLT-XX | 1.25 | 7.30 | 3.10 |
| 3 | XD-1.25-3PLT-XX | 2.50 | 8.60 | 4.35 |
| 4 | XD-1.25-4PLT-XX | 3.75 | 9.80 | 5.60 |
| 5 | XD-1.25-5PLT-XX | 5.00 | 11.10 | 6.85 |
| 6 | XD-1.25-6PLT-XX | 6.25 | 12.30 | 8.10 |
| 7 | XD-1.25-7PLT-XX | 7.50 | 13.60 | 9.35 |
| 8 | XD-1.25-8PLT-XX | 8.75 | 14.90 | 10.60 |
| 9 | XD-1.25-9PLT-XX | 10.00 | 16.10 | 11.85 |
| 10 | XD-1.25-10PLT-XX | 11.25 | 17.30 | 13.10 |
| 11 | XD-1.25-11PLT-XX | 12.50 | 18.60 | 14.35 |
| 12 | XD-1.25-12PLT-XX | 13.75 | 19.85 | 15.60 |
| 13 | XD-1.25-13PLT-XX | 15.00 | 21.10 | 16.85 |
| 14 | XD-1.25-14PLT-XX | 16.25 | 22.35 | 18.10 |
| 15 | XD-1.25-15PLT-XX | 17.50 | 23.60 | 19.35 |
| 16 | XD-1.25-16PLT-XX | 18.75 | 24.85 | 20.60 |
| 17 | XD-1.25-17PLT-XX | 20.00 | 26.10 | 21.85 |
| 18 | XD-1.25-18PLT-XX | 21.25 | 27.35 | 23.10 |
| 19 | XD-1.25-19PLT-XX | 22.50 | 28.60 | 24.35 |
| 20 | XD-1.25-20PLT-XX | 23.75 | 29.85 | 25.60 |

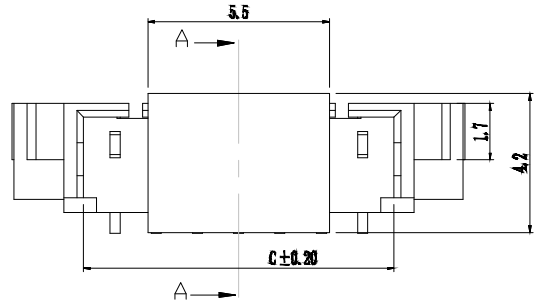
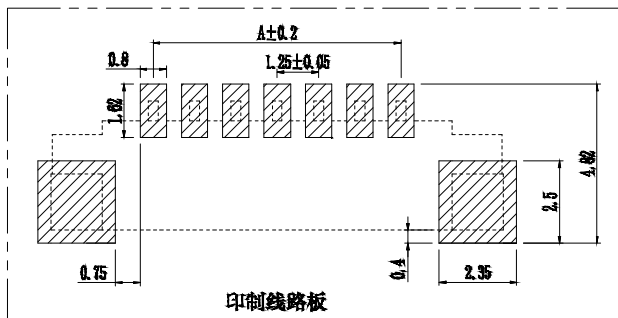
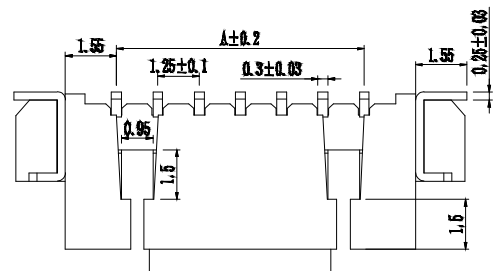

印制线路板

Ordering Information

XD - 1.25 - N *** - **

Pin Type Contact Plating
 插针类型 触点镀层
 AW=镀锡 AW=镀锡 G11/2 Gold
 AW=镀银 AW=镀银 G22/2 Gold
 PLT=镀金 PLT=镀金 G33/2 Gold
 PWT=镀钨 PWT=镀钨 G44/2 Gold
 G55/2 Gold

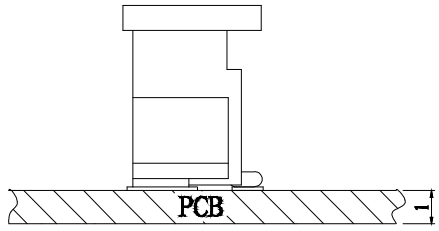

| | | | |
|-------------------|----------------|-------------|------------|
| GENERAL TOLERANCE | | 制图 | 03 |
| DIM TOL | | 审核 | |
| X.X ±0.30 | | 批准 | |
| X.XX ±0.20 | | APPROVAL | |
| X.XXX ±0.10 | | 比例 | |
| Angle ±3.0° | | SCALE | |
| 序号 | 变更内容 | 日期 | 投影 |
| No. | MODIFY CONTENT | MODIFY DATE | Projection |

XD 深圳讯答科技有限公司
 Shenzhen Xunta Technology Co., Ltd

| | | | |
|----------|-----------------|-------|-----|
| 产品名称 | 1.25 单排 立贴 | 版本 | A |
| TITLE | | REV. | |
| 产品料号 | XD-1.25-NPLT-XX | 单位 | mm |
| PART NO. | | UNITS | |
| 材料 | | 页次 | 1/1 |
| MATERIAL | | SHEET | |

X-ON Electronics

Largest Supplier of Electrical and Electronic Components

Click to view similar products for [Headers & Wire Housings](#) category:

Click to view products by [chxunda](#) manufacturer:

Other Similar products are found below :

[0015917161](#) [0022155065](#) [57102-F02-18ULF](#) [58102-G61-06LF](#) [582553-1](#) [01.001.5753.1](#) [0050291907](#) [02.125.8002.8](#) [609-3404](#) [61062-3](#)
[CSU011177004](#) [622-0430](#) [622-3653LF](#) [63453-116](#) [636-1030](#) [636-1427](#) [636-3427](#) [636-4007](#) [641938-9](#) [65495-038](#) [65692-001LF](#) [65781-018](#)
[65781-047](#) [65817-010LF](#) [65817-015LF](#) [67095-007LF](#) [67601157](#) [68631-112](#) [68645-018](#) [699319-000](#) [70.362.1628.0](#) [70-4210](#) [70-4226B](#) [70-](#)
[4853B](#) [71.350.2428.0](#) [733-134](#) [733-162](#) [760-3052](#) [MHR-64-VUAL](#) [80.063.4001.1](#) [800-90-001-10-001000](#) [801-43-002-10-013000](#)
[801-43-006-10-002000](#) [803-43-024-10-001000](#) [803-93-012-10-001000](#) [8-1437020-4](#) [819-22-004-30-001101](#) [820-22-006-30-001101](#)
[820-22-008-30-001101](#) [821-22-002-10-001101](#)