

- SPECIFICATIONS**
- 1、Current Rating: 1A AC, DC
  - 2、Voltage Rating: 125V AC, DC
  - 3、Temperatuer Range: -25°C~ +85°C
  - 4、Contact Resistance: 20mΩ Max
  - 5、Insulation Resistance: 500mΩ Min
  - 6、Withstanding Voltang: 500V AC/minute
  - 7、Material: Wafer LCP UL94-V0  
Pin Brass Tin-plated

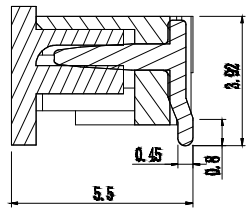

截面 A-A

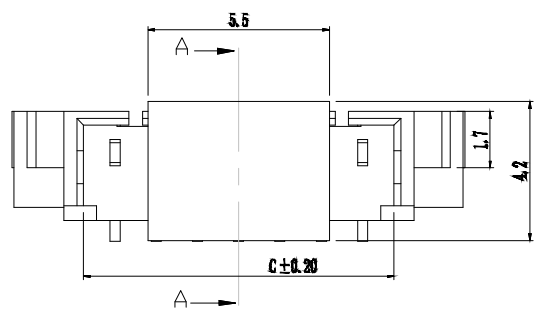
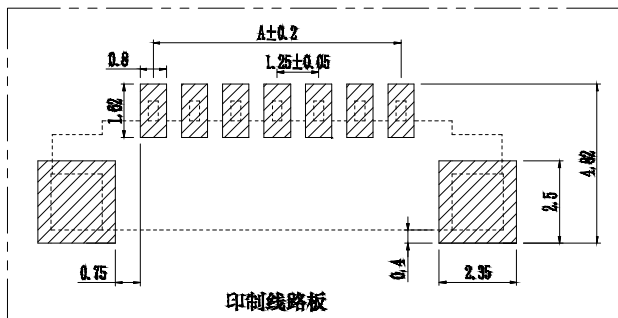
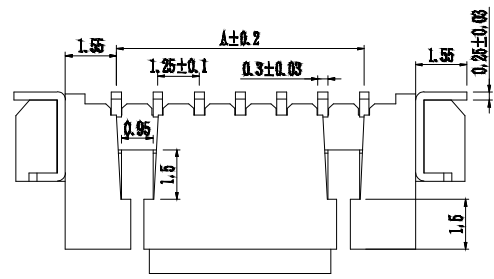

印制线路板

| Circuit | Part NO.         | Dimensions mm |       |       |
|---------|------------------|---------------|-------|-------|
|         |                  | A             | B     | C     |
| 2       | XD-1.25-2PLT-XX  | 1.25          | 7.30  | 3.10  |
| 3       | XD-1.25-3PLT-XX  | 2.50          | 8.60  | 4.35  |
| 4       | XD-1.25-4PLT-XX  | 3.75          | 9.80  | 5.60  |
| 5       | XD-1.25-5PLT-XX  | 5.00          | 11.10 | 6.85  |
| 6       | XD-1.25-6PLT-XX  | 6.25          | 12.30 | 8.10  |
| 7       | XD-1.25-7PLT-XX  | 7.50          | 13.60 | 9.35  |
| 8       | XD-1.25-8PLT-XX  | 8.75          | 14.90 | 10.60 |
| 9       | XD-1.25-9PLT-XX  | 10.00         | 16.10 | 11.85 |
| 10      | XD-1.25-10PLT-XX | 11.25         | 17.30 | 13.10 |
| 11      | XD-1.25-11PLT-XX | 12.50         | 18.60 | 14.35 |
| 12      | XD-1.25-12PLT-XX | 13.75         | 19.85 | 15.60 |
| 13      | XD-1.25-13PLT-XX | 15.00         | 21.10 | 16.85 |
| 14      | XD-1.25-14PLT-XX | 16.25         | 22.35 | 18.10 |
| 15      | XD-1.25-15PLT-XX | 17.50         | 23.60 | 19.35 |
| 16      | XD-1.25-16PLT-XX | 18.75         | 24.85 | 20.60 |
| 17      | XD-1.25-17PLT-XX | 20.00         | 26.10 | 21.85 |
| 18      | XD-1.25-18PLT-XX | 21.25         | 27.35 | 23.10 |
| 19      | XD-1.25-19PLT-XX | 22.50         | 28.60 | 24.35 |
| 20      | XD-1.25-20PLT-XX | 23.75         | 29.85 | 25.60 |

Ordering Information

XD - 1.25 - N \*\*\* - \*\*

Pin Type Contact Plating  
 1.25mm A型插针 Au-镀层 G11/2 Gold  
 1.25mm B型插针 Au-镀层 G22/2 Gold  
 1.25mm C型插针 Au-镀层 G33/2 Gold  
 1.25mm D型插针 Au-镀层 G44/2 Gold  
 1.25mm E型插针 Au-镀层 G55/2 Gold

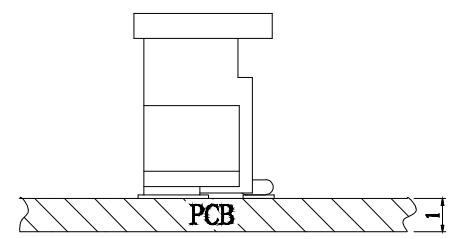

|                   |                     |                |             |
|-------------------|---------------------|----------------|-------------|
| GENERAL TOLERANCE |                     | 制图             | 03          |
| DIM TOL           |                     | 审核             |             |
| X.X ±0.30         |                     | 批准             |             |
| X.XX ±0.20        |                     | APPROVAL       |             |
| X.XXX ±0.10       |                     | 比例             |             |
| Angle ±3.0°       |                     | SCALE          |             |
| 1                 | 初版发行                | 投影             |             |
| 序号 No.            | 变更内容 MODIFY CONTENT | 日期 MODIFY DATE | 材料 MATERIAL |

**XD** 深圳讯答科技有限公司  
 ShenzhenXuntaTechnology Co.,Ltd

|               |                 |          |     |
|---------------|-----------------|----------|-----|
| 产品名称 TITLE    | 1.25 单排 立贴      | 版本 REV.  | A   |
| 产品料号 PART NO. | XD-1.25-NPLT-XX | 单位 UNITS | mm  |
| 材料 MATERIAL   |                 | 页次 SHEET | 1/1 |

## X-ON Electronics

Largest Supplier of Electrical and Electronic Components

*Click to view similar products for [Headers & Wire Housings](#) category:*

*Click to view products by [chxunda](#) manufacturer:*

Other Similar products are found below :

[0015917161](#) [0022155065](#) [57102-F02-18ULF](#) [58102-G61-06LF](#) [582553-1](#) [01.001.5753.1](#) [0050291907](#) [02.125.8002.8](#) [609-3404](#) [61062-3](#)  
[CSU011177004](#) [622-0430](#) [622-3653LF](#) [63453-116](#) [636-1030](#) [636-1427](#) [636-3427](#) [636-4007](#) [641938-9](#) [65495-038](#) [65692-001LF](#) [65781-018](#)  
[65781-047](#) [65817-010LF](#) [65817-015LF](#) [67095-007LF](#) [67601157](#) [68631-112](#) [68645-018](#) [699319-000](#) [70.362.1628.0](#) [70-4210](#) [70-4226B](#) [70-](#)  
[4853B](#) [71.350.2428.0](#) [733-134](#) [733-162](#) [760-3052](#) [MHR-64-VUAL](#) [80.063.4001.1](#) [800-90-001-10-001000](#) [801-43-002-10-013000](#)  
[801-43-006-10-002000](#) [803-43-024-10-001000](#) [803-93-012-10-001000](#) [8-1437020-4](#) [819-22-004-30-001101](#) [820-22-006-30-001101](#)  
[820-22-008-30-001101](#) [821-22-002-10-001101](#)