

2023



深圳市讯答科技有限公司

线对板连接器 产品介绍

线对板连接器 产品目录

- 1 • 间距 PITCH: 0.8mm (5~6页)
0.8单排条形连接器 XD-0.8 系列 (XXXX-SURS-TF)

- 2 • 间距 PITCH: 1.0mm (7~12页)
1.0单排条形连接器 XD-1.0 系列 (XXX-SRSS-TB)
1.0超薄条形连接器 XD-CB1.0 系列
1.0普通带钩条形连接器 XD-G1.0 系列
1.0双排条形连接器 XD-SHD 系列 (XX SHD系列)
1.0双排条形连接器 XD-SHC 系列 (X-SHLDS-G-TF)

- 3 • 间距 PITCH: 1.25mm (13~20页)
1.25单排条形连接器 XD-1.25 系列 (53261/53398)
1.25超薄条形连接器 XD-CB1.25 系列 (53780)
1.25双排条形连接器 XD-A1250 (DF13) 系列 (DF13)
1.25带扣条形连接器 XD-GH 系列 (X-GHS-TB)
1.25双排条形连接器 XD-GHD 系列
1.25空中对接条形连接器 XD-1.25 系列

- 4 • 间距 PITCH: 1.5mm (21~25页)
1.5单排条形连接器 XD-ZH 系列 (XX-ZR-SM4-TFT)
1.5单排条形连接器 XD-ZE 系列 (XX-ZESS-TBT)
1.5单排条形连接器 XD-ZA 系列 (87438/87438)

- 5 • 间距 PITCH: 2.0mm (26~39页)
2.0单排条形连接器 XD-PH 系列 (PH)
2.0双排条形连接器 XD-PHD 系列 (XX-PHDSS)
2.0双排带扣条形连接器 XD-PHB 系列
2.0单排条形连接器 XD-PA 系列
2.0单排条形连接器 XD-PAE 系列 (XX-PA)
2.0单排带扣条形连接器 XD-HY 系列 (YEONHO-20037-HNN)
2.0单排带扣(加高)条形连接器 XD-HYH 系列
2.0双排条形连接器 XD-SPH 系列 (XX-PADSS)
2.0空中对接条形连接器 XD-PH 系列
2.0空中对接条形连接器 XD-HY 系列
2.0杜邦连接器 XD-2008 系列

线对板连接器 产品目录

6 • 间距 PITCH: 2.50mm (40~52页)

2.5单排条形连接器 XD-XH (TJC3) 系列 (XH)

2.5单排条形连接器 XD-XHB 系列

2.5双排条形连接器 XD-XHD 系列 (DF1B)

2.5单排(加高)条形连接器 XD-XHL 系列

2.5单排条形连接器 XD-XA 系列 (XX-XASS)

2.5单排条形连接器 XD-HA 系列

2.5单排条形连接器 XD-5264 系列

2.5双排条形连接器 XD-XAD 系列

2.54双排条形连接器 XD-2510 系列

2.54刺破条形连接器 XD-A2510 系列

7 • 间距 PITCH: 3.00mm (53~55页)

3.00双排条形连接器 XD-MX 系列 (43650)

8 • 间距 PITCH: 3.81mm (56~57页)

3.81单排条形连接器 XD-3.81 系列

9 • 间距 PITCH: 3.96mm (58~63页)

3.96单排条形连接器 XD-3.96 系列 (0965)

3.96单排条形连接器 XD-VH 系列 (VH)

3.96单排(加高)条形连接器 XD-VHL 系列 (BH2P-VH)

3.96单排(加高)条形连接器 XD-VHH

10 • 间距 PITCH: 4.20mm (64~67页)

4.20单、双排条形连接器 XD-5557 系列

4.20双排 防水条形连接器 XD-5557R 系列

11 • 间距 PITCH: 5.00mm (68~70页)

5.00单排条形连接器 XD-5003 系列 (XX-NV)

5.00单排条形连接器 XD-C2 系列

线对板连接器 产品目录

12 · 间距 PITCH: 5.08mm (71~76页)

- 5.08单排条形连接器 XD-5.08 系列
- 5.08单排条形连接器 XD-C5080 系列
- 5.08单排条形连接器 XD-5083 系列
- 5.08双排条形连接器 XD-5084 系列

13 · 间距 PITCH: 6.20mm (77~79页)

- 6.20单、双排条形连接器 XD-C6200 系列 (XX-VL)

14 · 间距 PITCH: 6.35mm (80~82页)

- 6.35单排条形连接器 XD-C6350 系列

15 · 间距 PITCH: 8.00mm (83~84页)

- 8.00单排条形连接器 XD-8001 系列

16 · 间距 PITCH: 10.16mm (85~88页)

- 10.16单排条形连接器 XD-10.16 系列
- 10.16双排条形连接器 XD-10.16 系列

0.8mm 系列

1

• 间距 PITCH: 0.8mm (5~6页)

0.8单排条形连接器 XD-0.8 系列

主要技术特征 MAIN SPECIFICATIONS

间距 Pitch: 0.8mm
 线数 Poles: 2~16
 适用线规 APPLICable Wire: AWG#32- #36
 适用基板厚度 APPLICable PC board thickness: 0.6~1.2mm
 温度范围 Temperatuer Range: -25°C~ +85°C
 额定电压 Voltage Rating: 30V AC, DC
 额定电流 Current Rating: 0.5A AC, DC
 接触电阻 Contract Resistance: 30mΩ Max
 绝缘电阻 Insulation Resistance: 100mΩ Min
 耐压 Withstanding Voltang: 200V

材料 MATERIAL

端子 Terminal: Phosphor bronz
 孔座 Housing: PA46 UL94V-0
 针座 Wafer: LCP UL94V-0

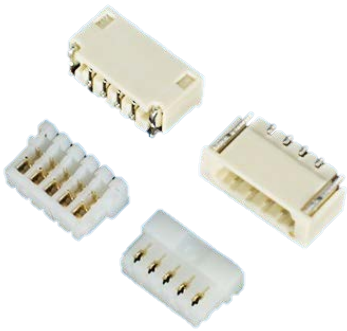

XD-0.8 系列

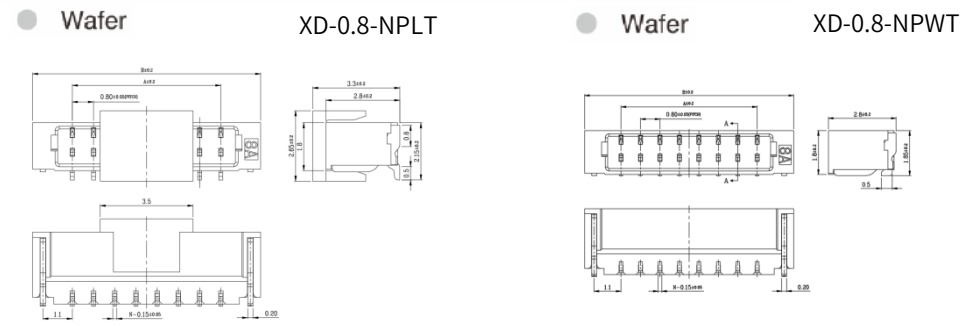
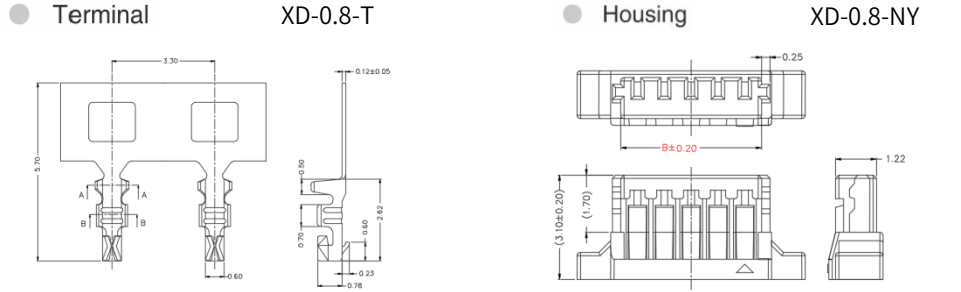

● Housing

| 型号Type- | 尺寸(mm). | | |
|-------------|---------|-------|-------|
| | A. | B. | C. |
| XD-0.8-2Y. | 0.20 | 1.80 | 4.40 |
| XD-0.8-3Y. | 1.40 | 2.60 | 5.20 |
| XD-0.8-4Y. | 2.40 | 3.40 | 6.00 |
| XD-0.8-5Y. | 3.20 | 4.20 | 6.80 |
| XD-0.8-6Y. | 4.00 | 5.00 | 7.60 |
| XD-0.8-7Y. | 4.50 | 5.50 | 8.40 |
| XD-0.8-8Y. | 5.00 | 6.00 | 9.20 |
| XD-0.8-9Y. | 6.40 | 7.40 | 10.00 |
| XD-0.8-10Y. | 7.20 | 8.20 | 10.80 |
| XD-0.8-11Y. | 8.00 | 9.00 | 11.60 |
| XD-0.8-12Y. | 8.80 | 9.80 | 12.40 |
| XD-0.8-13Y. | 9.60 | 10.60 | 13.20 |
| XD-0.8-14Y. | 10.40 | 11.40 | 14.00 |
| XD-0.8-15Y. | 11.20 | 12.20 | 14.80 |
| XD-0.8-16Y. | 12.00 | 13.00 | 15.60 |

● Wafer

| 型号Type- | 尺寸(mm). | | |
|--------------------|---------|-------|-------|
| | A. | B. | C. |
| XD-0.8-2P/LT/PWT. | 0.80 | 3.80 | 3.80 |
| XD-0.8-3P/LT/PWT. | 1.60 | 4.60 | 4.60 |
| XD-0.8-4P/LT/PWT. | 2.40 | 5.40 | 5.40 |
| XD-0.8-5P/LT/PWT. | 3.20 | 6.20 | 6.20 |
| XD-0.8-6P/LT/PWT. | 4.00 | 7.00 | 7.00 |
| XD-0.8-7P/LT/PWT. | 4.80 | 7.80 | 7.80 |
| XD-0.8-8P/LT/PWT. | 5.60 | 8.60 | 8.60 |
| XD-0.8-9P/LT/PWT. | 6.40 | 9.40 | 9.40 |
| XD-0.8-10P/LT/PWT. | 7.20 | 10.20 | 10.20 |
| XD-0.8-11P/LT/PWT. | 8.00 | 11.00 | 11.00 |
| XD-0.8-12P/LT/PWT. | 8.80 | 11.80 | 11.80 |
| XD-0.8-13P/LT/PWT. | 9.60 | 12.60 | 12.60 |
| XD-0.8-14P/LT/PWT. | 10.40 | 13.40 | 13.40 |
| XD-0.8-15P/LT/PWT. | 11.20 | 14.20 | 14.20 |
| XD-0.8-16P/LT/PWT. | 12.00 | 15.00 | 15.00 |

1.0mm 系列

2

- 间距 PITCH: 1.0mm (7~12页)

- 1.0单排条形连接器 XD-1.0 系列

- 1.0超薄条形连接器 XD-CB1.0 系列

- 1.0普通带钩条形连接器 XD-G1.0 系列

- 1.0双排条形连接器 XD-SHD 系列

- 1.0双排条形连接器 XD-SHC 系列

主要技术特征 MAIN SPECIFICATIONS

间距 Pitch: 1.0mm

线数 Poles: 2~16

适用线规 APPLICable Wire: AWG#28- #32

适用基板厚度 APPLICable PC board thickness: 0.6~1.2mm

温度范围 Temperatuer Range: -25°C~ +85°C

额定电压 Voltage Rating: 125V AC, DC

额定电流 Current Rating: 1A AC, DC

接触电阻 Contract Resistance: 20mΩ Max

绝缘电阻 Insulation Resistance: 100mΩ Min

耐压 Withstanding Voltang: 500V

XD-1.0 系列

● Terminal

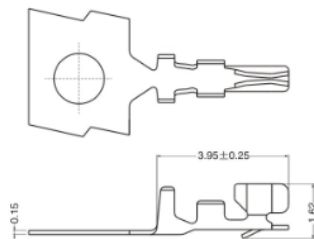

1.0-T

● Housing

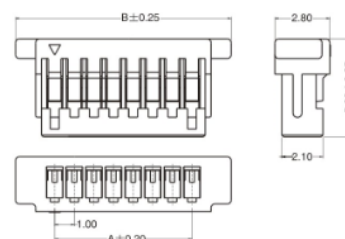

1.0-Y

● Wafer

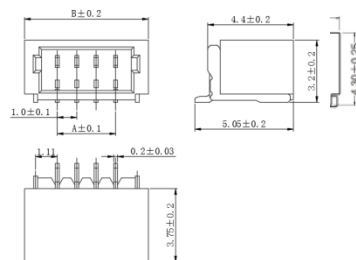

1.0(卧贴)

● Wafer

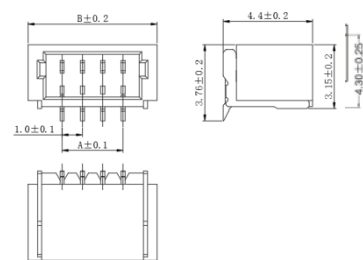

1.0(立贴)

材料 MATERIAL

端子 Terminal: Phosphor bronz

孔座 Housing: PBT UL94V-0

针座 Wafer: LCP UL94V-0

● Housing

| 型号Type ^① | 尺寸(mm) ^② | |
|-------------------------|---------------------|--------------------|
| | A ^③ | B ^④ |
| XD-1.0-2Y ^⑤ | 1.00 ^⑥ | 5.00 ^⑦ |
| XD-1.0-3Y ^⑤ | 2.00 ^⑥ | 6.00 ^⑦ |
| XD-1.0-4Y ^⑤ | 3.00 ^⑥ | 7.00 ^⑦ |
| XD-1.0-5Y ^⑤ | 4.00 ^⑥ | 8.00 ^⑦ |
| XD-1.0-6Y ^⑤ | 5.00 ^⑥ | 9.00 ^⑦ |
| XD-1.0-7Y ^⑤ | 6.00 ^⑥ | 10.00 ^⑦ |
| XD-1.0-8Y ^⑤ | 7.00 ^⑥ | 11.00 ^⑦ |
| XD-1.0-16Y ^⑤ | 15.00 ^⑥ | 19.00 ^⑦ |

● Wafer

| 型号Type ^① | 尺寸(mm) ^② | |
|------------------------------|---------------------|--------------------|
| | A ^③ | B ^④ |
| XD-1.0-2PWT/LT ^⑤ | 1.00 ^⑥ | 4.30 ^⑦ |
| XD-1.0-3PWT/LT ^⑤ | 2.00 ^⑥ | 5.30 ^⑦ |
| XD-1.0-4PWT/LT ^⑤ | 3.00 ^⑥ | 6.30 ^⑦ |
| XD-1.0-5PWT/LT ^⑤ | 4.00 ^⑥ | 7.30 ^⑦ |
| XD-1.0-6PWT/LT ^⑤ | 5.00 ^⑥ | 8.30 ^⑦ |
| XD-1.0-7PWT/LT ^⑤ | 6.00 ^⑥ | 9.30 ^⑦ |
| XD-1.0-8PWT/LT ^⑤ | 7.00 ^⑥ | 10.30 ^⑦ |
| XD-1.0-16PWT/LT ^⑤ | 15.00 ^⑥ | 18.30 ^⑦ |

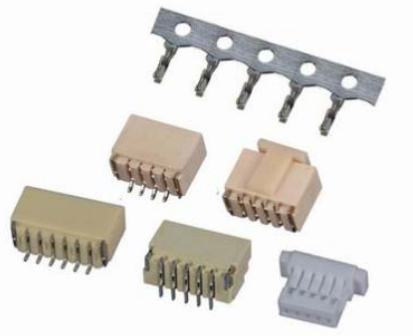

主要技术特征 MAIN SPECIFICATIONS

间距 Pitch: 1.0mm

线数 Poles: 2~20

适用线规 APPLICable Wire: AWG#28- #32

适用基板厚度 APPLICable PC board thickness: 0.6~1.2mm

温度范围 Temperatuer Range: -25°C~ +85°C

额定电压 Voltage Rating: 50V AC, DC

额定电流 Current Rating: 1A AC, DC

接触电阻 Contact Resistance: 20mΩ Max

绝缘电阻 Insulation Resistance: 100mΩ Min

耐压 Withstanding Voltang: 500V

XD-CB1.0 超薄系列

Terminal

XD-CB1.0-T

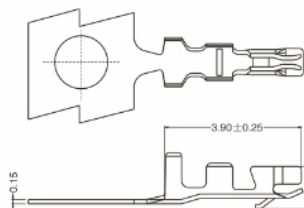

Housing

XD-CB1.0-NY

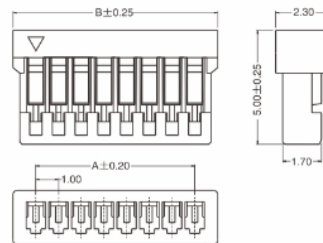

Wafer

XD-CB1.0-NPWT (卧贴)

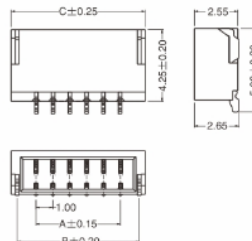

材料 MATERIAL

端子 Terminal: Phosphor bronz

孔座 Housing: PA66 UL94V-0

针座 Wafer: PA6T UL94V-0

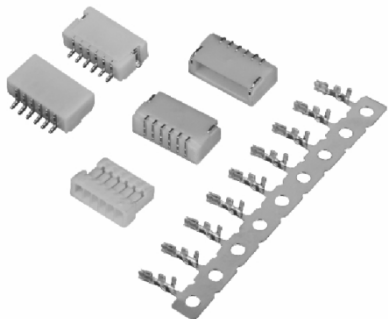

Housing

| 型号Type | 尺寸(mm) | | |
|----------------|--------|-------|-------|
| | A | B | C |
| XD-CB1.0-2PWT | 1.00 | 3.20 | 4.00 |
| XD-CB1.0-3PWT | 2.00 | 4.20 | 5.00 |
| XD-CB1.0-4PWT | 3.00 | 5.20 | 6.00 |
| XD-CB1.0-5PWT | 4.00 | 6.20 | 7.00 |
| XD-CB1.0-6PWT | 5.00 | 7.20 | 8.00 |
| XD-CB1.0-7PWT | 6.00 | 8.20 | 9.00 |
| XD-CB1.0-8PWT | 7.00 | 9.20 | 10.00 |
| XD-CB1.0-20PWT | 19.00 | 21.20 | 22.00 |

Wafer

| 型号Type | 尺寸(mm) | |
|--------------|--------|-------|
| | A | B |
| XD-CB1.0-2Y | 1.00 | 3.00 |
| XD-CB1.0-3Y | 2.00 | 4.00 |
| XD-CB1.0-4Y | 3.00 | 5.00 |
| XD-CB1.0-5Y | 4.00 | 6.00 |
| XD-CB1.0-6Y | 5.00 | 7.00 |
| XD-CB1.0-7Y | 6.00 | 8.00 |
| XD-CB1.0-8Y | 7.00 | 9.00 |
| XD-CB1.0-20Y | 19.00 | 21.00 |

主要技术特征 MAIN SPECIFICATIONS

间距 Pitch: 1.0mm

线数 Poles: 2~20

适用线规 APPLICable Wire: AWG#28- #32

适用基板厚度 APPLICable PC board thickness: 0.6~1.2mm

温度范围 Temperatuer Range: -25°C~ +85°C

额定电压 Voltage Rating: 50V AC, DC

额定电流 Current Rating: 1A AC, DC

接触电阻 Contract Resistance: 20mΩ Max

绝缘电阻 Insulation Resistance: 100mΩ Min

耐压 Withstanding Voltang: 500V

XD-G1.0 带钩系列

Terminal

G1.0带钩-T

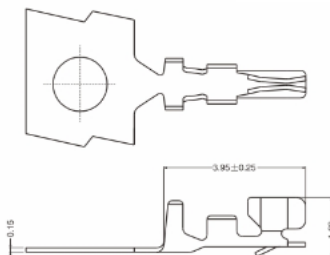

Housing

G1.0带钩-Y

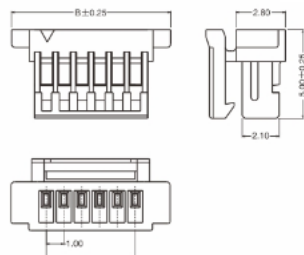

Wafer

G1.0带钩-PWT(卧贴)

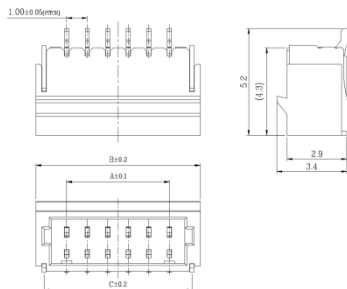

G1.0带钩-PLT(立贴)

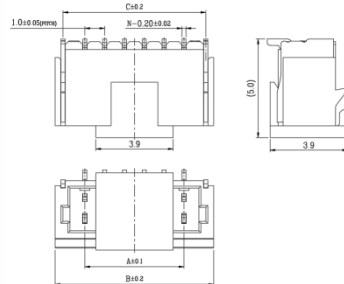

材料 MATERIAL

端子 Terminal: Phosphor bronz

孔座 Housing: PA66 UL94V-0

针座 Wafer: LCP UL94V-0



Housing

| 型号Type | 尺寸(mm) | |
|-------------|--------|-------|
| | A | B |
| XD-G1.0-2Y | 1.00 | 5.00 |
| XD-G1.0-3Y | 2.00 | 6.00 |
| XD-G1.0-4Y | 3.00 | 7.00 |
| XD-G1.0-5Y | 4.00 | 8.00 |
| XD-G1.0-6Y | 5.00 | 9.00 |
| XD-G1.0-20Y | 19.00 | 23.00 |

Wafer

| 型号Type | 尺寸(mm) | | |
|------------------|--------|-------|-------|
| | A | B | C |
| XD-G1.0-2PWT/LT | 1.00 | 4.00 | 3.20 |
| XD-G1.0-3PWT/LT | 2.00 | 5.00 | 4.20 |
| XD-G1.0-4PWT/LT | 3.00 | 6.00 | 5.20 |
| XD-G1.0-5PWT/LT | 4.00 | 7.00 | 6.20 |
| XD-G1.0-6PWT/LT | 5.00 | 8.00 | 7.20 |
| XD-G1.0-20PWT/LT | 19.00 | 22.00 | 21.20 |

主要技术特征 MAIN SPECIFICATIONS

间距 Pitch: 1.0mm

线数 Poles: 4~50

适用线规 APPLICable Wire: AWG#28

适用基板厚度 APPLICable PC board thickness: 0.6~1.2mm

温度范围 Temperatuer Range: -25°C~ +85°C

额定电压 Voltage Rating: 50V AC, DC

额定电流 Current Rating: 1A AC, DC

接触电阻 Contact Resistance: 20mΩ Max

绝缘电阻 Insulation Resistance: 100mΩ Min

耐压 Withstanding Voltang: 500V

XD-SHD1.0 双排系列

● Wafer

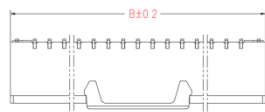

SHD-PLT(立贴)

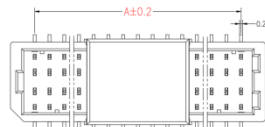
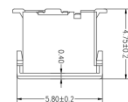

● Wafer

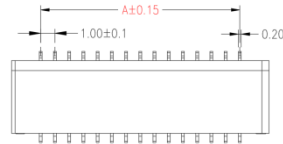

SHD-PWT(卧贴)

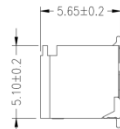

● Wafer

| 型号Type. | 尺寸(mm). | |
|----------------------|---------|--------|
| | A. | B. |
| XD-SHD-2x2PLT-G-04. | 1.00. | 4.30. |
| XD-SHD-2x3PLT-G-04. | 2.00. | 5.30. |
| XD-SHD-2x4PLT-G-04. | 3.00. | 6.30. |
| XD-SHD-2x5PLT-G-04. | 4.00. | 7.30. |
| XD-SHD-2x6PLT-G-04. | 5.00. | 8.30. |
| XD-SHD-2x25PLT-G-04. | 24.00. | 27.30. |

● Wafer

| 型号Type. | 尺寸(mm). | |
|----------------------|---------|--------|
| | A. | B. |
| XD-SHD-2x5PWT-G-04. | 4.00. | 8.10. |
| XD-SHD-2x6PWT-G-04. | 5.00. | 9.10. |
| XD-SHD-2x7PWT-G-04. | 6.00. | 10.10. |
| XD-SHD-2x8PWT-G-04. | 7.00. | 12.10. |
| XD-SHD-2x9PWT-G-04. | 8.00. | 13.10. |
| XD-SHD-2x25PWT-G-04. | 24.00. | 28.10. |

材料 MATERIAL

针座 Wafer: LCP UL94V-0

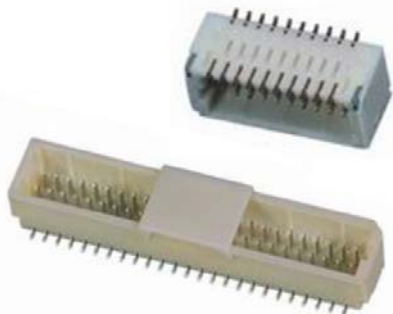

主要技术特征 MAIN SPECIFICATIONS

间距 Pitch: 1.0mm

线数 Poles: 4~50

适用线规 APPLICable Wire: AWG#28- #32

适用基板厚度 APPLICable PC board thickness: 0.6~1.2mm

温度范围 Temperatuer Range: -25°C~ +85°C

额定电压 Voltage Rating: 50V AC, DC

额定电流 Current Rating: 1A AC, DC

接触电阻 Contract Resistance: 30mΩ Max

绝缘电阻 Insulation Resistance: 100mΩ Min

耐压 Withstanding Voltang: 500V

XD-SHC1.0 双排系列

Terminal XD-SHC-T

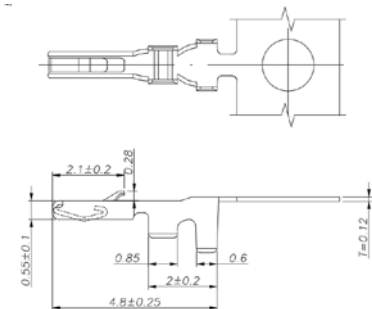

Housing XD-SHC-2xNY

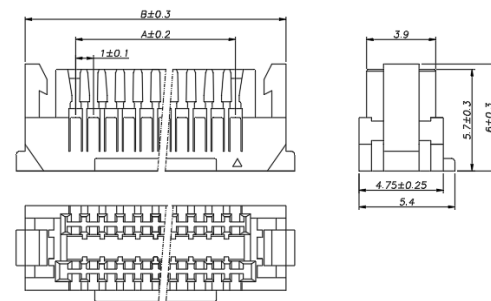

Wafer XD-SHC-2xNPLT(立贴)

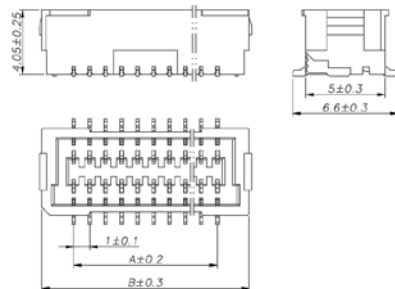

Wafer XD-SHC-2xNPWT(卧贴)

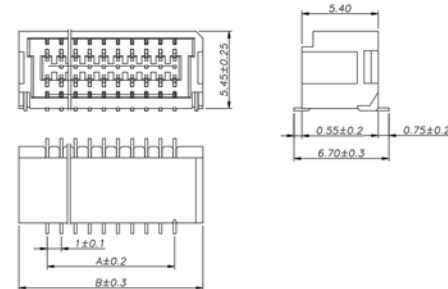

Housing

| 型号Type | 尺寸(mm) | |
|--------------|--------|-------|
| | A | B |
| XD-SHC-2x2Y | 1.00 | 6.70 |
| XD-SHC-2x3Y | 2.00 | 7.70 |
| XD-SHC-2x4Y | 3.00 | 8.70 |
| XD-SHC-2x5Y | 4.00 | 9.70 |
| XD-SHC-2x6Y | 5.00 | 10.70 |
| XD-SHC-2x7Y | 6.00 | 11.70 |
| XD-SHC-2x8Y | 7.00 | 12.70 |
| XD-SHC-2x30Y | 29.00 | 34.70 |

Wafer

| 型号Type | 尺寸(mm) | |
|--------------------|--------|-------------|
| | A | B |
| XD-SHC-2x2PLT/PWT | 1.00 | 5.00/5.50 |
| XD-SHC-2x3PLT/PWT | 2.00 | 6.00/6.50 |
| XD-SHC-2x4PLT/PWT | 3.00 | 7.00/7.50 |
| XD-SHC-2x5PLT/PWT | 4.00 | 8.00/8.50 |
| XD-SHC-2x6PLT/PWT | 5.00 | 9.00/9.50 |
| XD-SHC-2x7PLT/PWT | 6.00 | 10.00/10.50 |
| XD-SHC-2x8PLT/PWT | 7.00 | 11.00/11.50 |
| XD-SHC-2x30PLT/PWT | 29.00 | 33.00/33.50 |

材料 MATERIAL

端子 Terminal: Phosphor bronz

孔座 Housing: PA66 UL94V-0

针座 Wafer: PA66 UL94V-0

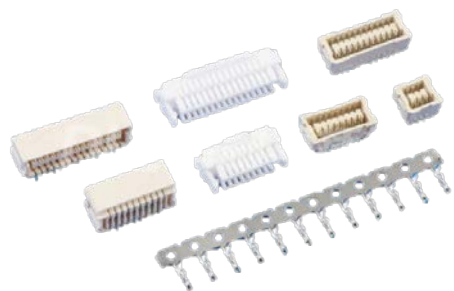

1.25mm 系列

3

- 间距 PITCH: 1.25mm (13~20页)

- 1.25单排条形连接器 XD-1.25 系列

- 1.25超薄条形连接器 XD-CB1.25 系列

- 1.25双排条形连接器 XD-A1250 (DF13) 系列

- 1.25带扣条形连接器 XD-GH1.25 系列

- 1.25空中对接条形连接器 XD-1.25 系列

主要技术特征 MAIN SPECIFICATIONS

间距 Pitch: 1.25mm

线数 Poles: 2~16

适用线规 APPLICable Wire: AWG#28- #32

适用基板厚度 APPLICable PC board thickness: 0.6~1.2mm

温度范围 Temperatuer Range: -25°C~ +85°C

额定电压 Voltage Rating: 125V AC, DC

额定电流 Current Rating: 1A AC, DC

接触电阻 Contract Resistance: 20mΩ Max

绝缘电阻 Insulation Resistance: 100mΩ Min

耐压 Withstanding Voltang: 500V

材料 MATERIAL

端子 Terminal: Phosphor bronz

孔座 Housing: Nylon66 UL94V-0

针座 Wafer: Nylon46 UL94V-0

针座(立/卧贴) Wafer: LCP UL94V-0



XD-1.25 系列 (1)

Terminal

XD-1.25-T

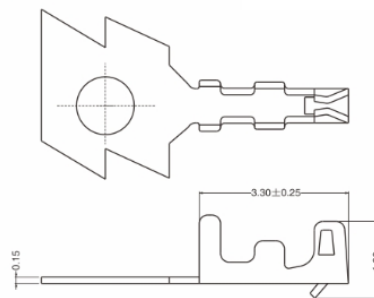

Housing

XD-1.25-NY

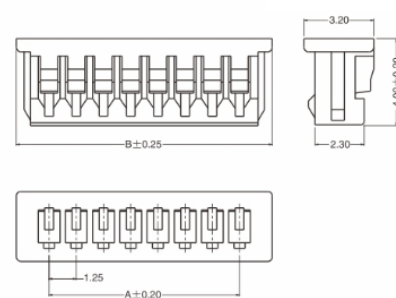

Wafer

XD-1.25-NA

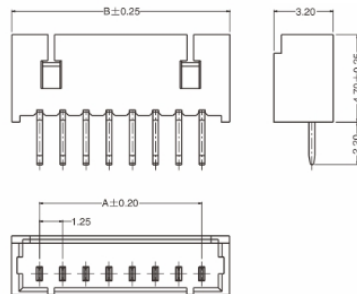

Wafer

XD-1.25-NAW

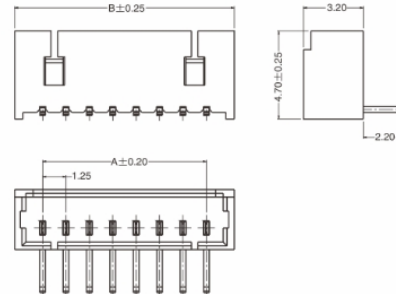

主要技术特征 MAIN SPECIFICATIONS

间距 Pitch: 1.25mm

线数 Poles: 2~16

适用线规 APPLICable Wire: AWG#28- #32

适用基板厚度 APPLICable PC board thickness: 0.6~1.2mm

温度范围 Temperatuer Range: -25°C~ +85°C

额定电压 Voltage Rating: 125V AC, DC

额定电流 Current Rating: 1A AC, DC

接触电阻 Contract Resistance: 20mΩ Max

绝缘电阻 Insulation Resistance: 100mΩ Min

耐压 Withstanding Voltang: 500V

XD-1.25 系列 (2)

● Wafer

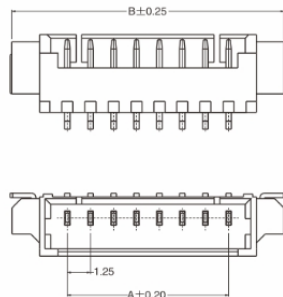

XD-1.25-NPWT

● Wafer

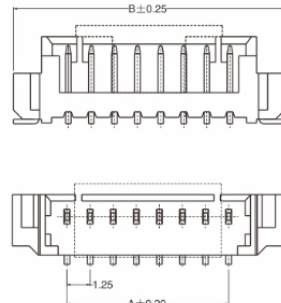

XD-1.25-NPLT

材料 MATERIAL

端子 Terminal: Phosphor bronz

孔座 Housing: Nylon66 UL94V-0

针座 Wafer: Nylon46 UL94V-0

针座(立/卧贴) Wafer: LCP UL94V-0



Housing

| 型号Type | 尺寸(mm) | |
|-------------|--------|-------|
| | A | B |
| XD-1.25-2Y | 1.25 | 4.25 |
| XD-1.25-3Y | 2.50 | 5.50 |
| XD-1.25-4Y | 3.75 | 6.75 |
| XD-1.25-5Y | 5.00 | 8.00 |
| XD-1.25-6Y | 6.25 | 9.25 |
| XD-1.25-7Y | 7.50 | 10.50 |
| XD-1.25-8Y | 8.75 | 11.75 |
| XD-1.25-9Y | 10.00 | 13.00 |
| XD-1.25-10Y | 11.25 | 14.25 |
| XD-1.25-11Y | 12.50 | 15.50 |
| XD-1.25-12Y | 13.75 | 16.75 |
| XD-1.25-13Y | 15.00 | 18.00 |
| XD-1.25-14Y | 16.25 | 19.25 |
| XD-1.25-15Y | 17.50 | 20.50 |
| XD-1.25-20Y | 23.75 | 26.75 |

Wafer

| 型号Type | 尺寸(mm) | |
|----------------|--------|-------|
| | A | B |
| XD-1.25-2A/AW | 1.25 | 4.25 |
| XD-1.25-3A/AW | 2.50 | 5.50 |
| XD-1.25-4A/AW | 3.75 | 6.75 |
| XD-1.25-5A/AW | 5.00 | 8.00 |
| XD-1.25-6A/AW | 6.25 | 9.25 |
| XD-1.25-7A/AW | 7.50 | 10.50 |
| XD-1.25-8A/AW | 8.75 | 11.75 |
| XD-1.25-9A/AW | 10.00 | 13.00 |
| XD-1.25-10A/AW | 11.25 | 14.25 |
| XD-1.25-11A/AW | 12.50 | 15.50 |
| XD-1.25-12A/AW | 13.75 | 16.75 |
| XD-1.25-13A/AW | 15.00 | 18.00 |
| XD-1.25-14A/AW | 16.25 | 19.25 |
| XD-1.25-15A/AW | 17.50 | 20.50 |
| XD-1.25-20A/AW | 23.75 | 26.75 |

Wafer

| 型号Type | 尺寸(mm) | |
|------------------|--------|-------|
| | A | B |
| XD-1.25-2PWT/LT | 1.25 | 7.35 |
| XD-1.25-3PWT/LT | 2.50 | 8.60 |
| XD-1.25-4PWT/LT | 3.75 | 9.85 |
| XD-1.25-5PWT/LT | 5.00 | 11.10 |
| XD-1.25-6PWT/LT | 6.25 | 12.35 |
| XD-1.25-7PWT/LT | 7.50 | 13.60 |
| XD-1.25-8PWT/LT | 8.75 | 14.85 |
| XD-1.25-9PWT/LT | 10.00 | 16.10 |
| XD-1.25-10PWT/LT | 11.25 | 17.35 |
| XD-1.25-11PWT/LT | 12.50 | 18.60 |
| XD-1.25-12PWT/LT | 13.75 | 19.85 |
| XD-1.25-13PWT/LT | 15.00 | 21.10 |
| XD-1.25-14PWT/LT | 16.25 | 22.35 |
| XD-1.25-15PWT/LT | 17.50 | 23.60 |
| XD-1.25-20PWT/LT | 23.75 | 29.85 |

主要技术特征 MAIN SPECIFICATIONS

间距 Pitch: 1.25mm

线数 Poles: 2~30

适用线规 APPLICable Wire: AWG#28- #32

适用基板厚度 APPLICable PC board thickness: 0.6~1.2mm

温度范围 Temperatuer Range: -25°C~ +85°C

额定电压 Voltage Rating: 125V AC, DC

额定电流 Current Rating: 1A AC, DC

接触电阻 Contact Resistance: 20mΩ Max

绝缘电阻 Insulation Resistance: 100mΩ Min

耐压 Withstanding Voltang: 500V

材料 MATERIAL

端子 Terminal: Phosphor bronz

孔座 Housing: PBT UL94V-0

针座 Wafer: Nylon6T UL94V-0



XD-CB1.25 系列

Terminal

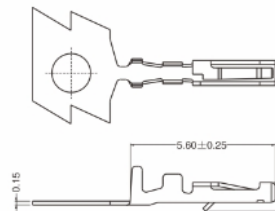

XD-CB1.25-NT

Housing

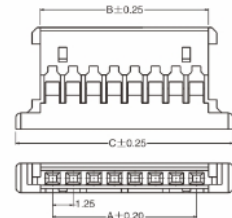

XD-CB1.25-NY



Wafer

XD-CB1.25-NAWT

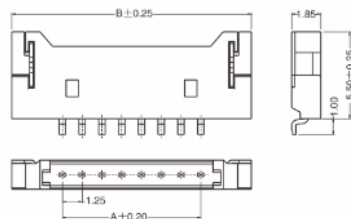

Housing

| 型号 Type ^o | 尺寸 (mm) ^o | | |
|----------------------------|----------------------|--------------------|--------------------|
| | A ^o | B ^o | C ^o |
| XD-CB1.25-2Y ^o | 1.25 ^o | 2.72 ^o | 5.72 ^o |
| XD-CB1.25-3Y ^o | 2.50 ^o | 3.97 ^o | 6.97 ^o |
| XD-CB1.25-4Y ^o | 3.75 ^o | 5.22 ^o | 8.22 ^o |
| XD-CB1.25-5Y ^o | 5.00 ^o | 6.47 ^o | 9.47 ^o |
| XD-CB1.25-6Y ^o | 6.25 ^o | 7.72 ^o | 10.72 ^o |
| XD-CB1.25-7Y ^o | 7.50 ^o | 8.97 ^o | 11.97 ^o |
| XD-CB1.25-8Y ^o | 8.75 ^o | 10.22 ^o | 13.22 ^o |
| XD-CB1.25-30Y ^o | 36.25 ^o | 37.72 ^o | 40.72 ^o |

Wafer

| 型号 Type ^o | 尺寸 (mm) ^o | |
|------------------------------|----------------------|--------------------|
| | A ^o | B ^o |
| XD-CB1.25-2AWT ^o | 1.25 ^o | 7.65 ^o |
| XD-CB1.25-3AWT ^o | 2.50 ^o | 8.90 ^o |
| XD-CB1.25-4AWT ^o | 3.75 ^o | 10.15 ^o |
| XD-CB1.25-5AWT ^o | 5.00 ^o | 11.40 ^o |
| XD-CB1.25-6AWT ^o | 6.25 ^o | 12.65 ^o |
| XD-CB1.25-7AWT ^o | 7.50 ^o | 13.90 ^o |
| XD-CB1.25-8AWT ^o | 8.75 ^o | 15.15 ^o |
| XD-CB1.25-30AWT ^o | 36.25 ^o | 42.65 ^o |

主要技术特征 MAIN SPECIFICATIONS

间距 Pitch: 1.25mm

线数 Poles: 2~40

适用线规 APPLICable Wire: AWG#28- #32

适用基板厚度 APPLICable PC board thickness: 0.6~1.2mm

温度范围 Temperatuer Range: -25°C~ +85°C

额定电压 Voltage Rating: 150V AC, DC

额定电流 Current Rating: 1A AC, DC

接触电阻 Contract Resistance: 20mΩ Max

绝缘电阻 Insulation Resistance: 500mΩ Min

耐压 Withstanding Voltang: 500V

XD-A1250 (DF13)系列

● Terminal

XD-A1250-T

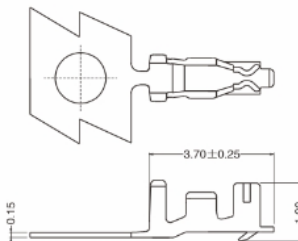

● Housing

XD-A1250-NY

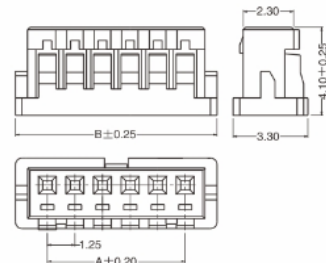

● Housing

XD-A1250-2xNY

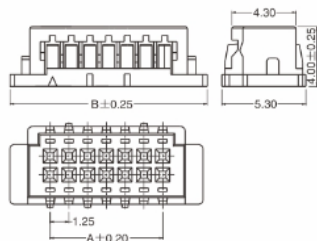

● Wafer

XD-A1250-2xNPLT

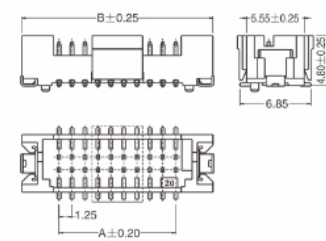

材料 MATERIAL

端子 Terminal: Phosphor bronz

孔座 Housing: Nylon66 UL94V-0

针座 Wafer: Nylon46 UL94V-0

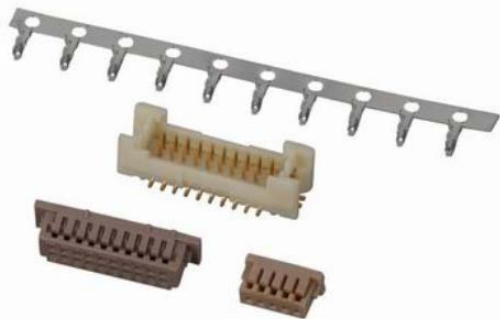

● Housing/Wafer

| 型号Type. | 尺寸(mm). | |
|---------------|---------|--------|
| | A- | B- |
| XD-A1250-2Y. | 1.25. | 4.15. |
| XD-A1250-3Y. | 2.50. | 5.40. |
| XD-A1250-4Y. | 3.75. | 6.65. |
| XD-A1250-5Y. | 5.00. | 7.90. |
| XD-A1250-6Y. | 6.25. | 9.15. |
| XD-A1250-7Y. | 7.50. | 10.40. |
| XD-A1250-8Y. | 8.75. | 11.65. |
| XD-A1250-15Y. | 17.50. | 20.40. |

● Housing

| 型号Type. | 尺寸(mm). | |
|-----------------|---------|--------|
| | A- | B- |
| XD-A1250-2x5Y. | 5.00. | 10.40. |
| XD-A1250-2x7Y. | 7.50. | 12.90. |
| XD-A1250-2x10Y. | 11.25. | 16.65. |
| XD-A1250-2x15Y. | 17.50. | 22.90. |
| XD-A1250-2x20Y. | 23.75. | 29.15. |

● Wafer

| 型号Type. | 尺寸(mm). | |
|-------------------|---------|--------|
| | A- | B- |
| XD-A1250-2x5PLT. | 5.00. | 10.40. |
| XD-A1250-2x7PLT. | 7.50. | 12.90. |
| XD-A1250-2x10PLT. | 11.25. | 16.65. |
| XD-A1250-2x15PLT. | 17.50. | 22.90. |
| XD-A1250-2x20PLT. | 23.75. | 29.15. |

主要技术特征 MAIN SPECIFICATIONS

间距 Pitch: 1.25mm

线数 Poles: 2~15

适用线规 APPLICable Wire: AWG#28- #32

适用基板厚度 APPLICable PC board thickness: 0.6~1.2mm

温度范围 Temperatuer Range: -25°C~ +85°C

额定电压 Voltage Rating: 50V AC, DC

额定电流 Current Rating: 1A AC, DC

接触电阻 Contract Resistance: 20mΩ Max

绝缘电阻 Insulation Resistance: 100mΩ Min

耐压 Withstanding Voltang: 500V

XD-GH 系列

Terminal

XD-GH-T

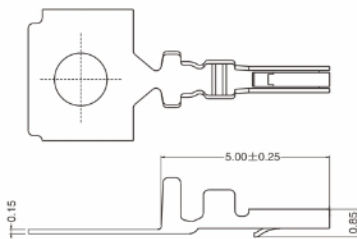

Housing

XD-GH-NY

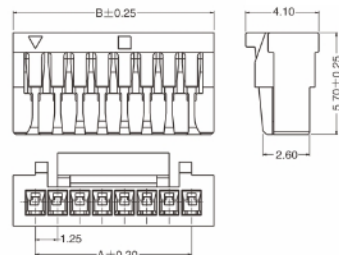

Wafer

XD-GH-NPWT

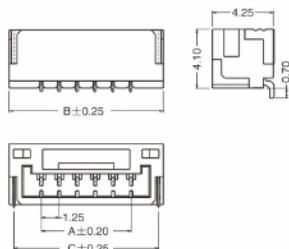

Wafer

XD-GH-NPLT

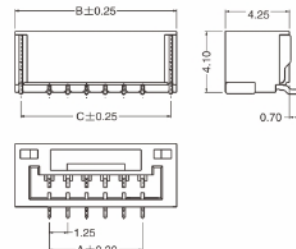

材料 MATERIAL

端子 Terminal: Phosphor bronz

孔座 Housing: PA66 UL94V-0

针座 Wafer: Nylon/LCP UL94V-0

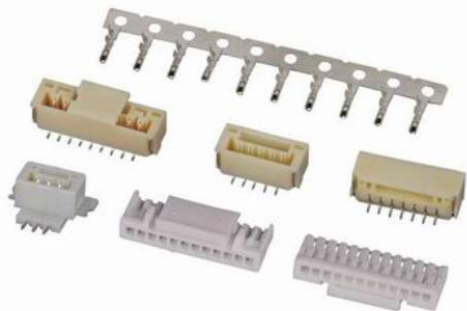

Housing

| 型号 Type | 尺寸 (mm) | |
|-----------|---------|-------|
| | A | B |
| XD-GH-2Y | 1.25 | 3.75 |
| XD-GH-3Y | 2.50 | 5.00 |
| XD-GH-4Y | 3.75 | 6.25 |
| XD-GH-5Y | 5.00 | 7.50 |
| XD-GH-6Y | 6.25 | 8.75 |
| XD-GH-7Y | 7.50 | 10.00 |
| XD-GH-8Y | 8.75 | 11.25 |
| XD-GH-15Y | 17.50 | 20.00 |

Wafer

| 型号 Type | 尺寸 (mm) | | |
|----------------|---------|-------|-------|
| | A | B | C |
| XD-GH-2PWT/LT | 1.25 | 5.75 | 5.00 |
| XD-GH-3PWT/LT | 2.50 | 7.00 | 6.25 |
| XD-GH-4PWT/LT | 3.75 | 8.25 | 7.50 |
| XD-GH-5PWT/LT | 5.00 | 9.50 | 8.75 |
| XD-GH-6PWT/LT | 6.25 | 10.75 | 10.00 |
| XD-GH-7PWT/LT | 7.50 | 12.00 | 11.25 |
| XD-GH-8PWT/LT | 8.75 | 13.25 | 12.50 |
| XD-GH-15PWT/LT | 17.50 | 22.00 | 21.25 |

主要技术特征 MAIN SPECIFICATIONS

间距 Pitch: 1.25mm

线数 Poles: 2~15

适用线规 APPLICable Wire: AWG#26- #30

适用基板厚度 APPLICable PC board thickness: 0.6~1.2mm

温度范围 Temperatuer Range: -25°C~ +85°C

额定电压 Voltage Rating: 50V AC, DC

额定电流 Current Rating: 1.25A AC, DC

接触电阻 Contract Resistance: 50mΩ Max

绝缘电阻 Insulation Resistance: 100mΩ Min

耐压 Withstanding Voltang: 500V

XD-GHD 系列

- Terminal XD-GHD-T

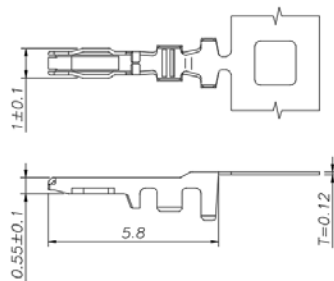

- Housing XD-GHD-2xNY

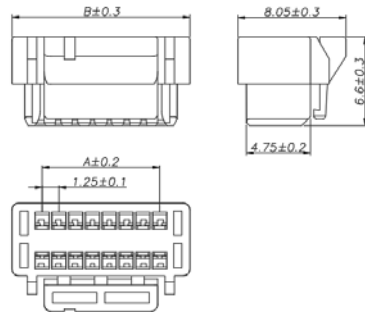

- Wafer XD-GHD-2xNPLT(立贴)

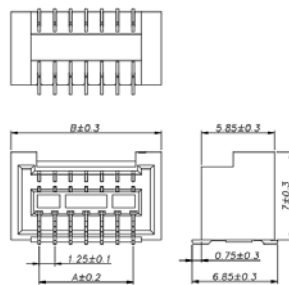

- Wafer XD-GHD-2xNPWT(卧贴)

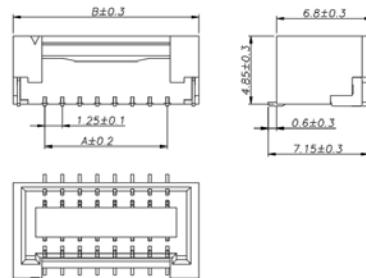

- Housing

| 型号Type. | 尺寸(mm). | |
|--------------------|---------|--------|
| | A. | B. |
| XD-GHD-2x2Y-X-05. | 1.25. | 5.75. |
| XD-GHD-2x3Y-X-05. | 2.50. | 7.00. |
| XD-GHD-2x4Y-X-05. | 3.75. | 8.25. |
| XD-GHD-2x5Y-X-05. | 5.00. | 9.50. |
| XD-GHD-2x20Y-X-05. | 23.75. | 28.25. |

- Wafer

| 型号Type. | 尺寸(mm). | |
|-------------------------|---------|--------|
| | A. | B. |
| XD-GHD-2x2PLT/PWT-X-05. | 1.25. | 5.75. |
| XD-GHD-2x3PLT/PWT-X-05. | 2.50. | 7.00. |
| XD-GHD-2x4PLT/PWT-X-05. | 3.75. | 8.25. |
| XD-GHD-2x5PLT/PWT-X-05. | 5.00. | 9.50. |
| XD-GHD-2x6PLT/PWT-X-05. | 23.75. | 28.25. |

材料 MATERIAL

端子 Terminal: Phosphor bronz

孔座 Housing: Nylon66 UL94V-0

针座 Wafer: LCP UL94V-0

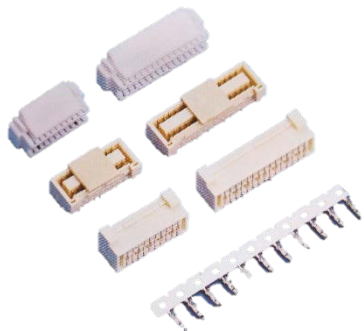

主要技术特征 MAIN SPECIFICATIONS

间距 Pitch: 1.25mm

线数 Poles: 2~15

适用线规 APPLICABLE WIRE: AWG#28- #32

温度范围 Temperature Range: -25°C~ +85°C

额定电压 Voltage Rating: 125V AC, DC

额定电流 Current Rating: 1A AC, DC

接触电阻 Contact Resistance: 20mΩ Max

绝缘电阻 Insulation Resistance: 100mΩ Min

耐压 Withstanding Voltage: 500V

材料 MATERIAL

端子 Terminal: Phosphor bronze

孔座 Housing: PA66 UL94V-0

针座 Wafer: Nylon/LCP UL94V-0



XD-1.25 空中对接系列

Terminal

XD-1.25-PT

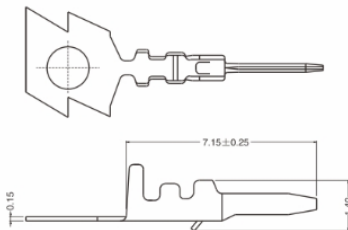

Housing

XD-1.25-EY

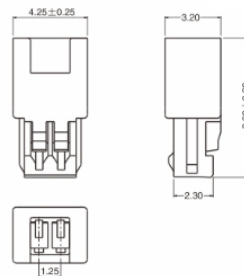

Housing

XD-1.25-SY

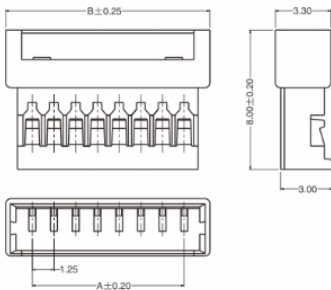

Housing

| 型号Type | 尺寸(mm) | |
|------------------------------|--------------------|--------------------|
| | A _e | B _e |
| XD-1.25-2SY/EY _e | 1.25 _e | 4.25 _e |
| XD-1.25-3SY/EY _e | 2.50 _e | 5.50 _e |
| XD-1.25-4SY/EY _e | 3.75 _e | 6.75 _e |
| XD-1.25-5SY/EY _e | 5.00 _e | 8.00 _e |
| XD-1.25-6SY/EY _e | 6.25 _e | 9.25 _e |
| XD-1.25-7SY/EY _e | 7.50 _e | 10.50 _e |
| XD-1.25-8SY/EY _e | 7.50 _e | 11.75 _e |
| XD-1.25-9SY/EY _e | 8.75 _e | 13.00 _e |
| XD-1.25-10SY/EY _e | 10.00 _e | 14.25 _e |
| XD-1.25-11SY/EY _e | 11.25 _e | 15.50 _e |
| XD-1.25-12SY/EY _e | 12.50 _e | 16.75 _e |
| XD-1.25-15SY/EY _e | 17.50 _e | 20.50 _e |

1.5mm 系列

4

• 间距 PITCH: 1.5mm (21~25页)

1.5单排条形连接器 XD-ZH 系列

1.5单排条形连接器 XD-ZE 系列

1.5单排条形连接器 XD-ZA 系列

主要技术特征 MAIN SPECIFICATIONS

间距 Pitch: 1.5mm

线数 Poles: 2~16

适用线规 APPLICable Wire: AWG#26- #32

适用基板厚度 APPLICable PC board thickness: 0.6~1.2mm

温度范围 Temperatuer Range: -25°C~ +85°C

额定电压 Voltage Rating: 100V AC, DC

额定电流 Current Rating: 1A AC, DC

接触电阻 Contract Resistance: 20mΩ Max

绝缘电阻 Insulation Resistance: 500mΩ Min

耐压 Withstanding Voltang: 500V AC/1分钟 minute

材料 MATERIAL

端子 Terminal: Phosphor bronz

孔座 Housing: Nylon66 UL94V-0

针座 Wafer: Nylon46 UL94V-0

针座(立/卧贴) Wafer: Nylon6T UL94V-0



XD-ZH 系列 (1)

Terminal

XD-ZH-T

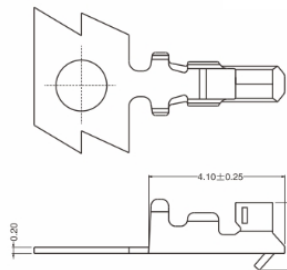

Housing

XD-ZH-NY

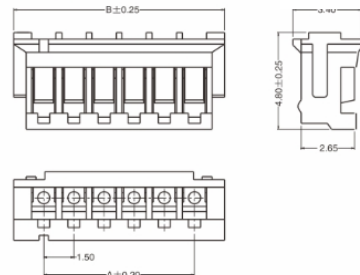

Housing

XD-ZH1.5-NA

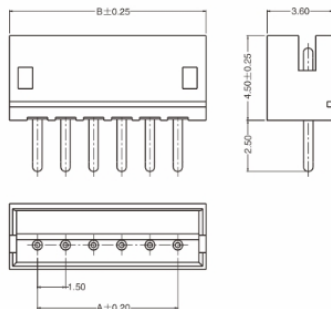

Wafer

XD-ZH1.5-NAWD

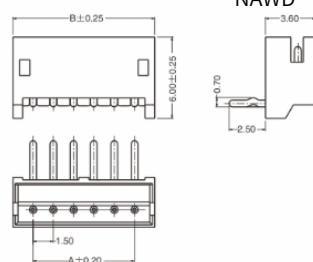

主要技术特征 MAIN SPECIFICATIONS

间距 Pitch: 1.5mm

线数 Poles: 2~16

适用线规 APPLICable Wire: AWG#26- #32

适用基板厚度 APPLICable PC board thickness: 0.6~1.2mm

温度范围 Temperatuer Range: -25°C~ +85°C

额定电压 Voltage Rating: 100V AC, DC

额定电流 Current Rating: 1A AC, DC

接触电阻 Contract Resistance: 20mΩ Max

绝缘电阻 Insulation Resistance: 500mΩ Min

耐压 Withstanding Voltang: 500V AC/1分钟 minute

XD-ZH 系列 (2)

● Wafer

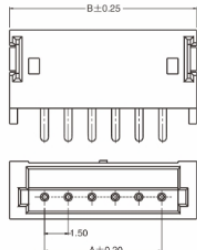

XD-ZH-NAWT

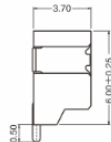

● Wafer

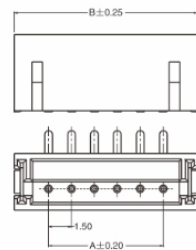

XD-ZH-NPLT

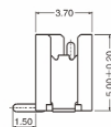

● Housing

● Waf

● Wafer

| 型号Type | 尺寸 (mm) | |
|-----------|---------|-------|
| | A | B |
| XD-ZH-2Y | 1.50 | 4.50 |
| XD-ZH-3Y | 3.00 | 6.00 |
| XD-ZH-4Y | 4.50 | 7.50 |
| XD-ZH-5Y | 6.00 | 9.00 |
| XD-ZH-6Y | 7.50 | 10.50 |
| XD-ZH-7Y | 9.00 | 12.00 |
| XD-ZH-8Y | 10.50 | 13.50 |
| XD-ZH-9Y | 12.00 | 15.00 |
| XD-ZH-10Y | 13.50 | 16.50 |
| XD-ZH-11Y | 15.00 | 18.00 |
| XD-ZH-12Y | 16.50 | 19.50 |
| XD-ZH-13Y | 18.00 | 21.00 |
| XD-ZH-14Y | 19.50 | 22.50 |
| XD-ZH-20Y | 28.50 | 31.50 |

| 型' ype | 尺寸 (mm) | |
|--------------|---------|-------|
| | A | B |
| XD-ZH-2A/AW | 1.50 | 4.50 |
| XD-ZH-3A/AW | 3.00 | 6.00 |
| XD-ZH-4A/AW | 4.50 | 7.50 |
| XD-ZH-5A/AW | 6.00 | 9.00 |
| XD-ZH-6A/AW | 7.50 | 10.50 |
| XD-ZH-7A/AW | 9.00 | 12.00 |
| XD-ZH-8A/AW | 10.50 | 13.50 |
| XD-ZH-9A/AW | 12.00 | 15.00 |
| XD-ZH-10A/AW | 13.50 | 16.50 |
| XD-ZH-11A/AW | 15.00 | 18.00 |
| XD-ZH-12A/AW | 16.50 | 19.50 |
| XD-ZH-13A/AW | 18.00 | 21.00 |
| XD-ZH-14A/AW | 19.50 | 22.50 |
| XD-ZH-20A/AW | 28.50 | 31.50 |

| 型号Type | 尺寸 (mm) | |
|-----------------|---------|-------|
| | A | B |
| XD-ZH-2AWT/PLT | 1.50 | 6.00 |
| XD-ZH-3AWT/PLT | 3.00 | 7.50 |
| XD-ZH-4AWT/PLT | 4.50 | 9.00 |
| XD-ZH-5AWT/PLT | 6.00 | 10.50 |
| XD-ZH-6AWT/PLT | 7.50 | 12.00 |
| XD-ZH-7AWT/PLT | 9.00 | 13.50 |
| XD-ZH-8AWT/PLT | 10.50 | 15.00 |
| XD-ZH-9AWT/PLT | 12.00 | 16.50 |
| XD-ZH-10AWT/PLT | 13.50 | 18.00 |
| XD-ZH-11AWT/PLT | 15.00 | 19.50 |
| XD-ZH-12AWT/PLT | 16.50 | 21.00 |
| XD-ZH-13AWT/PLT | 18.00 | 22.50 |
| XD-ZH-14AWT/PLT | 19.50 | 24.00 |
| XD-ZH-20AWT/PLT | 28.50 | 33.00 |

材料 MATERIAL

端子 Terminal: Phosphor bronz

孔座 Housing: Nylon66 UL94V-0

针座 Wafer: Nylon46 UL94V-0

针座(立/卧贴) Wafer: Nylon6T UL94V-0



主要技术特征 MAIN SPECIFICATIONS

间距 Pitch: 1.5mm

线数 Poles: 2~16

适用线规 APPLICable Wire: AWG#28- #32

适用基板厚度 APPLICable PC board thickness: 0.6~1.6mm

温度范围 Temperatuer Range: -25°C~ +85°C

额定电压 Voltage Rating: 100V AC, DC

额定电流 Current Rating: 2A AC, DC

接触电阻 Contact Resistance: 20mΩ Max

绝缘电阻 Insulation Resistance: 500mΩ Min

耐压 Withstanding Voltang: 500V

XD-ZE 系列

Terminal

XD-ZE-T

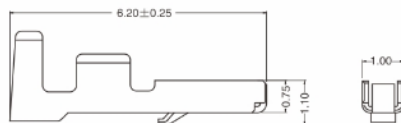

Housing

XD-ZE-NY

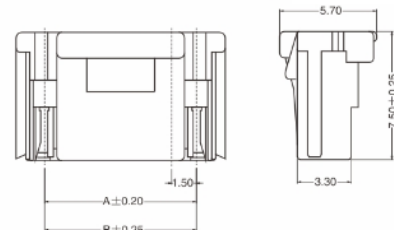

Wafer

XD-ZE-NPWT

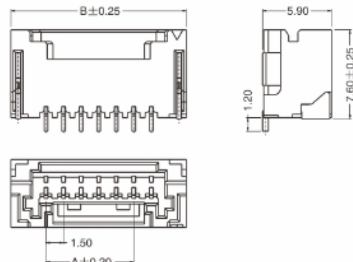

材料 MATERIAL

端子 Terminal: Phosphor bronz

孔座 Housing: Nylon66 UL94V-0

针座 Wafer: Nylon46 UL94V-0

针座(立/卧贴) Wafer: Nylon6T UL94V-0

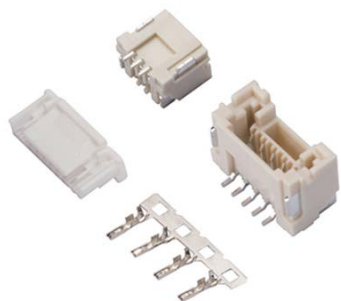

Housing

| 型号Type ^μ | 尺寸(mm) ^μ | |
|------------------------|---------------------|--------------------|
| | A ^μ | R ^μ |
| XD-ZE-2Y ^μ | 1.50 ^μ | 5.00 ^μ |
| XD-ZE-3Y ^μ | 3.00 ^μ | 6.50 ^μ |
| XD-ZE-4Y ^μ | 4.50 ^μ | 8.00 ^μ |
| XD-ZE-5Y ^μ | 6.00 ^μ | 9.50 ^μ |
| XD-ZE-6Y ^μ | 7.50 ^μ | 11.00 ^μ |
| XD-ZE-7Y ^μ | 9.00 ^μ | 12.50 ^μ |
| XD-ZE-8Y ^μ | 10.50 ^μ | 14.00 ^μ |
| XD-ZE-16Y ^μ | 22.50 ^μ | 26.00 ^μ |

Wafer

| 型号Type ^μ | 尺寸(mm) ^μ | |
|--------------------------|---------------------|--------------------|
| | A ^μ | R ^μ |
| XD-ZE-2PWT ^μ | 1.50 ^μ | 7.50 ^μ |
| XD-ZE-3PWT ^μ | 3.00 ^μ | 9.00 ^μ |
| XD-ZE-4PWT ^μ | 4.50 ^μ | 10.50 ^μ |
| XD-ZE-5PWT ^μ | 6.00 ^μ | 12.00 ^μ |
| XD-ZE-6PWT ^μ | 7.50 ^μ | 13.50 ^μ |
| XD-ZE-7PWT ^μ | 9.00 ^μ | 15.00 ^μ |
| XD-ZE-8PWT ^μ | 10.50 ^μ | 16.50 ^μ |
| XD-ZE-16PWT ^μ | 22.50 ^μ | 28.50 ^μ |

主要技术特征 MAIN SPECIFICATIONS

间距 Pitch: 1.5mm

线数 Poles: 2~16

适用线规 APplicable Wire: AWG#28- #32

适用基板厚度 APplicable PC board thickness: 0.6~1.6mm

温度范围 Temperatuer Range: -25°C~ +85°C

额定电压 Voltage Rating: 100V AC, DC

额定电流 Current Rating: 2A AC, DC

接触电阻 Contract Resistance: 20mΩ Max

绝缘电阻 Insulation Resistance: 500mΩ Min

耐压 Withstanding Voltang: 500V

材料 MATERIAL

端子 Terminal: Phosphor bronz

孔座 Housing: Nylon66 UL94V-0

针座 Wafer: Nylon46 UL94V-0

针座(立/卧贴) Wafer: Nylon6T UL94V-0

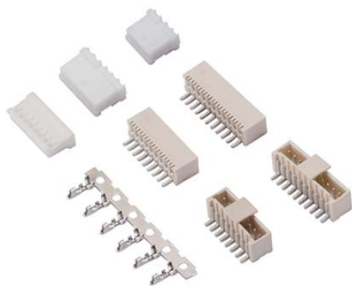

XD-ZA 系列

Terminal

XD-ZA-T

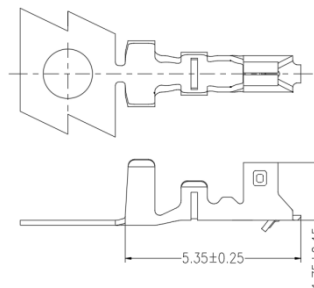

Housing

XD-ZA-NY

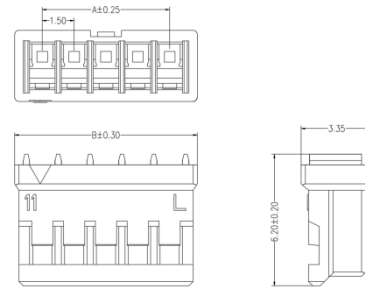

Wafer

XD-ZA-NPLT

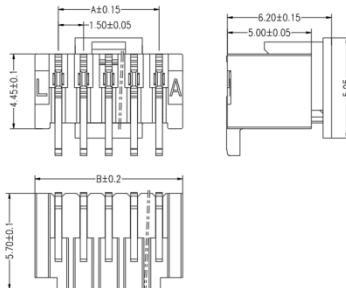

Wafer

XD-ZA-NPWT

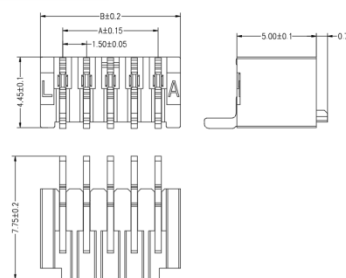

Housing

| 型号Type ₀ | 尺寸(mm) ₀ | |
|---------------------------|---------------------|--------------------|
| | A ₀ | B ₀ |
| XD-ZA-2Y-04 ₀ | 1.50 ₀ | 4.10 ₀ |
| XD-ZA-3Y-04 ₀ | 3.00 ₀ | 5.60 ₀ |
| XD-ZA-4Y-04 ₀ | 4.50 ₀ | 7.10 ₀ |
| XD-ZA-5Y-04 ₀ | 6.00 ₀ | 8.60 ₀ |
| XD-ZA-6Y-04 ₀ | 7.50 ₀ | 10.10 ₀ |
| XD-ZA-7Y-04 ₀ | 9.00 ₀ | 11.60 ₀ |
| XD-ZA-8Y-04 ₀ | 10.50 ₀ | 13.10 ₀ |
| XD-ZA-15Y-04 ₀ | 21.00 ₀ | 23.60 ₀ |

Wafer

| 型号Type ₀ | 尺寸(mm) ₀ | |
|--------------------------------|---------------------|--------------------|
| | A ₀ | B ₀ |
| XD-ZA-2PWT/LT-04 ₀ | 1.50 ₀ | 4.30 ₀ |
| XD-ZA-3PWT/LT-04 ₀ | 3.00 ₀ | 5.80 ₀ |
| XD-ZA-4PWT/LT-04 ₀ | 4.50 ₀ | 7.30 ₀ |
| XD-ZA-5PWT/LT-04 ₀ | 6.00 ₀ | 8.80 ₀ |
| XD-ZA-6PWT/LT-04 ₀ | 7.50 ₀ | 10.30 ₀ |
| XD-ZA-7PWT/LT-04 ₀ | 9.00 ₀ | 11.80 ₀ |
| XD-ZA-8PWT/LT-04 ₀ | 10.50 ₀ | 13.30 ₀ |
| XD-ZA-15PWT/LT-04 ₀ | 21.00 ₀ | 23.80 ₀ |

2.0mm 系列

5

• 间距 PITCH: 2.0mm (26~39页)

2.0单排条形连接器 XD-PH 系列

2.0双排条形连接器 XD-PHD 系列

2.0双排条形连接器 XD-PHB 系列

2.0单排条形连接器 XD-PA 系列

2.0单排条形连接器 XD-PAE 系列

2.0单排条形连接器 XD-HY 系列

2.0单排带扣(加高)条形连接器 XD-HYH 系列

2.0双排条形连接器 XD-SPH 系列

2.0空中对接条形连接器 XD-PH 系列

2.0空中对接条形连接器 XD-HY 系列

2.0杜邦连接器 XD-2008 系列

2.0杜邦连接器 XD-2008 系列

主要技术特征 MAIN SPECIFICATIONS

间距 Pitch: 2.0mm

线数 Poles: 2~16

适用线规 APPLICable Wire: AWG#24- #30

适用基板厚度 APPLICable PC board thickness: 0.8~1.6mm

温度范围 Temperatuer Range: -25°C~ +85°C

额定电压 Voltage Rating: 250V AC, DC

额定电流 Current Rating: 2A AC, DC

接触电阻 Contract Resistance: 20mΩ Max

绝缘电阻 Insulation Resistance: 1000mΩ Min

耐压 Withstanding Voltang: 800V AC/1分钟minute

材料 MATERIAL

端子 Terminal: Phosphor bronz

孔座 Housing: Nylon66 UL94V-0

针座 Wafer: Nylon66 UL94V-0

针座(立/卧贴) Wafer: Nylon6T UL94V-0

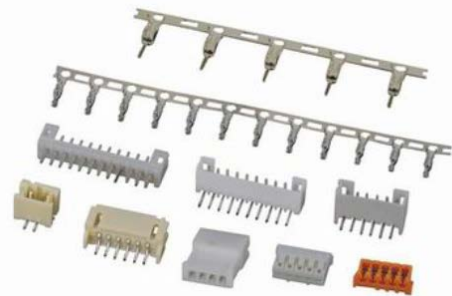

XD-PH 系列 (1)

Terminal XD-PH-T

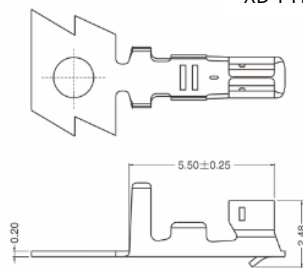

Housing XD-PH-NY

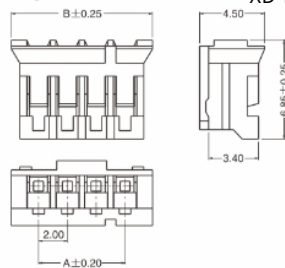

Wafer XD-PH-PY

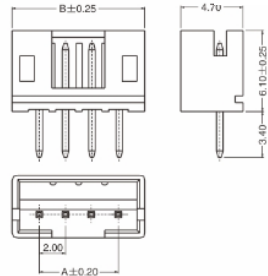

Terminal XD-PH-NA

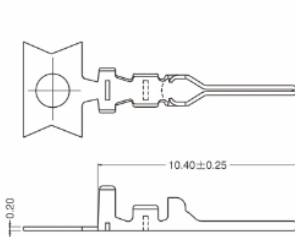

Housing XD-PH-EY

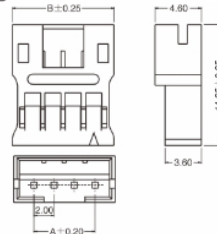

主要技术特征 MAIN SPECIFICATIONS

间距 Pitch: 2.0mm

线数 Poles: 2~16

适用线规 APPLICable Wire: AWG#24- #30

适用基板厚度 APPLICable PC board thickness: 0.8~1.6mm

温度范围 Temperatuer Range: -25°C~ +85°C

额定电压 Voltage Rating: 250V AC, DC

额定电流 Current Rating: 2A AC, DC

接触电阻 Contract Resistance: 20mΩ Max

绝缘电阻 Insulation Resistance: 1000mΩ Min

耐压 Withstanding Voltang: 800V AC/1分钟minute

材料 MATERIAL

端子 Terminal: Phosphor bronz

孔座 Housing: Nylon66 UL94V-0

针座 Wafer: Nylon66 UL94V-0

针座(立/卧贴) Wafer: Nylon6T UL94V-0

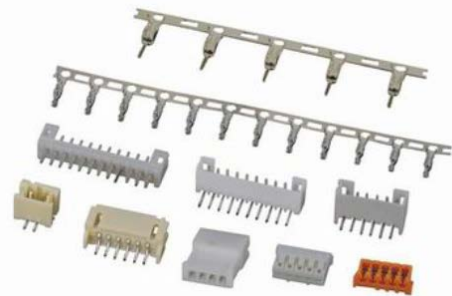

XD-PH 系列 (2)

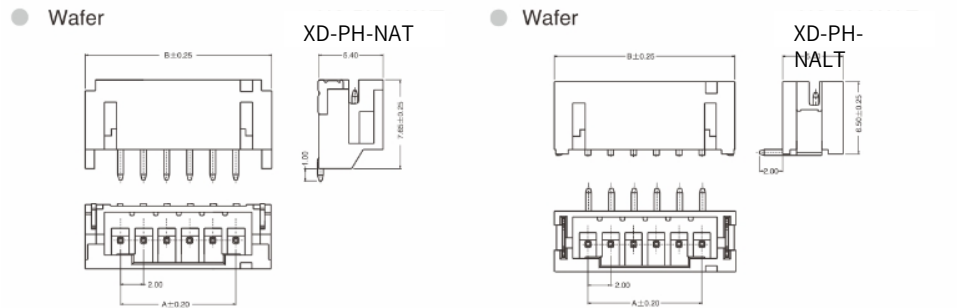
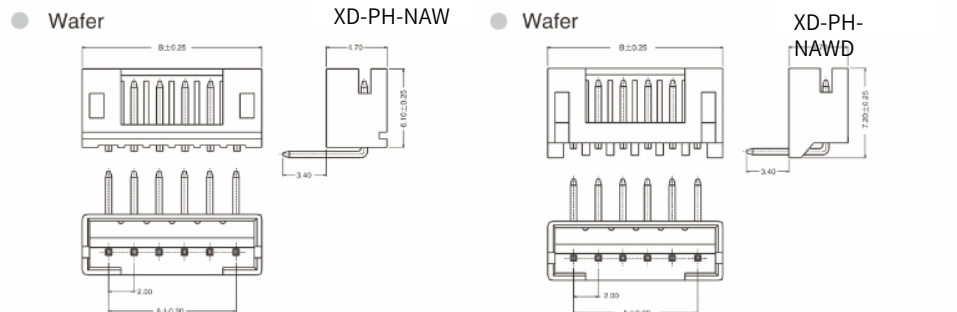

| 型号 Type | 尺寸 (mm) | |
|-----------------|---------|-------|
| | A | B |
| XD-PH-2Y/PY/EY | 2.00 | 6.00 |
| XD-PH-3Y/PY/EY | 4.00 | 8.00 |
| XD-PH-4Y/PY/EY | 6.00 | 10.00 |
| XD-PH-5Y/PY/EY | 8.00 | 12.00 |
| XD-PH-6Y/PY/EY | 10.00 | 14.00 |
| XD-PH-7Y/PY/EY | 12.00 | 16.00 |
| XD-PH-8Y/PY/EY | 14.00 | 18.00 |
| XD-PH-16Y/PY/EY | 30.00 | 34.00 |

| 型号 Type | 尺寸 (mm) | |
|------------------|---------|-------|
| | A | B |
| XD-PH-2A/AW/AWD | 2.00 | 6.00 |
| XD-PH-3A/AW/AWD | 4.00 | 8.00 |
| XD-PH-4A/AW/AWD | 6.00 | 10.00 |
| XD-PH-5A/AW/AWD | 8.00 | 12.00 |
| XD-PH-6A/AW/AWD | 10.00 | 14.00 |
| XD-PH-7A/AW/AWD | 12.00 | 16.00 |
| XD-PH-8A/AW/AWD | 14.00 | 18.00 |
| XD-PH-16A/AW/AWD | 30.00 | 34.00 |

| 型号 Type | 尺寸 (mm) | |
|---------------|---------|-------|
| | A | B |
| XD-PH-2AW/LT | 2.00 | 8.00 |
| XD-PH-3AW/LT | 4.00 | 10.00 |
| XD-PH-4AW/LT | 6.00 | 12.00 |
| XD-PH-5AW/LT | 8.00 | 14.00 |
| XD-PH-6AW/LT | 10.00 | 16.00 |
| XD-PH-7AW/LT | 12.00 | 18.00 |
| XD-PH-8AW/LT | 14.00 | 20.00 |
| XD-PH-16AW/LT | 30.00 | 36.00 |

主要技术特征 MAIN SPECIFICATIONS

间距 Pitch: 2.0mm

线数 Poles: 4~40

适用线规 APPLICable Wire: AWG#22- #28

适用基板厚度 APPLICable PC board thickness: 1.6mm

温度范围 Temperatuer Range: -25°C~ +85°C

额定电压 Voltage Rating: 250V AC, DC

额定电流 Current Rating: 3A AC, DC

接触电阻 Contract Resistance: 20mΩ Max

绝缘电阻 Insulation Resistance: 1000mΩ Min

耐压 Withstanding Voltang: 800V

XD-PHD 系列

● Terminal

XD-PHD-T

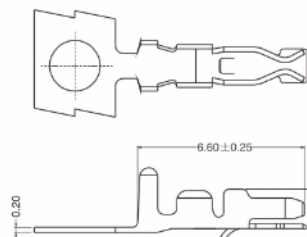

● Housing

I XD-PHD-

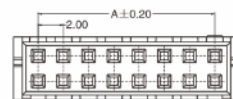
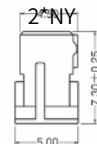
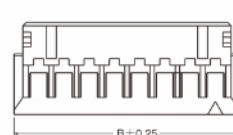

● Housing

XD-PHD-2*NA

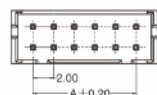
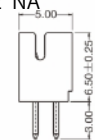
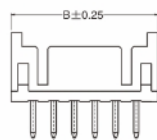

● Wafer

XD-PHD-2*NAW

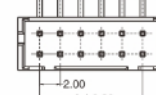
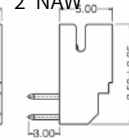
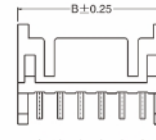

● Wafer

XD-PHDS-2*NY

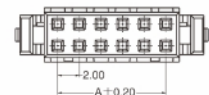
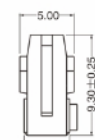
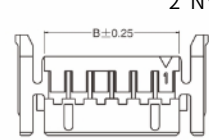

材料 MATERIAL

端子 Terminal: Phosphor bronz

孔座 Housing: Nylon66 UL94V-0

针座 Wafer: Nylon66 UL94V-0



● Housing

| 型号Type | 尺寸(mm) | |
|--------------|--------|-------|
| | A | B |
| XD-PHD-2*2Y | 2.00 | 6.00 |
| XD-PHD-2*3Y | 4.00 | 8.00 |
| XD-PHD-2*4Y | 6.00 | 10.00 |
| XD-PHD-2*5Y | 8.00 | 12.00 |
| XD-PHD-2*6Y | 10.00 | 14.00 |
| XD-PHD-2*7Y | 12.00 | 16.00 |
| XD-PHD-2*8Y | 14.00 | 18.00 |
| XD-PHD-2*20Y | 38.00 | 42.00 |

● Wafer

| 型号Type | 尺寸(mm) | |
|-----------------|--------|-------|
| | A | B |
| XD-PHD-2*2A/AW | 2.00 | 6.00 |
| XD-PHD-2*3A/AW | 4.00 | 8.00 |
| XD-PHD-2*4A/AW | 6.00 | 10.00 |
| XD-PHD-2*5A/AW | 8.00 | 12.00 |
| XD-PHD-2*6A/AW | 10.00 | 14.00 |
| XD-PHD-2*7A/AW | 12.00 | 16.00 |
| XD-PHD-2*8A/AW | 14.00 | 18.00 |
| XD-PHD-2*20A/AW | 38.00 | 42.00 |

主要技术特征 MAIN SPECIFICATIONS

间距 Pitch: 2.0mm

线数 Poles: 10~40

适用线规 APPLICable Wire: AWG#22- #28

适用基板厚度 APPLICable PC board thickness: 1.6mm

温度范围 Temperatuer Range: -25°C~ +85°C

额定电压 Voltage Rating: 250V AC, DC

额定电流 Current Rating: 3A AC, DC

接触电阻 Contract Resistance: 20mΩ Max

绝缘电阻 Insulation Resistance: 1000mΩ Min

耐压 Withstanding Voltang: 800V

XD-PHB 系列

Terminal XD-PHB-T

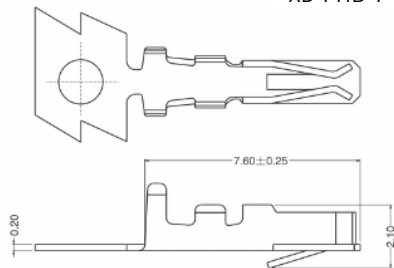

Housing

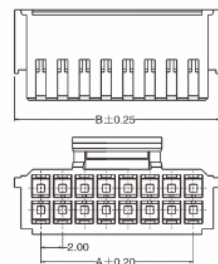

XD-PHB-2*NY.00

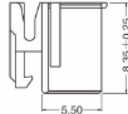

Wafer

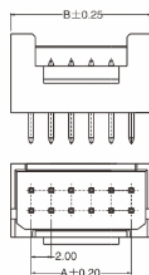

XD-PHB-2*NA

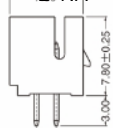

Wafer

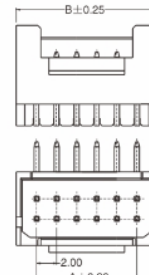

XD-PHB-2*NAW

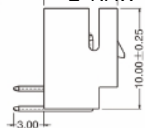

Housing

| 型号Type ^o | 尺寸(mm) ^o | |
|---------------------------|---------------------|--------------------|
| | A ^o | B ^o |
| XD-PHB-2*5Y ^o | 8.00 ^o | 13.00 ^o |
| XD-PHB-2*6Y ^o | 10.00 ^o | 15.00 ^o |
| XD-PHB-2*7Y ^o | 12.00 ^o | 17.00 ^o |
| XD-PHB-2*8Y ^o | 14.00 ^o | 19.00 ^o |
| XD-PHB-2*9Y ^o | 16.00 ^o | 21.00 ^o |
| XD-PHB-2*10Y ^o | 18.00 ^o | 23.00 ^o |
| XD-PHB-2*11Y ^o | 20.00 ^o | 25.00 ^o |
| XD-PHB-2*20Y ^o | 38.00 ^o | 43.00 ^o |

Wafer

| 型号Type ^o | 尺寸(mm) ^o | |
|------------------------------|---------------------|--------------------|
| | A ^o | B ^o |
| XD-PHB-2*5A/AW ^o | 8.00 ^o | 12.00 ^o |
| XD-PHB-2*6A/AW ^o | 10.00 ^o | 14.00 ^o |
| XD-PHB-2*7A/AW ^o | 12.00 ^o | 16.00 ^o |
| XD-PHB-2*8A/AW ^o | 14.00 ^o | 18.00 ^o |
| XD-PHB-2*9A/AW ^o | 16.00 ^o | 20.00 ^o |
| XD-PHB-2*10A/AW ^o | 18.00 ^o | 22.00 ^o |
| XD-PHB-2*11A/AW ^o | 20.00 ^o | 24.00 ^o |
| XD-PHB-2*20A/AW ^o | 38.00 ^o | 42.00 ^o |

材料 MATERIAL

端子 Terminal: Phosphor bronz

孔座 Housing: Nylon66 UL94V-0

针座 Wafer: Nylon66 UL94V-0

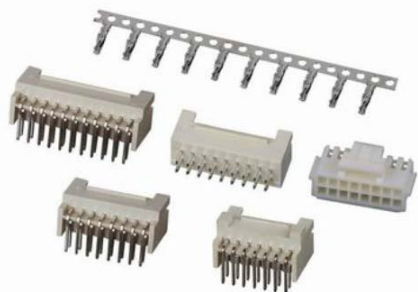

主要技术特征 MAIN SPECIFICATIONS

间距 Pitch: 2.0mm

线数 Poles: 2~16

适用线规 APPLICable Wire: AWG#22- #28

适用基板厚度 APPLICable PC board thickness: 1.6mm

温度范围 Temperatuer Range: -25°C~ +85°C

额定电压 Voltage Rating: 100V AC, DC

额定电流 Current Rating: 3A AC, DC

接触电阻 Contract Resistance: 20mΩ Max

绝缘电阻 Insulation Resistance: 1000mΩ Min

耐压 Withstanding Voltang: 800V

材料 MATERIAL

端子 Terminal: Phosphor bronz

孔座 Housing: Nylon66 UL94V-0

针座 Wafer: PBT UL94V-0



XD-PA 系列

Terminal XD-PA-T

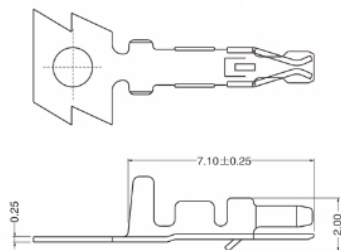

Housing XD-PA-Y

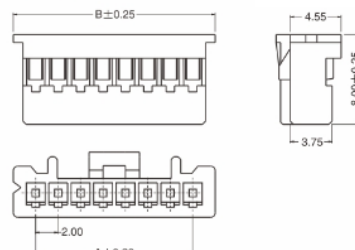

Wafer XD-PA-NA

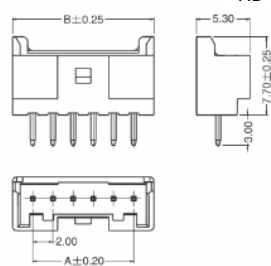

Wafer XD-PA-NAWD

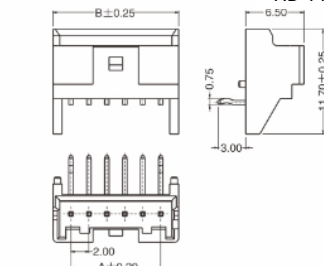

Housing

| 型号 Type | 尺寸 (mm) | |
|-----------|---------|-------|
| | A | B |
| XD-PA-2Y | 2.00 | 6.00 |
| XD-PA-3Y | 4.00 | 8.00 |
| XD-PA-4Y | 6.00 | 10.00 |
| XD-PA-5Y | 8.00 | 12.00 |
| XD-PA-6Y | 10.00 | 14.00 |
| XD-PA-7Y | 12.00 | 16.00 |
| XD-PA-8Y | 14.00 | 18.00 |
| XD-PA-16Y | 30.00 | 34.00 |

Wafer

| 型号 Type | 尺寸 (mm) | |
|---------------|---------|-------|
| | A | B |
| XD-PA-2A/AWD | 2.00 | 6.00 |
| XD-PA-3A/AWD | 4.00 | 8.00 |
| XD-PA-4A/AWD | 6.00 | 10.00 |
| XD-PA-5A/AWD | 8.00 | 12.00 |
| XD-PA-6A/AWD | 10.00 | 14.00 |
| XD-PA-7A/AWD | 12.00 | 16.00 |
| XD-PA-8A/AWD | 14.00 | 18.00 |
| XD-PA-16A/AWD | 30.00 | 34.00 |

主要技术特征 MAIN SPECIFICATIONS

间距 Pitch: 2.0mm

线数 Poles: 2~12

适用线规 APplicable Wire: AWG#22- #28

适用基板厚度 APplicable PC board thickness: 1.6mm

温度范围 Temperatuer Range: -25°C~ +85°C

额定电压 Voltage Rating: 300V AC, DC

额定电流 Current Rating: 3A AC, DC

接触电阻 Contract Resistance: 20mΩ Max

绝缘电阻 Insulation Resistance: 1000mΩ Min

耐压 Withstanding Voltang: 800V

材料 MATERIAL

端子 Terminal: Phosphor bronz

孔座 Housing: Nylon66 UL94V-0

针座 Wafer: Nylon6T UL94V-0

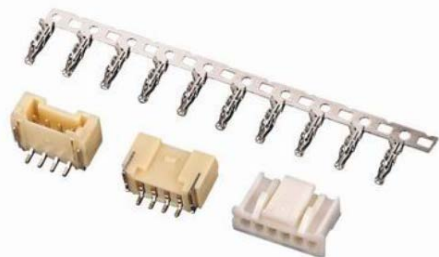

XD-PAE 系列

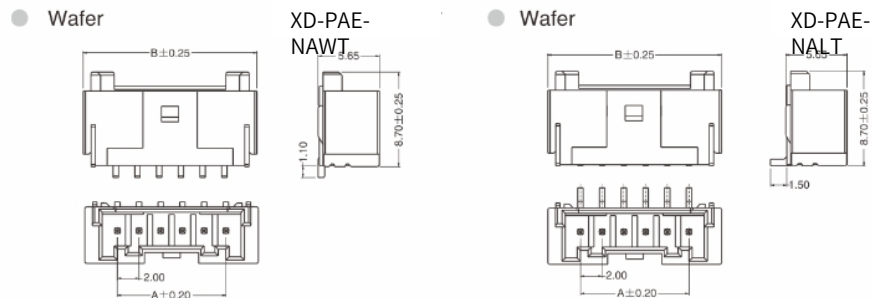
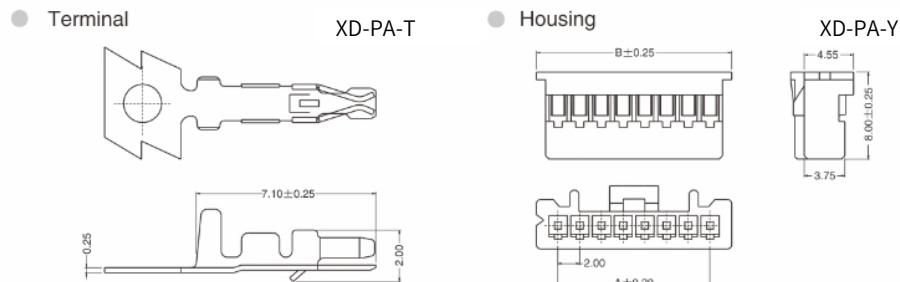

● Housing

| 型号Type _v | 尺寸 (mm) _v | |
|-------------------------|----------------------|--------------------|
| | A _v | B _v |
| XD-PAE-2Y _v | 2.00 _v | 6.00 _v |
| XD-PAE-3Y _v | 4.00 _v | 8.00 _v |
| XD-PAE-4Y _v | 6.00 _v | 10.00 _v |
| XD-PAE-5Y _v | 8.00 _v | 12.00 _v |
| XD-PAE-6Y _v | 10.00 _v | 14.00 _v |
| XD-PAE-7Y _v | 12.00 _v | 16.00 _v |
| XD-PAE-8Y _v | 14.00 _v | 18.00 _v |
| XD-PAE-12Y _v | 22.00 _v | 26.00 _v |

● Wafer

| 型号Type _v | 尺寸 (mm) _v | |
|------------------------------|----------------------|--------------------|
| | A _v | B _v |
| XD-PAE-2AWT/LT _v | 2.00 _v | 8.00 _v |
| XD-PAE-3AWT/LT _v | 4.00 _v | 10.00 _v |
| XD-PAE-4AWT/LT _v | 6.00 _v | 12.00 _v |
| XD-PAE-5AWT/LT _v | 8.00 _v | 14.00 _v |
| XD-PAE-6AWT/LT _v | 10.00 _v | 16.00 _v |
| XD-PAE-7AWT/LT _v | 12.00 _v | 18.00 _v |
| XD-PAE-8AWT/LT _v | 14.00 _v | 20.00 _v |
| XD-PAE-12AWT/LT _v | 22.00 _v | 28.00 _v |

主要技术特征 MAIN SPECIFICATIONS

间距 Pitch: 2.0mm

线数 Poles: 2~20

适用线规 APPLICable Wire: AWG#24- #30

适用基板厚度 APPLICable PC board thickness: 0.8~1.6mm

温度范围 Temperatuer Range: -25°C~ +85°C

额定电压 Voltage Rating: 250V AC, DC

额定电流 Current Rating: 2A AC, DC

接触电阻 Contract Resistance: 20mΩ Max

绝缘电阻 Insulation Resistance: 1000mΩ Min

耐压 Withstanding Voltang: 1000V

材料 MATERIAL

端子 Terminal: Phosphor bronz

孔座 Housing: Nylon66 UL94V-0

针座 Wafer: Nylon66 UL94V-0

针座(立/卧贴) Wafer: LCP UL94V-0

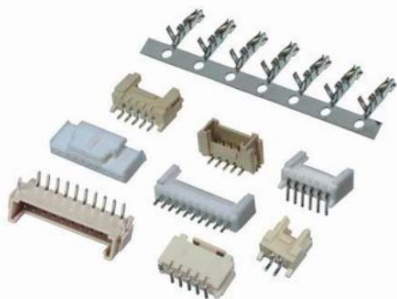

XD-HY 系列 (1)

Terminal

XD-HY-T

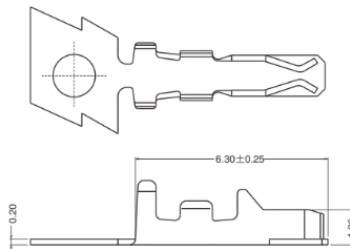

Housing

XD-HY-NY

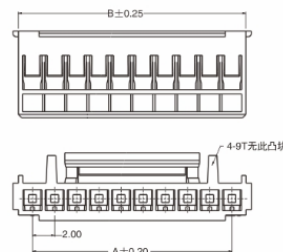

Wafer

XD-HY-NA

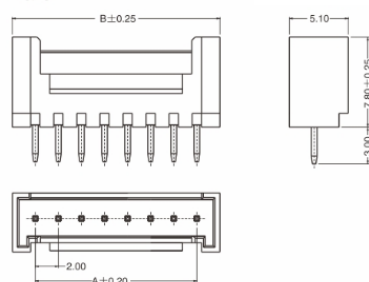

Wafer

XD-HY-NAW

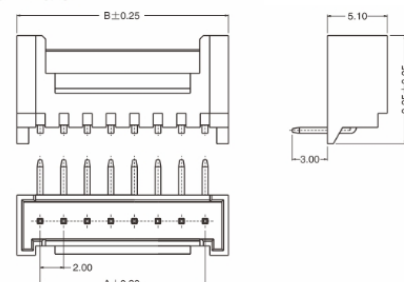

Wafer

XD-HY-NAWT

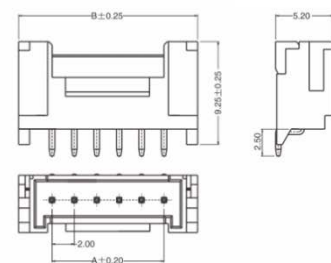

Housing

XD-HY-NALT

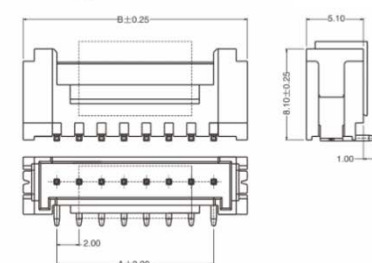

主要技术特征 MAIN SPECIFICATIONS

间距 Pitch: 2.0mm

线数 Poles: 2~20

适用线规 APPLICable Wire: AWG#24- #30

适用基板厚度 APPLICable PC board thickness: 0.8~1.6mm

温度范围 Temperatuer Range: -25°C~ +85°C

额定电压 Voltage Rating: 250V AC, DC

额定电流 Current Rating: 2A AC, DC

接触电阻 Contract Resistance: 20mΩ Max

绝缘电阻 Insulation Resistance: 1000mΩ Min

耐压 Withstanding Voltang: 1000V

XD-HY 系列 (2)

● Wafer

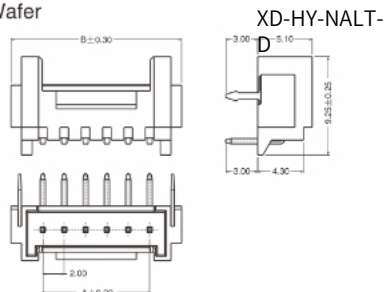

● Housing

| 型号 Type | 尺寸 (mm) | |
|-----------|---------|-------|
| | A | B |
| XD-HY-2Y | 2.00 | 4.80 |
| XD-HY-3Y | 4.00 | 6.80 |
| XD-HY-4Y | 6.00 | 8.80 |
| XD-HY-5Y | 8.00 | 10.80 |
| XD-HY-6Y | 10.00 | 12.80 |
| XD-HY-7Y | 12.00 | 14.80 |
| XD-HY-20Y | 38.00 | 40.80 |

● Wafer

| 型号 Type | 尺寸 (mm) | |
|---------------|---------|-------|
| | A | B |
| XD-HY-2ALT-D | 2.00 | 8.00 |
| XD-HY-3ALT-D | 4.00 | 10.00 |
| XD-HY-4ALT-D | 6.00 | 12.00 |
| XD-HY-5ALT-D | 8.00 | 14.00 |
| XD-HY-6ALT-D | 10.00 | 16.00 |
| XD-HY-7ALT-D | 12.00 | 18.00 |
| XD-HY-20ALT-D | 38.00 | 44.00 |

● Wafer

| 型号 Type | 尺寸 (mm) | |
|--------------|---------|-------|
| | A | B |
| XD-HY-2A/AW | 2.00 | 6.00 |
| XD-HY-3A/AW | 4.00 | 8.00 |
| XD-HY-4A/AW | 6.00 | 10.00 |
| XD-HY-5A/AW | 8.00 | 12.00 |
| XD-HY-6A/AW | 10.00 | 14.00 |
| XD-HY-7A/AW | 12.00 | 16.00 |
| XD-HY-20A/AW | 38.00 | 42.00 |

● Wafer

| 型号 Type | 尺寸 (mm) | |
|----------------|---------|-------|
| | A | B |
| XD-HY-2AWT/LT | 2.00 | 8.00 |
| XD-HY-3AWT/LT | 4.00 | 10.00 |
| XD-HY-4AWT/LT | 6.00 | 12.00 |
| XD-HY-5AWT/LT | 8.00 | 14.00 |
| XD-HY-6AWT/LT | 10.00 | 16.00 |
| XD-HY-7AWT/LT | 12.00 | 18.00 |
| XD-HY-20AWT/LT | 38.00 | 44.00 |

材料 MATERIAL

端子 Terminal: Phosphor bronz

孔座 Housing: Nylon66 UL94V-0

针座 Wafer: Nylon66 UL94V-0

针座(立/卧贴) Wafer: LCP UL94V-0

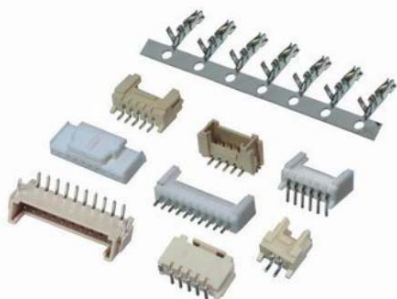

主要技术特征 MAIN SPECIFICATIONS

间距 Pitch: 2.0mm

线数 Poles: 2~20

适用线规 APPLICable Wire: AWG#24- #30

适用基板厚度 APPLICable PC board thickness: 0.8~1.6mm

温度范围 Temperatuer Range: -25°C~ +85°C

额定电压 Voltage Rating: 250V AC, DC

额定电流 Current Rating: 2A AC, DC

接触电阻 Contract Resistance: 20mΩ Max

绝缘电阻 Insulation Resistance: 1000mΩ Min

耐压 Withstanding Voltang: 1000V

材料 MATERIAL

针座 Wafer: Nylon66 UL94V-0

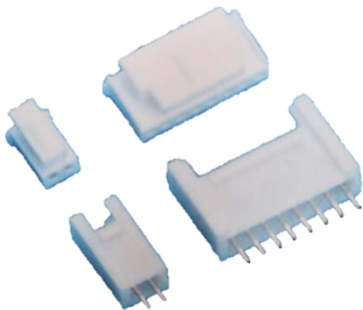

XD-HYH 系列

● Wafer XD-HYH-NA-X

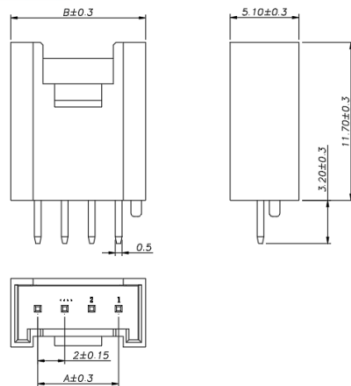

● Wafer

| 型号 Type | 尺寸 (mm) | |
|--------------|---------|-------|
| | A | B |
| XD-HYH-2A-X | 2.00 | 6.00 |
| XD-HYH-3A-X | 4.00 | 8.00 |
| XD-HYH-4A-X | 6.00 | 10.00 |
| XD-HYH-5A-X | 8.00 | 12.00 |
| XD-HYH-6A-X | 10.00 | 14.00 |
| XD-HYH-7A-X | 12.00 | 16.00 |
| XD-HYH-8A-X | 14.00 | 18.00 |
| XD-HYH-20A-X | 38.00 | 42.00 |

主要技术特征 MAIN SPECIFICATIONS

间距 Pitch: 2.0mm

线数 Poles: 2~15

适用线规 APPLICABLE Wire: AWG#24- #28

温度范围 Temperatuer Range: -25°C~ +85°C

额定电压 Voltage Rating: 125V AC, DC

额定电流 Current Rating: 2A AC, DC

接触电阻 Contract Resistance: 20mΩ Max

绝缘电阻 Insulation Resistance: 1000mΩ Min

耐压 Withstanding Voltang: 500V

材料 MATERIAL

端子 Terminal: Phosphor bronz

孔座 Housing: PBT UL94V-0



XD-PH 空中对接 系列

● Terminal XD-PH-ST

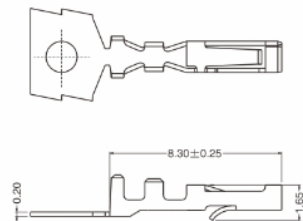

● Terminal XD-PH-PT

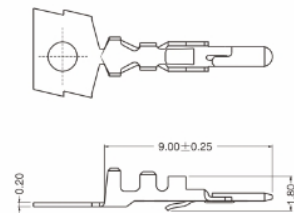

● Housing XD-PH-NSY

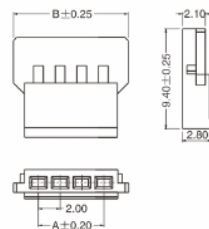

● Housing XD-PH-EY

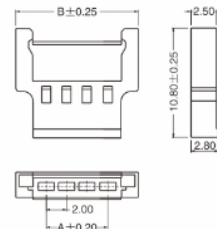

● Housing

| 型号 Type ^o | 尺寸 (mm) ^o | |
|-------------------------|----------------------|--------------------|
| | A ^o | B ^o |
| XD-PH-2SY ^o | 2.00 ^o | 8.00 ^o |
| XD-PH-3SY ^o | 4.00 ^o | 10.00 ^o |
| XD-PH-4SY ^o | 6.00 ^o | 12.00 ^o |
| XD-PH-5SY ^o | 8.00 ^o | 14.00 ^o |
| XD-PH-6SY ^o | 10.00 ^o | 16.00 ^o |
| XD-PH-7SY ^o | 12.00 ^o | 18.00 ^o |
| XD-PH-8SY ^o | 14.00 ^o | 20.00 ^o |
| XD-PH-15SY ^o | 28.00 ^o | 34.00 ^o |

● Housing

| 型号 Type ^o | 尺寸 (mm) ^o | |
|-------------------------|----------------------|--------------------|
| | A ^o | B ^o |
| XD-PH-2EY ^o | 2.00 ^o | 8.00 ^o |
| XD-PH-3EY ^o | 4.00 ^o | 10.00 ^o |
| XD-PH-4EY ^o | 6.00 ^o | 12.00 ^o |
| XD-PH-5EY ^o | 8.00 ^o | 14.00 ^o |
| XD-PH-6EY ^o | 10.00 ^o | 16.00 ^o |
| XD-PH-7EY ^o | 12.00 ^o | 18.00 ^o |
| XD-PH-8EY ^o | 14.00 ^o | 20.00 ^o |
| XD-PH-15EY ^o | 28.00 ^o | 34.00 ^o |

主要技术特征 MAIN SPECIFICATIONS

间距 Pitch: 2.0mm

线数 Poles: 2~15

适用线规 APPLICABLE WIRE: AWG#22- #30

温度范围 Temperatuer Range: -25°C~ +85°C

额定电压 Voltage Rating: 250V AC, DC

额定电流 Current Rating: 2A AC, DC

接触电阻 Contract Resistance: 20mΩ Max

绝缘电阻 Insulation Resistance: 1000mΩ Min

耐压 Withstanding Voltang: 1000V

材料 MATERIAL

端子 Terminal: Phosphor bronz

孔座 Housing: Nylon66 UL94V-0

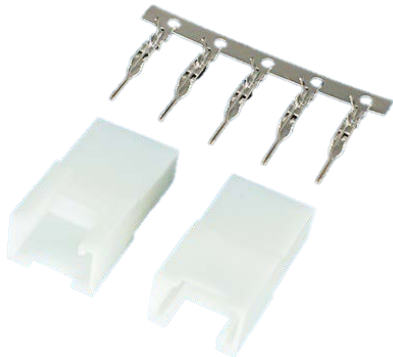

XD-HY 空中对接 系列

● Terminal XD-HY-PT

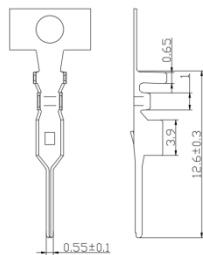

● Housing XD-HY-NEY

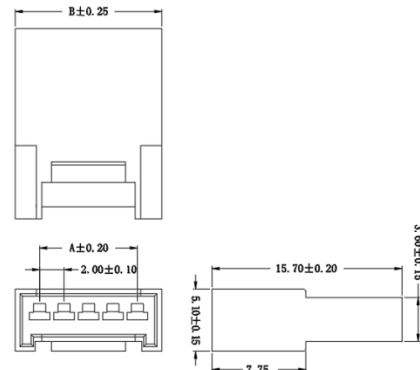

● Housing

| 型号 Type | 尺寸 (mm) | |
|------------|---------|-------|
| | A | B |
| XD-HY-2EY | 2.00 | 6.00 |
| XD-HY-3EY | 4.00 | 8.00 |
| XD-HY-4EY | 6.00 | 10.00 |
| XD-HY-5EY | 8.00 | 12.00 |
| XD-HY-6EY | 10.00 | 14.00 |
| XD-HY-7EY | 12.00 | 16.00 |
| XD-HY-8EY | 14.00 | 18.00 |
| XD-PAE-15Y | 28.00 | 32.00 |

主要技术特征 MAIN SPECIFICATIONS

间距 Pitch: 2.0mm

线数 Poles: 2~42

适用线规 APPLICABLE WIRE: AWG#26- #30

温度范围 Temperatuer Range: -25°C~ +85°C

额定电压 Voltage Rating: 250V AC, DC

额定电流 Current Rating: 2A AC, DC

接触电阻 Contract Resistance: 20mΩ Max

绝缘电阻 Insulation Resistance: 1000mΩ Min

耐压 Withstanding Voltang: 500V

材料 MATERIAL

端子 Terminal: Phosphor bronz

孔座 Housing: Nylon66 UL94V-0

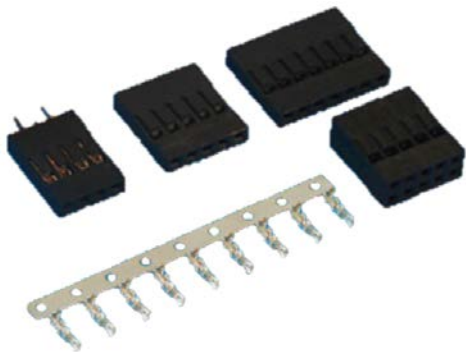

XD-2008 杜邦 系列

● Terminal

XD-2008-T

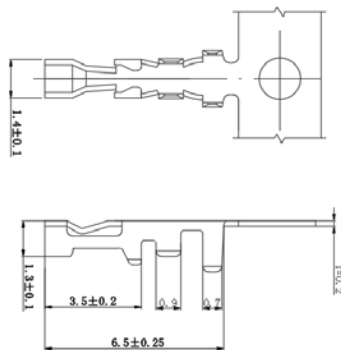

● Housing

XD-2008-2xNY

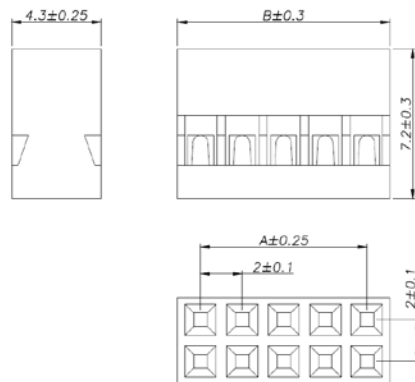

● Housing

| 型号Type. | 尺寸(mm). | |
|------------------|---------|--------|
| | A. | B. |
| XD-2008-2x2Y-X. | 2.00. | 4.20. |
| XD-2008-2x3Y-X. | 4.00. | 6.20. |
| XD-2008-2x4Y-X. | 6.00. | 8.20. |
| XD-2008-2x5Y-X. | 8.00. | 10.20. |
| XD-2008-2x6Y-X. | 10.00. | 12.20. |
| XD-2008-2x7Y-X. | 12.00. | 14.20. |
| XD-2008-2x8Y-X. | 14.00. | 16.20. |
| XD-2008-2x42Y-X. | 82.00. | 84.20. |

2.5mm 系列

6

• 间距 PITCH: 2.5mm (40~52页)

2.5单排条形连接器 XD-XH (TJC3) 系列

2.5单排条形连接器 XD-XHB 系列

2.5双排条形连接器 XD-XHD 系列

2.5单排(加高)条形连接器 XD-XHL 系列

2.5单排条形连接器 XD-XA 系列

2.5单排条形连接器 XD-HA 系列

2.5单排条形连接器 XD-5264 系列

2.5双排条形连接器 XD-XAD 系列

2.54双排条形连接器 XD-2510 系列

2.54刺破条形连接器 XD-A2510 系列

主要技术特征 MAIN SPECIFICATIONS

间距 Pitch: 2.5mm

线数 Poles: 2~20

适用线规 APPLICable Wire: AWG#22- #28

适用基板厚度 APPLICable PC board thickness: 1.6mm

温度范围 Temperatuer Range: -25°C~ +85°C

额定电压 Voltage Rating: 250V AC, DC

额定电流 Current Rating: 3A AC, DC

接触电阻 Contract Resistance: 20mΩ Max

绝缘电阻 Insulation Resistance: 1000mΩ Min

耐压 Withstanding Voltang: 1000V AC/1分钟minute

材料 MATERIAL

端子 Terminal: Phosphor bronz

孔座 Housing: Nylon66 UL94V-0

针座 Wafer: Nylon66 UL94V-0

针座(立/卧贴) Wafer: LCP UL94V-0

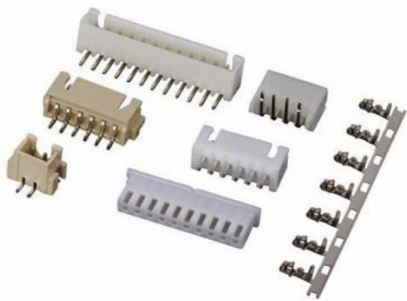

XD-XH 系列 (1)

Terminal

XD-XH-T17.3

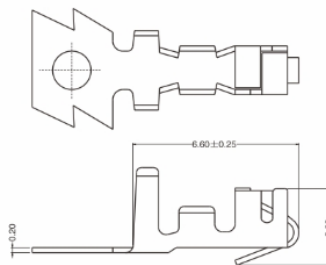

Housing

XD-XH-Y

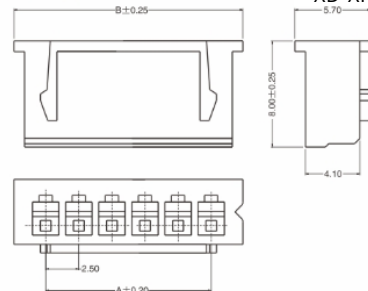

Wafer

XD-XH-NA

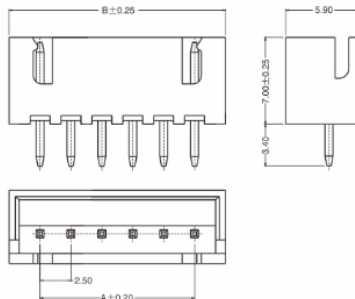

Wafer

XD-XH-NAW

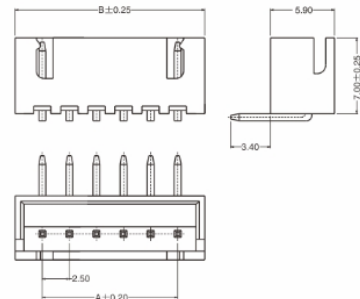

主要技术特征 MAIN SPECIFICATIONS

间距 Pitch: 2.5mm

线数 Poles: 2~20

适用线规 APPLICable Wire: AWG#22- #28

适用基板厚度 APPLICable PC board thickness: 1.6mm

温度范围 Temperatuer Range: -25°C~ +85°C

额定电压 Voltage Rating: 250V AC, DC

额定电流 Current Rating: 3A AC, DC

接触电阻 Contract Resistance: 20mΩ Max

绝缘电阻 Insulation Resistance: 1000mΩ Min

耐压 Withstanding Voltang: 1000V AC/1分钟minute

XD-XH 系列 (2)

● Wafer

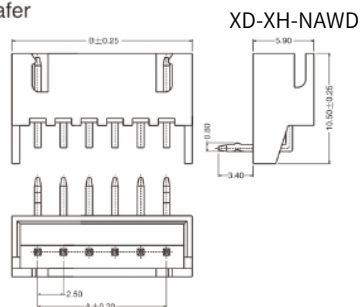

● Wafer

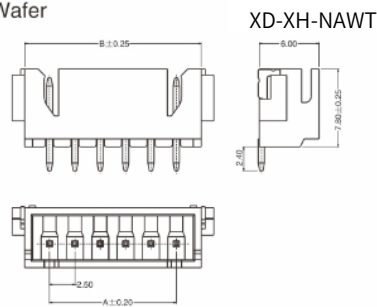

● Wafer

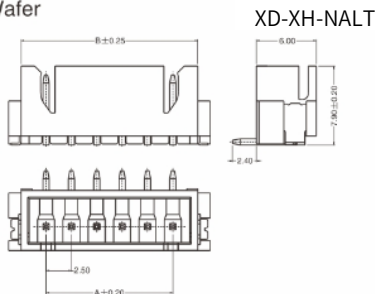

● Housing

| 型号Type ₀ | 尺寸(mm) ₀ | |
|------------------------|---------------------|--------------------|
| | A ₀ | B ₀ |
| XD-XH-2Y ₀ | 2.50 ₀ | 7.50 ₀ |
| XD-XH-3Y ₀ | 5.00 ₀ | 10.00 ₀ |
| XD-XH-4Y ₀ | 7.50 ₀ | 12.50 ₀ |
| XD-XH-5Y ₀ | 10.00 ₀ | 15.00 ₀ |
| XD-XH-6Y ₀ | 12.50 ₀ | 17.50 ₀ |
| XD-XH-7Y ₀ | 15.00 ₀ | 20.00 ₀ |
| XD-XH-8Y ₀ | 17.50 ₀ | 22.50 ₀ |
| XD-XH-20Y ₀ | 47.50 ₀ | 52.50 ₀ |

● Wafer

| 型号Type ₀ | 尺寸(mm) ₀ | |
|---------------------------------|---------------------|--------------------|
| | A ₀ | B ₀ |
| XD-XH-2A/ AW/ AWD ₀ | 2.50 ₀ | 7.50 ₀ |
| XD-XH-3A/ AW/ AWD ₀ | 5.00 ₀ | 10.00 ₀ |
| XD-XH-4A/ AW/ AWD ₀ | 7.50 ₀ | 12.50 ₀ |
| XD-XH-5A/ AW/ AWD ₀ | 10.00 ₀ | 15.00 ₀ |
| XD-XH-6A/ AW/ AWD ₀ | 12.50 ₀ | 17.50 ₀ |
| XD-XH-7A/ AW/ AWD ₀ | 15.00 ₀ | 20.00 ₀ |
| XD-XH-8A/ AW/ AWD ₀ | 17.50 ₀ | 22.50 ₀ |
| XD-XH-20A/ AW/ AWD ₀ | 47.50 ₀ | 52.50 ₀ |

● Wafer

| 型号Type ₀ | 尺寸(mm) ₀ | |
|----------------------------|---------------------|--------------------|
| | A ₀ | B ₀ |
| XD-XH-2AWT/LI ₀ | 2.50 ₀ | 7.50 ₀ |
| XD-XH-3AWT/LT ₀ | 5.00 ₀ | 10.00 ₀ |
| XD-XH-4AWT/LT ₀ | 7.50 ₀ | 12.50 ₀ |
| XD-XH-5AWT/LT ₀ | 10.00 ₀ | 15.00 ₀ |
| XD-XH-6AWT/LT ₀ | 12.50 ₀ | 17.50 ₀ |
| XD-XH-7AWT/LT ₀ | 15.00 ₀ | 20.00 ₀ |
| XD-XH-8AWT/LI ₀ | 17.50 ₀ | 22.50 ₀ |
| XD-XH-20AWTLI ₀ | 47.50 ₀ | 52.50 ₀ |

材料 MATERIAL

端子 Terminal: Phosphor bronz

孔座 Housing: Nylon66 UL94V-0

针座 Wafer: Nylon66 UL94V-0

针座(立/卧贴) Wafer: LCP UL94V-0

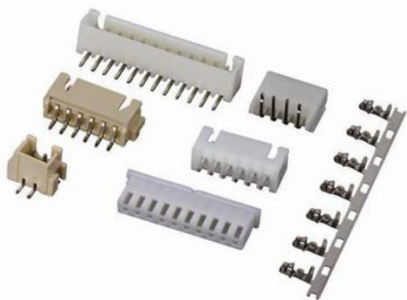

主要技术特征 MAIN SPECIFICATIONS

间距 Pitch: 2.5mm

线数 Poles: 2~20

适用线规 APPLICable Wire: AWG#22- #28

适用基板厚度 APPLICable PC board thickness: 1.6mm

温度范围 Temperatuer Range: -25°C~ +85°C

额定电压 Voltage Rating: 250V AC, DC

额定电流 Current Rating: 3A AC, DC

接触电阻 Contract Resistance: 20mΩ Max

绝缘电阻 Insulation Resistance: 1000mΩ Min

耐压 Withstanding Voltang: 1000V

XD-XHB 系列

● Housing

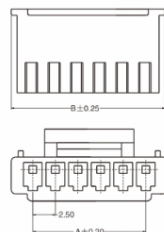

XD-XHB-Y

● Wafer

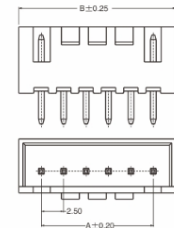

XD-XHB-NA

● Wafer

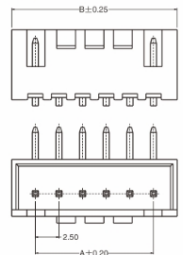

XD-XHB-NA

● Wafer

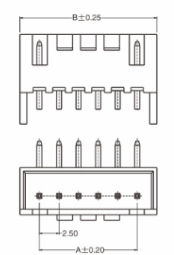

XD-XHB-NAWA



材料 MATERIAL

端子 Terminal: Phosphor bronz

孔座 Housing: Nylon66 UL94V-0

针座 Wafer: Nylon66 UL94V-0

针座(立/卧贴) Wafer: LCP UL94V-0



● Housing

| 型号 Type | 尺寸 (mm) | |
|------------|---------|-------|
| | A | B |
| XD-XHB-2Y | 25.00 | 7.50 |
| XD-XHB-3Y | 5.00 | 10.00 |
| XD-XHB-4Y | 7.50 | 12.50 |
| XD-XHB-5Y | 10.00 | 15.00 |
| XD-XHB-6Y | 12.50 | 17.50 |
| XD-XHB-7Y | 15.00 | 20.00 |
| XD-XHB-8Y | 17.50 | 22.50 |
| XD-XHB-9Y | 20.00 | 25.00 |
| XD-XHB-10Y | 22.50 | 27.50 |
| XD-XHB-11Y | 25.00 | 30.00 |
| XD-XHB-12Y | 27.50 | 32.50 |
| XD-XHB-13Y | 30.00 | 35.00 |
| XD-XHB-14Y | 32.50 | 37.50 |
| XD-XHB-15Y | 35.00 | 40.00 |
| XD-XHB-16Y | 37.50 | 42.50 |
| XD-XHB-20Y | 47.50 | 52.50 |

● Wafer

| 型号 Type | 尺寸 (mm) | |
|---------------------------------|---------|-------|
| | A | B |
| XD-XHB-2A/AW/D; HC-HA-2AWT/LT | 25.00 | 7.50 |
| XD-XHB-3A/AW/D; HC-HA-3AWT/LT | 5.00 | 10.00 |
| XD-XHB-4A/AW/D; HC-HA-4AWT/LT | 7.50 | 12.50 |
| XD-XHB-5A/AW/D; HC-HA-5AWT/LT | 10.00 | 15.00 |
| XD-XHB-6A/AW/D; HC-HA-6AWT/LT | 12.50 | 17.50 |
| XD-XHB-7A/AW/D; HC-HA-7AWT/LT | 15.00 | 20.00 |
| XD-XHB-8A/AW/D; HC-HA-8AWT/LT | 17.50 | 22.50 |
| XD-XHB-9A/AW/D; HC-HA-9AWT/LT | 20.00 | 25.00 |
| XD-XHB-10A/AW/D; HC-HA-10AWT/LT | 22.50 | 27.50 |
| XD-XHB-11A/AW/D; HC-HA-11AWT/LT | 25.00 | 30.00 |
| XD-XHB-12A/AW/D; HC-HA-12AWT/LT | 27.50 | 32.50 |
| XD-XHB-13A/AW/D; HC-HA-13AWT/LT | 30.00 | 35.00 |
| XD-XHB-14A/AW/D; HC-HA-14AWT/LT | 32.50 | 37.50 |
| XD-XHB-15A/AW/D; HC-HA-15AWT/LT | 35.00 | 40.00 |
| XD-XHB-16A/AW/D; HC-HA-16AWT/LT | 37.50 | 42.50 |
| XD-XHB-20A/AW/D; HC-HA-20AWT/LT | 47.50 | 52.50 |

主要技术特征 MAIN SPECIFICATIONS

间距 Pitch: 2.5mm

线数 Poles: 2~20

适用线规 APPLICable Wire: AWG#22- #30

适用基板厚度 APPLICable PC board thickness: 1.6mm

温度范围 Temperatuer Range: -25°C~ +85°C

额定电压 Voltage Rating: 250V AC, DC

额定电流 Current Rating: 3A AC, DC

接触电阻 Contract Resistance: 30mΩ Max

绝缘电阻 Insulation Resistance: 1000mΩ Min

耐压 Withstanding Voltang: 800V

材料 MATERIAL

端子 Terminal: Phosphor bronz

孔座 Housing: Nylon66 UL94V-0

针座 Wafer: Nylon66 UL94V-0



XD-XHD 系列 (1)

Terminal

XD-XHD-T

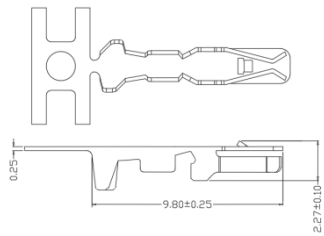

Housing

XD-XHD-NY

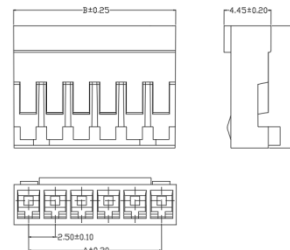

Wafer

XD-XHD-NA

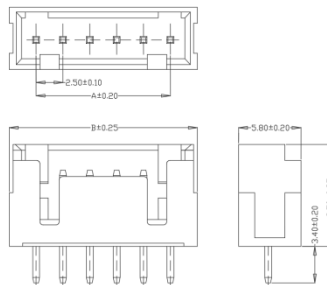

Wafer

XD-XHD-NAW

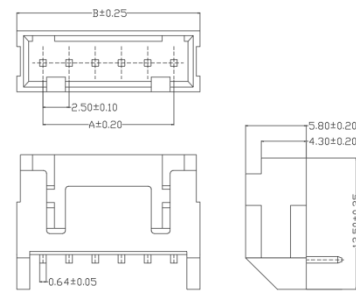

Wafer

XD-XHD-2xNY

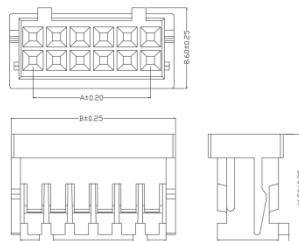

主要技术特征 MAIN SPECIFICATIONS

间距 Pitch: 2.5mm

线数 Poles: 2~20

适用线规 APplicable Wire: AWG#22- #30

适用基板厚度 APplicable PC board thickness: 1.6mm

温度范围 Temperatuer Range: -25°C~ +85°C

额定电压 Voltage Rating: 250V AC, DC

额定电流 Current Rating: 3A AC, DC

接触电阻 Contract Resistance: 30mΩ Max

绝缘电阻 Insulation Resistance: 1000mΩ Min

耐压 Withstanding Voltang: 800V

XD-XHD 系列 (2)

● Wafer

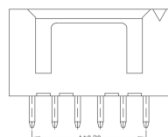
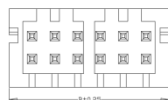

XD-XHD-
2xNA

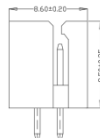

● Wafer

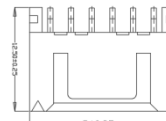
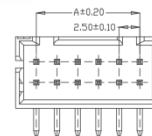

XD-XHD-
2xNAW

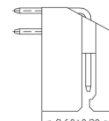

● Housing

| 型号Type. | 尺寸(mm) | |
|-------------|--------|--------|
| | A. | B. |
| XD-XHD-2Y. | 2.50. | 5.25. |
| XD-XHD-3Y. | 5.00. | 7.75. |
| XD-XHD-4Y. | 7.50. | 10.25. |
| XD-XHD-5Y. | 10.00. | 12.75. |
| XD-XHD-6Y. | 12.50. | 15.25. |
| XD-XHD-7Y. | 15.00. | 17.75. |
| XD-XHD-8Y. | 17.50. | 20.25. |
| XD-XHD-12Y. | 27.50. | 30.25. |

● Wafer

| 型号Type. | 尺寸(mm) | |
|----------------|--------|--------|
| | A. | B. |
| XD-XHD-2A/AW. | 2.50. | 7.50. |
| XD-XHD-3A/AW. | 5.00. | 10.00. |
| XD-XHD-4A/AW. | 7.50. | 12.50. |
| XD-XHD-5A/AW. | 10.00. | 15.00. |
| XD-XHD-6A/AW. | 12.50. | 17.50. |
| XD-XHD-7A/AW. | 15.00. | 20.00. |
| XD-XHD-8A/AW. | 17.50. | 22.50. |
| XD-XHD-12A/AW. | 27.50. | 32.50. |

● Wafer

| 型号Type. | 尺寸(mm) | |
|--------------------|--------|--------|
| | A. | B. |
| XD-XHD-2x2A/AW/Y. | 2.50. | 7.50. |
| XD-XHD-2x3A/AW/Y. | 5.00. | 10.00. |
| XD-XHD-2x4A/AW/Y. | 7.50. | 12.50. |
| XD-XHD-2x5A/AW/Y. | 10.00. | 15.00. |
| XD-XHD-2x6A/AW/Y. | 12.50. | 17.50. |
| XD-XHD-2x7A/AW/Y. | 15.00. | 20.00. |
| XD-XHD-2x8A/AW/Y. | 17.50. | 22.50. |
| XD-XHD-2x12A/AW/Y. | 27.50. | 32.50. |

材料 MATERIAL

端子 Terminal: Phosphor bronz

孔座 Housing: Nylon66 UL94V-0

针座 Wafer: Nylon66 UL94V-0

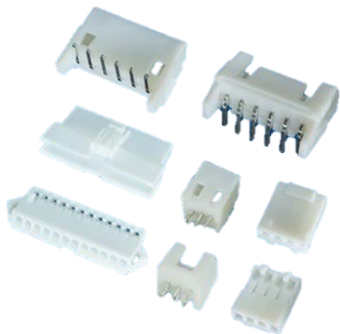

主要技术特征 MAIN SPECIFICATIONS

间距 Pitch: 2.5mm

线数 Poles: 2~15

适用线规 APPLICable Wire: AWG#22- #28

适用基板厚度 APPLICable PC board thickness: 1.6mm

温度范围 Temperatuer Range: -25°C~ +85°C

额定电压 Voltage Rating: 250V AC, DC

额定电流 Current Rating: 3A AC, DC

接触电阻 Contract Resistance: 20mΩ Max

绝缘电阻 Insulation Resistance: 1000mΩ Min

耐压 Withstanding Voltang: 1000V

材料 MATERIAL

端子 Terminal: Phosphor bronz

孔座 Housing: Nylon66 UL94V-0

针座 Wafer: Nylon66 UL94V-0

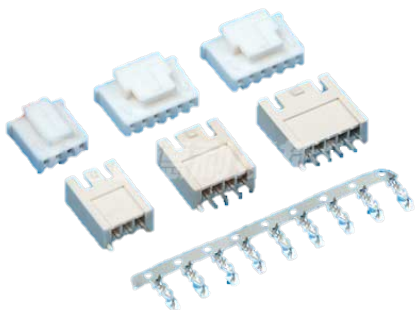

XD-XHL 系列

Terminal XD-XHL-T

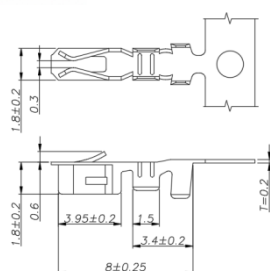

Housing XD-XHL-NY-X

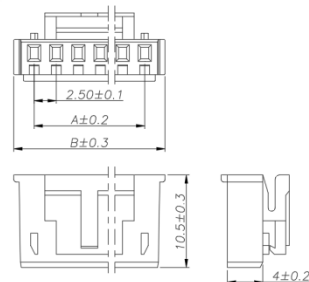

Wafer XD-XHL-NA-X

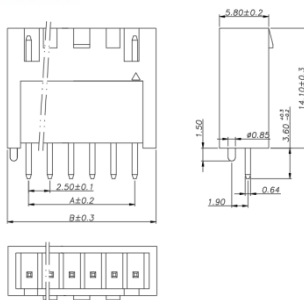

Housing

| 型号Type. | 尺寸(mm). | |
|---------------|---------|--------|
| | A. | B. |
| XD-XHL-2Y-X. | 2.50. | 7.00. |
| XD-XHL-3Y-X. | 5.00. | 9.50. |
| XD-XHL-4Y-X. | 7.50. | 12.00. |
| XD-XHL-5Y-X. | 10.00. | 14.50. |
| XD-XHL-6Y-X. | 12.50. | 17.00. |
| XD-XHL-7Y-X. | 15.00. | 19.50. |
| XD-XHL-8Y-X. | 17.50. | 22.00. |
| XD-XHL-15Y-X. | 35.00. | 39.50. |

Wafer

| 型号Type. | 尺寸(mm). | |
|---------------|---------|--------|
| | A. | B. |
| XD-XHL-2A-X. | 2.50. | 7.50. |
| XD-XHL-3A-X. | 5.00. | 10.00. |
| XD-XHL-4A-X. | 7.50. | 12.50. |
| XD-XHL-5A-X. | 10.00. | 15.00. |
| XD-XHL-6A-X. | 12.50. | 17.50. |
| XD-XHL-7A-X. | 15.00. | 20.00. |
| XD-XHL-8A-X. | 17.50. | 22.50. |
| XD-XHL-15A-X. | 35.00. | 40.00. |

主要技术特征 MAIN SPECIFICATIONS

间距 Pitch: 2.5mm

线数 Poles: 2~40

适用线规 APPLICable Wire: AWG#22- #28

适用基板厚度 APPLICable PC board thickness: 1.6mm

温度范围 Temperatuer Range: -25°C~ +85°C

额定电压 Voltage Rating: 250V AC, DC

额定电流 Current Rating: 3A AC, DC

接触电阻 Contract Resistance: 20mΩ Max

绝缘电阻 Insulation Resistance: 1000mΩ Min

耐压 Withstanding Voltang: 1000V

材料 MATERIAL

端子 Terminal: Phosphor bronz

孔座 Housing: Nylon66 UL94V-0

针座 Wafer: Nylon66 UL94V-0

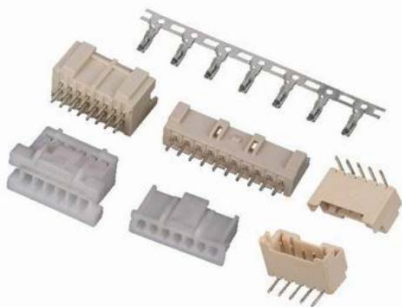

XD-XA 系列

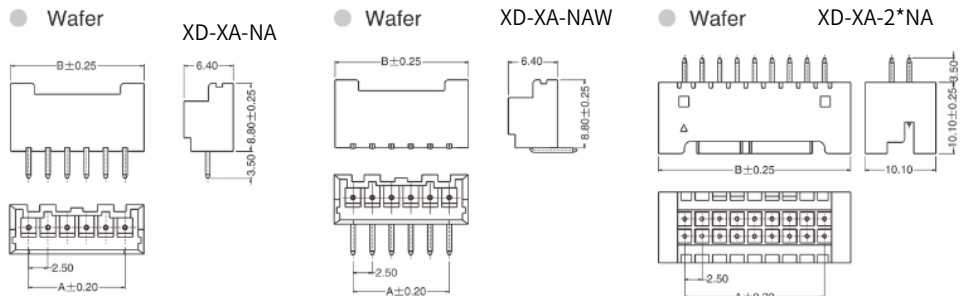
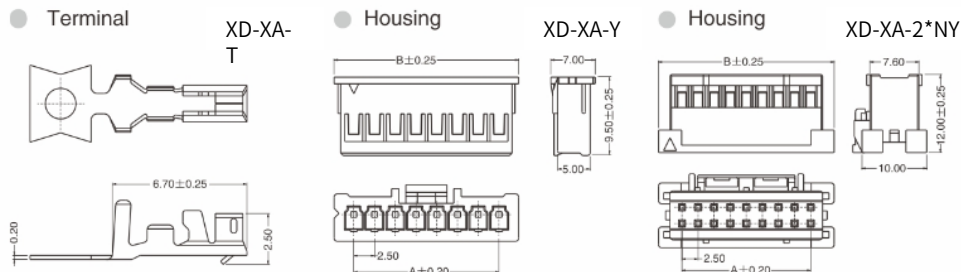

● Housing

| 型号 Type | 尺寸 (mm) | |
|------------------|---------|-------|
| | A | B |
| XD-XA-2Y/2A/AW | 2.50 | 7.50 |
| XD-XA-3Y/3A/AW | 5.00 | 10.00 |
| XD-XA-4Y/4A/AW | 7.50 | 12.50 |
| XD-XA-5Y/5A/AW | 10.00 | 15.00 |
| XD-XA-6Y/6A/AW | 12.50 | 17.50 |
| XD-XA-7Y/7A/AW | 15.00 | 20.00 |
| XD-XA-8Y/8A/AW | 17.50 | 22.50 |
| XD-XA-20Y/20A/AW | 47.50 | 52.50 |

● Wafer

| 型号 Type | 尺寸 (mm) | |
|-----------------|---------|-------|
| | A | B |
| XD-XA-2*4Y/4A | 7.50 | 15.00 |
| XD-XA-2*5Y/5A | 10.00 | 17.50 |
| XD-XA-2*6Y/6A | 12.50 | 20.00 |
| XD-XA-2*7Y/7A | 15.00 | 22.50 |
| XD-XA-2*8Y/8A | 17.50 | 25.00 |
| XD-XA-2*9Y/9A | 20.00 | 27.50 |
| XD-XA-2*10Y/10A | 22.50 | 30.00 |
| XD-XA-2*20Y/20A | 47.50 | 55.00 |

主要技术特征 MAIN SPECIFICATIONS

间距 Pitch: 2.5mm

线数 Poles: 2~12

适用线规 APPLICable Wire: AWG#22- #30

适用基板厚度 APPLICable PC board thickness: 1.6mm

温度范围 Temperatuer Range: -25°C~ +85°C

额定电压 Voltage Rating: 250V AC, DC

额定电流 Current Rating: 3A AC, DC

接触电阻 Contract Resistance: 30mΩ Max

绝缘电阻 Insulation Resistance: 1000mΩ Min

耐压 Withstanding Voltang: 800V

材料 MATERIAL

端子 Terminal: Phosphor bronz

孔座 Housing: Nylon66 UL94V-0

针座 Wafer: Nylon66 UL94V-0

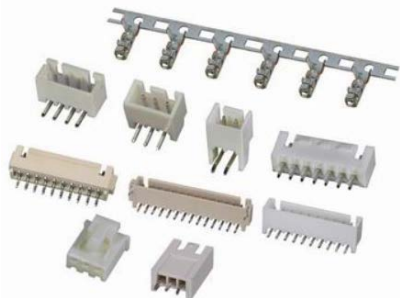

XD-HA 系列

Terminal

XD-HA-T

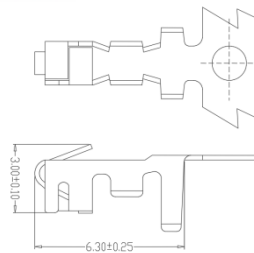

Housing

XD-HA-NY

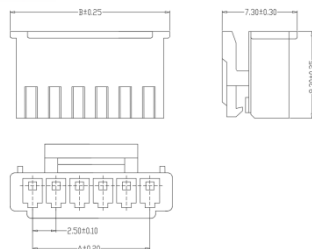

Wafer

XD-HA-NALT

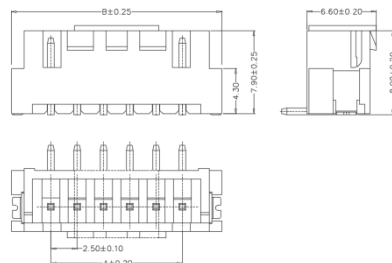

Wafer

XD-HA-NIAWT

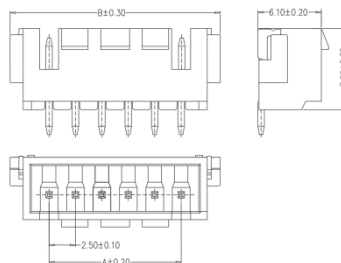

Housing

| 型号Type | 尺寸 (mm) | |
|-----------|---------|-------|
| | A | B |
| XD-HA-2Y | 2.50 | 6.80 |
| XD-HA-3Y | 5.00 | 9.30 |
| XD-HA-4Y | 7.50 | 11.80 |
| XD-HA-5Y | 10.00 | 14.30 |
| XD-HA-6Y | 12.50 | 16.80 |
| XD-HA-7Y | 15.00 | 19.30 |
| XD-HA-8Y | 17.50 | 21.80 |
| XD-HA-12Y | 27.50 | 31.80 |

Wafer

| 型号Type | 尺寸 (mm) | |
|-----------------|---------|-------|
| | A | B |
| XD-HA-2ALT/AWT | 2.50 | 10.00 |
| XD-HA-3ALT/AWT | 5.00 | 12.50 |
| XD-HA-4ALT/AWT | 7.50 | 15.00 |
| XD-HA-5ALT/AWT | 10.00 | 17.50 |
| XD-HA-6ALT/AWT | 12.50 | 20.00 |
| XD-HA-7ALT/AWT | 15.00 | 22.50 |
| XD-HA-8ALT/AWT | 17.50 | 27.50 |
| XD-HA-12ALT/AWT | 27.50 | 35.00 |

主要技术特征 MAIN SPECIFICATIONS

间距 Pitch: 2.5mm

线数 Poles: 2~20

适用线规 APPLICable Wire: AWG#22- #28

适用基板厚度 APPLICable PC board thickness: 1.6mm

温度范围 Temperatuer Range: -25°C~ +85°C

额定电压 Voltage Rating: 250V AC, DC

额定电流 Current Rating: 3A AC, DC

接触电阻 Contract Resistance: 20mΩ Max

绝缘电阻 Insulation Resistance: 1000mΩ Min

耐压 Withstanding Voltang: 1000V

XD-5264 系列

● Terminal XD-5264-T

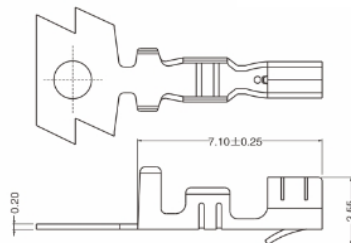

● Housing XD-5264-Y

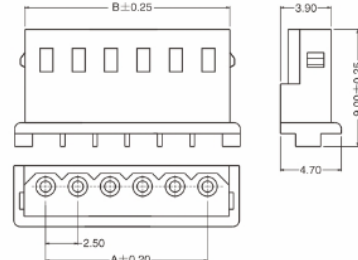

● Wafer XD-5264-NA

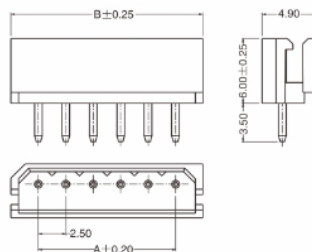

● Wafer XD-5264-NAW

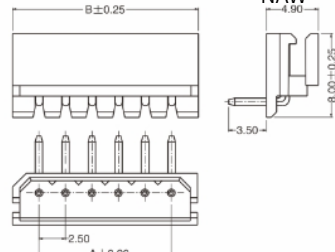

材料 MATERIAL

端子 Terminal: Phosphor bronz

孔座 Housing: Nylon66 UL94V-0

针座 Wafer: Nylon66 UL94V-0



● Housing

| 型号 Type ^o | 尺寸 (mm) ^o | |
|--------------------------|----------------------|--------------------|
| | A ^o | B ^o |
| XD-5264-2Y ^o | 2.50 ^o | 5.80 ^o |
| XD-5264-3Y ^o | 5.00 ^o | 8.30 ^o |
| XD-5264-4Y ^o | 7.50 ^o | 10.80 ^o |
| XD-5264-5Y ^o | 10.00 ^o | 13.30 ^o |
| XD-5264-6Y ^o | 12.50 ^o | 15.80 ^o |
| XD-5264-7Y ^o | 15.00 ^o | 18.30 ^o |
| XD-5264-8Y ^o | 17.50 ^o | 20.80 ^o |
| XD-5264-20Y ^o | 47.50 ^o | 50.80 ^o |

● Wafer

| 型号 Type ^o | 尺寸 (mm) ^o | |
|-----------------------------|----------------------|--------------------|
| | A ^o | B ^o |
| XD-5264-2A/AW ^o | 2.50 ^o | 7.50 ^o |
| XD-5264-3A/AW ^o | 5.00 ^o | 10.00 ^o |
| XD-5264-4A/AW ^o | 7.50 ^o | 12.50 ^o |
| XD-5264-5A/AW ^o | 10.00 ^o | 15.00 ^o |
| XD-5264-6A/AW ^o | 12.50 ^o | 17.50 ^o |
| XD-5264-7A/AW ^o | 15.00 ^o | 20.00 ^o |
| XD-5264-8A/AW ^o | 17.50 ^o | 22.50 ^o |
| XD-5264-20A/AW ^o | 47.50 ^o | 52.50 ^o |

主要技术特征 MAIN SPECIFICATIONS

间距 Pitch: 2.5mm

线数 Poles: 2~20

适用线规 APPLICable Wire: AWG#22- #28

适用基板厚度 APPLICable PC board thickness: 1.6mm

温度范围 Temperatuer Range: -25°C~ +85°C

额定电压 Voltage Rating: 250V AC, DC

额定电流 Current Rating: 3A AC, DC

接触电阻 Contract Resistance: 20mΩ Max

绝缘电阻 Insulation Resistance: 1000mΩ Min

耐压 Withstanding Voltang: 1000V

材料 MATERIAL

端子 Terminal: Phosphor bronz

孔座 Housing: Nylon66 UL94V-0

针座 Wafer: Nylon66 UL94V-0



XD-XAD 系列

● Terminal

XD-XAD-T-05

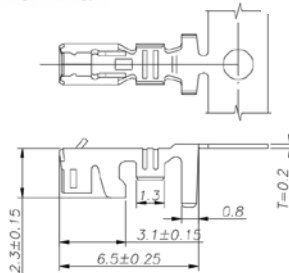

● Housing

XD-XAD-2xNY-05

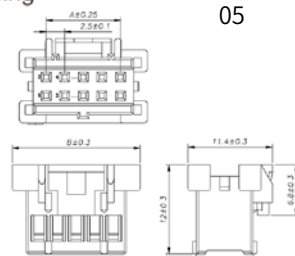

● Wafer

XD-XAD-2xNA-05

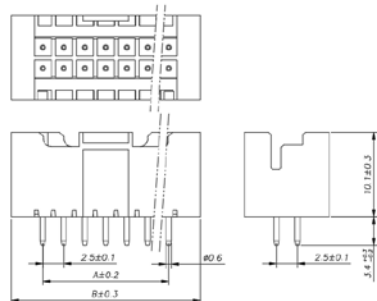

● Wafer

XD-XHD-2xNAWD-05

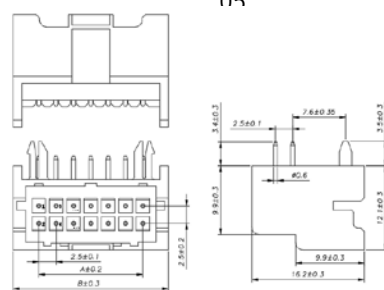

● Wafer

XD-XAD-2xNY

主要技术特征 MAIN SPECIFICATIONS

间距 Pitch: 2.54mm

线数 Poles: 2~20

适用线规 APPLICable Wire: AWG#24- #30

适用基板厚度 APPLICable PC board thickness: 1.6mm

温度范围 Temperatuer Range: -25°C~ +85°C

额定电压 Voltage Rating: 250V AC, DC

额定电流 Current Rating: 4A AC, DC

接触电阻 Contract Resistance: 20mΩ Max

绝缘电阻 Insulation Resistance: 1000mΩ Min

耐压 Withstanding Voltang: 1000V

XD-2510 系列

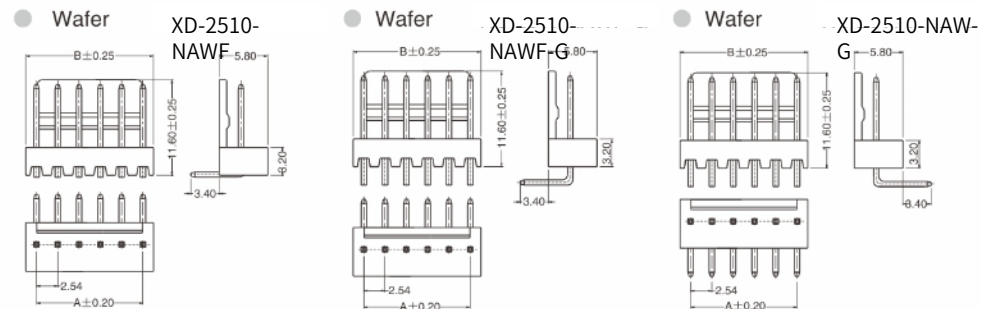
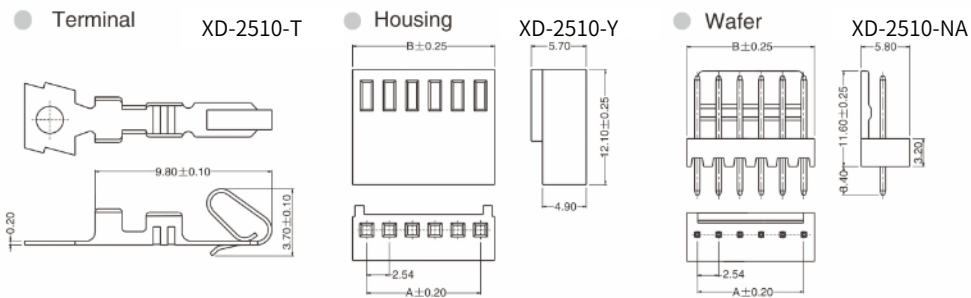

材料 MATERIAL

端子 Terminal: Phosphor bronz

孔座 Housing: Nylon66 UL94V-0

针座 Wafer: Nylon66 UL94V-0



● Housing

| 型号 Type | 尺寸 (mm) | |
|-------------|---------|-------|
| | A | B |
| XD-2510-2Y | 2.54 | 5.68 |
| XD-2510-3Y | 5.08 | 8.22 |
| XD-2510-4Y | 7.62 | 10.76 |
| XD-2510-5Y | 10.16 | 13.30 |
| XD-2510-6Y | 12.70 | 15.84 |
| XD-2510-7Y | 15.24 | 18.38 |
| XD-2510-8Y | 17.78 | 20.92 |
| XD-2510-20Y | 48.26 | 51.40 |

● Wafer

| 型号 Type | 尺寸 (mm) | |
|----------------------------|---------|-------|
| | A | B |
| XD-2510-2A/AWF/AWF-G/AW-G | 2.54 | 5.08 |
| XD-2510-3A/AWF/AWF-G/AW-G | 5.08 | 7.62 |
| XD-2510-4A/AWF/AWF-G/AW-G | 7.62 | 10.16 |
| XD-2510-5A/AWF/AWF-G/AW-G | 10.16 | 12.70 |
| XD-2510-6A/AWF/AWF-G/AW-G | 12.70 | 15.24 |
| XD-2510-7A/AWF/AWF-G/AW-G | 15.24 | 17.78 |
| XD-2510-8A/AWF/AWF-G/AW-G | 17.78 | 20.32 |
| XD-2510-20A/AWF/AWF-G/AW-G | 48.26 | 50.80 |

主要技术特征 MAIN SPECIFICATIONS

间距 Pitch: 2.54mm

线数 Poles: 2~30

适用线规 APPLICable Wire: AWG#22- #28

适用基板厚度 APPLICable PC board thickness: 1.6mm

温度范围 Temperatuer Range: -25°C~ +85°C

额定电压 Voltage Rating: 250V AC, DC

额定电流 Current Rating: 2A AC, DC

接触电阻 Contract Resistance: 20mΩ Max

绝缘电阻 Insulation Resistance: 1000mΩ Min

耐压 Withstanding Voltang: 1500V

材料 MATERIAL

端子 Terminal: Phosphor bronz

孔座 Housing: Nylon66 UL94V-0

针座 Wafer: Nylon66 UL94V-0

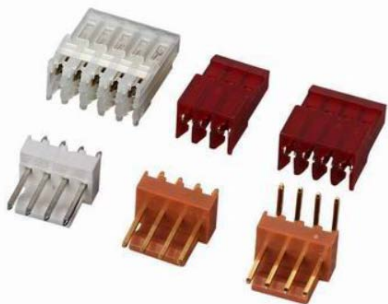

XD-A2510 刺破系列

● Terminal XD-A2510-T

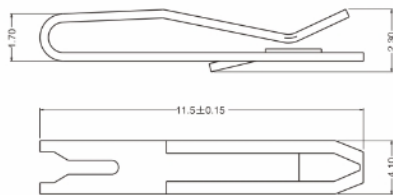

● Housing XD-A2510-NY

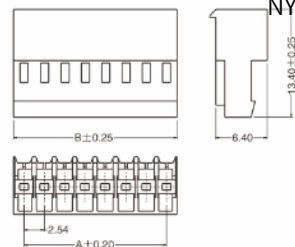

● Wafer XD-A2510-NA

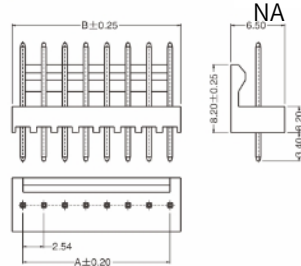

● Wafer XD-A2510-NAW-G

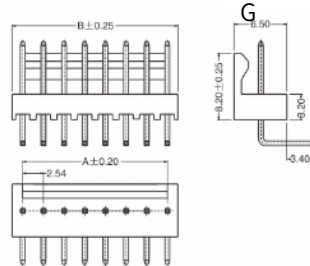

● Housing

| 型号Type | 尺寸 mm | |
|--------------|-------|-------|
| | A | B |
| XD-A2510-2Y | 2.54 | 5.20 |
| XD-A2510-3Y | 5.08 | 7.72 |
| HG A25104Y | 7.62 | 10.28 |
| XD-A2510-5Y | 10.16 | 12.82 |
| XD-A2510-6Y | 12.70 | 15.36 |
| XD-A2510-7Y | 15.24 | 17.90 |
| XD A2510 BY | 17.78 | 20.44 |
| XD-A2510-30Y | 73.66 | 76.32 |

● Wafer

| 型号Type | 尺寸 (mm) | |
|-------------------|---------|-------|
| | A | B |
| XD-A2510-2A/AW-G | 2.54 | 5.08 |
| XD-A2510-3A/AW-G | 5.08 | 7.72 |
| XD-A2510-4A/AW-G | 7.62 | 10.16 |
| XD-A2510-5A/AW-G | 10.16 | 12.70 |
| XD-A2510-6A/AW-G | 12.70 | 15.24 |
| XD-A2510-7A/AW-G | 15.24 | 17.78 |
| XD-A2510-8A/AW-G | 17.78 | 20.32 |
| XD-A2510-30A/AW-C | 73.66 | 76.20 |

3.00mm 系列

- 7 · 间距 PITCH: 3.00mm (53~55页)
3.00双排条形连接器 XD-MX 系列

主要技术特征 MAIN SPECIFICATIONS

间距 Pitch: 3.0mm

线数 Poles: 2~24

适用线规 APPLICABLE Wire: AWG#20- #28

适用基板厚度 APPLICABLE PC board thickness: 1.6mm

温度范围 Temperatuer Range: -25°C~ +85°C

额定电压 Voltage Rating: 600V AC, DC

额定电流 Current Rating: 5A AC, DC

接触电阻 Contact Resistance: 20mΩ Max

绝缘电阻 Insulation Resistance: 1000mΩ Min

耐压 Withstanding Voltang: 1500V

材料 MATERIAL

端子 Terminal: Phosphor bronz

孔座 Housing: Nylon66 UL94V-0

针座 Wafer: Nylon66 UL94V-0



XD-MX 系列(1)

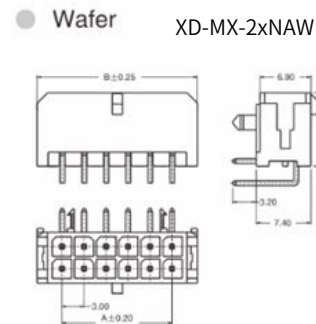
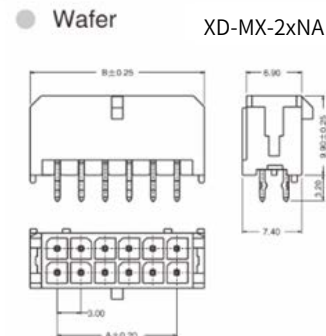
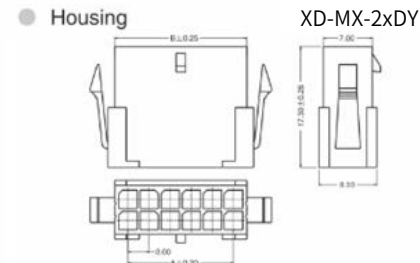
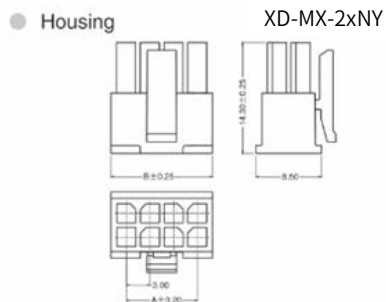
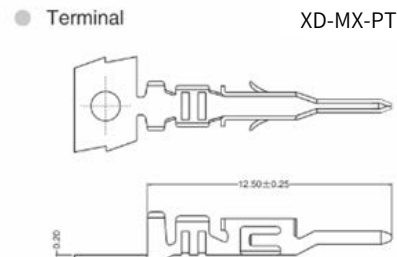
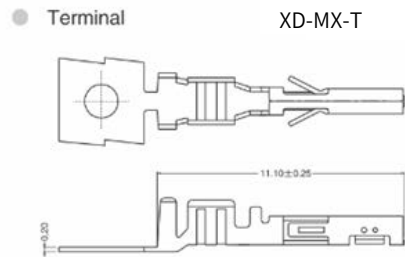

3.81mm 系列

8

- 间距 PITCH: 3.81mm (56~57页)
3.81双排条形连接器 XD-MX 系列

主要技术特征 MAIN SPECIFICATIONS

间距 Pitch: 3.81mm

线数 Poles: 2~12

适用线规 APPLICable Wire: AWG#14- #24

适用基板厚度 APPLICable PC board thickness: 1.6mm

温度范围 Temperatuer Range: -25°C~ +85°C

额定电压 Voltage Rating: 250V AC, DC

额定电流 Current Rating: 15A AC, DC

接触电阻 Contract Resistance: 10mΩ Max

绝缘电阻 Insulation Resistance: 1000mΩ Min

耐压 Withstanding Voltang: 1500V

材料 MATERIAL

端子 Terminal: Phosphor bronz

孔座 Housing: PBT UL94V-0

针座 Wafer: PBT UL94V-0

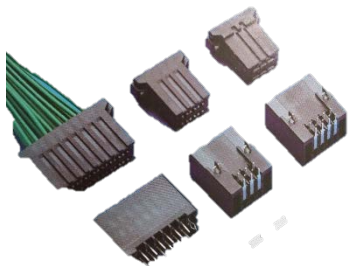

XD-3.81 系列

- Terminal XD-3.81-T-05

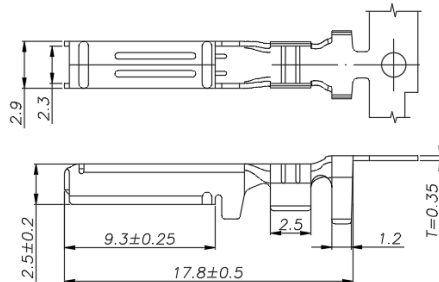

- Housing XD-3.81-2xNY-05

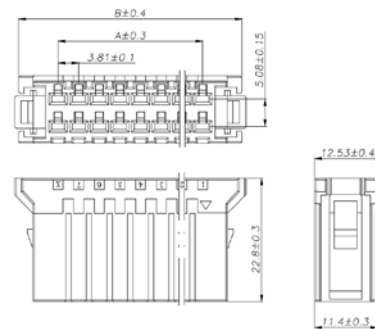

- Wafer XD-3.81-2xNA-05

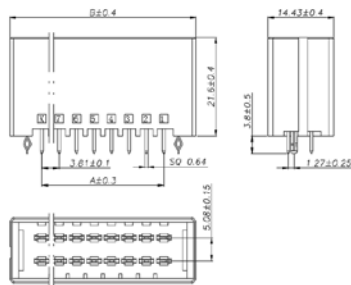

- Wafer XD-3.81-2xNAW-05

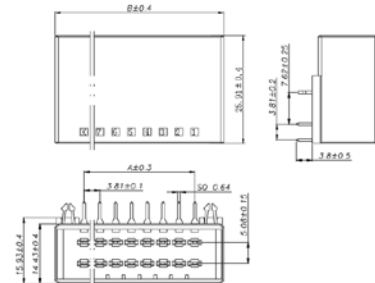

- Housing

| 型号Type | 尺寸(mm) | |
|--------------------|--------|-------|
| | A | B |
| XD-3.81-2x2Y-X-05 | 3.81 | 18.35 |
| XD-3.81-2x3Y-X-05 | 7.62 | 22.16 |
| XD-3.81-2x4Y-X-05 | 11.43 | 25.97 |
| XD-3.81-2x5Y-X-05 | 15.24 | 29.78 |
| XD-3.81-2x12Y-X-05 | 41.91 | 56.45 |

- Wafer

| 型号Type | 尺寸(mm) | |
|-----------------------|--------|-------|
| | A | B |
| XD-3.81-2x2A/AW-X-05 | 3.81 | 17.81 |
| XD-3.81-2x3A/AW-X-05 | 7.62 | 21.62 |
| XD-3.81-2x4A/AW-X-05 | 11.43 | 25.43 |
| XD-3.81-2x5A/AW-X-05 | 15.24 | 29.24 |
| XD-3.81-2x12A/AW-X-05 | 41.91 | 55.91 |

3.96mm 系列

9

• 间距 PITCH: 3.96mm (58~63页)

3.96单排条形连接器 XD-3.96 系列

3.96单排条形连接器 XD-VH 系列

3.96单排条形连接器 XD-VHL 系列

3.96单排条形连接器 XD-VHH系列

主要技术特征 MAIN SPECIFICATIONS

间距 Pitch: 3.96mm

线数 Poles: 2~12

适用线规 APPLICable Wire: AWG#18- #24

适用基板厚度 APPLICable PC board thickness: 1.6mm

温度范围 Temperatuer Range: -25°C~ +85°C

额定电压 Voltage Rating: 250V AC, DC

额定电流 Current Rating: 6A AC, DC

接触电阻 Contract Resistance: 20mΩ Max

绝缘电阻 Insulation Resistance: 1000mΩ Min

耐压 Withstanding Voltang: 1500V

XD-3.96 系列

● Terminal XD-3,96-T

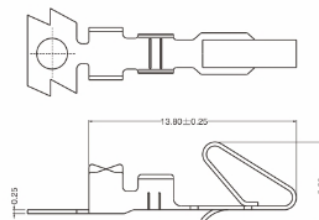

● Housing XD-3,96-Y

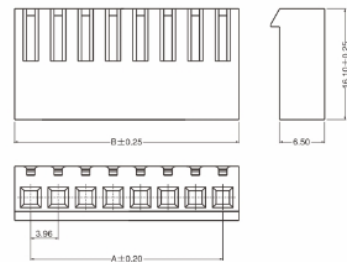

● Wafer XD-3,96-NA

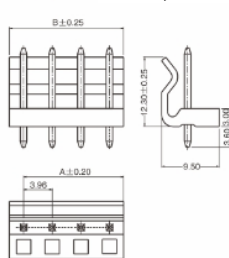

● Wafer XD-3,96-NAW

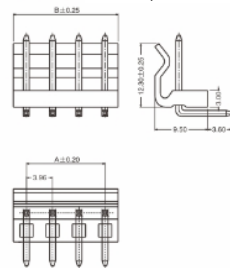

● Wafer XD-3,96-NAW-G

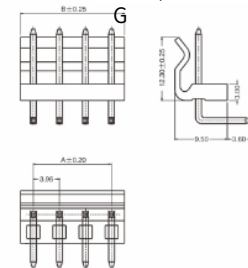

材料 MATERIAL

端子 Terminal: Phosphor bronz

孔座 Housing: Nylon66 UL94V-0

针座 Wafer: Nylon66 UL94V-0

● Housing

| 型号Type | 尺寸 (mm) | |
|-------------|---------|-------|
| | A | B |
| XD-3.96-2Y | 3.96 | 8.80 |
| XD-3.96-3Y | 7.92 | 12.76 |
| XD-3.96-4Y | 11.88 | 16.72 |
| XD-3.96-5Y | 15.84 | 20.68 |
| XD-3.96-6Y | 19.80 | 24.64 |
| XD-3.96-7Y | 23.76 | 28.60 |
| XD-3.96-8Y | 27.72 | 32.56 |
| XD-3.96-9Y | 31.68 | 36.52 |
| XD-3.96-10Y | 35.64 | 40.48 |
| XD-3.96-11Y | 39.60 | 44.44 |
| XD-3.96-12Y | 43.56 | 47.62 |

● Wafer

| 型号Type | 尺寸 (mm) | |
|---------------------|---------|-------|
| | A | B |
| XD-3.96-2A/AW/AW-G | 3.96 | 7.92 |
| XD-3.96-3A/AW/AW-G | 7.92 | 11.88 |
| XD-3.96-4A/AW/AW-G | 11.88 | 15.84 |
| XD-3.96-5A/AW/AW-G | 15.84 | 19.80 |
| XD-3.96-6A/AW/AW-G | 19.80 | 23.76 |
| XD-3.96-7A/AW/AW-G | 23.76 | 27.72 |
| XD-3.96-8A/AW/AW-G | 27.72 | 31.68 |
| XD-3.96-9A/AW/AW-G | 31.68 | 35.64 |
| XD-3.96-10A/AW/AW-G | 35.64 | 39.60 |
| XD-3.96-11A/AW/AW-G | 39.60 | 43.56 |
| XD-3.96-12A/AW/AW-G | 43.56 | 47.52 |



主要技术特征 MAIN SPECIFICATIONS

间距 Pitch: 3.96mm

线数 Poles: 2~12

适用线规 APPLICable Wire: AWG#18- #22

适用基板厚度 APPLICable PC board thickness: 1.6mm

温度范围 Temperatuer Range: -25°C~ +85°C

额定电压 Voltage Rating: 250V AC, DC

额定电流 Current Rating: 7A AC, DC

接触电阻 Contract Resistance: 20mΩ Max

绝缘电阻 Insulation Resistance: 1000mΩ Min

耐压 Withstanding Voltang: 1500V

材料 MATERIAL

端子 Terminal: Phosphor bronz

孔座 Housing: Nylon66 UL94V-0

针座 Wafer: Nylon66 UL94V-0

针座(立/卧贴) Wafer: LCP UL94V-0 UL94V-0



XD-VH 系列 (1)

Terminal

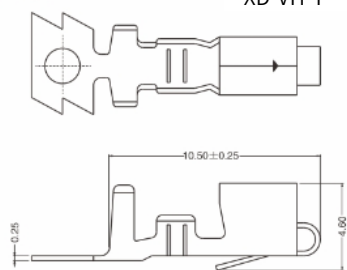

Housing

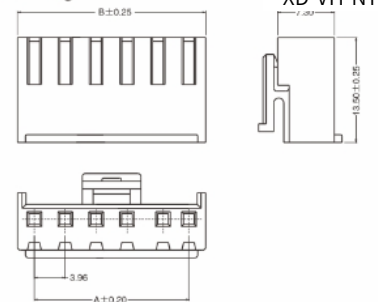

Wafer

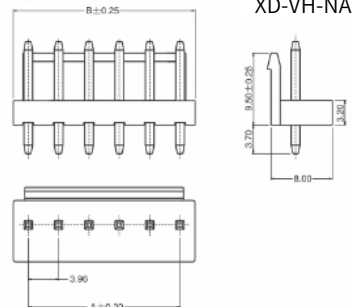

Wafer

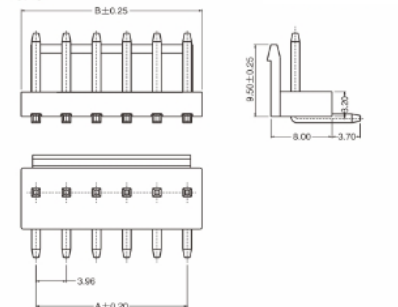

主要技术特征 MAIN SPECIFICATIONS

间距 Pitch: 3.96mm

线数 Poles: 2~12

适用线规 APPLICable Wire: AWG#18- #22

适用基板厚度 APPLICable PC board thickness: 1.6mm

温度范围 Temperatuer Range: -25°C~ +85°C

额定电压 Voltage Rating: 250V AC, DC

额定电流 Current Rating: 7A AC, DC

接触电阻 Contract Resistance: 20mΩ Max

绝缘电阻 Insulation Resistance: 1000mΩ Min

耐压 Withstanding Voltang: 1500V

XD-VH 系列 (2)

● Wafer

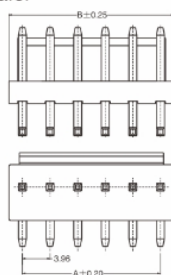

XD-VH-NAW-G

● Wafer

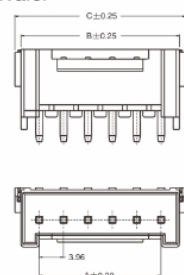

XD-VH-NAWT



● Wafer

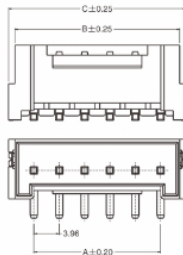

XD-VH-NALT

材料 MATERIAL

端子 Terminal: Phosphor bronz

孔座 Housing: Nylon66 UL94V-0

针座 Wafer: Nylon66 UL94V-0

针座(立/卧贴) Wafer: LCP UL94V-0 UL94V-0

● Housing

● Wafer

● Wafer



| 型号 Type | 尺寸 (mm) | |
|-----------|---------|-------|
| | A | B |
| XD-VH-2Y | 3.96 | 8.02 |
| XD-VH-3Y | 7.92 | 11.98 |
| XD-VH-4Y | 11.88 | 15.94 |
| XD-VH-5Y | 15.84 | 19.90 |
| XD-VH-6Y | 19.80 | 23.86 |
| XD-VH-7Y | 23.76 | 27.82 |
| XD-VH-8Y | 27.72 | 31.78 |
| XD-VH-9Y | 31.68 | 35.74 |
| XD-VH-10Y | 35.64 | 39.70 |
| XD-VH-11Y | 39.60 | 43.66 |
| XD-VH-12Y | 43.56 | 47.62 |

| 型号 Type | 尺寸 (mm) | |
|-------------------|---------|-------|
| | A | B |
| XD-VH-2A/AW/AW-G | 3.96 | 7.92 |
| XD-VH-3A/AW/AW-G | 7.92 | 11.88 |
| XD-VH-4A/AW/AW-G | 11.88 | 15.84 |
| XD-VH-5A/AW/AW-G | 15.84 | 19.80 |
| XD-VH-6A/AW/AW-G | 19.80 | 23.76 |
| XD-VH-7A/AW/AW-G | 23.76 | 27.72 |
| XD-VH-8A/AW/AW-G | 27.72 | 31.68 |
| XD-VH-9A/AW/AW-G | 31.68 | 35.64 |
| XD-VH-10A/AW/AW-G | 35.64 | 39.60 |
| XD-VH-11A/AW/AW-G | 39.60 | 43.56 |
| XD-VH-12A/AW/AW-G | 43.56 | 47.52 |

| 型号 Type | 尺寸 (mm) | | |
|----------------|---------|-------|-------|
| | A | B | C |
| XD-VH-2AWT/LT | 3.96 | 9.90 | 11.88 |
| XD-VH-3AWT/LT | 7.92 | 13.86 | 15.84 |
| XD-VH-4AWT/LT | 11.88 | 17.82 | 19.80 |
| XD-VH-5AWT/LT | 15.84 | 21.78 | 23.76 |
| XD-VH-6AWT/LT | 19.80 | 25.74 | 27.72 |
| XD-VH-7AWT/LT | 23.76 | 29.70 | 31.68 |
| XD-VH-8AWT/LT | 27.72 | 33.66 | 35.64 |
| XD-VH-9AWT/LT | 31.68 | 37.62 | 39.60 |
| XD-VH-10AWT/LT | 35.64 | 41.58 | 43.56 |
| XD-VH-11AWT/LT | 39.60 | 45.54 | 47.52 |
| XD-VH-12AWT/LT | 43.56 | 49.50 | 51.48 |

主要技术特征 MAIN SPECIFICATIONS

间距 Pitch: 3.96mm

线数 Poles: 2~15

适用线规 APPLICable Wire: AWG#18- #22

适用基板厚度 APPLICable PC board thickness: 1.6mm

温度范围 Temperatuer Range: -25°C~ +85°C

额定电压 Voltage Rating: 250V AC, DC

额定电流 Current Rating: 7A AC, DC

接触电阻 Contract Resistance: 20mΩ Max

绝缘电阻 Insulation Resistance: 1000mΩ Min

耐压 Withstanding Voltang: 1500V

材料 MATERIAL

端子 Terminal: Phosphor bronz

孔座 Housing: Nylon66 UL94V-0

针座 Wafer: Nylon66 UL94V-0



XD-VHL 系列

Terminal XD-VHL-T

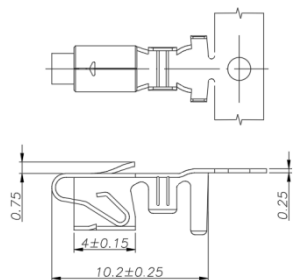

Housing XD-VHL-NY-X

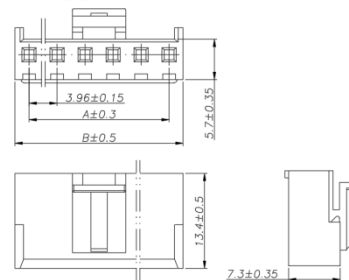

Wafer XD-VHL-NA-X

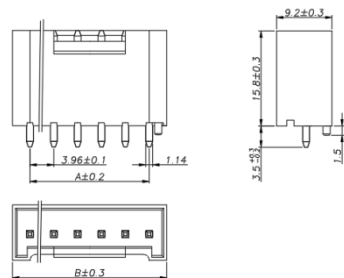

Housing

| 型号Type | 尺寸(mm) | |
|--------------|--------|-------|
| | A | B |
| XD-VHL-2Y-X | 3.96 | 7.92 |
| XD-VHL-3Y-X | 7.92 | 11.88 |
| XD-VHL-4Y-X | 11.88 | 15.84 |
| XD-VHL-5Y-X | 15.84 | 19.80 |
| XD-VHL-6Y-X | 19.80 | 23.76 |
| XD-VHL-7Y-X | 23.76 | 27.72 |
| XD-VHL-8Y-X | 27.72 | 31.68 |
| XD-VHL-15Y-X | 55.44 | 59.40 |

Wafer

| 型号Type | 尺寸(mm) | |
|--------------|--------|-------|
| | A | B |
| XD-VHL-2A-X | 3.96 | 8.80 |
| XD-VHL-3A-X | 7.92 | 13.76 |
| XD-VHL-4A-X | 11.88 | 17.72 |
| XD-VHL-5A-X | 15.84 | 21.68 |
| XD-VHL-6A-X | 19.80 | 25.64 |
| XD-VHL-7A-X | 23.76 | 29.60 |
| XD-VHL-8A-X | 27.72 | 33.56 |
| XD-VHL-15A-X | 55.44 | 61.28 |

主要技术特征 MAIN SPECIFICATIONS

间距 Pitch: 3.96mm

线数 Poles: 2~15

适用线规 APplicable Wire: AWG#18- #22

适用基板厚度 APplicable PC board thickness: 1.6mm

温度范围 Temperatuer Range: -25°C~ +85°C

额定电压 Voltage Rating: 250V AC, DC

额定电流 Current Rating: 7A AC, DC

接触电阻 Contract Resistance: 20mΩ Max

绝缘电阻 Insulation Resistance: 1000mΩ Min

耐压 Withstanding Voltang: 1500V

材料 MATERIAL

端子 Terminal: Phosphor bronz

孔座 Housing: Nylon66 UL94V-0

针座 Wafer: Nylon66 UL94V-0

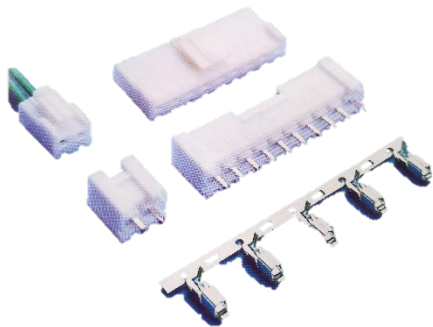

XD-VHH系列

- Terminal XD-VHL-T (共享型号)

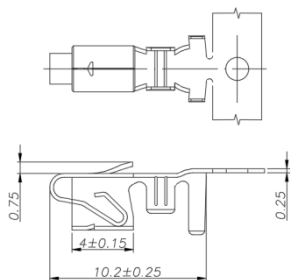

- Housing XD-VHL-NY-X (共享型号)

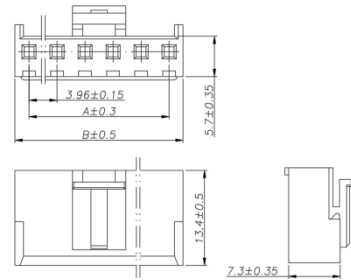

- Wafer XD-VHH-NA-X

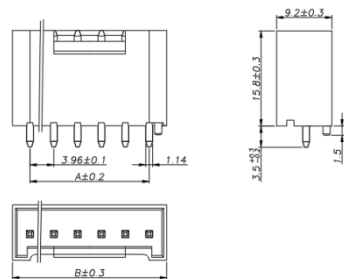

- Wafer XD-VHH-NAWD-X

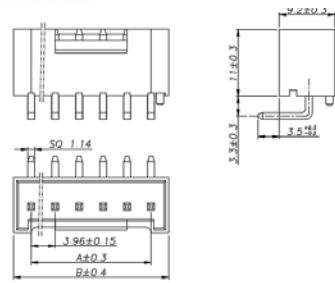

- Housing

- Wafer

| 型号Type | 尺寸(mm) | |
|--------------|--------|-------|
| | A | B |
| XD-VHL-2Y-X | 3.96 | 7.92 |
| XD-VHL-3Y-X | 7.92 | 11.88 |
| XD-VHL-4Y-X | 11.88 | 15.84 |
| XD-VHL-5Y-X | 15.84 | 19.80 |
| XD-VHL-6Y-X | 19.80 | 23.76 |
| XD-VHL-7Y-X | 23.76 | 27.72 |
| XD-VHL-8Y-X | 27.72 | 31.68 |
| XD-VHL-15Y-X | 55.44 | 59.40 |

| 型号Type | 尺寸(mm) | |
|------------------|--------|-------|
| | A | B |
| XD-VHH-2A/AWD-X | 3.96 | 9.80 |
| XD-VHH-3A/AWD-X | 7.92 | 13.76 |
| XD-VHH-4A/AWD-X | 11.88 | 17.72 |
| XD-VHH-5A/AWD-X | 15.84 | 21.68 |
| XD-VHH-6A/AWD-X | 19.80 | 25.64 |
| XD-VHH-7A/AWD-X | 23.76 | 29.60 |
| XD-VHH-8A/AWD-X | 27.72 | 33.56 |
| XD-VHH-17A/AWD-X | 63.36 | 69.20 |

4.20mm 系列

10

• 间距 PITCH: 4.20mm (64~67页)

4.20单、双排条形连接器 XD-5557 系列

4.20双排条形连接器 XD-5557R 系列

主要技术特征 MAIN SPECIFICATIONS

间距 Pitch: 4.20mm

线数 Poles: 2~24

适用线规 APPLICable Wire: AWG#20- #26

适用基板厚度 APPLICable PC board thickness: 1.6mm

温度范围 Temperatuer Range: -25°C~ +85°C

额定电压 Voltage Rating: 600V AC, DC

额定电流 Current Rating: 9A AC, DC

接触电阻 Contact Resistance: 20mΩ Max

绝缘电阻 Insulation Resistance: 1000mΩ Min

耐压 Withstanding Voltang: 1500V

材料 MATERIAL

端子 Terminal: Phosphor bronz

孔座 Housing: Nylon66 UL94V-0

针座 Wafer: Nylon66 UL94V-0



XD-5557 系列 (1)

● Terminal XD-5557-T

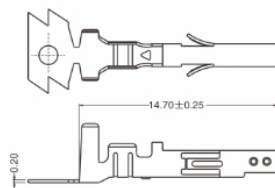

● Terminal XD-5557-PT

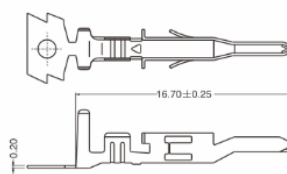

● Housing XD-5557-NY

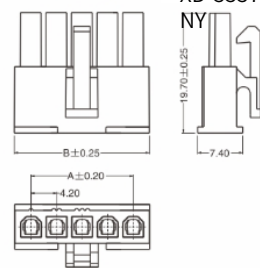

● Housing XD-5557-EY

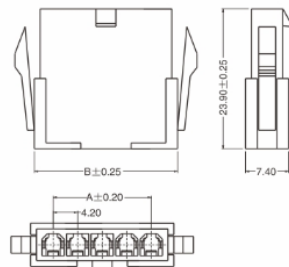

● Wafer XD-5557-NA

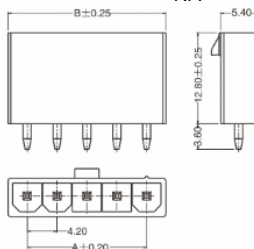

● Wafer XD-5557-NAW

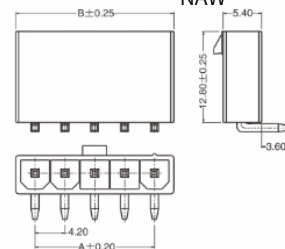

● Housing

| 型号Type | 尺寸 (mm) | |
|------------------|---------|-------|
| | A | B |
| XD-5557-2/2*2Y | 4.20 | 9.60 |
| XD-5557-3/2*3Y | 8.40 | 13.80 |
| XD-5557-4/2*4Y | 12.60 | 18.00 |
| XD-5557-12/2*12Y | 46.20 | 51.60 |

● Housing

| 型号Type | 尺寸 (mm) | |
|-------------------|---------|-------|
| | A | B |
| XD-5557-2/2*2EY | 4.20 | 11.80 |
| XD-5557-3/2*3EY | 8.40 | 16.00 |
| XD-5557-4/2*4EY | 12.60 | 20.20 |
| XD-5557-12/2*12EY | 46.20 | 53.80 |

主要技术特征 MAIN SPECIFICATIONS

间距 Pitch: 4.20mm

线数 Poles: 2~24

适用线规 APPLICable Wire: AWG#20- #26

适用基板厚度 APPLICable PC board thickness: 1.6mm

温度范围 Temperatuer Range: -25°C~ +85°C

额定电压 Voltage Rating: 600V AC, DC

额定电流 Current Rating: 9A AC, DC

接触电阻 Contract Resistance: 20mΩ Max

绝缘电阻 Insulation Resistance: 1000mΩ Min

耐压 Withstanding Voltang: 1500V

材料 MATERIAL

端子 Terminal: Phosphor bronz

孔座 Housing: Nylon66 UL94V-0

针座 Wafer: Nylon66 UL94V-0



XD-5557 系列 (2)

● Housing

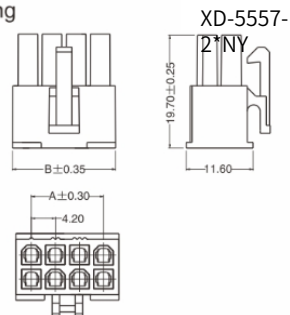

● Housing

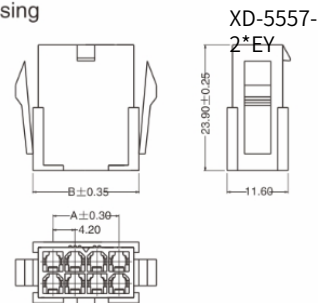

● Wafer

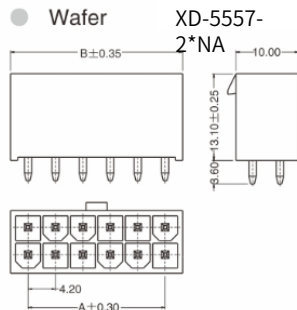

● Wafer

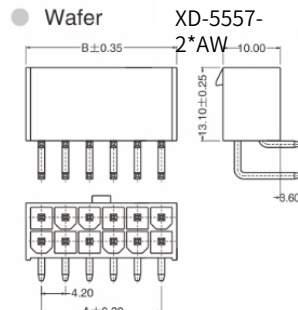

● Wafer

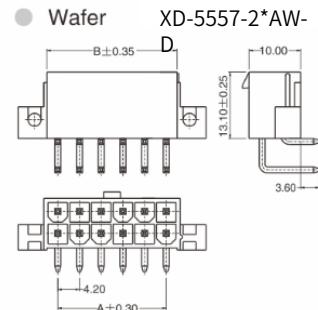

● Wafer

| 型号 Type | 尺寸 (mm) | |
|------------|---------|-------|
| | A | B |
| XD-5557-2A | 4.20 | 9.60 |
| XD-5557-3A | 8.40 | 13.80 |
| XD-5557-4A | 12.60 | 18.00 |
| XD-5557-5A | 16.80 | 22.20 |

● Wafer

| 型号 Type | 尺寸 (mm) | |
|-------------------------|---------|-------|
| | A | B |
| XD-5557-2*2A/ AW/ AW-D | 4.20 | 9.60 |
| XD-5557-2*3A/ AW/ AW-D | 8.40 | 13.80 |
| XD-5557-2*4A/ AW/ AW-D | 12.60 | 18.00 |
| XD-5557-2*5A/ AW/ AW-D | 16.80 | 22.20 |
| XD-5557-2*6A/ AW/ AW-D | 21.00 | 26.40 |
| XD-5557-2*12A/ AW/ AW-D | 46.20 | 51.60 |

主要技术特征 MAIN SPECIFICATIONS

间距 Pitch: 4.20mm

线数 Poles: 2~24

适用线规 APPLICable Wire: AWG#20- #26

适用基板厚度 APPLICable PC board thickness: 1.6mm

温度范围 Temperatuer Range: -25°C~ +85°C

额定电压 Voltage Rating: 300V AC, DC

额定电流 Current Rating: 9A AC, DC

接触电阻 Contract Resistance: 20mΩ Max

绝缘电阻 Insulation Resistance: 1000mΩ Min

耐压 Withstanding Voltang: 1500V

材料 MATERIAL

端子 Terminal: Phosphor bronz

孔座 Housing: Nylon66 UL94V-0

针座 Wafer: Nylon66 UL94V-0

XD-5557R 防水款 系列 (1)

Terminal XD-5557R-T-05

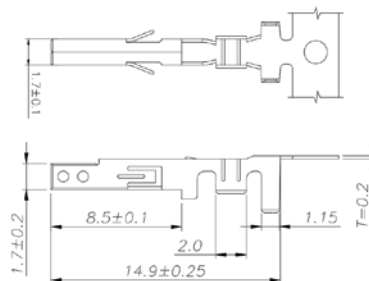

Housing XD-5557R-2xNYF-05

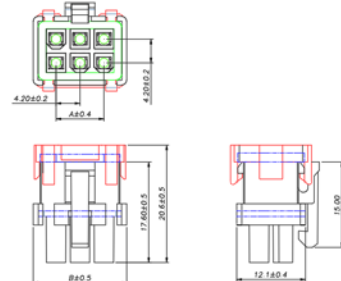

Wafer XD-5557R-2xNA-05

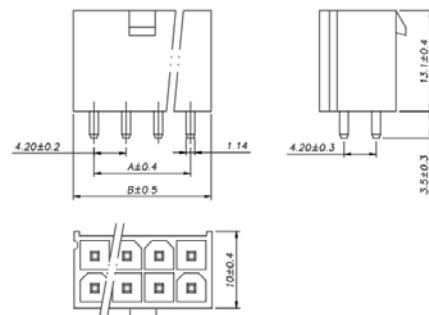

Housing

| 型号Type | 尺寸(mm) | |
|----------------------|--------|-------|
| | A | B |
| XD-5557R-2x1YF-X-05 | | 8.00 |
| XD-5557R-2x2YF-X-05 | 4.20 | 12.20 |
| XD-5557R-2x3YF-X-05 | 8.40 | 16.40 |
| XD-5557R-2x4YF-X-05 | 12.60 | 20.60 |
| XD-5557R-2x12YF-X-05 | 46.20 | 54.20 |

Wafer

| 型号Type | 尺寸(mm) | |
|---------------------|--------|-------|
| | A | B |
| XD-5557R-2x1A-X-05 | | 5.40 |
| XD-5557R-2x2A-X-05 | 4.20 | 9.60 |
| XD-5557R-2x3A-X-05 | 8.40 | 13.80 |
| XD-5557R-2x4A-X-05 | 12.60 | 18.00 |
| XD-5557R-2x12A-X-05 | 46.20 | 51.60 |

5.00mm 系列

11

• 间距 PITCH: 5.00mm (68~70页)

5.00单排条形连接器 XD-5003 系列

5.00单排条形连接器 XD-C2 系列

主要技术特征 MAIN SPECIFICATIONS

间距 Pitch: 5.00mm

线数 Poles: 2~12

适用线规 APPLICable Wire: AWG#16- #22

适用基板厚度 APPLICable PC board thickness: 1.6mm

温度范围 Temperatuer Range: -25°C~ +85°C

额定电压 Voltage Rating: 250V AC, DC

额定电流 Current Rating: 10A AC, DC

接触电阻 Contract Resistance: 20mΩ Max

绝缘电阻 Insulation Resistance: 1000mΩ Min

耐压 Withstanding Voltang: 1500V

材料 MATERIAL

端子 Terminal: Phosphor bronz

孔座 Housing: Nylon66 UL94V-0

针座 Wafer: Nylon66 UL94V-0

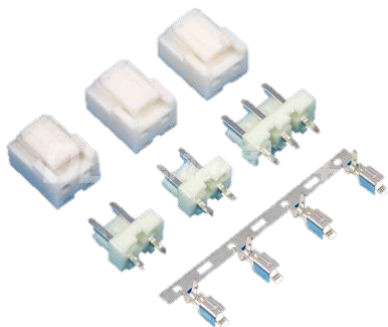

XD-5003系列

Terminal XD-5003-T

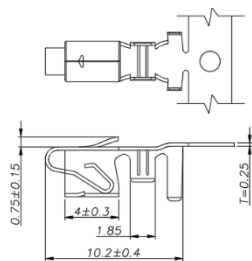

Housing XD-5003-NY

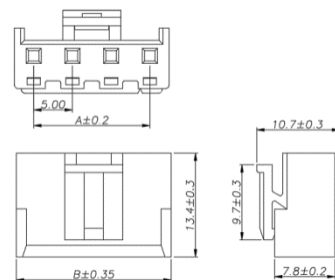

Wafer XD-5003-NA

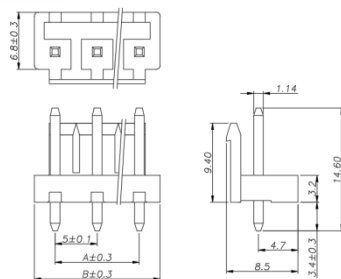

Wafer XD-5003-NAW-G

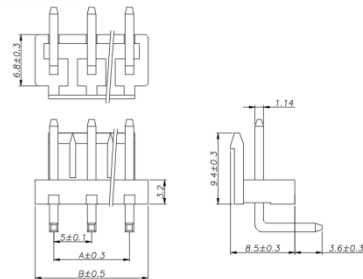

Housing

| 型号Type | 尺寸(mm) | |
|-------------|--------|-------|
| | A | B |
| XD-5003-2Y | 5.00 | 10.00 |
| XD-5003-3Y | 10.00 | 15.00 |
| XD-5003-4Y | 15.00 | 20.00 |
| XD-5003-5Y | 20.00 | 25.00 |
| XD-5003-6Y | 25.00 | 30.00 |
| XD-5003-7Y | 30.00 | 35.00 |
| XD-5003-8Y | 35.00 | 40.00 |
| XD-5003-12Y | 55.00 | 60.00 |

Wafer

| 型号Type | 尺寸(mm) | |
|------------------|--------|-------|
| | A | B |
| XD-5003-2A/AW-G | 5.00 | 10.00 |
| XD-5003-3A/AW-G | 10.00 | 15.00 |
| XD-5003-4A/AW-G | 15.00 | 20.00 |
| XD-5003-5A/AW-G | 20.00 | 25.00 |
| XD-5003-6A/AW-G | 25.00 | 30.00 |
| XD-5003-7A/AW-G | 30.00 | 35.00 |
| XD-5003-8A/AW-G | 35.00 | 40.00 |
| XD-5003-12A/AW-G | 55.00 | 60.00 |

主要技术特征 MAIN SPECIFICATIONS

间距 Pitch: 5.00mm

线数 Poles: 2~6

适用线规 APPLICable Wire: AWG#20- #26

适用基板厚度 APPLICable PC board thickness: 1.6mm

温度范围 Temperatuer Range: -25°C~ +85°C

额定电压 Voltage Rating: 250V AC, DC

额定电流 Current Rating: 4A AC, DC

接触电阻 Contact Resistance: 10mΩ Max

绝缘电阻 Insulation Resistance: 1000mΩ Min

耐压 Withstanding Voltang: 1500V

材料 MATERIAL

端子 Terminal: Phosphor bronz

孔座 Housing: Nylon66 UL94V-0

针座 Wafer: PBT UL94V-0

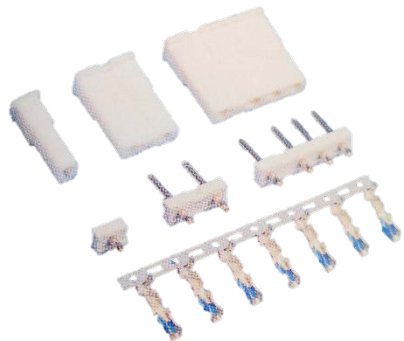

XD-C2系列

● Terminal XD-C2-T-05

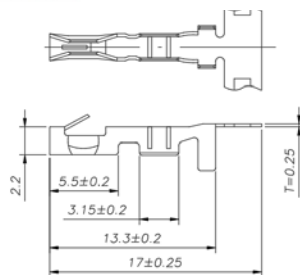

● Housing XD-C2-NY-05

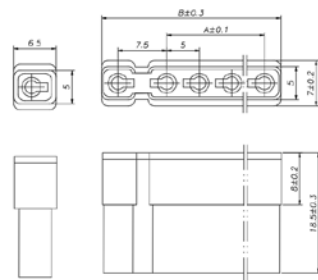

● Wafer XD-C2-NA-05

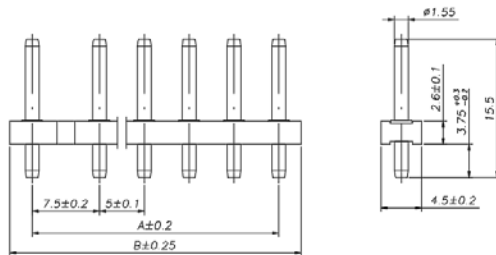

● Housing

| 型号Type | 尺寸(mm) | |
|---------------|--------|-------|
| | A | B |
| XD-C2-2Y-X-05 | ----- | 12.80 |
| XD-C2-3Y-X-05 | 5.00 | 17.80 |
| XD-C2-4Y-X-05 | 10.00 | 22.80 |
| XD-C2-5Y-X-05 | 15.00 | 27.80 |
| XD-C2-6Y-X-05 | 20.00 | 32.80 |

● Wafer

| 型号Type | 尺寸(mm) | |
|---------------|--------|-------|
| | A | B |
| XD-C2-2A-X-05 | 7.50 | 12.50 |
| XD-C2-3A-X-05 | 12.50 | 17.50 |
| XD-C2-4A-X-05 | 17.50 | 22.50 |
| XD-C2-5A-X-05 | 22.50 | 27.50 |
| XD-C2-6A-X-05 | 27.50 | 32.50 |

5.08mm 系列

12

• 间距 PITCH: 5.08mm (71~76页)

5.08单排条形连接器 XD-5.08 系列

5.08单排条形连接器 XD-C5080 系列

5.08单排条形连接器 XD-5083 系列

5.08双排条形连接器 XD-5084 系列

主要技术特征 MAIN SPECIFICATIONS

间距 Pitch: 5.08mm

线数 Poles: 2~20

适用线规 APPLICable Wire: AWG#18- #24

适用基板厚度 APPLICable PC board thickness: 1.6mm

温度范围 Temperatuer Range: -25°C~ +85°C

额定电压 Voltage Rating: 250V AC, DC

额定电流 Current Rating: 7A AC, DC

接触电阻 Contract Resistance: 20mΩ Max

绝缘电阻 Insulation Resistance: 1000mΩ Min

耐压 Withstanding Voltang: 1500V

XD-5.08系列

● Terminal

XD-5.08-T

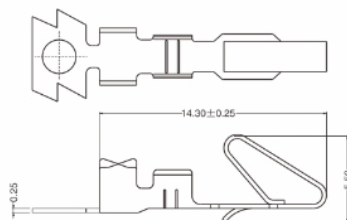

● Housing

XD-5.08-Y

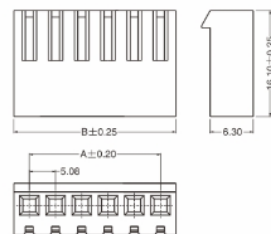

● Wafer

XD-5.08-NA

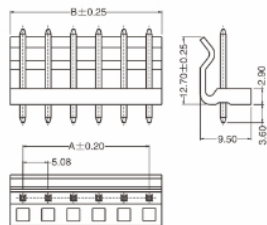

● Wafer

XD-5.08-NAW

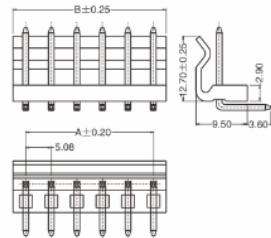

● Wafer

XD-5.08-NAW-G

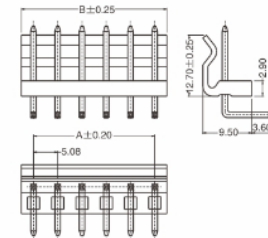

材料 MATERIAL

端子 Terminal: Phosphor bronz

孔座 Housing: Nylon66 UL94V-0

针座 Wafer: Nylon66 UL94V-0



● Housing

| 型号Type | 尺寸 (mm) | |
|-------------|---------|--------|
| | A | B |
| XD-5.08-2Y | 5.08 | 9.60 |
| XD-5.08-3Y | 10.16 | 14.68 |
| XD-5.08-4Y | 15.24 | 19.76 |
| XD-5.08-5Y | 20.32 | 24.84 |
| XD-5.08-6Y | 25.40 | 29.92 |
| XD-5.08-7Y | 30.48 | 35.00 |
| XD-5.08-8Y | 35.56 | 40.08 |
| XD-5.08-20Y | 96.52 | 101.04 |

● Wafer

| 型号Type | 尺寸 (mm) | |
|---------------------|---------|-------|
| | A | B |
| XD-5.08-2A/AW/AW-G | 5.08 | 10.16 |
| XD-5.08-3A/AW/AW-G | 10.16 | 15.24 |
| XD-5.08-4A/AW/AW-G | 15.24 | 20.32 |
| XD-5.08-5A/AW/AW-G | 20.32 | 25.40 |
| XD-5.08-6A/AW/AW-G | 25.40 | 30.48 |
| XD-5.08-7A/AW/AW-G | 30.48 | 35.56 |
| XD-5.08-8A/AW/AW-G | 35.56 | 40.64 |
| XD-5.08-20A/AW/AW-G | 96.52 | 101.6 |

主要技术特征 MAIN SPECIFICATIONS

间距 Pitch: 5.08mm

线数 Poles: 2~8

适用线规 APPLICable Wire: AWG#18- #24

适用基板厚度 APPLICable PC board thickness: 1.6mm

温度范围 Temperatuer Range: -25°C~ +85°C

额定电压 Voltage Rating: 250V AC, DC

额定电流 Current Rating: 10A AC, DC

接触电阻 Contract Resistance: 20mΩ Max

绝缘电阻 Insulation Resistance: 1000mΩ Min

耐压 Withstanding Voltang: 1500V

材料 MATERIAL

端子 Terminal: Phosphor bronz

孔座 Housing: Nylon66 UL94V-0

针座 Wafer: Nylon66 UL94V-0



XD-C5080系列 (1)

● Terminal XD-C5080-T (母端)

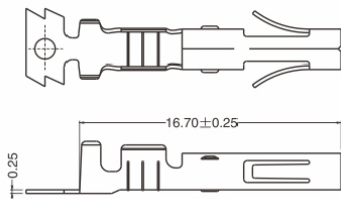

● Terminal XD-C5080-PT (公端)

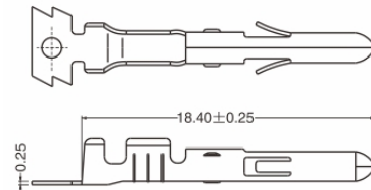

● Housing XD-C5080-NY (公)

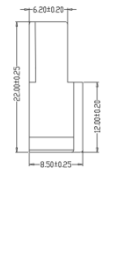
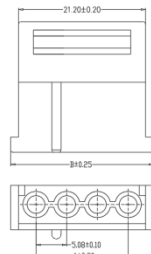

● Housing XD-C5080-NEY(母)



● Housing XD-C5080-NDY (公)

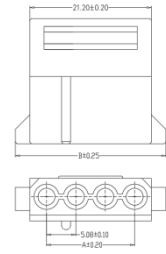

● Wafer XD-C5080-NA (实心带点)

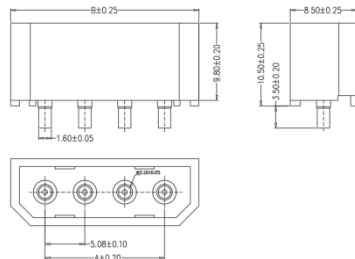

● Wafer XD-C5080-NAR (空心带齿)

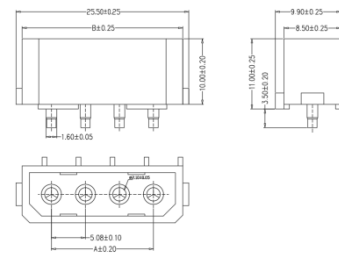

主要技术特征 MAIN SPECIFICATIONS

间距 Pitch: 5.08mm

线数 Poles: 2~8

适用线规 APPLICable Wire: AWG#18- #24

适用基板厚度 APPLICable PC board thickness: 1.6mm

温度范围 Temperatuer Range: -25°C~ +85°C

额定电压 Voltage Rating: 250V AC, DC

额定电流 Current Rating: 10A AC, DC

接触电阻 Contract Resistance: 20mΩ Max

绝缘电阻 Insulation Resistance: 1000mΩ Min

耐压 Withstanding Voltang: 1500V

材料 MATERIAL

端子 Terminal: Phosphor bronz

孔座 Housing: Nylon66 UL94V-0

针座 Wafer: Nylon66 UL94V-0



XD-C5080系列 (2)

● Wafer XD-C5080-NAS (空心带边)

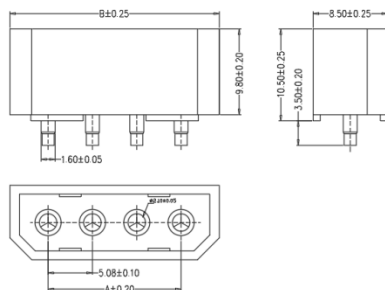

● Wafer XD-C5080-NAW

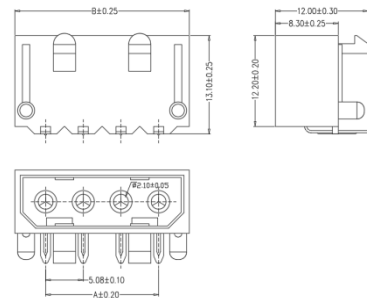

● Wafer XD-C5080-2xNA (空心)

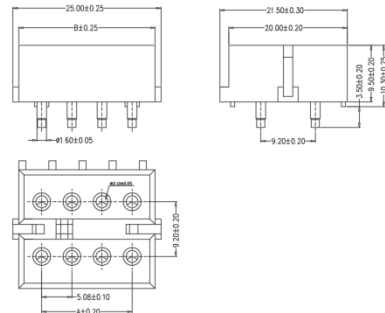

● Housing XD-C5080-2xNY

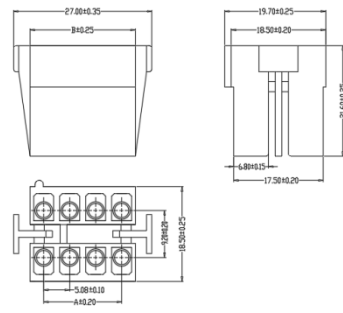

● Housina

| 型号Type | 尺寸(mm) | | |
|-------------------|--------|-------------------|--|
| | A | B | |
| XD-C5080-2Y/EY/DY | 5.08 | 13.44/13.12/16.04 | |
| XD-C5080-3Y/EY/DY | 10.16 | 18.52/20.20/21.12 | |
| XD-C5080-4Y/EY/DY | 15.24 | 23.60/23.28/26.20 | |

| 型号Type | 尺寸(mm) | |
|---------------|--------|-------|
| | A | B |
| XD-05C80-2x2Y | 5.08 | 10.44 |
| XD-05C80-2x3Y | 10.16 | 15.62 |
| XD-05C80-2x4Y | 15.24 | 20.60 |

● Wafer

| 型号Type | 尺寸(mm) | |
|----------------------|--------|-------|
| | A | B |
| XD-C5080-2A/AR/AS/AI | 5.08 | 13.34 |
| XD-C5080-3A/AR/AS/AI | 10.16 | 18.42 |
| XD-C5080-4A/AR/AS/AI | 15.24 | 23.50 |

| 型号Type | 尺寸mm | |
|---------------|-------|-------|
| | A | B |
| XD-C5080-22A | 5.08 | 12.84 |
| XD-C5080-2m3A | 10.16 | 17.92 |
| XD-C5080-2x4A | 15.24 | 23.00 |

主要技术特征 MAIN SPECIFICATIONS

间距 Pitch: 5.08mm

线数 Poles: 2~12

适用线规 APPLICable Wire: AWG#16- #22

适用基板厚度 APPLICable PC board thickness: 1.6mm

温度范围 Temperatuer Range: -25°C~ +85°C

额定电压 Voltage Rating: 600V AC, DC

额定电流 Current Rating: 15A AC, DC

接触电阻 Contract Resistance: 10mΩ Max

绝缘电阻 Insulation Resistance: 1000mΩ Min

耐压 Withstanding Voltang: 2200V

材料 MATERIAL

端子 Terminal: Phosphor bronz

孔座 Housing: PBT UL94V-0

针座 Wafer: PBT UL94V-0



XD-5083系列

Terminal XD-5083-T-05

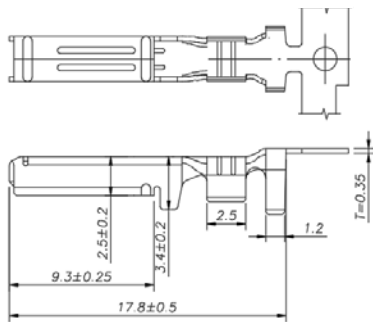

Housing XD-5083-NY-05

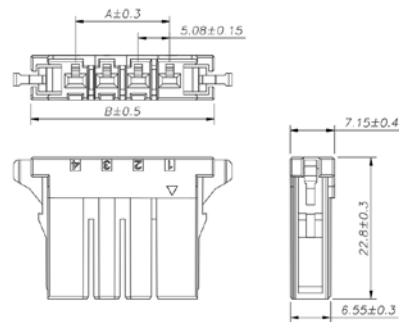

Wafer XD-5083-NA-05

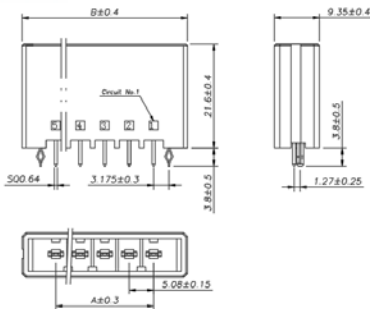

Wafer XD-5083-NAW-05

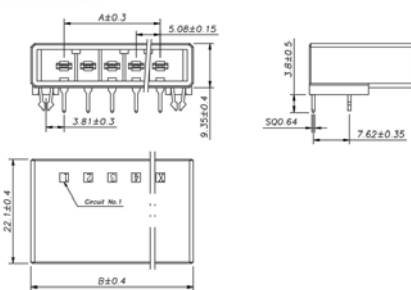

Housing

| 型号Type | 尺寸(mm) | |
|------------------|--------|-------|
| | A | B |
| XD-5083-2Y-X-05 | 5.08 | 19.02 |
| XD-5083-3Y-X-05 | 10.16 | 24.10 |
| XD-5083-4Y-X-05 | 15.24 | 29.18 |
| XD-5083-12Y-X-05 | 55.88 | 69.82 |

Wafer

| 型号Type | 尺寸(mm) | |
|---------------------|--------|-------|
| | A | B |
| XD-5083-2A/2AW-X-05 | 5.08 | 19.02 |
| XD-5083-2A/2AW-X-05 | 10.16 | 24.10 |
| XD-5083-2A/2AW-X-05 | 15.24 | 29.18 |
| XD-5083-2A/2AW-X-05 | 55.88 | 69.82 |

主要技术特征 MAIN SPECIFICATIONS

间距 Pitch: 5.08mm

线数 Poles: 2~12

适用线规 APPLICable Wire: AWG#16- #22

适用基板厚度 APPLICable PC board thickness: 1.6mm

温度范围 Temperatuer Range: -25°C~ +85°C

额定电压 Voltage Rating: 600V AC, DC

额定电流 Current Rating: 15A AC, DC

接触电阻 Contract Resistance: 10mΩ Max

绝缘电阻 Insulation Resistance: 1000mΩ Min

耐压 Withstanding Voltang: 2200V

XD-5084系列

● Terminal XD-5084-T-05

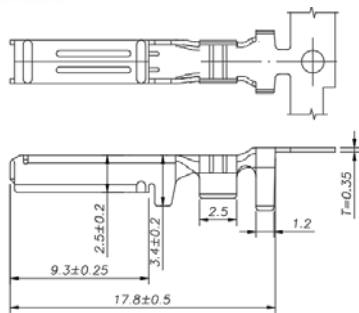

● Terminal XD-5084-PT-05

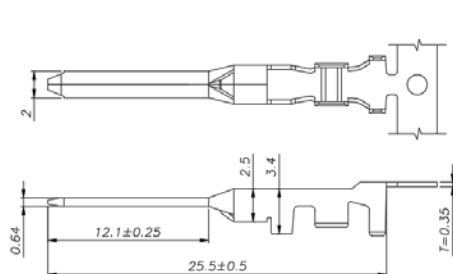

● Housing XD-5084-2xNY-05

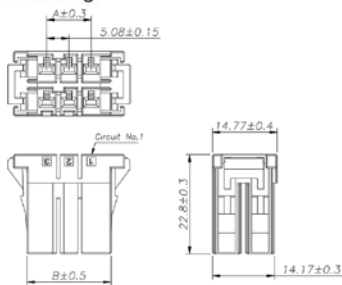

● Housing XD-5084-2xNSY-05

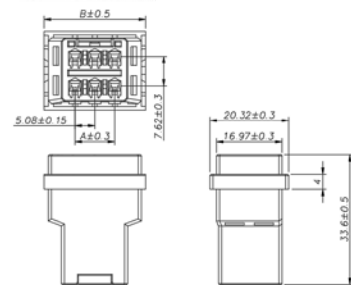

● Housing XD-5084-2xNEY-05

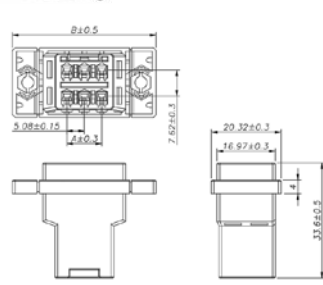

● Housing

| 型号Type | 尺寸 (mm) | |
|--------------------|---------|-------|
| | A | B |
| XD-5084-2x2Y-X-05 | 5.08 | 14.16 |
| XD-5084-2x3Y-X-05 | 10.16 | 19.24 |
| XD-5084-2x4Y-X-05 | 15.24 | 24.32 |
| XD-5084-2x12Y-X-05 | 55.88 | 64.96 |

| 型号Type | 尺寸 (mm) | |
|---------------------|---------|-------|
| | A | B |
| XD-5084-2x2SY-X-05 | 5.08 | 21.84 |
| XD-5084-2x3SY-X-05 | 10.16 | 26.92 |
| XD-5084-2x4SY-X-05 | 15.24 | 32.00 |
| XD-5084-2x12SY-X-05 | 55.88 | 72.64 |

| 型号Type | 尺寸 (mm) | |
|---------------------|---------|-------|
| | A | B |
| XD-5084-2x2EY-X-05 | 5.08 | 36.83 |
| XD-5084-2x3EY-X-05 | 10.16 | 41.91 |
| XD-5084-2x4EY-X-05 | 15.24 | 46.99 |
| XD-5084-2x12EY-X-05 | 55.88 | 87.63 |

材料 MATERIAL

端子 Terminal: Phosphor bronz

孔座 Housing: PBT UL94V-0

针座 Wafer: PBT UL94V-0



6.20mm 系列

- 13 • 间距 PITCH: 6.20mm (77~79页)
6.20单、双排条形连接器 XD-C6200 系列

主要技术特征 MAIN SPECIFICATIONS

间距 Pitch: 6.20mm

线数 Poles: 2~6

适用线规 APPLICABLE WIRE: AWG#12- #20

温度范围 Temperaturer Range: -25°C~ +85°C

额定电压 Voltage Rating: 600V AC, DC

额定电流 Current Rating: 20A AC, DC

接触电阻 Contact Resistance: 20mΩ Max

绝缘电阻 Insulation Resistance: 1000mΩ Min

耐压 Withstanding Voltang: 2000V

XD-C6200系列 (1)

● Terminal XD-C6200-T-05

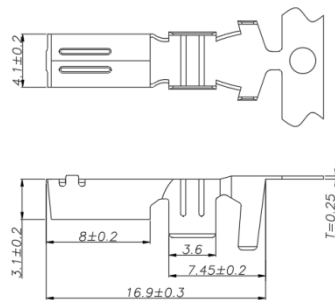

● Terminal XD-C6200-PT-05

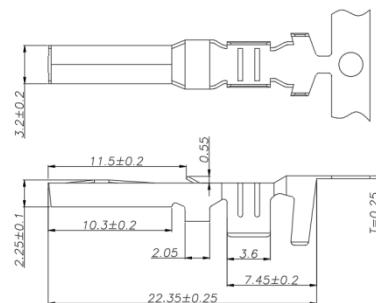

● Housing XD-C6200-NY-05

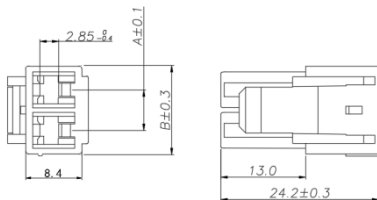

● Housing XD-C6200-NEY-05

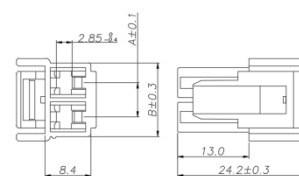

● Housing XD-C6200-NSY-05

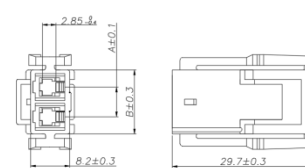

● Housing XD-C6200-2xNY-05

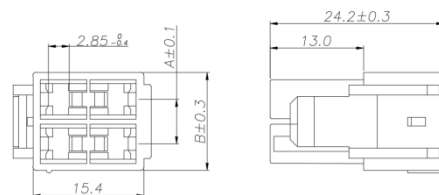

● Housing XD-C6200-2xNEY-05

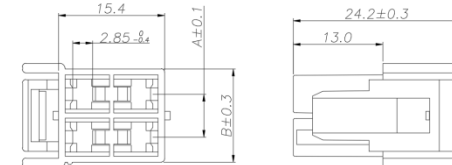

材料 MATERIAL

端子 Terminal: Phosphor bronz

孔座 Housing: Nylon66 UL94V-0



主要技术特征 MAIN SPECIFICATIONS

间距 Pitch: 6.20mm

线数 Poles: 2~6

适用线规 APPLICABLE WIRE: AWG#12- #20

温度范围 Temperature Range: -25°C~ +85°C

额定电压 Voltage Rating: 600V AC, DC

额定电流 Current Rating: 20A AC, DC

接触电阻 Contact Resistance: 20mΩ Max

绝缘电阻 Insulation Resistance: 1000mΩ Min

耐压 Withstanding Voltage: 2000V

材料 MATERIAL

端子 Terminal: Phosphor bronze

孔座 Housing: Nylon66 UL94V-0



XD-C6200系列 (2)

- Housing XD-C6200-2xNSY-05

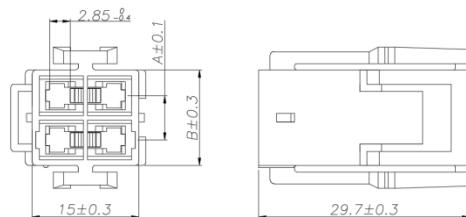

- Housing XD-C6200-1S-05

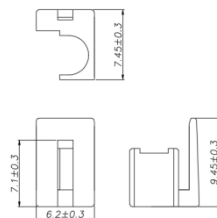

- Housing XD-C6200-NS-05

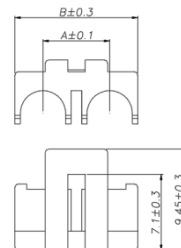

- Housing

- Housing

- Housing

| 型号Type | 尺寸(mm) | |
|----------------------|--------|-------|
| | A | B |
| XD-C6200-2Y/EY/SY-05 | 6.20 | 13.40 |
| XD-C6200-3Y/EY/SY-05 | 12.40 | 19.60 |
| XD-C6200-4Y/EY/SY-05 | 18.60 | 25.80 |

| 型号Type | 尺寸(mm) | |
|-------------------|--------|-------|
| | A | B |
| XD-C6200-2x2EY-05 | 6.20 | 13.40 |
| XD-C6200-2x3EY-05 | 12.40 | 19.60 |
| XD-C6200-2x4EY-05 | 18.60 | 25.80 |

| 型号Type | 尺寸(mm) | |
|----------------|--------|-------|
| | A | B |
| XD-C6200-2S-05 | 6.20 | 11.40 |
| XD-C6200-3S-05 | 12.40 | 17.60 |
| XD-C6200-4S-05 | 18.60 | 23.80 |

6.35mm 系列

14

• 间距 PITCH: 6.35mm (80~82页)

6.35单排条形连接器 XD-C6350 系列

主要技术特征 MAIN SPECIFICATIONS

间距 Pitch: 6.35mm

线数 Poles: 2~8

适用线规 APPLICable Wire: AWG#14- #24

适用基板厚度 APPLICable PC board thickness: 1.6mm

温度范围 Temperatuer Range: -25°C~ +85°C

额定电压 Voltage Rating: 600V AC, DC

额定电流 Current Rating: 15A AC, DC

接触电阻 Contract Resistance: 20mΩ Max

绝缘电阻 Insulation Resistance: 1000mΩ Min

耐压 Withstanding Voltang: 1500V

材料 MATERIAL

端子 Terminal: Phosphor bronz

孔座 Housing: Nylon66 UL94V-0

针座 Wafer: Nylon66 UL94V-0



XD-C6350系列 (1)

● Terminal XD-C6350-T

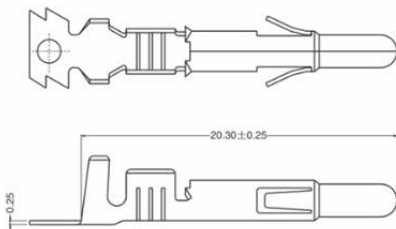

● Terminal XD-C6350-PT

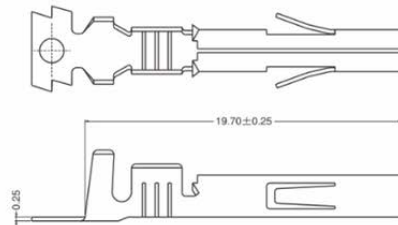

● Housing XD-C6350-NY

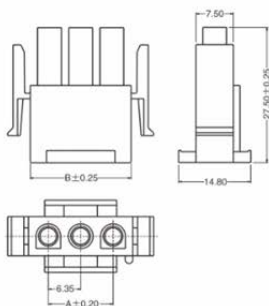

● Housing XD-C6350-3xNY

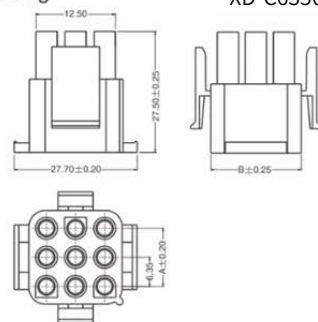

主要技术特征 MAIN SPECIFICATIONS

间距 Pitch: 6.35mm

线数 Poles: 2~8

适用线规 APplicable Wire: AWG#14- #24

适用基板厚度 APplicable PC board thickness: 1.6mm

温度范围 Temperatuer Range: -25°C~ +85°C

额定电压 Voltage Rating: 600V AC, DC

额定电流 Current Rating: 15A AC, DC

接触电阻 Contract Resistance: 20mΩ Max

绝缘电阻 Insulation Resistance: 1000mΩ Min

耐压 Withstanding Voltang: 1500V

材料 MATERIAL

端子 Terminal: Phosphor bronz

孔座 Housing: Nylon66 UL94V-0

针座 Wafer: Nylon66 UL94V-0



XD-C6350系列 (2)

● Housing

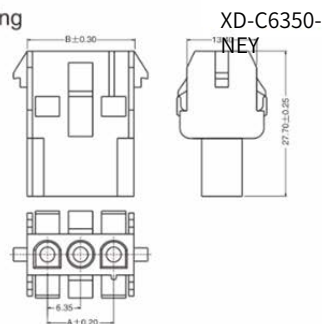

● Housing

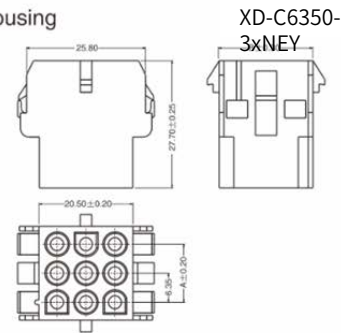

● Wafer

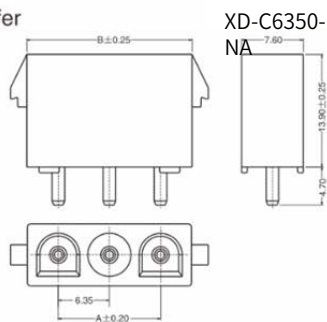

● Wafer

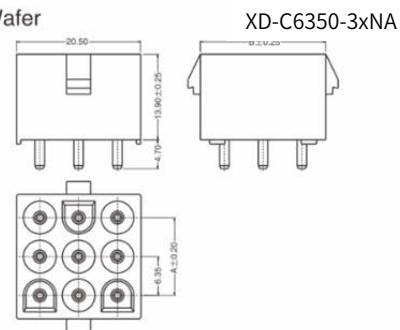

● Housing

| 型号Type | 尺寸 (mm) | |
|----------------|---------|-------|
| | A | B |
| XD-C6350-2V/EY | 8.35 | 14.20 |
| XD-C6350-3V/EY | 12.70 | 20.55 |
| XD-C6350-4V/EY | 19.05 | 26.90 |
| XD-C6350-5V/EY | 25.40 | 33.25 |
| XD-C6350-6V/EY | 31.75 | 39.60 |
| XD-C6350-7V/EY | 38.10 | 45.95 |
| XD-C6350-8V/EY | 44.45 | 52.30 |

| 型号Type | 尺寸 (mm) | |
|------------------|---------|-------|
| | A | B |
| XD-C6350-3x2V/EY | 8.35 | 14.20 |
| XD-C6350-3x3V/EY | 12.70 | 20.55 |
| XD-C6350-3x4V/EY | 19.05 | 26.90 |
| XD-C6350-3x5V/EY | 25.40 | 33.25 |

● Wafer

| 型号Type | 尺寸 (mm) | |
|-------------|---------|-------|
| | A | B |
| XD-C6350-2A | 6.35 | 14.20 |
| XD-C6350-3A | 12.70 | 20.55 |
| XD-C6350-4A | 19.05 | 26.90 |
| XD-C6350-5A | 25.40 | 33.25 |
| XD-C6350-6A | 31.75 | 39.60 |
| XD-C6350-7A | 38.10 | 45.95 |
| XD-C6350-8A | 44.45 | 52.30 |

| 型号Type | 尺寸 (mm) | |
|---------------|---------|-------|
| | A | B |
| XD-C6350-3x2A | 6.35 | 14.20 |
| XD-C6350-3x3A | 12.70 | 20.55 |
| XD-C6350-3x4A | 19.05 | 26.90 |
| XD-C6350-3x5A | 25.40 | 33.25 |

8.00mm 系列

15

• 间距 PITCH: 8.00mm (83~84页)

8.00单排条形连接器 XD-8001 系列

主要技术特征 MAIN SPECIFICATIONS

间距 Pitch: 8.00mm

线数 Poles: 1~3

适用线规 APPLICable Wire: AWG#18- #24

温度范围 Temperatuer Range: -25°C~ +85°C

额定电压 Voltage Rating: 250V AC, DC

额定电流 Current Rating: 7A AC, DC

接触电阻 Contract Resistance: 20mΩ Max

绝缘电阻 Insulation Resistance: 1000mΩ Min

耐压 Withstanding Voltang: 1000V

材料 MATERIAL

端子 Terminal: Phosphor bronz

孔座 Housing: Nylon66 UL94V-0

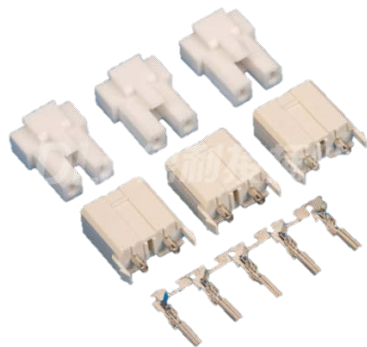

XD-8001系列

Terminal XD-8001-T-05

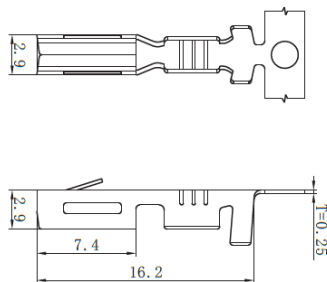

Housing XD-8001-NY-05

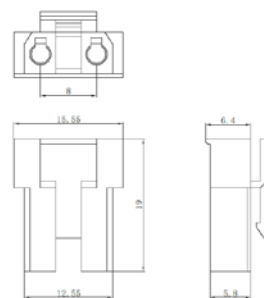

Wafer XD-8001-NA-05

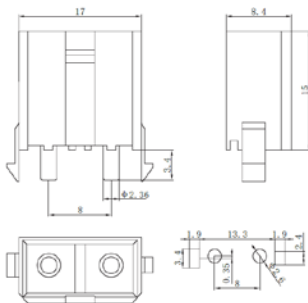

10.16mm 系列

16

• 间距 PITCH: 10.16mm (85~88页)

10.16单排条形连接器 XD-10.16 系列

10.16双排条形连接器 XD-10.16 系列

主要技术特征 MAIN SPECIFICATIONS

间距 Pitch: 10.16mm

线数 Poles: 1~3

适用线规 APPLICABLE WIRE: AWG#18- #24

温度范围 Temperatuer Range: -25°C~ +85°C

额定电压 Voltage Rating: 250V AC, DC

额定电流 Current Rating: 7A AC, DC

接触电阻 Contract Resistance: 20mΩ Max

绝缘电阻 Insulation Resistance: 1000mΩ Min

耐压 Withstanding Voltang: 1000V

材料 MATERIAL

端子 Terminal: Phosphor bronz

孔座 Housing: Nylon66 UL94V-0

针座 Wafer: PBT UL94V-0



XD-10.16 单排 系列 (1)

● Terminal XD-10.16-T-05

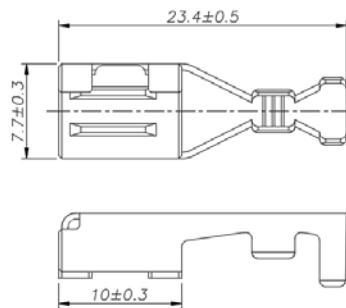

● Terminal XD-10.16-PT-05

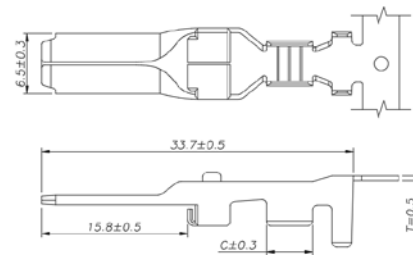

● Housing XD-10.16-NY-05

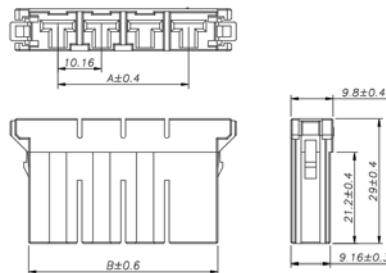

● Housing XD-10.16-NEY-05

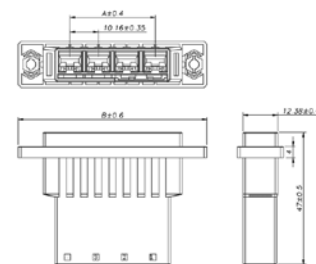

主要技术特征 MAIN SPECIFICATIONS

间距 Pitch: 10.16mm

线数 Poles: 1~3

适用线规 APPLICABLE WIRE: AWG#18- #24

温度范围 Temperatur Range: -25°C~ +85°C

额定电压 Voltage Rating: 250V AC, DC

额定电流 Current Rating: 7A AC, DC

接触电阻 Contact Resistance: 20mΩ Max

绝缘电阻 Insulation Resistance: 1000mΩ Min

耐压 Withstanding Voltang: 1000V

材料 MATERIAL

端子 Terminal: Phosphor bronz

孔座 Housing: Nylon66 UL94V-0

针座 Wafer: PBT UL94V-0

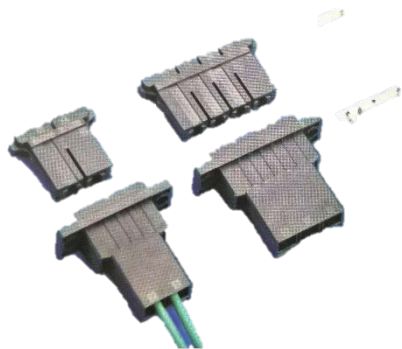

XD-10.16 单排 系列 (2)

● Wafer XD-10.16-NA-05

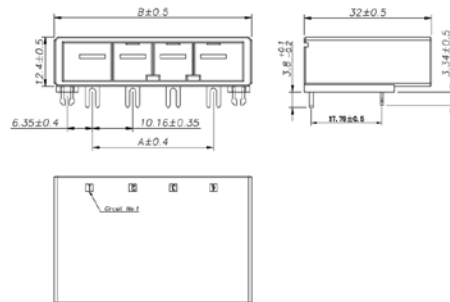

● Wafer XD-10.16-NAW-05

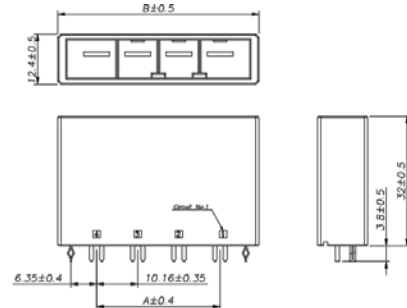

● Housing

| 型号Type | 尺寸(mm) | |
|---------------------|--------|---------------|
| | A | B |
| XD-10.16-2Y/EY-X-05 | 10.16 | 23.76 / 47.00 |
| XD-10.16-3Y/EY-X-05 | 20.32 | 33.92 / 57.16 |
| XD-10.16-4Y/EY-X-05 | 30.48 | 44.08 / 67.32 |
| XD-10.16-5Y/EY-X-05 | 40.64 | 54.24 / 77.48 |
| XD-10.16-6Y/EY-X-05 | 50.80 | 64.40 / 87.64 |

● Wafer

| 型号Type | 尺寸(mm) | |
|-------------------|--------|-------|
| | A | B |
| XD-10.16-2A/AW-05 | 10.16 | 29.36 |
| XD-10.16-3A/AW-05 | 20.32 | 39.52 |
| XD-10.16-4A/AW-05 | 30.48 | 49.68 |
| XD-10.16-5A/AW-05 | 40.64 | 59.84 |
| XD-10.16-6A/AW-05 | 50.80 | 70.00 |

主要技术特征 MAIN SPECIFICATIONS

间距 Pitch: 10.16mm

线数 Poles: 1~3

适用线规 APPLICABLE WIRE: AWG#18- #24

温度范围 Temperatuer Range: -25°C~ +85°C

额定电压 Voltage Rating: 250V AC, DC

额定电流 Current Rating: 7A AC, DC

接触电阻 Contract Resistance: 20mΩ Max

绝缘电阻 Insulation Resistance: 1000mΩ Min

耐压 Withstanding Voltang: 1000V

材料 MATERIAL

端子 Terminal: Phosphor bronz

孔座 Housing: Nylon66 UL94V-0

针座 Wafer: PBT UL94V-0

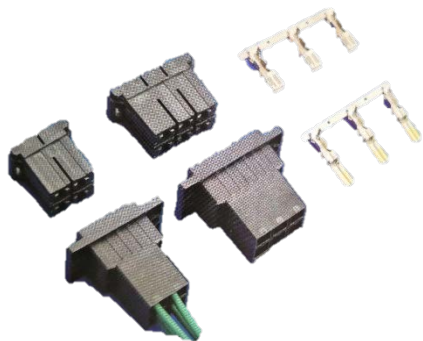

XD-10.16 双排 系列

Terminal XD-10.16-T-05

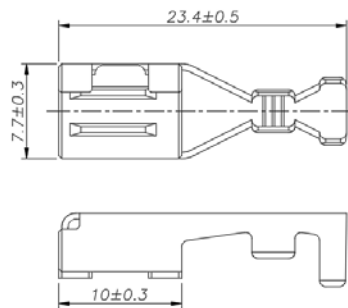

Housing XD-10.16-2xNY-05

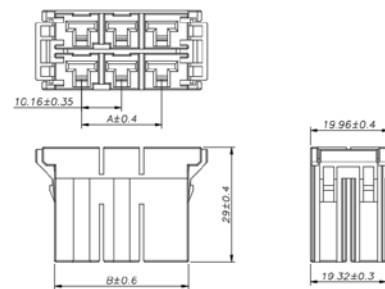

Wafer XD-10.16-2xNA-05

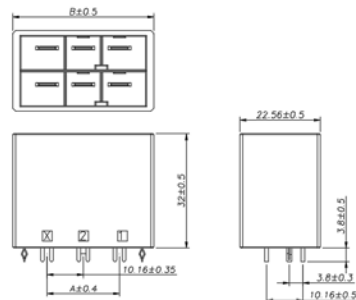

Wafer XD-10.16-2xNAW-05

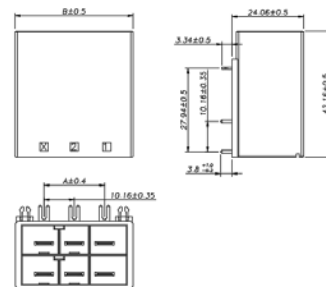

Housing

| 型号Type | 尺寸(mm) | |
|--------------------|--------|-------|
| | A | B |
| XD-10.16-2x2Y-X-05 | 10.16 | 23.76 |
| XD-10.16-2x3Y-X-05 | 20.32 | 33.92 |
| XD-10.16-2x4Y-X-05 | 30.48 | 44.08 |
| XD-10.16-2x5Y-X-05 | 40.64 | 54.24 |
| XD-10.16-2x6Y-X-05 | 50.80 | 64.40 |

Wafer

| 型号Type | 尺寸(mm) | |
|---------------------|--------|-------|
| | A | B |
| XD-10.16-2x2A/AW-05 | 10.16 | 29.36 |
| XD-10.16-2x3A/AW-05 | 20.32 | 39.52 |
| XD-10.16-2x4A/AW-05 | 30.48 | 49.68 |
| XD-10.16-2x5A/AW-05 | 40.64 | 59.84 |
| XD-10.16-2x6A/AW-05 | 50.80 | 70.00 |

X-ON Electronics

Largest Supplier of Electrical and Electronic Components

Click to view similar products for [Headers & Wire Housings](#) category:

Click to view products by [chxunda](#) manufacturer:

Other Similar products are found below :

[0015917161](#) [0022155065](#) [57102-F02-18ULF](#) [58102-G61-06LF](#) [582553-1](#) [01.001.5753.1](#) [0050291907](#) [02.125.8002.8](#) [609-3404](#) [61062-3](#)
[CSU011177004](#) [622-0430](#) [622-3653LF](#) [63453-116](#) [636-1030](#) [636-1427](#) [636-3427](#) [636-4007](#) [641938-9](#) [65495-038](#) [65692-001LF](#) [65781-018](#)
[65781-047](#) [65817-010LF](#) [65817-015LF](#) [67095-007LF](#) [67601157](#) [68631-112](#) [68645-018](#) [699319-000](#) [70.362.1628.0](#) [70-4210](#) [70-4226B](#) [70-](#)
[4853B](#) [71.350.2428.0](#) [733-134](#) [733-162](#) [760-3052](#) [MHR-64-VUAL](#) [80.063.4001.1](#) [800-90-001-10-001000](#) [801-43-002-10-013000](#)
[801-43-006-10-002000](#) [803-43-024-10-001000](#) [803-93-012-10-001000](#) [8-1437020-4](#) [819-22-004-30-001101](#) [820-22-006-30-001101](#)
[820-22-008-30-001101](#) [821-22-002-10-001101](#)