



- UL497E LISTED - I_{max} 20kA (10kA UL) - I_n 10kA (10kA UL) - Bi-directional - Replaceable Gas Tube

CITEL

P8AX09-6G-N/MF

RF



- Gas Discharge Tube Technology, DC Pass
- Frequency Range 0-6.9GHz
- I_{max} 20kA, 10kA (UL), I_n 10kA
- IP67 Outdoor Rated
- N-Type Connector
- Bi-Directional
- Replaceable Gas Tube

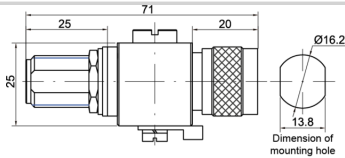

Electrical Characteristics

Frequency range	f	DC-7 GHz
Insertion loss		< 0.2 dB
Return loss		> 19 dB
Impedance		50 ohms
VSWR		<1.25:1
Max. load current	IL	10 A
Protection mode(s)		Common mode
Impulse current(2 x 10/350µs Test - D1 Category)	Iimp	1 kA
Nominal discharge current(8/20µs Test x 10 - C2 Category)	I _n	5 kA
Max Power		70 W
DC Pass		true
Insulation resistance	IR	≥10 GOhms
RF Power(Maximum)	W	25.0000
Return Loss(Minimum)	db	>20
VSWR(Maximum)	:1	<1.25
Max Total Discharge Current(I _{max} (8/20µs x 1))	kA	10.0000
Max Discharge Current(I _{max} (8/20µs x 1))	kA	10.0000
DC Pass		Yes
RF SPD TYPE		UL497E LISTED
VOLTS	(V)	48
AC/DC/DC PV/RF		RF
WIRES		1W+GROUND
LINE CURRENT MAX	(A)	10
POWER RATING	(W)	25
AMBIENT MIN	(C)	-40
AMBIENT MAX	(C)	+85
RESIDUAL VOLTAGE	(V)	700
I _N (10 impulses 8/20µs)	(kA)	10.0000
I _{MAX} (8/20µs)	(kA)	20
FREQUENCY RANGE	(GHz)	0-6.9
INSERTION LOSS (@ FREQ)	(db)	<0.2
RETURN LOSS	(db)	>22
VSWR		<1.25:1
IMPEDANCE	Ω	50

Installation

Operating Temperature(Min)	°C	-45.0000
Operating Temperature(Max)	°C	85.0000
Operating Temperature(Min)	°F	-50.0000
Operating Temperature(Max)	°F	85.0000
Operating Relative Humidity(Max)	%RH	Can be submerged
Operating Altitude(Min)	Ft	2000.0000
Operating Altitude(Max)	Ft	6500.0000
Housing/Enclosure material		Cu, Zn, Sn plated Brass
Mounting		Bracket or through hole
IP Environmental rating(IP)		IP65
NEMA Environmental rating(NEMA)		NEMA 4
Installation Location		Indoor / outdoor

P8AX09-6G-N/MF

RF

Spare part		BA HF 90/20
Accessories		BK
Product Dimension(L)	mm	71.0000
Product Dimension(H)	mm	25.0000
Product Dimension(W)	mm	13.8000
Product Dimension(L)	In	2.8000
Product Dimension(H)	In	0.9800
Product Dimension(W)	In	0.5400
Miscellaneous		
Individual Pack		No
Storage Temperature(Min)	°C	-40.0000
Storage Temperature(Max)	°C	85.0000
Storage Temperature(Min)	°F	-40.0000
Storage Temperature(Max)	°F	85.0000
Mechanical Characteristics		
Outdoor application		Yes
Contacts		Bronze/Surface Au-Ag
Insulation material		PTFE
Weight		0.175 kg
TECHNOLOGY		GDT
CONNECTION METHOD		SERIES CONNECTOR, BI-DIRECTIONAL
CONNECTOR TYPE		N
GENDER		MALE TO FEMALE
MOUNTING		BULKHEAD, OPTIONAL BRACKET
MATERIAL		Cu, Zn, Sn plated Brass, PTFE
NEMA RATING (IP RATING)		NEMA 6P (IP67)
DIMENSIONS		See diagram (mm)
WEIGHT		0.30 lbs
SPARE PART		BA HF 90/20
Standards		
RohS compliance		Yes
UL STANDARD		UL497E
UL CATEGORY		QVLA
UL FILE NUMBER		E349646
STANDARDS		NOM-003-SCFI-2014, NOM-001-SCFI-1993
ENVIRONMENTAL STANDARDS		ROHS
Part number		
68001		

X-ON Electronics

Largest Supplier of Electrical and Electronic Components

Click to view similar products for [Surge Suppressors](#) category:

Click to view products by [Citel](#) manufacturer:

Other Similar products are found below :

[2800521](#) [GUS11](#) [GUS4](#) [30460](#) [IE103](#) [SRA64C060X](#) [PC642C015](#) [1810-15-A3](#) [2713175](#) [4B06B-EC1-150LF](#) [SRA6LC](#) [CX06M](#) [CCTV1](#)
[GUS13](#) [GUS14](#) [GUS5](#) [VAL-MS 320/3+0-FM](#) [TTC-6-1X2-M-24DC-UT-I](#) [TTC-6P-1X2-24DC-UT-I](#) [TTC-6P-1X2-M-24DC-UT-I](#) [VAL-](#)
[SEC-T2-1S-350-FM](#) [VAL-US-120/40/1+1-FM](#) [VAL-US-120/65/1+1-FM](#) [VAL-US-480D/30/3+0-FM](#) [VAL-US-120/40/1+0-FM](#)
[STCHSP121BT1RU](#) [LP-GTR-NFF](#) [LP-BFDN-CW](#) [LP-STRL-NFF](#) [LP-STRL-DFF](#) [0804111](#) [5053609](#) [5053201](#) [SPD2-150-1P0](#) [SPD2-550-](#)
[1P0](#) [1-2191595-2](#) [STC-CAT6-P0E-I](#) [SPD2-350-1P0](#) [SPD2-550-3P0](#) [FLT-CP-350-ST](#) [TTC-6P-3-HF-F-M-12DC-UT-I](#) [TTC-6-2X1-24DC-UT](#)
[LTC4364CMS-1#TRPBF](#) [DS71RS-120](#) [P8AX09-T/MF](#) [CRMJ8-POE-C6](#) [DS42S-48DC](#) [MJ8-CAT6S](#) [DS41S-280](#) [3414.99.0021](#)