

|   |       |        |         |         |         |          |          |      |         |          |
|---|-------|--------|---------|---------|---------|----------|----------|------|---------|----------|
| linear dimension(Tolerances Standard GB/T 14486-2008) |       |        |         |         |         |          |          | —    |         |          |
| variable range  | to    | over 6 | over 10 | over 30 | over 60 | over 100 | over 160 | to   | over 10 | over 100 |
|   | 6     | to 10  | to 30   | to 60   | to 100  | to 160   | to 10    |      | to 100  | to       |
| tolerance   | ±0.20 | ±0.30  | ±0.50   | ±0.70   | ±1.00   | ±1.30    | ±1.60    | 0.10 | 0.30    | 0.60     |

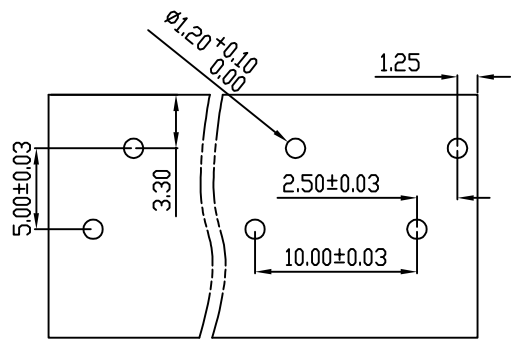

PCB Layout

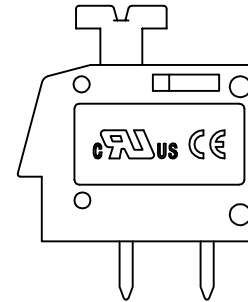
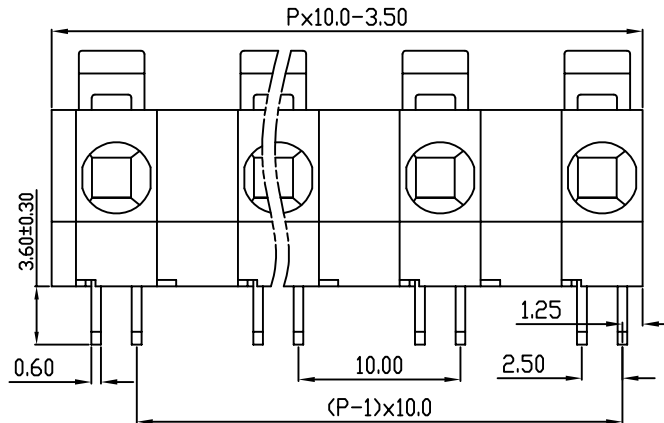
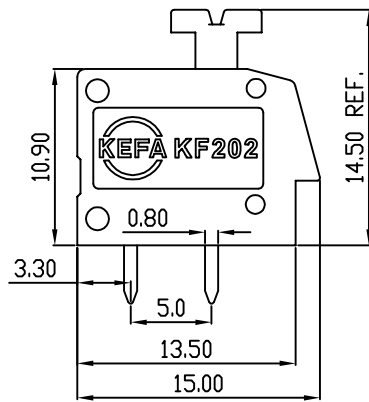
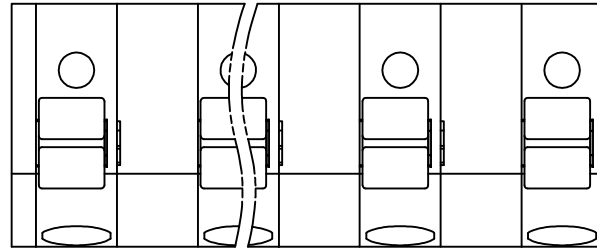

| REVISION RECORD |             |         |          |          |
|-----------------|-------------|---------|----------|----------|
| REV.            | DESCRIPTION | ECN No. | APPROVED | DATE     |
| A               | 新发行         |         | CLF      | 21.10.19 |
|                 |             |         |          |          |
|                 |             |         |          |          |

|                       |                                 |                  |     |            |  |  |
|-----------------------|---------------------------------|------------------|-----|------------|--|--|
| UL/CUL 技术参数           |                                 |                  |     |            |  |  |
| UL/CUL Technical Data |                                 |                  |     |            |  |  |
| 等级                    | Use Group                       | B                | C   | D          |  |  |
| 额定电压                  | Rated Voltage [V]               | 300              | -   | 300        |  |  |
| 额定电流                  | Rated Current [A]               | 12               | -   | 10         |  |  |
| 接线范围                  | Wire Range                      | 24-12            |     |            |  |  |
| 单/多芯线                 | Solid/Stranded [AWG]            |                  |     |            |  |  |
| 耐电压                   | Withstanding Voltage            | 1600V/1Min       |     |            |  |  |
| IEC 技术参数              |                                 |                  |     |            |  |  |
| IEC Technical Data    |                                 |                  |     |            |  |  |
| 过电压类别                 | Overvoltage Category            | III              | III | II         |  |  |
| 污染等级                  | Contamination Class             | 3                | 2   | 2          |  |  |
| 额定电压                  | Rated Voltage [V]               | 320              | 320 | 630        |  |  |
| 额定电流                  | Rated Current [A]               | 16               | 16  | 16         |  |  |
| 额定冲击电压                | Impulse withstand voltagea [KV] | 4                | 4   | 4          |  |  |
| 导线截面积                 | Conductor cross section         | 2.5              |     |            |  |  |
| 硬质/柔性导线               | Solid/flexible [mm²]            |                  |     |            |  |  |
| 材料                    |                                 |                  |     | Material   |  |  |
| 绝缘材料                  | Insulation Material             | PA66             |     |            |  |  |
| 阻燃等级                  | Imflammability                  | UL94V-0          |     |            |  |  |
| 导体材料                  | Contactive Material             | 铜合金 Copper alloy |     |            |  |  |
| 导体表面镀层                | Contactive Coating              | 镀锡 Tin Plated    |     |            |  |  |
| 一般参数                  |                                 |                  |     | Other Data |  |  |
| 间距                    | Pitch [mm]                      | 10.0             |     |            |  |  |
| 极数                    | Poles [P]                       | 02-XX            |     |            |  |  |
| 剥线长度                  | Stripping Length [mm]           | 11               |     |            |  |  |
| 螺丝                    | Screw/扭矩 Torque(Max) [N.m]      | -                |     |            |  |  |
| 工作温度                  | Operating temperatur [°C]       | -40~+105         |     |            |  |  |
| 引针尺寸                  | Pin Dimensions [mm]             | 3.6              |     |            |  |  |
| PCB板孔径                | PCB Hole Diameter [mm]          | 1.2              |     |            |  |  |

|      |     |      |          |
|------|-----|------|----------|
| DES. | SJD | DATE | 21.10.19 |
| CHK. | BY  | DATE | 21.10.19 |
| APP. | CLF | DATE | 21.10.19 |

|  |    |         |    |          |     |
|--|----|---------|----|----------|-----|
| 单位/UNITS                                     | mm | 尺寸/SIZE | A4 | 比例/SCALE | 1:1 |
| 慈溪市科发电子有限公司<br>CIXI KEFA ELECTRONIC CO., LTD |    |         |    |          |     |

|                             |  |          |            |
|-----------------------------|--|----------|------------|
| 第三视角/THIRD ANGLE PROJECTION |  | 版本/REV   | A          |
|                             |  | 名称/TITLE | KF202-10.0 |

## X-ON Electronics

Largest Supplier of Electrical and Electronic Components

*Click to view similar products for [Fixed Terminal Blocks](#) category:*

*Click to view products by [Cixi Kefa](#) manufacturer:*

Other Similar products are found below :

[MBE-1512](#) [MBE-1520](#) [MBE-154](#) [MBE-156](#) [MBES-156](#) [MH-2512](#) [MHE-132](#) [MHE-163](#) [MI-254 \(35\)](#) [MPT-275](#) [ELM10110G](#) [BA311TU](#)  
[BA411SU](#) [MV-254-D](#) [MV-255](#) [MV-493](#) [MVE-252](#) [MVE-253](#) [MVEB-153](#) [1705142](#) [1-796689-8](#) [1841320000](#) [S451](#) [29.007](#) [29.116](#) [30.204](#)  
[30.503](#) [30.756](#) [30.853](#) [9872-0-00-15-00-00-33-0](#) [996750](#) [1710052](#) [20020316-G071B01LF](#) [20020327-C061B01LF](#) [29590](#) [30.652](#) [30.710](#)  
[30.754](#) [30.757](#) [32.058](#) [37.206](#) [37.208](#) [37.507](#) [37.558](#) [38331-5812](#) [38331-8018](#) [38540-1910](#) [39.002](#) [MBE-1517](#) [MBE-153](#)