

| linear dimension(Tolerances Standard GB/T 14486-2008) |            |              |               |               |                |                 |             | —     | $\nabla$       | $\perp$     |
|---|------------|--------------|---------------|---------------|----------------|-----------------|-------------|-------|----------------|-------------|
| variable range  | to 6       | over 6 to 10 | over 10 to 30 | over 30 to 60 | over 60 to 100 | over 100 to 160 | over 160 to | to 10 | over 10 to 100 | over 100 to |
| tolerance   | $\pm 0.20$ | $\pm 0.30$   | $\pm 0.50$    | $\pm 0.70$    | $\pm 1.00$     | $\pm 1.30$      | $\pm 1.60$  | 0.10  | 0.30           | 0.60        |

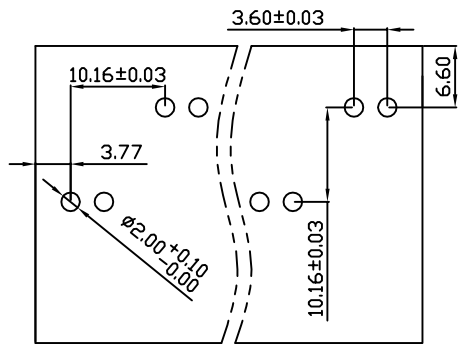

PCB LAYOUT

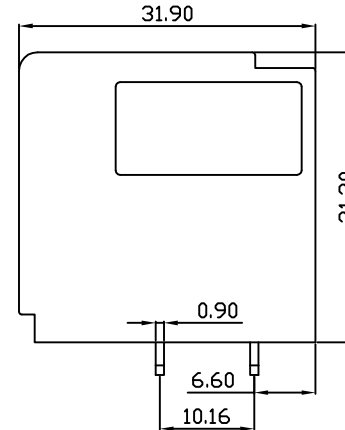
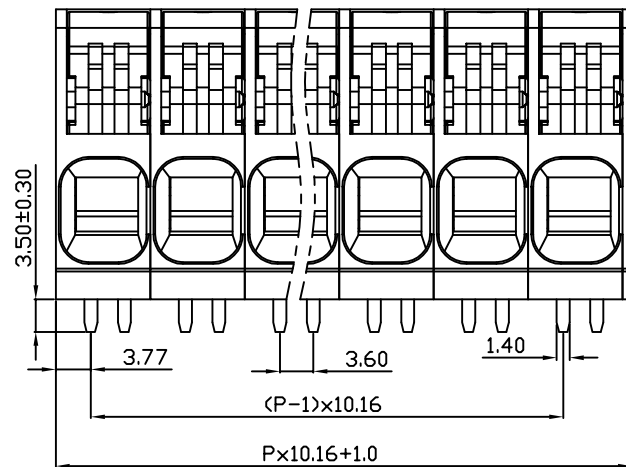
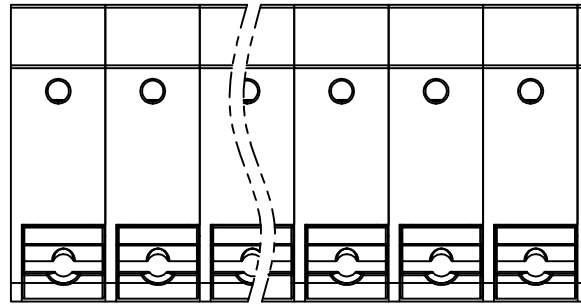

| REVISION RECORD |             |         |          |          |
|-----------------|-------------|---------|----------|----------|
| REV.            | DESCRIPTION | ECN No. | APPROVED | DATE     |
| A               | 新发行         |         | CLF      | 21.06.04 |
|                 |             |         |          |          |
|                 |             |         |          |          |

| UL/CUL 技术参数<br>UL/CUL Technical Data |                                   |                  |      |            |  |  |
|--------------------------------------|-----------------------------------|------------------|------|------------|--|--|
| 等级                                   | Use Group                         | B                | C    | D          |  |  |
| 额定电压                                 | Rated Voltage [V]                 | 600              | 600  | 300        |  |  |
| 额定电流                                 | Rated Current [A]                 | 58               | 58   | 10         |  |  |
| 接线范围                                 | Wire Range                        |                  |      |            |  |  |
| 单/多芯线                                | Solid/Stranded [AWG]              | 20-6             |      |            |  |  |
| 耐电压                                  | Withstanding Voltage              | 2200V/1Min       |      |            |  |  |
| IEC 技术参数<br>IEC Technical Data       |                                   |                  |      |            |  |  |
| 过电压类别                                | Oversvoltage Category             | III              | III  | II         |  |  |
| 污染等级                                 | Contamination Class               | 3                | 2    | 2          |  |  |
| 额定电压                                 | Rated Voltage [V]                 | 800              | 1000 | 1000       |  |  |
| 额定电流                                 | Rated Current [A]                 | 67               | 67   | 67         |  |  |
| 额定冲击电压                               | Impulse withstand voltagea [KV]   | 8                | 8    | 6          |  |  |
| 导线截面积                                | Conductor cross section           |                  |      |            |  |  |
| 硬质/柔性导线                              | Solid/flexible [mm <sup>2</sup> ] | 16.0             |      |            |  |  |
| 材料                                   |                                   |                  |      | Material   |  |  |
| 绝缘材料                                 | Insulation Material               | PA66             |      |            |  |  |
| 阻燃等级                                 | Imflammability                    | UL94V-0          |      |            |  |  |
| 导体材料                                 | Contactior Material               | 铜合金 Copper alloy |      |            |  |  |
| 导体表面镀层                               | Contactive Coating                | 镀锡 Tin Plated    |      |            |  |  |
| 一般参数                                 |                                   |                  |      | Other Data |  |  |
| 间距                                   | Pitch [mm]                        | 10.16            |      |            |  |  |
| 极数                                   | Poles [P]                         | 01-XX            |      |            |  |  |
| 剥线长度                                 | Stripping Length [mm]             | 18.0             |      |            |  |  |
| 螺丝                                   | Screw/扭矩 Torque(Max) [N.m]        | -                |      |            |  |  |
| 工作温度                                 | Operating temperatur [°C]         | -40~+105         |      |            |  |  |
| 引针尺寸                                 | Pin Dimensions [mm]               | 3.50             |      |            |  |  |
| PCB板孔径                               | PCB Hole Diameter [mm]            | 2.00             |      |            |  |  |

|      |     |      |          |          |    |         |    |          |     |
|------|-----|------|----------|----------|----|---------|----|----------|-----|
| DES. | LQQ | DATE | 21.06.04 | 单位/UNITS | mm | 尺寸/SIZE | A4 | 比例/SCALE | 1:1 |
| CHK. | SY  | DATE | 21.06.04 |          |    |         |    |          |     |
| APP. | CLF | DATE | 21.06.04 |          |    |         |    |          |     |



慈溪市科发电子有限公司  
CIXI KEFA ELECTRONICS CO., LTD

|                             |  |          |               |
|-----------------------------|--|----------|---------------|
| 第三视角/THIRD ANGLE PROJECTION |  | 版本/REV   | A             |
|                             |  | 名称/TITLE | KF207RB-10.16 |

## X-ON Electronics

Largest Supplier of Electrical and Electronic Components

*Click to view similar products for [Fixed Terminal Blocks](#) category:*

*Click to view products by [Cixi Kefa](#) manufacturer:*

Other Similar products are found below :

[MBE-1512](#) [MBE-1520](#) [MBE-154](#) [MBE-156](#) [MBES-156](#) [MH-2512](#) [MHE-132](#) [MHE-163](#) [MI-254 \(35\)](#) [MPT-275](#) [ELM10110G](#) [BA311TU](#)  
[BA411SU](#) [MV-254-D](#) [MV-255](#) [MV-493](#) [MVE-252](#) [MVE-253](#) [MVEB-153](#) [1705142](#) [1-796689-8](#) [1841320000](#) [S451](#) [29.007](#) [29.116](#) [30.204](#)  
[30.503](#) [30.756](#) [30.853](#) [9872-0-00-15-00-00-33-0](#) [996750](#) [1710052](#) [20020316-G071B01LF](#) [20020327-C061B01LF](#) [29590](#) [30.652](#) [30.710](#)  
[30.754](#) [30.757](#) [32.058](#) [37.206](#) [37.208](#) [37.507](#) [37.558](#) [38331-5812](#) [38331-8018](#) [38540-1910](#) [39.002](#) [MBE-1517](#) [MBE-153](#)