

linear dimension(Tolerances Standard GB/T 14486-2008)								—		
variable range	to 6	over 6 to 10	over 10 to 30	over 30 to 60	over 60 to 100	over 100 to 160	over 160 to	to 10	over 10 to 100	over 100 to
tolerance	±0.20	±0.30	±0.50	±0.70	±1.00	±1.30	±1.60	0.10	0.30	0.60

REVISION RECORD				
REV.	DESCRIPTION	ECN No.	APPROVED	DATE
A	新发行		CLF	21.10.28

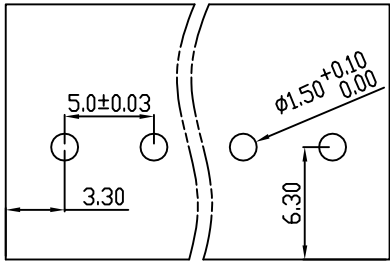

PCB Layout

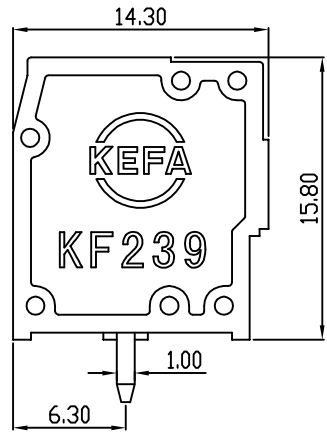
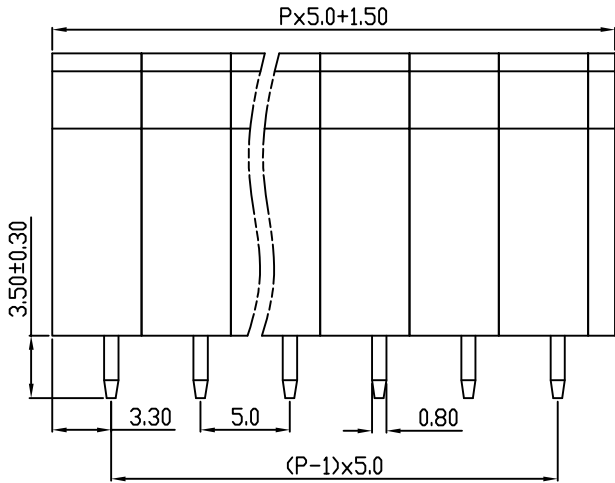
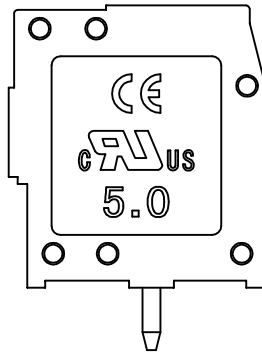
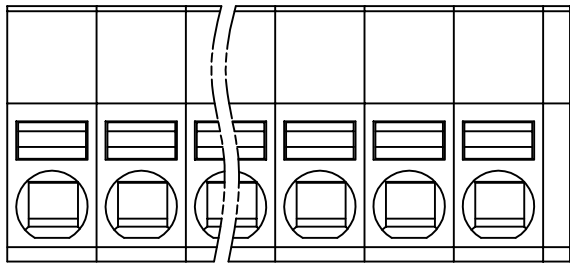

UL/CUL 技术参数 UL/CUL Technical Data									
等级	Use Group	B	C	D					
额定电压	Rated Voltage [V]	300	-	300					
额定电流	Rated Current [A]	12	-	10					
接线范围	Wire Range				28-12				
单/多芯线	Solid/Stranded [AWG]								
耐电压	Withstanding Voltage				1600V/1Min				
IEC 技术参数 IEC Technical Data									
过电压类别	Overvoltage Category	III	III	II					
污染等级	Contamination Class	3	2	2					
额定电压	Rated Voltage [V]	320	320	630					
额定电流	Rated Current [A]	12	12	12					
额定冲击电压	Impulse withstand voltage [KV]	4.0	4.0	4.0					
导线截面积	Conductor cross section				2.5				
硬质/柔性导线	Solid/flexible [mm ²]								
材料 Material									
绝缘材料	Insulation Material				PA66				
阻燃等级	Inflammability				UL94V-0				
导体材料	Contacting Material				铜合金 Copper alloy				
导体表面镀层	Contactive Coating				镀锡 Tin Plated				
一般参数 Other Data									
间距	Pitch [mm]				5.0				
极数	Poles [P]				01-XX				
剥线长度	Stripping Length [mm]				9-10				
螺丝	Screw 扭矩 Torque(Max) [N.m]				-				
工作温度	Operating temperatur [°C]				-40→105				
引针尺寸	Pin Dimensions [mm]				3.5				
PCB板孔径	PCB Hole Diameter [mm]				1.5				

DES.	SJD	DATE	21.10.28
CHK.	BY	DATE	21.10.28
APP.	CLF	DATE	21.10.28

单位/UNITS	mm	尺寸/SIZE	A4	比例/SCALE	1:1
慈溪市科发电子有限公司 CIXI KEFA ELECTRONIC CO., LTD					

第三视角/THIRD ANGLE PROJECTION	版本/REV	A
名称/TITLE	KF239-5.0	

X-ON Electronics

Largest Supplier of Electrical and Electronic Components

Click to view similar products for [Fixed Terminal Blocks](#) category:

Click to view products by [Cixi Kefa](#) manufacturer:

Other Similar products are found below :

[MBE-1512](#) [MBE-1520](#) [MBE-154](#) [MBE-156](#) [MBES-156](#) [MH-2512](#) [MHE-132](#) [MHE-163](#) [MI-254 \(35\)](#) [MPT-275](#) [ELM10110G](#) [BA311TU](#)
[BA411SU](#) [MV-254-D](#) [MV-255](#) [MV-493](#) [MVE-252](#) [MVE-253](#) [MVEB-153](#) [1705142](#) [1-796689-8](#) [1841320000](#) [S451](#) [29.007](#) [29.116](#) [30.204](#)
[30.503](#) [30.756](#) [30.853](#) [9872-0-00-15-00-00-33-0](#) [996750](#) [1710052](#) [20020316-G071B01LF](#) [20020327-C061B01LF](#) [29590](#) [30.652](#) [30.710](#)
[30.754](#) [30.757](#) [32.058](#) [37.206](#) [37.208](#) [37.507](#) [37.558](#) [38331-5812](#) [38331-8018](#) [38540-1910](#) [39.002](#) [MBE-1517](#) [MBE-153](#)