

linear dimension (Tolerances Standard GB/T 14486-2008)		—		□		L	
variable range	6 to 6	over 6 to 10	over 10 to 30	over 30 to 60	over 60 to 100	over 100 to 160	over 160 to 100
tolerance	±0.20	±0.30	±0.50	±0.70	±1.00	±1.30	±1.60
			0.10	0.30	0.60		

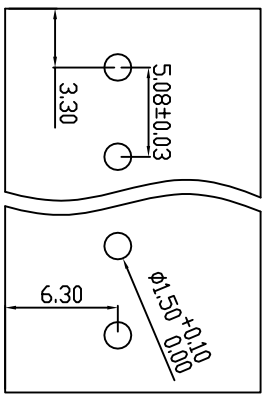

PCB Layout

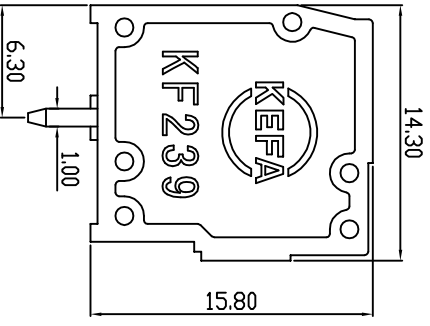
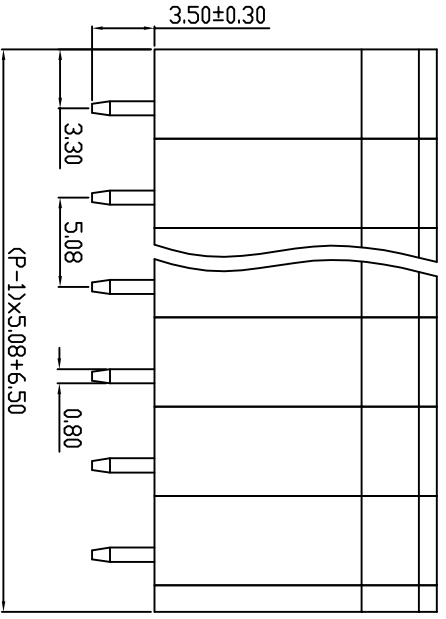
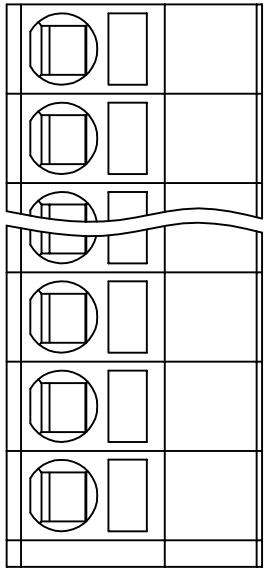
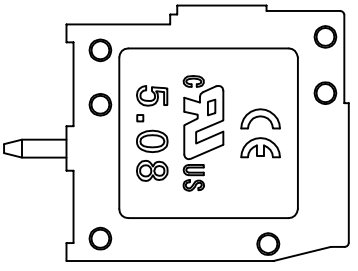

REVISION RECORD			
REV.	DESCRIPTION	ECH No.	APPROVED DATE

UL/CUL 技术参数			
UL/CUL Technical Data			
等级	Use Group	B	C D
额定电压	Rated Voltage	M	300 - 300
额定电流	Rated Current	A	12 - 10
接线范围	Wire Range	28-12	
单/多芯线	Solid/Stranded	[AWG]	
耐电压	Withstanding Voltage	1800V/1min	

IEC 技术参数			
IEC Technical Data			
过电压类别	Overvoltage Category	III	II
污染等级	Contamination Class	3	2
额定电压	Rated Voltage	M	320 630
额定电流	Rated Current	A	12 12
额定冲击电压	Impulse withstand voltage	[kV]	4.0 4.0
导线截面积	Conductor cross section	[mm ²]	2.5
材质/柔性导线	Solid/flexible	2.5	

材料		Material
绝缘材料	Insulation Material	PA66
阻燃等级	Inflammability	UL94V-0
导体材料	Conductor Material	铜合金 Copper alloy
导体表面镀层	Contactive Coating	铁锡 Tin Plated
一般参数		Other Data
间距	Pitch	[mm]
极数	Poles	508
剥线长度	Stripping Length	[mm]
剥线长度	Stripping Length	9-10
螺丝 螺钉/扭矩	Torque(Max)	[N.m]
工作温度	Operating temperature	[°C]
引脚尺寸	Pin Dimensions	[mm]
PCB板孔径	PCB Hole Diameter	[mm]

DES.	DATE
CHK	DATE
APP.	DATE

单位 / UNITS	mm	尺寸 / SIZE	A4	比例 / SCALE	1:1	
第三视图/THIRD ANGLE PROJECTION						
名称 / TITLE	KF239-5.08				版本 / REV	A



慈溪市科发电子有限公司
CXI KEFA ELECTRONIC CO., LTD

X-ON Electronics

Largest Supplier of Electrical and Electronic Components

Click to view similar products for [Fixed Terminal Blocks](#) category:

Click to view products by [Cixi Kefa](#) manufacturer:

Other Similar products are found below :

[MBE-1512](#) [MBE-1520](#) [MBE-154](#) [MBE-156](#) [MBES-156](#) [MH-2512](#) [MHE-132](#) [MHE-163](#) [MI-254 \(35\)](#) [MI-272](#) [MPT-275](#) [ELM10110G](#)
[BA311TU](#) [BA411SU](#) [MV-253/NCNOC](#) [MV-254-D](#) [MV-255](#) [MV-493](#) [MVE-252](#) [MVE-253](#) [MVE-273](#) [MVEB-153](#) [1700096](#) [1705142](#)
[1712417](#) [1713088](#) [1745195](#) [1760594](#) [1-796689-8](#) [1-796692-6](#) [1800114](#) [20020314-C121B01LF](#) [20020316-G041B01LF](#) [KP03215000J0G](#)
[KP04215000J0G](#) [S451](#) [29.007](#) [29.116](#) [30.103](#) [30.106](#) [30.503](#) [30.608](#) [30.755](#) [30.756](#) [30.853](#) [9872-0-00-15-00-00-33-0](#) [996750](#) [1706303](#)
[1710052](#) [1712418](#)