

|   |       |              |               |               |                |                 |             |       |                |             |
|---|-------|--------------|---------------|---------------|----------------|-----------------|-------------|-------|----------------|-------------|
| linear dimension(Tolerances Standard GB/T 14486-2008) |       |              |               |               |                |                 |             | —     |                |             |
| variable range  | to 6  | over 6 to 10 | over 10 to 30 | over 30 to 60 | over 60 to 100 | over 100 to 160 | over 160 to | to 10 | over 10 to 100 | over 100 to |
| tolerance   | ±0.20 | ±0.30        | ±0.50         | ±0.70         | ±1.00          | ±1.30           | ±1.60       | 0.10  | 0.30           | 0.60        |

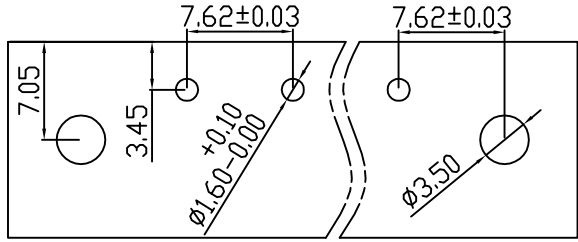

PCB LAYOUT

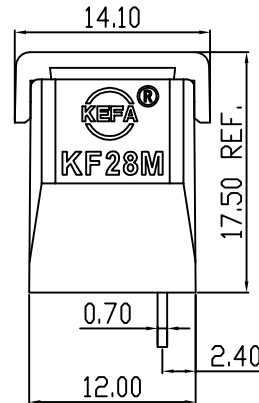
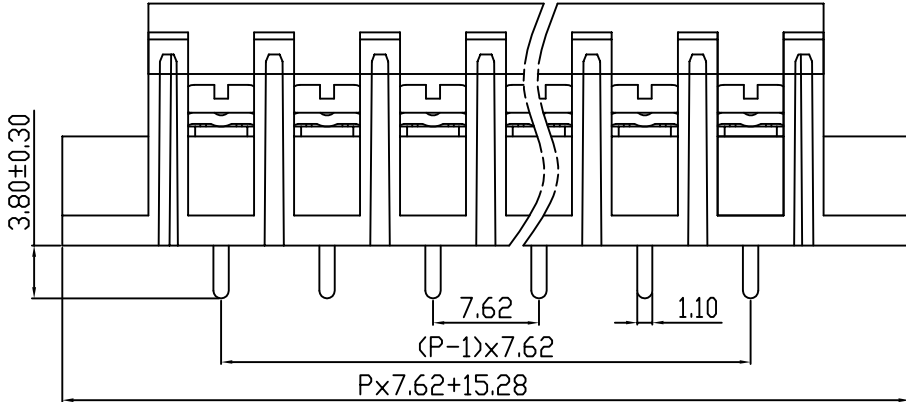
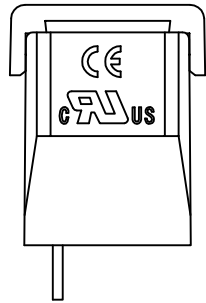
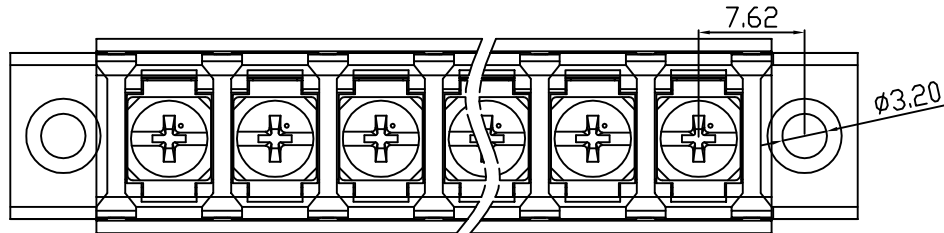

| REV. | DESCRIPTION | ECN No. | APPROVED | DATE     |
|------|-------------|---------|----------|----------|
| A    | 新发行         |         | CLF      | 21.12.10 |
|      |             |         |          |          |
|      |             |         |          |          |

|  |                  |   |   |  |
|--|------------------|---|---|--|
| UL/CUL 技术参数<br>UL/CUL Technical Data                                       |                  |   |   |  |
| 等级 Use Group   | B                | C | D |  |
| 额定电压 Rated Voltage [V]   | 300              | - | - |  |
| 额定电流 Rated Current [A]   | 20               | - | - |  |
| 接线范围 Wire Range<br>单/多芯线 Solid/Stranded [AWG]                              | 22-12            |   |   |  |
| IEC 技术参数<br>IEC Technical Data   |                  |   |   |  |
| 额定电压 Rated Voltage [V]   | 250              |   |   |  |
| 额定电流 Rated Current [A]   | 24               |   |   |  |
| 耐电压 Withstanding Voltage   | 2000V/1Min       |   |   |  |
| 导线截面积 Conductor cross section<br>硬质/柔性导线 Solid/flexible [mm <sup>2</sup> ] | 2.5              |   |   |  |
| 材料 Material  |                  |   |   |  |
| 绝缘材料 Insulation Material   | PA66             |   |   |  |
| 阻燃等级 Imflammability  | UL94V-0          |   |   |  |
| 导体材料 Contactor Material  | 铜合金 Copper alloy |   |   |  |
| 导体表面镀层 Contactive Coating  | 镀锡 Tin plated    |   |   |  |
| 一般参数 Other Data  |                  |   |   |  |
| 间距 Pitch [mm]  | 7.62             |   |   |  |
| 极数 Poles [P]   | 02-24            |   |   |  |
| 剥线长度 Stripping Length [mm]   | -                |   |   |  |
| 螺丝 Screw/扭矩 Torque(Max) [N.m]  | M3/0.8           |   |   |  |
| 工作温度 Operating temperatur [°C]   | -40~+105         |   |   |  |
| 引针尺寸 Pin Dimensions [mm]   | 3.8              |   |   |  |
| PCB板孔径 PCB Hole Diameter [mm]  | 1.6              |   |   |  |

|      |     |      |          |  |    |         |    |          |             |                             |        |   |
|------|-----|------|----------|--|----|---------|----|----------|-------------|-----------------------------|--------|---|
| DES. | LQQ | DATE | 21.12.10 | 单位/UNITS                                     | mm | 尺寸/SIZE | A4 | 比例/SCALE | 1:1         | 第三视角/THIRD ANGLE PROJECTION | 版本/REV | A |
| CHK. | BY  | DATE | 21.12.10 | 慈溪市科发电子有限公司<br>CIXI KEFA ELECTRONIC CO., LTD |    |         |    | 名称/TITLE | KF28SM-7.62 |                             |        |   |
| APP. | CLF | DATE | 21.12.10 |  |    |         |    |          |             |                             |        |   |

## X-ON Electronics

Largest Supplier of Electrical and Electronic Components

*Click to view similar products for [Barrier Terminal Blocks](#) category:*

*Click to view products by [Cixi Kefa](#) manufacturer:*

Other Similar products are found below :

[CR151D20104](#) [670A-RZ-15-KT20](#) [6C1N03](#) [6PCR-02](#) [6PCR-02-008](#) [6PCR-05-008](#) [6PCR-08-008](#) [6PCR-09-008](#) [6PCR-13-006](#) [6PCR-15-006](#) [6PCV-06-008](#) [6PCV-06-716](#) [6PCV-09-001](#) [6PCV-15-008](#) [6PCV-17-1206](#) [6PCV-20-323](#) [6STR-06-006](#) [6STR-08-006](#) [6STR-12-008](#) [6STR-13-006](#) [6STR-14-008](#) [6STR-16-008](#) [6STR-17-008](#) [6STR-21-008](#) [6STR-25-008](#) [6STR-27-008](#) [6STV-03-008](#) [6STV-09-006](#) [6STV-10-006](#) [6WWV-11-008](#) [6WWV-12-008](#) [6WWV-16-008](#) [71502-50](#) [71507-47-50](#) [72504-C-50](#) [72506-C](#) [72507-C-50](#) [72508-56](#) [73203](#) [75505-C-50](#) [812-GP-3/4ST-09](#) [812-GPZ-03PSB](#) [8-1437402-5](#) [8-1437402-7](#) [8PCR-06-006](#) [8PCR-11-006](#) [8PCV-04-001](#) [8PCV-05-008](#) [8PCV-09-006](#) [8PCV-15-006](#)