

|   |       |        |         |         |         |          |          |        |         |          |
|---|-------|--------|---------|---------|---------|----------|----------|--------|---------|----------|
| linear dimension(Tolerances Standard GB/T 14486-2008) |       |        |         |         |         |          |          | —      |         |          |
| variable range  |       | over 6 | over 10 | over 30 | over 60 | over 100 | over 160 |        | over 10 | over 100 |
|   | to 6  | to 10  | to 30   | to 60   | to 100  | to 160   | to 10    | to 100 | to 100  |          |
| tolerance   | ±0.20 | ±0.30  | ±0.50   | ±0.70   | ±1.00   | ±1.30    | ±1.60    | 0.10   | 0.30    | 0.60     |

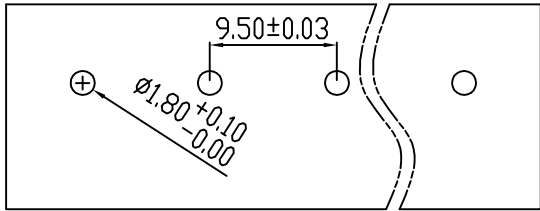

PCB LAYOUT

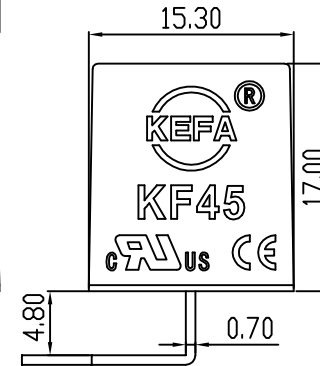
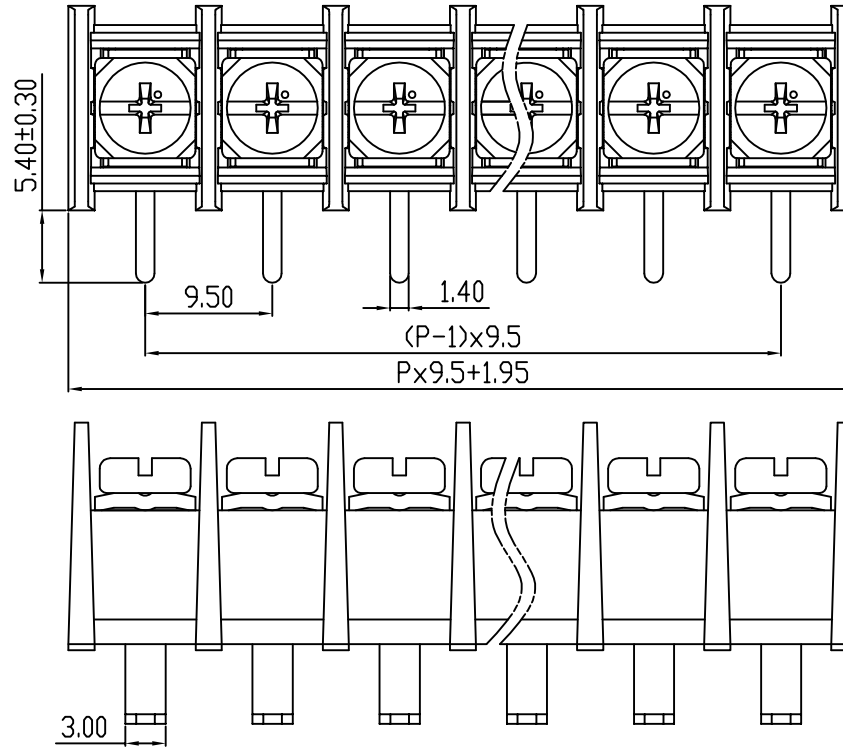

| REVISION RECORD |             |         |          |          |
|-----------------|-------------|---------|----------|----------|
| REV.            | DESCRIPTION | ECN No. | APPROVED | DATE     |
| A               | 新发行         |         | CLF      | 21.10.12 |
|                 |             |         |          |          |
|                 |             |         |          |          |

|                                      |                                   |                  |   |   |
|--------------------------------------|-----------------------------------|------------------|---|---|
| UL/CUL 技术参数<br>UL/CUL Technical Data |                                   |                  |   |   |
| 等级                                   | Use Group                         | B                | C | D |
| 额定电压                                 | Rated Voltage [V]                 | 300              | - | - |
| 额定电流                                 | Rated Current [A]                 | 20               | - | - |
| 接线范围                                 | Wire Range                        | 22-12            |   |   |
| 单/多芯线                                | Solid/Stranded [AWG]              |                  |   |   |
| IEC 技术参数<br>IEC Technical Data       |                                   |                  |   |   |
| 额定电压                                 | Rated Voltage [V]                 | 750              |   |   |
| 额定电流                                 | Rated Current [A]                 | 32               |   |   |
| 耐电压                                  | Withstanding Voltage [V/1Min]     | 3000V/1Min       |   |   |
| 导线截面积                                | Conductor cross section           | 4.0              |   |   |
| 硬质/柔性导线                              | Solid/flexible [mm <sup>2</sup> ] |                  |   |   |
| 材料<br>Material                       |                                   |                  |   |   |
| 绝缘材料                                 | Insulation Material               | PA66             |   |   |
| 阻燃等级                                 | Imflamability                     | UL94V-0          |   |   |
| 导体材料                                 | Contacting Material               | 铜合金 Copper alloy |   |   |
| 导体表面镀层                               | Contactive Coating                | 镀锡 Tin Plated    |   |   |
| 一般参数<br>Other Data                   |                                   |                  |   |   |
| 间距                                   | Pitch [mm]                        | 9.5              |   |   |
| 极数                                   | Poles [P]                         | 02~24            |   |   |
| 剥线长度                                 | Stripping Length [mm]             | -                |   |   |
| 螺丝                                   | Screw/扭矩 Torque(Max) [N.m]        | M4/1.0           |   |   |
| 工作温度                                 | Operating temperatur [°C]         | -40~+105         |   |   |
| 引针尺寸                                 | Pin Dimensions [mm]               | 5.4              |   |   |
| PCB板孔径                               | PCB Hole Diameter [mm]            | 1.8              |   |   |

|      |     |      |          |  |    |         |    |          |     |                             |           |   |
|------|-----|------|----------|--|----|---------|----|----------|-----|-----------------------------|-----------|---|
| DES. | LQQ | DATE | 21.10.12 | 单位/UNITS                                     | mm | 尺寸/SIZE | A4 | 比例/SCALE | 1:1 | 第三视角/THIRD ANGLE PROJECTION | 版本/REV    | A |
| CHK. | BY  | DATE | 21.10.12 | 慈溪市科发电子有限公司<br>CIXI KEFA ELECTRONIC CO., LTD |    |         |    |          |     |                             |           |   |
| APP. | CLF | DATE | 21.10.12 |  |    |         |    |          |     |                             |           |   |
|      |     |      |          |  |    |         |    |          |     | 名称/TITLE                    | KF45R-9.5 |   |

## X-ON Electronics

Largest Supplier of Electrical and Electronic Components

*Click to view similar products for [Barrier Terminal Blocks](#) category:*

*Click to view products by [Cixi Kefa](#) manufacturer:*

Other Similar products are found below :

[CR151D20104](#) [670A-RZ-15-KT20](#) [6C1N03](#) [6PCR-02](#) [6PCR-02-008](#) [6PCR-05-008](#) [6PCR-08-008](#) [6PCR-09-008](#) [6PCR-13-006](#) [6PCR-15-006](#) [6PCV-06-008](#) [6PCV-06-716](#) [6PCV-09-001](#) [6PCV-15-008](#) [6PCV-17-1206](#) [6PCV-20-323](#) [6STR-06-006](#) [6STR-08-006](#) [6STR-12-008](#) [6STR-13-006](#) [6STR-14-008](#) [6STR-16-008](#) [6STR-17-008](#) [6STR-21-008](#) [6STR-25-008](#) [6STR-27-008](#) [6STV-03-008](#) [6STV-09-006](#) [6STV-10-006](#) [6WWV-11-008](#) [6WWV-12-008](#) [6WWV-16-008](#) [71502-50](#) [71507-47-50](#) [72504-C-50](#) [72506-C](#) [72507-C-50](#) [72508-56](#) [73203](#) [75505-C-50](#) [812-GP-3/4ST-09](#) [812-GPZ-03PSB](#) [8-1437402-5](#) [8-1437402-7](#) [8PCR-06-006](#) [8PCR-11-006](#) [8PCV-04-001](#) [8PCV-05-008](#) [8PCV-09-006](#) [8PCV-15-006](#)