

| linear dimension(Tolerances Standard GB/T 14486-2008) |            |            |            |            |            |            |            | —    | $\nabla$ | $\perp$ |
|---|------------|------------|------------|------------|------------|------------|------------|------|----------|---------|
| variable range  | to         | over       | over       | over       | over       | over       | over       | to   | over     | over    |
|   | 6          | 6 to 10    | 10 to 30   | 30 to 60   | 60 to 100  | 100 to 160 | 160 to     |      |          |         |
| tolerance   | $\pm 0.20$ | $\pm 0.30$ | $\pm 0.50$ | $\pm 0.70$ | $\pm 1.00$ | $\pm 1.30$ | $\pm 1.60$ | 0.10 | 0.30     | 0.60    |

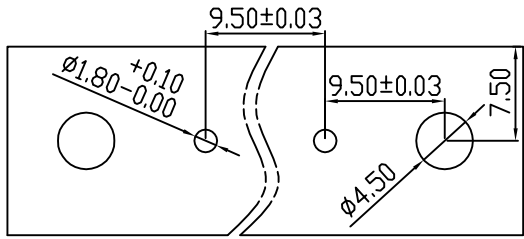

PCB LAYOUT

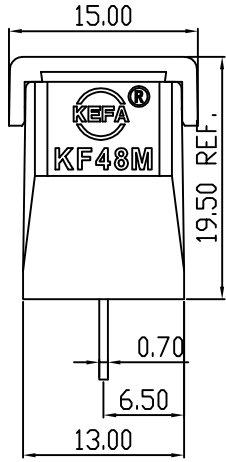
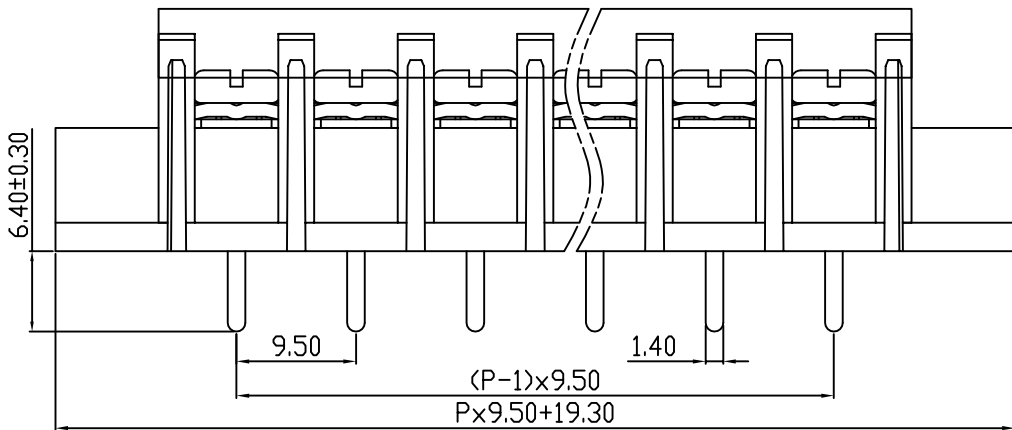
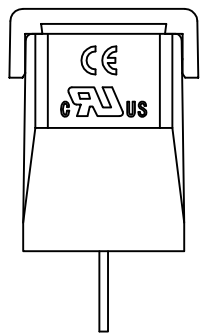
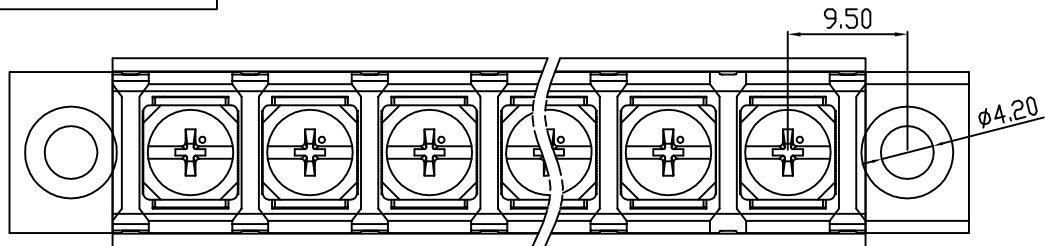

| REVISION RECORD |             |         |          |          |
|-----------------|-------------|---------|----------|----------|
| REV.            | DESCRIPTION | ECN No. | APPROVED | DATE     |
| A               | 新发行         |         | CLF      | 21.12.10 |
|                 |             |         |          |          |
|                 |             |         |          |          |

| UL/CUL 技术参数 |                                   | UL/CUL Technical Data |   |   |
|-------------|-----------------------------------|-----------------------|---|---|
| 等级          | Use Group                         | B                     | C | D |
| 额定电压        | Rated Voltage [V]                 | 300                   | - | - |
| 额定电流        | Rated Current [A]                 | 20                    | - | - |
| 接线范围        | Wire Range                        | 22-12                 |   |   |
| 单/多芯线       | Solid/Stranded [AWG]              |                       |   |   |
| IEC 技术参数    |                                   | IEC Technical Data    |   |   |
| 额定电压        | Rated Voltage [V]                 | 750                   |   |   |
| 额定电流        | Rated Current [A]                 | 32                    |   |   |
| 耐电压         | Withstanding Voltage              | 3000V/1Min            |   |   |
| 导线截面积       | Conductor cross section           | 4.0                   |   |   |
| 硬质/柔性导线     | Solid/flexible [mm <sup>2</sup> ] |                       |   |   |
| 材料          |                                   | Material              |   |   |
| 绝缘材料        | Insulation Material               | PA66                  |   |   |
| 阻燃等级        | Imflammability                    | UL94V-0               |   |   |
| 导体材料        | Contacting Material               | 铜合金 Copper alloy      |   |   |
| 导体表面镀层      | Contactive Coating                | 镀锡 Tin plated         |   |   |
| 一般参数        |                                   | Other Data            |   |   |
| 间距          | Pitch [mm]                        | 9.5                   |   |   |
| 极数          | Poles [P]                         | 02-24                 |   |   |
| 剥线长度        | Stripping Length [mm]             | -                     |   |   |
| 螺丝          | Screw/扭矩 Torque(Max) [N.m]        | M4/1.0                |   |   |
| 工作温度        | Operating temperatur [°C]         | -40~+105              |   |   |
| 引针尺寸        | Pin Dimensions [mm]               | 6.4                   |   |   |
| PCB板孔径      | PCB Hole Diameter [mm]            | 1.8                   |   |   |

|      |     |      |          |  |    |          |            |          |     |                             |        |   |
|------|-----|------|----------|--|----|----------|------------|----------|-----|-----------------------------|--------|---|
| DES. | LQQ | DATE | 21.12.10 | 单位/UNITS                                     | mm | 尺寸/SIZE  | A4         | 比例/SCALE | 1:1 | 第三视角/THIRD ANGLE PROJECTION | 版本/REV | A |
| CHK. | BY  | DATE | 21.12.10 | 慈溪市科发电子有限公司<br>CIXI KEFA ELECTRONIC CO., LTD |    | 名称/TITLE | KF48CM-9.5 |          |     |                             |        |   |
| APP. | CLF | DATE | 21.12.10 |  |    |          |            |          |     |                             |        |   |

## X-ON Electronics

Largest Supplier of Electrical and Electronic Components

*Click to view similar products for [Barrier Terminal Blocks](#) category:*

*Click to view products by [Cixi Kefa](#) manufacturer:*

Other Similar products are found below :

[CR151D20104](#) [670A-RZ-15-KT20](#) [6C1N03](#) [6PCR-02](#) [6PCR-02-008](#) [6PCR-05-008](#) [6PCR-08-008](#) [6PCR-09-008](#) [6PCR-13-006](#) [6PCR-15-006](#) [6PCV-06-008](#) [6PCV-06-716](#) [6PCV-09-001](#) [6PCV-15-008](#) [6PCV-17-1206](#) [6PCV-20-323](#) [6STR-06-006](#) [6STR-08-006](#) [6STR-12-008](#) [6STR-13-006](#) [6STR-14-008](#) [6STR-16-008](#) [6STR-17-008](#) [6STR-21-008](#) [6STR-25-008](#) [6STR-27-008](#) [6STV-03-008](#) [6STV-09-006](#) [6STV-10-006](#) [6WWV-11-008](#) [6WWV-12-008](#) [6WWV-16-008](#) [71502-50](#) [71507-47-50](#) [72504-C-50](#) [72506-C](#) [72507-C-50](#) [72508-56](#) [73203](#) [75505-C-50](#) [812-GP-3/4ST-09](#) [812-GPZ-03PSB](#) [8-1437402-5](#) [8-1437402-7](#) [8PCR-06-006](#) [8PCR-11-006](#) [8PCV-04-001](#) [8PCV-05-008](#) [8PCV-09-006](#) [8PCV-15-006](#)