

linear dimension(Tolerances Standard GB/T 14486-2008)								—		
variable range	to 6	over 6 to 10	over 10 to 30	over 30 to 60	over 60 to 100	over 100 to 160	over 160 to	to 10	over 10 to 100	over 100 to
tolerance	±0.20	±0.30	±0.50	±0.70	±1.00	±1.30	±1.60	0.10	0.30	0.60

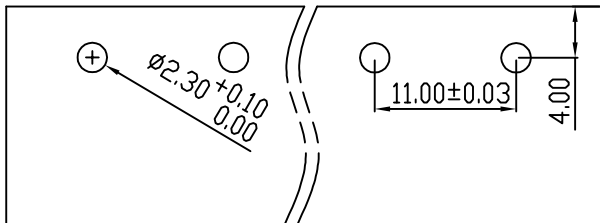

PCB LAYOUT

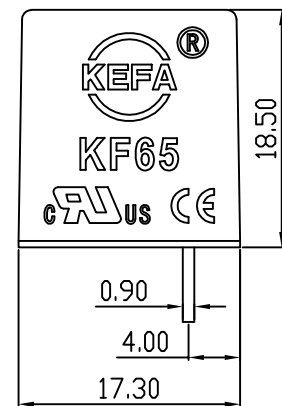
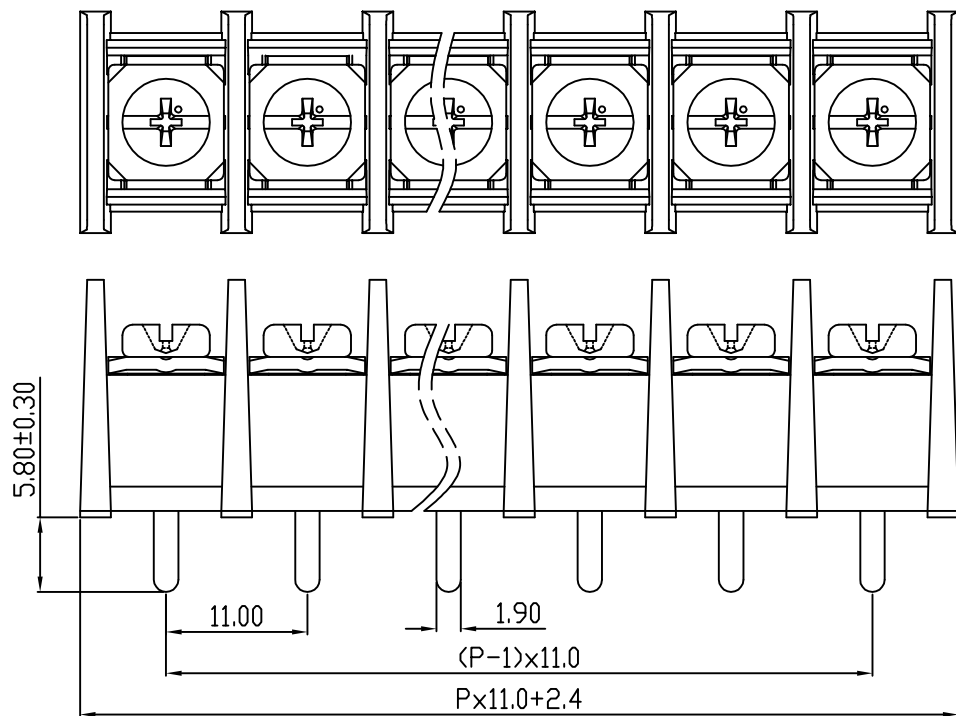

REV.	DESCRIPTION	ECN No.	APPROVED	DATE
A	新发行		CLF	21.09.28

UL/CUL 技术参数 UL/CUL Technical Data							
等级	Use Group		B	C	D		
额定电压	Rated Voltage	[V]	600	-	-		
额定电流	Rated Current	[A]	30	-	-		
接线范围	Wire Range					18-10	
单/多芯线	Solid/Stranded	[AWG]					
IEC 技术参数 IEC Technical Data							
额定电压	Rated Voltage	[V]				750	
额定电流	Rated Current	[A]				32	
耐电压	Withstanding Voltage					3000V/1Min	
导线截面积	Conductor cross section					4	
硬质/柔性导线	Solid/flexible	[mm ²]					
材料 Material							
绝缘材料	Insulation Material					PA66	
阻燃等级	Imflammability					UL94V-0	
导体材料	Contacting Material					铜合金 Copper alloy	
导体表面镀层	Contactive Coating					镀锡 Tin plated	
一般参数 Other Data							
间距	Pitch	[mm]				11.0	
极数	Poles	[P]				02-24	
剥线长度	Stripping Length	[mm]				-	
螺丝	Screw/扭丝	Torque(Max) [N.m]				M4/1.2	
工作温度	Operating temperatur	[°C]				-40~+105	
引针尺寸	Pin Dimensions	[mm]				5.8	
PCB板孔径	PCB Hole Diameter	[mm]				2.3	

DES.	LQQ	DATE	21.09.28	单位/UNITS	mm	尺寸/SIZE	A4	比例/SCALE	1:1	第三视角/THIRD ANGLE PROJECTION	版本/REV	A
CHK.	BY	DATE	21.09.28		慈溪市科发电子有限公司 CIXI KEFA ELECTRONIC CO., LTD			名称/TITLE	KF65S-11.0			
APP.	CLF	DATE	21.09.28									

X-ON Electronics

Largest Supplier of Electrical and Electronic Components

Click to view similar products for [Barrier Terminal Blocks](#) category:

Click to view products by [Cixi Kefa](#) manufacturer:

Other Similar products are found below :

[CR151D20104](#) [670A-RZ-15-KT20](#) [6C1N03](#) [6PCR-02](#) [6PCR-02-008](#) [6PCR-05-008](#) [6PCR-08-008](#) [6PCR-09-008](#) [6PCR-13-006](#) [6PCR-15-006](#) [6PCV-06-008](#) [6PCV-06-716](#) [6PCV-09-001](#) [6PCV-15-008](#) [6PCV-17-1206](#) [6PCV-20-323](#) [6STR-06-006](#) [6STR-08-006](#) [6STR-12-008](#) [6STR-13-006](#) [6STR-14-008](#) [6STR-16-008](#) [6STR-17-008](#) [6STR-21-008](#) [6STR-25-008](#) [6STR-27-008](#) [6STV-03-008](#) [6STV-09-006](#) [6STV-10-006](#) [6WWV-11-008](#) [6WWV-12-008](#) [6WWV-16-008](#) [71502-50](#) [71507-47-50](#) [72504-C-50](#) [72506-C](#) [72507-C-50](#) [72508-56](#) [73203](#) [75505-C-50](#) [812-GP-3/4ST-09](#) [812-GPZ-03PSB](#) [8-1437402-5](#) [8-1437402-7](#) [8PCR-06-006](#) [8PCR-11-006](#) [8PCV-04-001](#) [8PCV-05-008](#) [8PCV-09-006](#) [8PCV-15-006](#)