

# D Series

## Miniature Snap-in Power Rocker Switches

### Features/Benefits

- **Momentary and maintained models**
- **PC and quick connect terminals**
- **Recessed bracket available — prevents accidental actuation**
- **RoHS compliant**
- **Gold plated options available**

### Typical Applications

- **Small appliances**
- **Computers and peripherals**
- **Medical instrumentation**



UL 61058-1



### Specifications

CONTACT RATING:

D101, D102, D103, D105, D108, D201, D202, D203

GP (general purpose)

4 AMPS 125 VAC 50/60 Hz T85 10,000 cycles

2 AMPS 250 VAC 50/60 Hz T85 10,000 cycles

R (resistive)

4 AMPS 30 VDC T85 10,000 cycles

D501, D502, D503, D508, D601, D602, D608

GP (general purpose)

10 AMPS 125 VAC 50/60 Hz T85 10,000 cycles

5 AMPS 250 VAC 50/60 Hz T85 10,000 cycles

R (resistive)

10 AMPS 30 VDC T85 10,000 cycles

0.4VA @ 20V AC/DC (gold plating) available upon request

ELECTRICAL LIFE: 10,000 make-and-break cycles at full load.

INSULATION RESISTANCE:  $10^9 \Omega$  min.

DIELECTRIC STRENGTH: 1,000 Vrms min. @ sea level.

### Materials

ACTUATOR & HOUSING: 6/6 nylon (UL 94V-2), color black, finish: matte.

MOVABLE CONTACTS: D10X and D20X Models: Copper, silver plated.  
D50X and D60X Models: Coin silver, silver plated.

STATIONARY CONTACTS AND TERMINALS: Copper or brass, silver plated. Gold plating available.

CONTACT SPRING: Music wire or stainless steel.

OPERATING TEMPERATURE: -30°C to +65°C

**NOTE:** Specifications and materials listed above are for standard switches. For information on specific and custom switches, consult Customer Service Center.

### Build-A-Switch

To order, simply select desired option from each category and place in the appropriate box. Available options are shown and described on pages G-61 through G-65. For additional options not shown in catalog, consult Customer Service Center.

Switch Function	Actuator	Actuator Color	Mounting Style/Color	Terminations	Actuator Markings	Contact Material
<b>D101</b> SPDT, On-None-On	<b>J1</b> Rocker	<b>2</b> Black	<b>S2</b> Snap-in, black	<b>15</b> Quick connect	<b>NONE</b> No marking	<b>QA</b> Silver
<b>D102</b> SPST, On-None-Off	<b>J5</b> Lever	<b>1</b> White	<b>B2</b> Recessed snap-in actuator guard, black	<b>A</b> Right angle, PC thru-hole	<b>D</b> ON-OFF	Gold plating options available contact Customer Service
<b>D103</b> SPDT, On-Off-On		<b>3</b> Red	<b>G2</b> Actuator guard, black	<b>02</b> PC Thru-hole	<b>H</b> 0 I	
<b>D105</b> SPDT, Mom.-Off-Mom.			<b>S1</b> Snap-in, white	<b>05</b> Twisted quick connect	<b>N</b> Large dot	
<b>D108</b> SPDT, Mom.-None-On				<b>06</b> Extended PC thru-hole	<b>P</b> 0 -	
<b>D201</b> DPDT, On-None-On				<b>17</b> Wireable quick connect	<b>R</b> Red rectangle on end	
<b>D202</b> DPST, On-None-Off					<b>U</b> Large dot on end	
<b>D203</b> DPDT, On-Off-On						
<b>D501</b> SPDT, On-None-On						
<b>D502</b> SPST, On-None-Off						
<b>D503</b> SPDT, On-Off-On						
<b>D508</b> SPDT, Mom.-None-On						
<b>D601</b> DPDT, On-None-On						
<b>D602</b> DPST, On-None-Off						
<b>D608</b> DPDT, Mom.-None-On						











15 May 20



# D Series Miniature Snap-in Power Rocker Switches

## SWITCH FUNCTION



NO. POLES	MODEL NO.	AMP RATING*	SWITCH FUNCTION			CONNECTED TERMINALS			SCHEMATIC
			POS. 1	POS. 2	POS. 3	POS. 1	POS. 2	POS. 3	
									
SP	D102 D502	4 10	ON	NONE	OFF	1-1A	N/A	OPEN	SPST 
	D101 D501	4 10	ON	NONE	ON		OPEN	1-1B	SPDT 
	D103 D503	4 10		OFF					
	D105	4	MOM.	OFF					
	D108 D508	4 10	MOM.	NONE	ON		N/A		

### SPDT

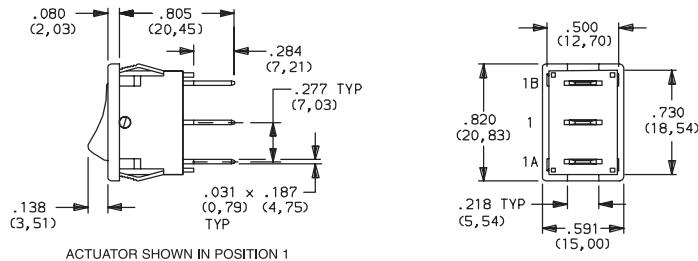

ACTUATOR SHOWN IN POSITION 1

TERMINAL NOS.  
FOR REF. ONLY

Part number shown: D101J12S215QA

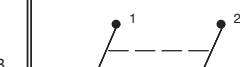
DP	<b>D202</b>	4	ON	NONE	OFF	1-1A, 2-2A	N/A	OPEN	DPST	
	<b>D602</b>	10								
	<b>D201</b>	4	ON	NONE	ON		OPEN	1-1B, 2-2B	DPDT	
	<b>D601</b>	10								
	<b>D203</b>	4		OFF						
	<b>D608</b>	10	MOM.	NONE			N/A			

### DPDT

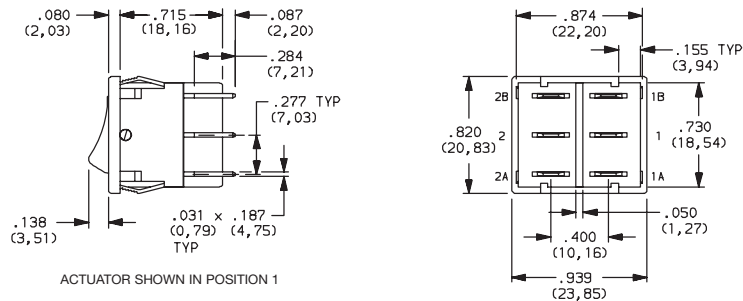

ACTUATOR SHOWN IN POSITION 1

TERMINAL NOS.  
FOR REF. ONLY

Part number shown: D201J12S215QA

MOM. = Momentary

\*AMP RATING: see G-60

See CONTACT MATERIALS, page G-64.



Rocker

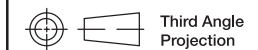

Third Angle Projection

Dimensions are shown: Inches (mm)  
Specifications and dimensions subject to change



15 May 20

# D Series Miniature Snap-in Power Rocker Switches



## J1 ROCKER

## J5 LEVER

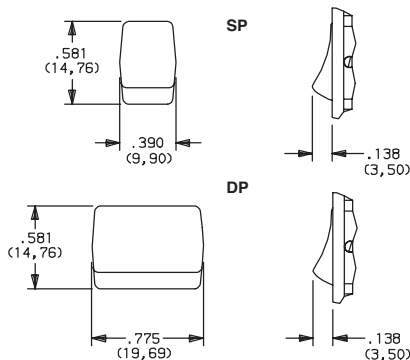

OPTION CODE	ACTUATOR COLOR
2	BLACK
1	WHITE
3	RED

**NOTE:** Actuator finish: matte. Other colors available, consult Customer Service Center.

'J5' actuator available only with DP models D201, D202, D601 and D602.

## MOUNTING STYLE/COLOR

## S SNAP-IN

## B2 RECESSED SNAP-IN ACTUATOR GUARD, BLACK

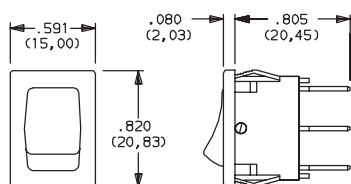

OPTION CODE	HOUSING COLOR
2	(STD.) BLACK
1	WHITE

**NOTE:** Frame finish on housing: matte. Other colors available, consult Customer Service Center.

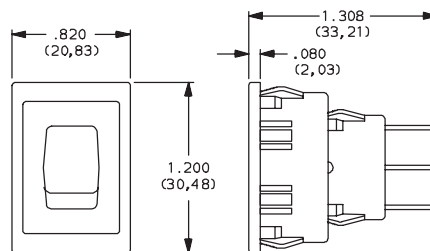

**NOTE:** Vertical mount, SP models only.

## G2 ACTUATOR GUARD, BLACK

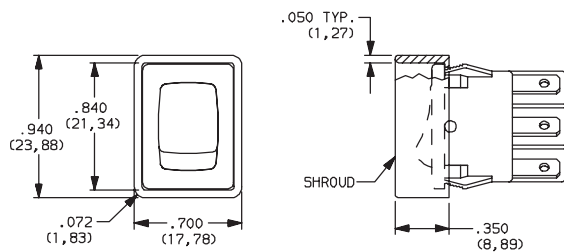

**NOTE:** Vertical mount, SP models only.

## PANEL MOUNTING

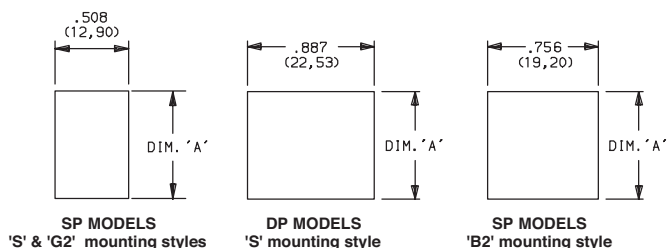

PANEL THICKNESS	DIM 'A' SP & DP MODELS 'S' MOUNTING STYLE	DIM 'A' WITH 'G2' OPTION SP MODELS ONLY	DIM 'A' SP MODELS 'B' MOUNTING STYLE
.030-.049 (0,76) (1,24)	.756 (19,20)	.764 (19,41)	1.068 (27,13)
.049-.079 (1,24) (2,01)	.764 (19,41)	.780 (19,81)	1.076 (27,33)
.079-.118 (2,01) (3,00)	.780 (19,81)	n/a	1.092 (27,74)

**NOTE:** Blank insert available for SP models only, see page G-64.

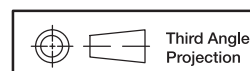

Dimensions are shown: Inches (mm)  
Specifications and dimensions subject to change



15 May 20



## TERMINATIONS

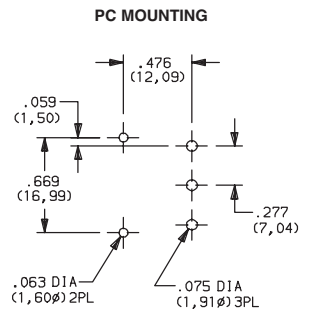
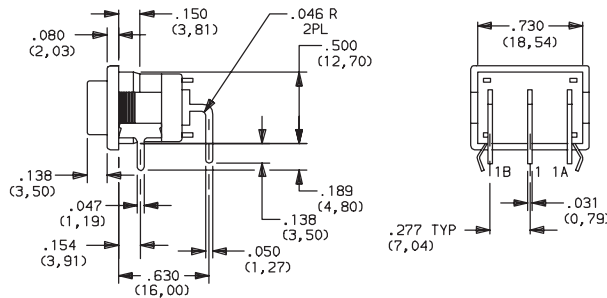

## TERMINATIONS

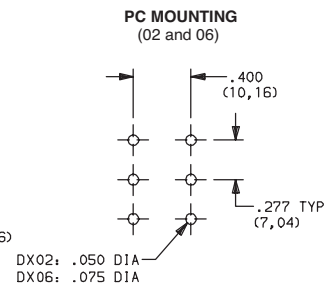
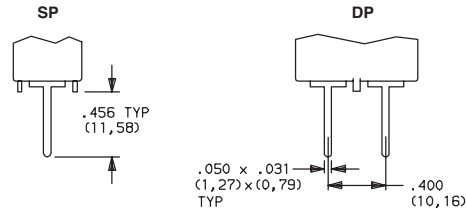

Available with DX01 and DX02 models only.

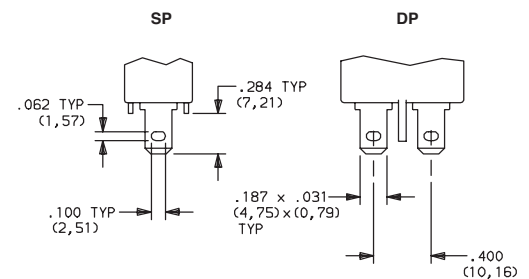
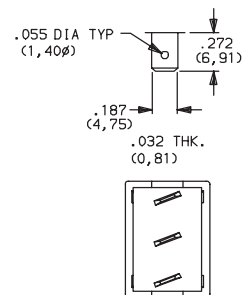

Available with DX01 and DX02 models only.

## ACTUATORS

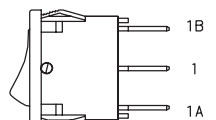

Third Angle Projection

**C&K**

[www.ckswitches.com](http://www.ckswitches.com)

## Miniature Snap-in Power Rocker Switches

OPTION CODE	CONTACT AND TERMINAL MATERIAL	RATINGS
QA	SILVER <sup>1</sup>	D101, D102, D103, D105, D108, D201, D202, D203
		GP (general purpose) 4 AMPS 125 VAC 50/60 Hz T85 10,000 cycles
		2 AMPS 250 VAC 50/60 Hz T85 10,000 cycles
		R (resistive) 4 AMPS 30 VDC T85 10,000 cycles
		D501, D502, D503, D508, D601, D602, D608
		GP (general purpose) 10 AMPS 125 VAC 50/60 Hz T85 10,000 cycles
		5 AMPS 250 VAC 50/60 Hz T85 10,000 cycles
		R (resistive) 10 AMPS 30 VDC T85 10,000 cycles

<sup>1</sup>MOVABLE CONTACT: D10X and D20X MODELS: Copper, silver plated.  
D50X and D60X MODELS: Coin silver, silver plated.



0.4VA @ 20V AC/DC Gold plated options available contact Customer Service.

## AVAILABLE HARDWARE

**Insert  
SP Only**

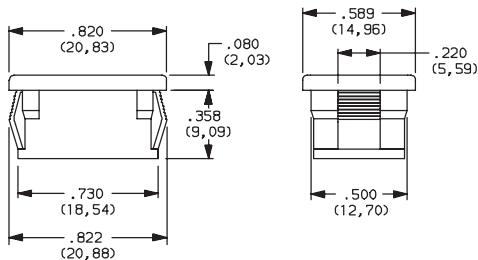

**PART NO.**  
**057190200** BLACK  
Material: Nylon 6/6  
Finish: Matte

**Recessed Actuator Guard,  
SP Only**

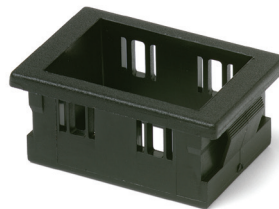

**599D02000** BLACK  
Material: 6/6 Nylon  
Finish: Matte

### Actuator Guard

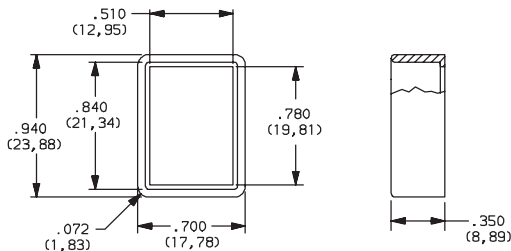

**PART NO.**  
**104C22000**  
Material: PBT thermoplastic  
Finish: Matte

## PART NO.

**216C00000** IP54 SPLASH PROOF RUBBER BOOT

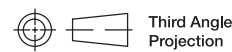
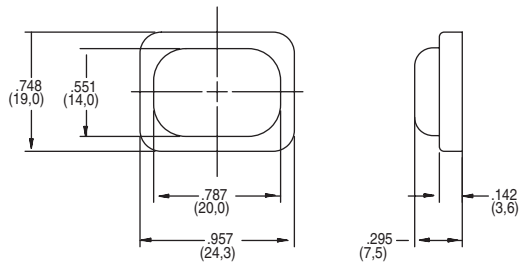

Dimensions are shown: Inches (mm)  
Specifications and dimensions subject to change



## X-ON Electronics

Largest Supplier of Electrical and Electronic Components

*Click to view similar products for [Switch Fixings](#) category:*

*Click to view products by [C&K](#) manufacturer:*

Other Similar products are found below :

[893102000](#) [00-5150](#) [LZZ1A](#) [0098.9234](#) [61-9451.0](#) [M2PA-5011](#) [630155](#) [635401](#) [6PA113](#) [6PA147-E6](#) [6PA148-E6](#) [6PA32](#) [6PA9](#) [700109](#)  
[700303A56](#) [700C1GRY](#) [700C2GRN](#) [704-6001](#) [704.960.4](#) [704.960.9](#) [704.965.2](#) [704.965.6](#) [704.966.0](#) [7089-3](#) [710082-B11](#) [71M1048](#)  
[757200264](#) [764300000](#) [MHU35](#) [MHU37](#) [807039-1](#) [825.003.011](#) [825.005.011](#) [825.053.011](#) [825.055.011](#) [826.000.071](#) [827.020.011](#)  
[827.400.021](#) [835.900.023](#) [MML52C10C](#) [MML52E10C](#) [MML92HGH](#) [MML93K](#) [84211M02CNNS](#) [84212M02CNNS](#) [84217A8.0LNOS](#)  
[842.500.011](#) [843.000.011](#) [843187-000](#) [843487-000](#)