

**RS 76 C - Full-travel key switch, not illuminable****3.13.001.210/0000**

Recommended for use of multi-module keycaps.



For accessories and keycaps, refer to RS 76.

**General information**

Recommended key grid	19.05 mm
----------------------	----------

**Mechanical design**

Contact function	momentary
Mounting	soldering
Terminals	solder terminals, tin-plated
Contact system	contactless with Hall-IC
Illumination	no

**Mechanical characteristics**

Switching travel off	0.8 ... 2.4 mm
Operating force max.	1 N
Operating travel	4 mm
Switching travel on	1.5 - 2.8 mm
Robustness max.	100 N

**Electrical characteristics**

Operating voltage DC	4.75 ... 5.25 V
Supply current max. at $U_{IL} = 0$ V	0.5 mA
Supply current max. at $U_{IH} = 5$ V	5 mA
Input voltage (F) at $U_{IL} = 0$ V	0.4 V
Input voltage (F) at $U_{IH} = 2.4$ V	5.25 V
Output load current (Q) max.	16 mA
Output residual current (Q) max.	10 $\mu$ A
Output saturation voltage (Q) max. bei 16 mA	0.4 V
ESD strength max.	8 kV
Output switching times (Q) at 25 °C, $t_{PHL}$	3 $\mu$ s
Output switching times (Q) at 25 °C, $t_{PLH}$	4 $\mu$ s
Output switching times (Q) at 25 °C, $t_{THL}$	1 $\mu$ s
Output switching times (Q) at 25 °C, $t_{TLH}$	2 $\mu$ s

### Other specifications

Reliability of Hall-IC at 25 °C	$\lambda = 2.5 \times 10^{-7} \text{ h}^{-1}$
Ambient temp. operating min.	0 °C
Ambient temp. operating max.	+70 °C
Storage temperature min.	-40 °C
Storage temperature max. (product)	+80 °C
Storage temperature max. (rail)	+50 °C
Environmental resistance	acc. to IEC 60068-2-14, -30, -33 and -78
Operating life min. (operations)	10 <sup>8</sup> cycle
Degree of protection	IP40 (DIN EN 60529)
Flammability of materials	UL 94 HB
ROHS compliant	yes
REACH compliant	yes

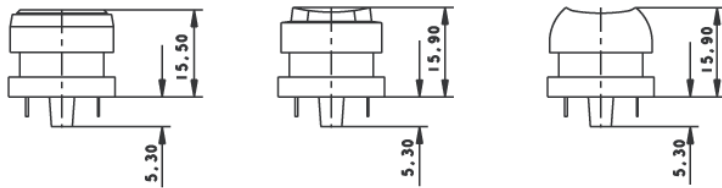
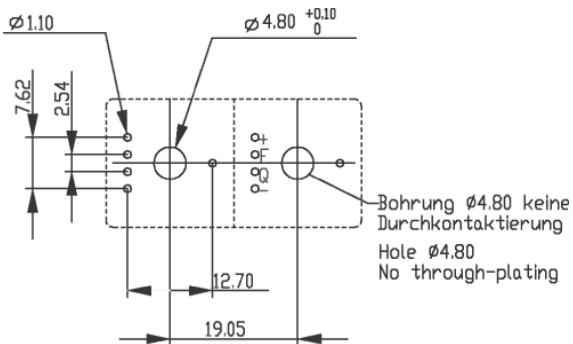

## X-ON Electronics

Largest Supplier of Electrical and Electronic Components

*Click to view similar products for [Pushbutton Switches](#) category:*

*Click to view products by [C&K](#) manufacturer:*

Other Similar products are found below :

[8940K2012](#) [LW1L-M1C10V-A](#) [LW1L-M1C70-A](#) [LW2L-A1C20M-GD](#) [LW2L-M1C20M-A](#) [60324L](#) [M22-D-R-GB0/K11](#) [M7E-HRN2](#)  
[67021K512](#) [67081K512X](#) [701PB580](#) [7199K101](#) [810K12910](#) [810KSV30B](#) [MML21EA2ADK](#) [MML21KA3ABK](#) [MML23KA3AC05K-001](#)  
[MML23KW3AA01W](#) [8418K2](#) [8442K3](#) [8450K1](#) [860K11911T01A](#) [861901](#) [861K11911T01A07](#) [861K13810T00A14](#) [861K13911](#)  
[8646AB6X718UL](#) [8646ABUL](#) [9001KXRK](#) [907AYY100](#) [PMHD155A1](#) [9533CD4+U574+U4922](#) [95-414.000](#) [99-450.837](#) [99-453.837](#)  
[PV3H2B0NN-341](#) [1203MRA](#) [A22NZBGANGA](#) [A22NZBNANGA](#) [A22NZMPATRA](#) [A2PMA1X03EC56](#) [A3A-5123-02](#) [A3A-7140](#) [A3A-7310](#) [A3A-7340](#) [A3U-TMW-A2C-5M](#) [A595](#) [12037A2ULCSA](#) [ABD122N-B](#) [1211390004](#)