

# DS Series Detect Switch



## Features/Benefits

- Compact design
- Low actuation force
- Detect mechanical movement
- Left and right options
- Right angle options

## Typical Applications

- Computer peripherals
- Office equipment
- Consumer electronics
- Appliances
- Audio and visual equipment

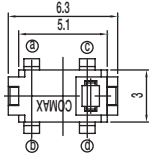

PART NUMBER	PACKAGING	SCHEMATIC
<b>DS-02005</b>	1,000 pieces	1P-1T

## Specifications

CONTACT ARRANGEMENT: SPST, NO  
 CONTACT RATING: 100mA @ 30 VDC  
 OPERATING LIFE: 50,000 cycles  
 OPERATING FORCE: 50 gf max.  
 PRE-TRAVEL: 0.7 mm  
 TOTAL TRAVEL: 2.6 mm  
 INITIAL CONTACT RESISTANCE: 1  $\Omega$  max.  
 INSULATION RESISTANCE: 100 M  $\Omega$  min. @ 100 VDC 60 sec.  
 DIELECTRIC STRENGTH: 100 V AC (50-60Hz) 60 sec.  
 OPERATING TEMPERATURE: -40°C to +85°C.

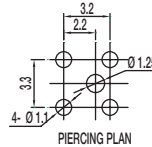
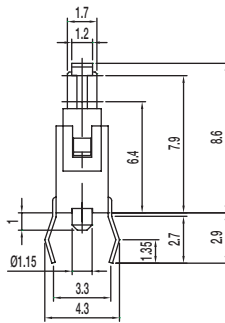
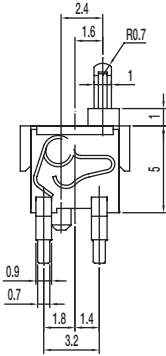

## Materials

KNOB: PA  
 COVER: PA  
 SPRING: Gold plated, copper alloy  
 HOUSING: PA  
 TERMINAL: Silver plated, copper alloy

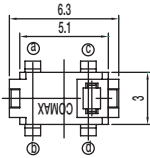

PART NUMBER	PACKAGING	SCHEMATIC
<b>DS-02005 (30)</b>	1,000 pieces	1P-1T

## Specifications

CONTACT ARRANGEMENT: SPST, NO  
 CONTACT RATING: 100mA @ 30 VDC  
 OPERATING LIFE: 50,000 cycles  
 OPERATING FORCE: 30 gf max.  
 PRE-TRAVEL: 0.7 mm  
 TOTAL TRAVEL: 2.2 mm  
 INITIAL CONTACT RESISTANCE: 1  $\Omega$  max.  
 INSULATION RESISTANCE: 100 M  $\Omega$  min. @ 100 VDC 60 sec.  
 DIELECTRIC STRENGTH: 100 V AC (50-60Hz) 60 sec.  
 OPERATING TEMPERATURE: -40°C to +85°C.

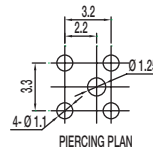
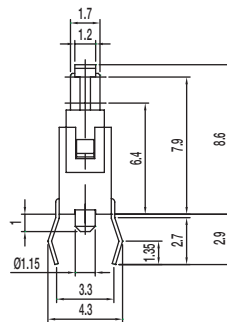
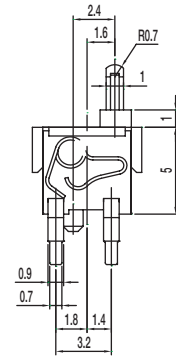

## Materials

KNOB: PA  
 COVER: PA  
 SPRING: Gold plated, copper alloy  
 HOUSING: PA  
 TERMINAL: Silver plated, copper alloy

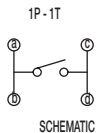

Detect



PART NUMBER	PACKAGING	SCHEMATIC
<b>DS-040-02</b>	1,000 pieces	1P-1T  N.O.

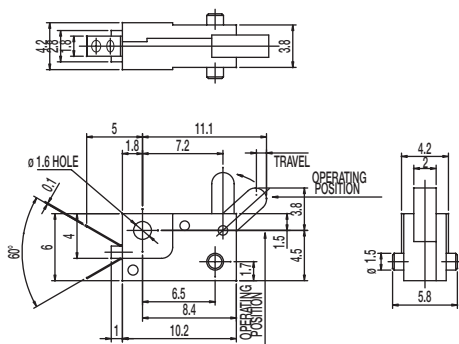

## Specifications

CONTACT ARRANGEMENT: SPST, NO  
 CONTACT RATING: 0.1A @ 16 VDC  
 OPERATING LIFE: 20,000 cycles  
 OPERATING FORCE: 30 ± 15 gf  
 TRAVEL: 0.90 ± 0.20 mm  
 INITIAL CONTACT RESISTANCE: 40 m Ω max.  
 INSULATION RESISTANCE: 100 M Ω min. @ 250 VDC 60 sec.  
 DIELECTRIC STRENGTH: 250 V AC (50-60Hz) 60 sec.  
 OPERATING TEMPERATURE: -20°C to +70°C.

## Materials

LEVER: POM  
 CASE: PBT  
 COVER: PC

PART NUMBER	PACKAGING	SCHEMATIC
<b>DS-180 RT</b>	3000 pieces	1P - 1T  N.O.

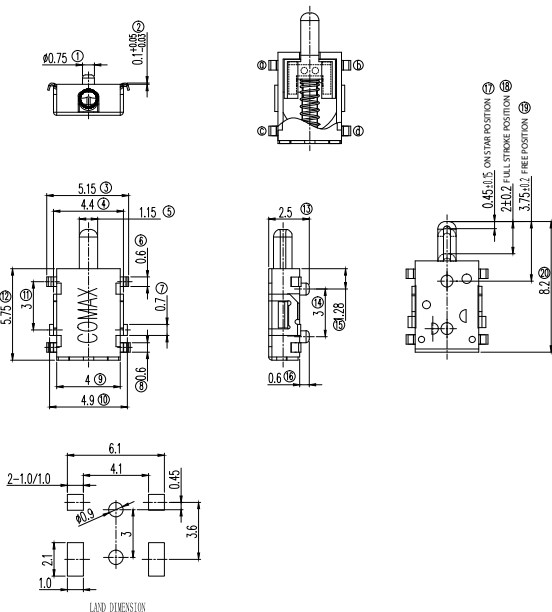

## Specifications

CONTACT ARRANGEMENT: SPST NO  
 CONTACT RATING: 1mA @ 5 VDC  
 OPERATING LIFE: 50,000 cycles  
 OPERATING FORCE: 60 gf max.  
 TOTAL TRAVEL: 2.0±0.2 mm  
 INITIAL CONTACT RESISTANCE: 5Ω max.  
 INSULATION RESISTANCE: 100 M Ω min. @ 100 VDC 60 sec.  
 DIELECTRIC STRENGTH: 100 V AC (50-60Hz) 60 sec.  
 OPERATING TEMPERATURE: -40°C to +85°C.

## Materials

KNOB: PA  
 COVER: SPTe  
 SPRING: SUS  
 HOUSING: LCP  
 TERMINAL: Silver plated



Detect



# DS Series Detect Switch



PART NUMBER	PACKAGING	SCHEMATIC
<b>DS-09005-02 RP</b>	500 pieces	

## Specifications

CONTACT ARRANGEMENT: SPST

CONTACT RATING: 1mA @ 5 VDC

OPERATING LIFE: 100,000 cycles

OPERATING FORCE: 50 gf max.

TOTAL TRAVEL: 4.5±0.2 mm

INITIAL CONTACT RESISTANCE: 500 m Ω max.

INSULATION RESISTANCE: 100 M Ω min. @ 500 VDC 60 sec.

DIELECTRIC STRENGTH: 500 V AC (50-60Hz) 60 sec.

OPERATING TEMPERATURE: -20°C to +70°C.

## Materials

LEVER: POM

COVER: PA

HOUSING: PA

TERMINAL: Silver plated

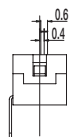
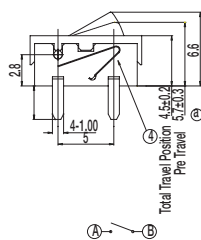
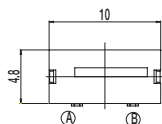

Detect

## X-ON Electronics

Largest Supplier of Electrical and Electronic Components

*Click to view similar products for [Detector Switches](#) category:*

*Click to view products by [C&K](#) manufacturer:*

Other Similar products are found below :

[E3S-LS5C4S](#) [SPVQ850300](#) [21075-6](#) [SPVQ860100](#) [K2CU-F20A-F AC220](#) [D3DM0005H](#) [D3DM0001E](#) [D3DM0003A](#) [HARB0012](#) [PP2-7H1-2D2](#) [PP1-FB7-2D2](#) [PP2-7U1-2B2](#) [PP1-ET7-2B2](#) [MR1000AWA](#) [MR1000BWA](#) [ESE-31R11T](#) [ESE-23F101](#) [ESE-13V01D](#) [ESE-13V01C](#) [ESE-13V01A](#) [ESE-13H01B](#) [ESE-11MH1T](#) [ESE-11MH2T](#) [ESE-11MV1](#) [ESE-31L11T](#) [HDS001R](#) [SPVL110102](#) [ESE-11MV1T](#) [ESE-13V01B](#) [ESE-23J101](#) [SPPW811200](#) [ESE-58R61B](#) [SPVQ361300](#) [ESE-58R11B](#) [SPVT210201](#) [SPVL120101](#) [ESE-24CMV9T](#) [DS080](#) [DS0900502RP](#) [T0-SCB22MP1NC1](#) [T0-SCB22MP1NSX](#) [ESE-13H01A](#) [ESE-13H01C](#) [ESE-13H01D](#) [ESE-18R63D](#) [ESE-24CMH6T](#) [SPVN210101](#) [SPPB110300](#) [SPPB120200](#) [SPPB1A0100](#)