

# KMR 6 Series Microminiature SMT Top Actuated IP67

## Features/Benefits

- Watertight IP67
- Standard and long life versions
- No ground pin
- Ultra low current capabilities
- Excellent tactile feel

## Typical Applications

- Automotive
- Medical
- Consumer
- Industrial

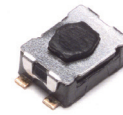

B

B

Tactile Switches

## Specification

FUNCTION: momentary action  
CONTACT ARRANGEMENT: 1 make contact = SPST, N.O.  
TERMINALS: Gullwing type for SMT

## Mechanical

| Type NG<br>See description<br>below | Operating<br>force<br>N (grs) | Operating<br>life<br>(cycles) | Travel (mm)   |
|-------------------------------------|-------------------------------|-------------------------------|---------------|
| KMR611NG LFS                        | 1.2 (120) ± 0.30              | 200,000                       | 0.20 mm ± 0.1 |
| KMR611NG ULC LFS                    | 1.2 (120) ± 0.30              | 200,000                       | 0.20 mm ± 0.1 |
| KMR613NG LFG                        | 1.2 (120) ± 0.30              | 200,000                       | 0.20 mm ± 0.1 |
| KMR613NG ULC LFG                    | 1.2 (120) ± 0.30              | 200,000                       | 0.20 mm ± 0.1 |
| KMR621NG LFS                        | 2.0 (200) ± 0.50              | 200,000                       | 0.25 mm ± 0.1 |
| KMR621NG ULC LFS                    | 2.0 (200) ± 0.50              | 200,000                       | 0.25 mm ± 0.1 |
| KMR623NG LFG                        | 2.0 (200) ± 0.50              | 200,000                       | 0.25 mm ± 0.1 |
| KMR623NG ULC LFG                    | 2.0 (200) ± 0.50              | 200,000                       | 0.25 mm ± 0.1 |
| KMR631NG LFS                        | 3.0 (300) ± 0.75              | 150,000                       | 0.25 mm ± 0.1 |
| KMR631NG ULC LFS                    | 3.0 (300) ± 0.75              | 150,000                       | 0.25 mm ± 0.1 |
| KMR632NG LFS                        | 3.0 (300) ± 0.75              | 300,000                       | 0.25 mm ± 0.1 |
| KMR632NG ULC LFS                    | 3.0 (300) ± 0.75              | 300,000                       | 0.25 mm ± 0.1 |
| KMR633NG LFG                        | 3.0 (300) ± 0.75              | 150,000                       | 0.25 mm ± 0.1 |
| KMR633NG ULC LFG                    | 3.0 (300) ± 0.75              | 150,000                       | 0.25 mm ± 0.1 |
| KMR641NG LFS                        | 4.0 (400) ± 1.00              | 100,000                       | 0.30 mm ± 0.1 |
| KMR641NG ULC LFS                    | 4.0 (400) ± 1.00              | 100,000                       | 0.30 mm ± 0.1 |
| KMR642NG LFS                        | 4.0 (400) ± 1.00              | 200,000                       | 0.30 mm ± 0.1 |
| KMR642NG ULC LFS                    | 4.0 (400) ± 1.00              | 200,000                       | 0.30 mm ± 0.1 |
| KMR643NG LFG                        | 4.0 (400) ± 1.00              | 100,000                       | 0.30 mm ± 0.1 |
| KMR643NG ULC LFG                    | 4.0 (400) ± 1.00              | 100,000                       | 0.30 mm ± 0.1 |

## Electrical

|                        | Silver     | Gold    |
|------------------------|------------|---------|
| MAXIMUM POWER:         | 1 VA       | 0.2 VA  |
| MAXIMUM VOLTAGE:       | 32 VDC     | 32 VDC  |
| MINIMUM VOLTAGE:       | 20 mVDC    | 20 mVDC |
| MAXIMUM CURRENT:       | 50 mA      | 10 mA   |
| MINIMUM CURRENT:       | 1 mA*      | 1 mA*   |
| DIELECTRIC STRENGTH:   | ≥ 250 Vrms |         |
| CONTACT RESISTANCE:    | ≤ 100 mΩ   |         |
| INSULATION RESISTANCE: | ≥ 1GΩ      |         |
| BOUNCE TIME:           | ≤ 3 ms     |         |

\*For ULC version minimum current is 1µA at 1.8 VDC

## Environmental

|                        | Silver        | Gold           |
|------------------------|---------------|----------------|
| OPERATING TEMPERATURE: | -40°C to 85°C | -40°C to 125°C |
| STORAGE TEMPERATURE:   | -55°C to 85°C | -55°C to 125°C |

## Process

Soldering: Lead free reflow soldering process in accordance with IEC 61760-1.

## Packaging

In reels of 7,000 pieces  
External diameter 330 mm ± 2 mm

NOTE: Specifications listed above are for switches with standard options. For information on specific and custom switches, consult Customer Service Center.

TACTILE FEELING: KMR 6 series with actuation force in 2N - 3N - 4N: ≥ 30%  
KMR 6 series with actuation force in 1.2N: ≥ 20%

## Part Number Description

For any part number different from those listed above, please consult your local representative.

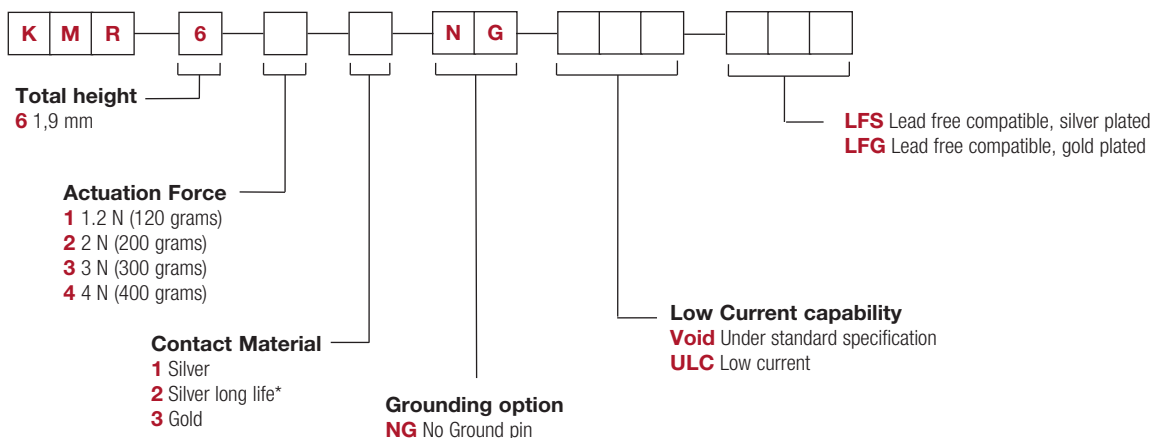

\* Silver long life is available in 3N and 4N actuation force. For other versions, please contact Customer Service.

# KMR 6 Series Microminiature SMT Top Actuated IP67

NG - No Ground Pin

Tactile Switches

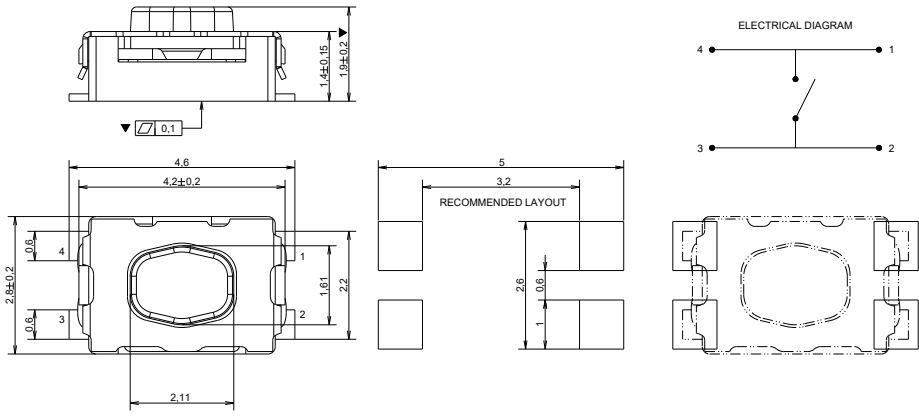

## TAPE & REEL

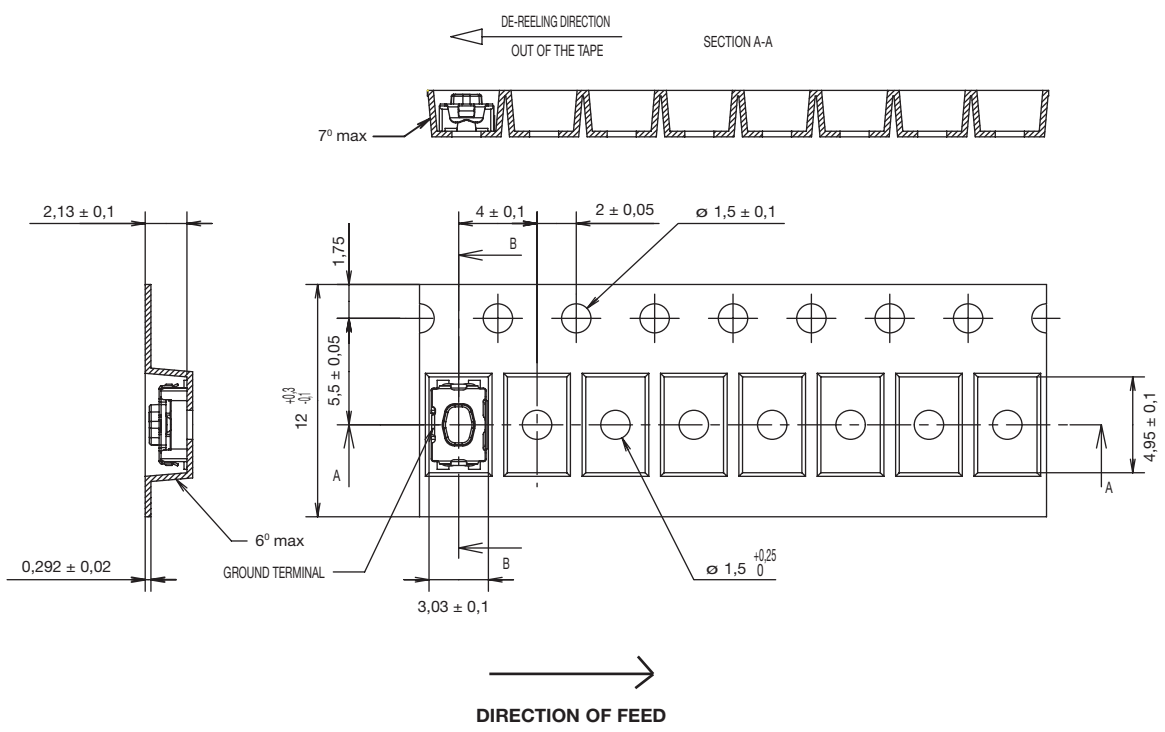

## X-ON Electronics

Largest Supplier of Electrical and Electronic Components

*Click to view similar products for [Tactile Switches](#) category:*

*Click to view products by [C&K](#) manufacturer:*

Other Similar products are found below :

[5GTH92001](#) [1-1977120-4](#) [ADTSA62NV](#) [ADTSA62RV](#) [ADTSA63KV](#) [ADTSA644NV](#) [ADTSMW66NV](#) [ADTSMW67RV](#) [B3F-3123](#) [B3F-6055A](#) [B3F-B32-01-KIT](#) [1977177-8](#) [1977266-1](#) [ADTS644KV](#) [ADTSA61RV](#) [ADTSA62KV](#) [ADTSA63NV](#) [ADTSA63RV](#) [ADTSM21NSVTR](#) [ADTSM32NVTR](#) [ADTSM63SVTR](#) [ADTSM644KVTR](#) [ADTSMW64RV](#) [ADTSMW69NV](#) [FSMRA4JHA04](#) [GS4.70F300QP](#) [3ESH9R](#) [506E00201](#) [MJTP1164TR](#) [3FTL600RAS](#) [3FTL640RAS](#) [Y96K132V0FPLFS](#) [101-TS5022T1601-EV](#) [5GSH92001](#) [KSJ0A231](#) [80SH LFG](#) [ADTSM31NVTR](#) [EVQ-P1D05K](#) [MJTP1162TR](#) [ADTSM63KV](#) [2-1977120-7](#) [TSJW-5.2-260-TR](#) [KMT011MNGJLHS](#) [B3WN6002S](#) [ADTSA648RV](#) [70-201.0](#) [ADTSG648NV](#) [ADTSM62KSVTR](#) [ATA600VTR](#) [ADTSG66RV](#) [ADTS61NV](#)