

# KMX Series Low Profile SMT Top Actuated



## Features

- Ultra low profile 0.58mm
- Compact switch body; 4.1x4.1mm
- 1.6 and 2.2N sharp tactile feel
- 250k cycles
- $\varnothing$  1.4mm actuator grounded
- RoHS compliant and compatible

## Typical Applications

- Allows higher board density with compact SMT switch for ultra low profile environment: cell phones keypads, key fob, white goods, medical and military

B

Tactile Switches

## Specification

FUNCTION: Snap action push-on type SPST/shielded  
CONTACT TYPE: Normally open  
TERMINALS: Gullwing type for SMT

## Mechanical

OVERLOAD: 50N  
TACTILE FEELING: 30% min.  
ACTUATION CONDITION LIMITS:  
- inclination: 4° max.  
- de-centering:  
\* series 100 Q.15 mm max.  
\* series 200 Q.30 mm max.  
- actuator diameter: 1 mm max. with 0.1 mm radius.

| Type         | Operating force<br>Newtons (grams) | Operating life<br>(operations) | Travel          |
|--------------|------------------------------------|--------------------------------|-----------------|
| KMX211G/213G | 1.6 (160) $\pm$ 30%                | 250,000                        | 0.20 $\pm$ 0.10 |
| KMX221G/223G | 2.2 (220) $\pm$ 30%                | 250,000                        | 0.20 $\pm$ 0.10 |

## Packaging

Tape and reels in reels of 10,000 pieces.  
External diameter 380mm  $\pm$  2mm.

## Electrical

|                        | Silver                | Gold   |
|------------------------|-----------------------|--------|
| MAXIMUM POWER:         | 0.5 VA                | 0.5 VA |
| MAXIMUM VOLTAGE:       | 32 VDC                | 32 VDC |
| MAXIMUM CURRENT DC:    | 50 mA                 | 20 mA  |
| MINIMUM CURRENT DC:    | 1 mA                  | 1 mA   |
| CONTACT RESISTANCE:    | $\leq$ 100 m $\Omega$ |        |
| INSULATION RESISTANCE: | $\geq$ 50 M $\Omega$  |        |
| BOUNCE TIME:           | $\leq$ 6 ms           |        |

## Environmental

|                        | Silver      | Gold         |
|------------------------|-------------|--------------|
| OPERATING TEMPERATURE: | -40C to 85C | -40C to 125C |
| STORAGE TEMPERATURE:   | -55C to 85C | -55C to 125C |
| RELATIVE HUMIDITY      | 90 to 96%   |              |

## Process

Infrared reflow soldering in accordance with IEC 61760-1

## How To Order

Our easy build-a-switch concept allows you to mix and match options to create the switch you need. To order, select desired option from each category and place it in the appropriate box.

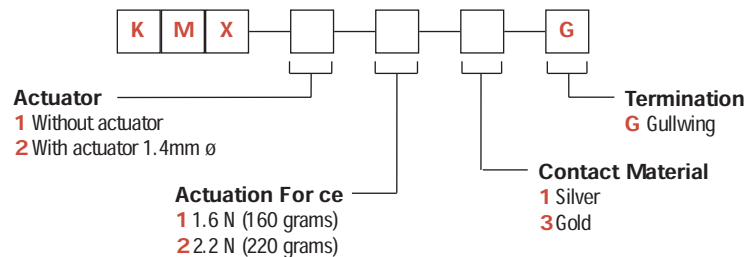

# KMX Series Low Profile SMT Top Actuated



Tactile Switches

B

## KMX 1

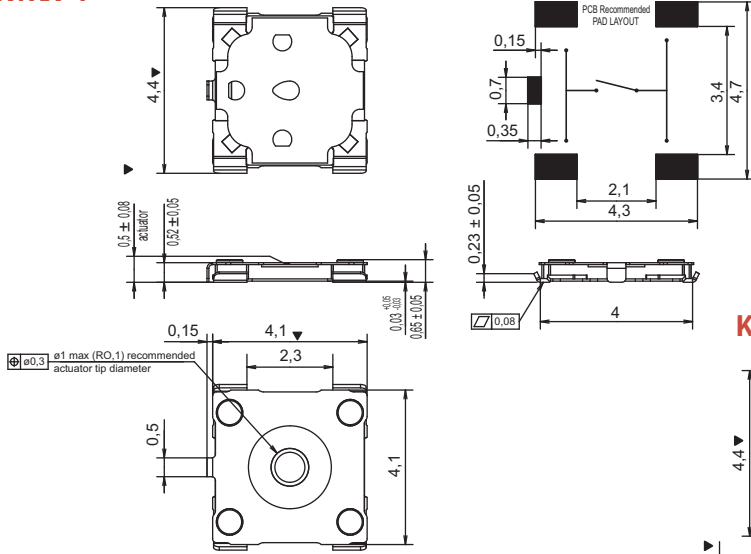

## KMX 2

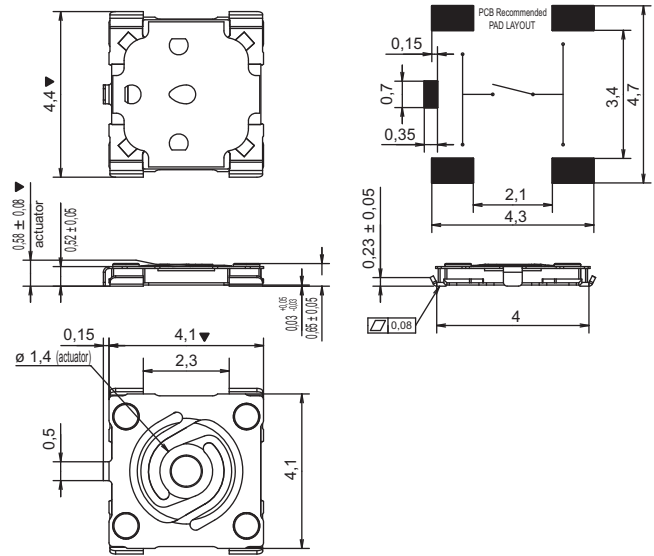

## TAPE & REEL

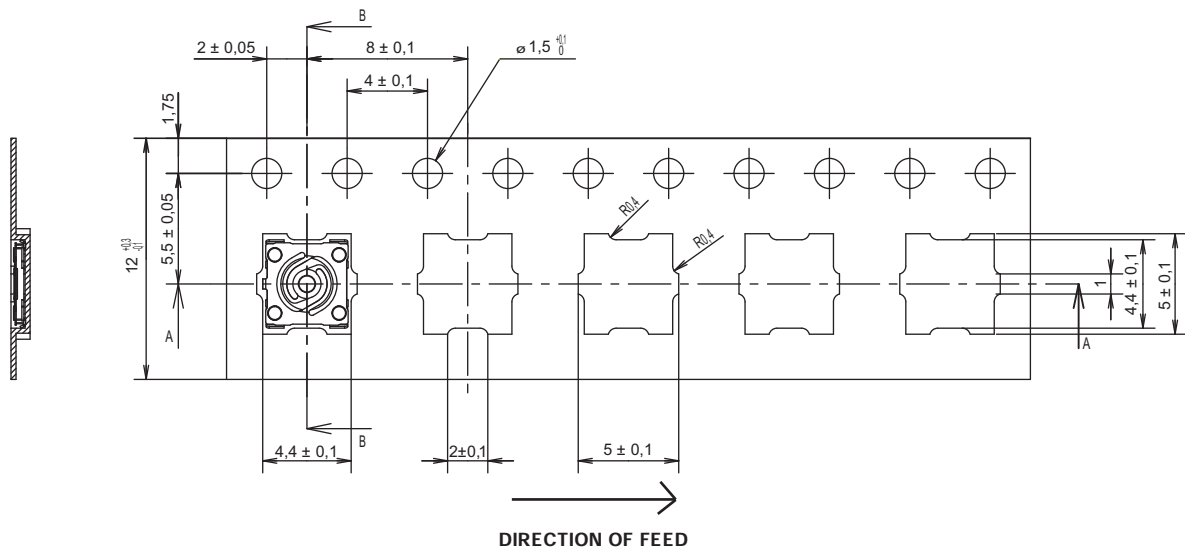

First Angle  
Projection

Dimensions shown in: mm (inch)  
Specifications and dimensions subject to change

www.ck-components.com



## X-ON Electronics

Largest Supplier of Electrical and Electronic Components

*Click to view similar products for [Tactile Switches](#) category:*

*Click to view products by [C&K](#) manufacturer:*

Other Similar products are found below :

[KMR633NG LFG](#) [5GTH92001](#) [5GTH9202242](#) [6426-201-11343](#) [MJ1226](#) [MJTP1109B](#) [MJTP1138EAUTR](#) [MJTP1230BL](#) [MJTPSHW](#)  
[GS6.90F300QP](#) [1-1977223-0](#) [1-1977120-4](#) [ADTSA62NV](#) [ADTSA62RV](#) [ADTSA63KV](#) [ADTSA644NV](#) [ADTSM24NVTR](#) [ADTSMW66NV](#)  
[ADTSMW67RV](#) [ATM533VTR](#) [1571300-3](#) [B3F-3123](#) [B3F-6055A](#) [B3F-B32-01-KIT](#) [1977177-8](#) [1977266-1](#) [2-1977223-4](#) [2-1977223-7](#)  
[ADTS644KV](#) [ADTSA61RV](#) [ADTSA62KV](#) [ADTSA63NV](#) [ADTSA63RV](#) [ADTSA65NV](#) [ADTSM21NSVTR](#) [ADTSM25RVTR](#)  
[ADTSM31RVTR](#) [ADTSM32NVTR](#) [ADTSM61YVTR](#) [ADTSM63SVTR](#) [ADTSM644KVTR](#) [ADTSMW64RV](#) [ADTSMW69NV](#)  
[FSMRA4JHA04](#) [GS4.70F300QP](#) [D38999/20JJ37SA](#) [TL1105B](#) [TL1105J](#) [ATH447K2Q](#) [ATM534VTR](#)